

REV	LOCATIONS	DESCRIPTION	DATE	REVISER	APPD

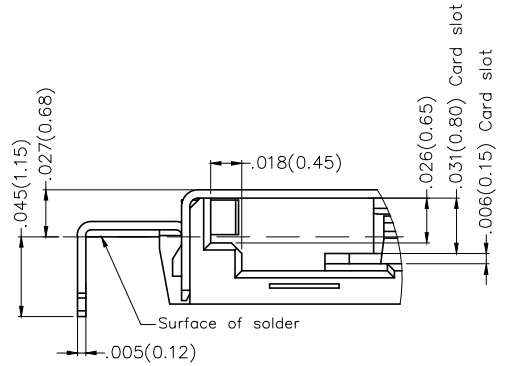

Detail "A"
Scale 8:1

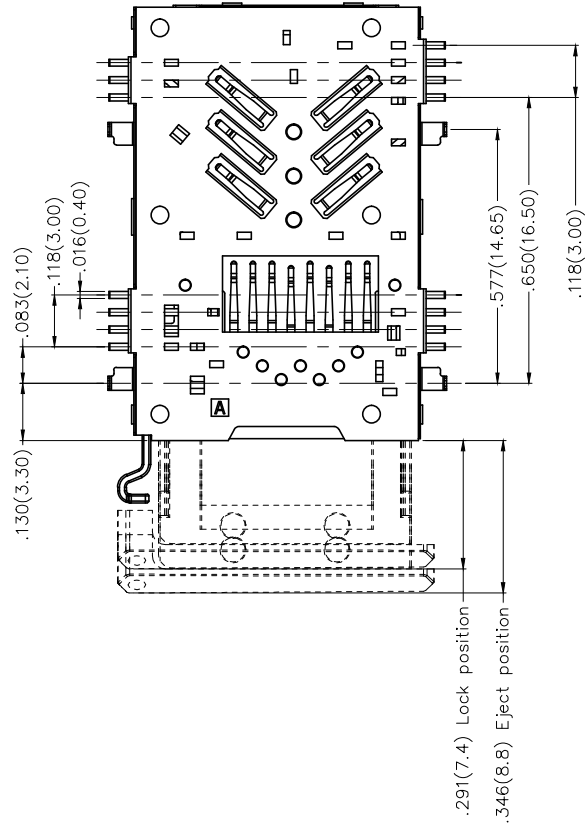
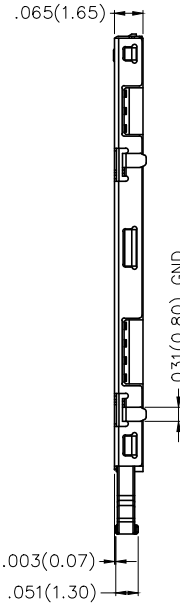
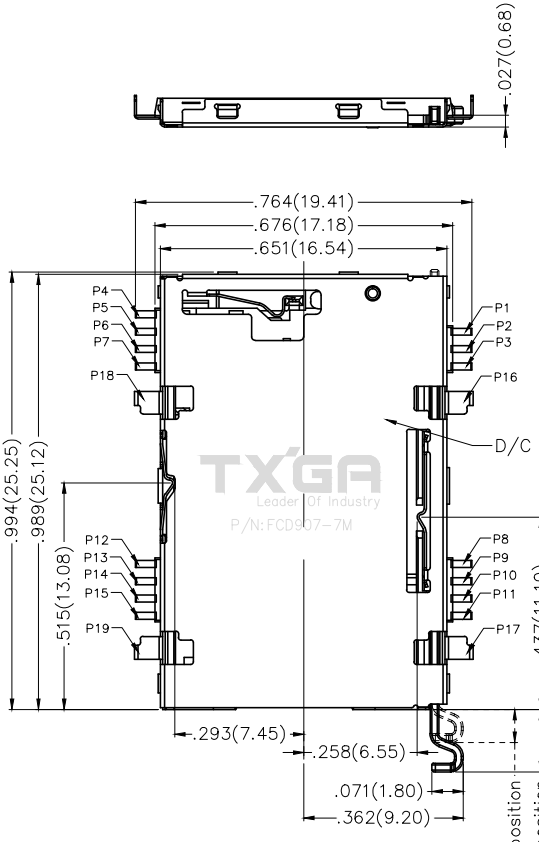
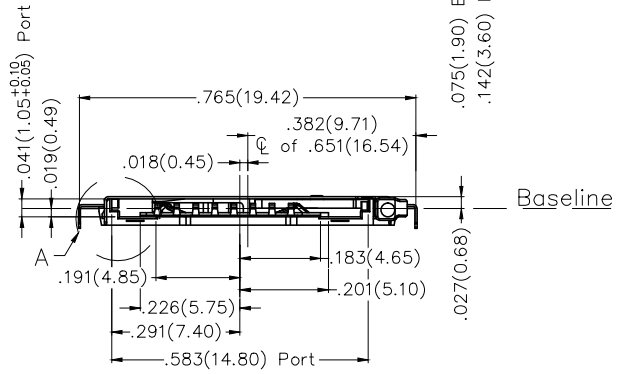

 THIRD ANGLE PROJECTION	GENERAL TOLERANCES (UNLESS SPECIFIED)		APPROVE BY FRANK	DATE 12/JUL/19	PART NO. FCD907-7M	ITEM NO. FCD907	 Leader Of Industry	
	X.±.012(0.30)	X'±5'	CHECKED BY CHERRY	DATE 12/JUL/19	TITLE Nano sim+Micro SD card connector (H=1.65mm)			
DESIGN UNITS Inch (metric)	X.X±.008(0.20)	.X'±2'	DRAWN BY KATE	DATE 12/JUL/19	THIS DRAWING CONTAINS INFORMATION THAT IS PROPRIETARY TO TXGA INDUSTRIAL ELECTRONICS(S.Z)CO.,LTD AND SHOULD NOT BE USED WITHOUT WRITTEN PERMISSION		REV 0	SHEET NO. 1/3
SCALE 5:1	SIZE A4	X.XX±.006(0.15)						
		X.XXX±.004(0.10)						

REV	LOCATIONS	DESCRIPTION	DATE	REVISER	APPD

SPECIFICATIONS

Electrical

Current Rating: 0.5A AC(rms)/DC
Voltage Rating: 100V AC(rms)/DC
Contact Resistance: 100 mΩ Max
Insulation Resistance: 1000 MΩ Min/DC 250V
Withstanding Voltage: 500V AC r.m.s
Temperature Range-Operating: -25°C~+85°C

Material

Housing: LCP (UL 94V-0) Black
Contact: Copper alloy
Shell: Stainless steel

Plating

Contact: 1μ" gold in contact area, gold flash in solder area,
Nickel plated overall
Shell: Nickel plated

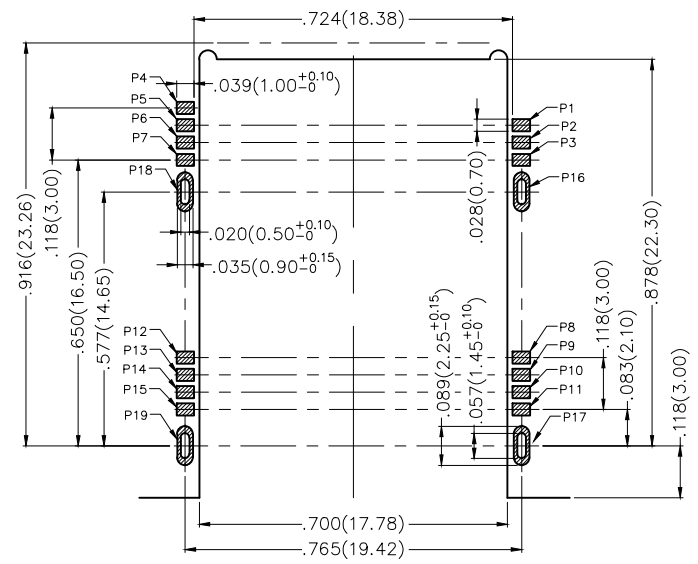

Keep out area
Pad area

Recommended P.C.Board Layout
General tolerances: ±.002(0.05)

PIN No.	FOR SPEC.	FUNCTION
1	Nano Sim C7	I/O
2	Nano Sim C6	VPP
3	Nano Sim C5	GND
4	None	CD FOR TRAY
5	Nano Sim C3	CLK
6	Nano Sim C2	RST
7	Nano Sim C1	VCC
8	MicroSD 1	DAT2
9	MicroSD 2	CD/DAT3
10	MicroSD 3	CMD
11	MicroSD 4	VDD
12	MicroSD 8	DAT1
13	MicroSD 7	DAT0
14	MicroSD 6	VSS
15	MicroSD 5	CLK
16	None	GND
17	None	GND
18	None	GND
19	None	GND

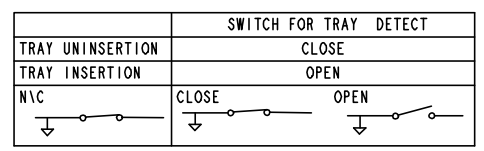

 THIRD ANGLE PROJECTION	GENERAL TOLERANCES (UNLESS SPECIFIED)		APPROVE BY	DATE	PART NO.	ITEM NO.	 Leader Of Industry
	X.±.012(0.30)	X.±5'	FRANK	12/JUL/19	FCD907-7M	FCD907	
DESIGN UNITS Inch (metric)	X.X±.008(0.20)	.X'±2'	CHECKED BY	DATE	TITLE		REV 0
SCALE	X.XX±.006(0.15)	.XX'±1'	CHERRY	12/JUL/19	Nano sim+Micro SD card connector (H=1.65mm)		SHEET NO. 2/3
5:1	X.XXX±.004(0.10)	.XXX'±0.5'	DRAWN BY	DATE	THIS DRAWING CONTAINS INFORMATION THAT IS PROPRIETARY TO TXGA INDUSTRIAL ELECTRONICS(S.Z)CO.,LTD AND SHOULD NOT BE USED WITHOUT WRITTEN PERMISSION		
SIZE A4			KATE	12/JUL/19			

REV	LOCATIONS	DESCRIPTION	DATE	REVISER	APPD

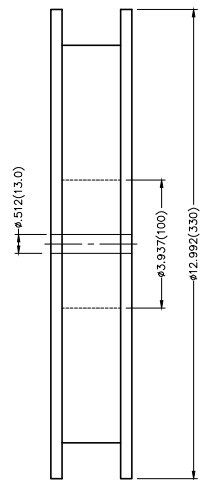
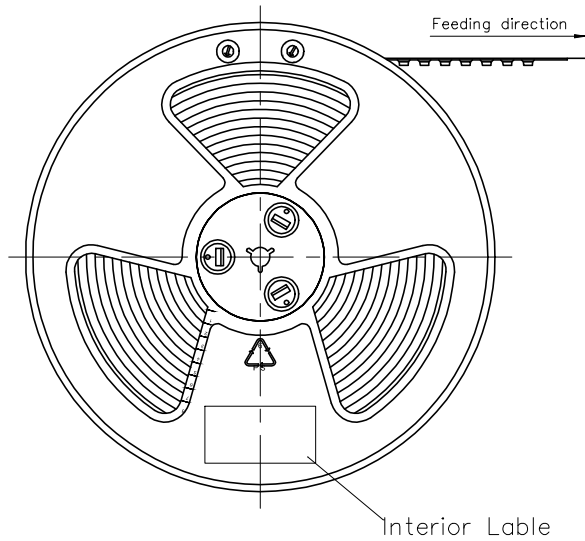

- Note:
- 10 sprocket hole cumulative tolerance ± 0.2
 - Carrier camber is within 1.0mm in 100mm
 - Material: White Conductive polystyrene Alloy 100% recyclable
 - All dimensions meet EIA-481-3 requirements
 - Component load per 13" reel: 750 pcs

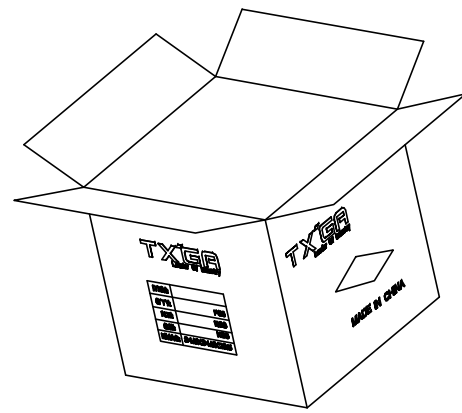
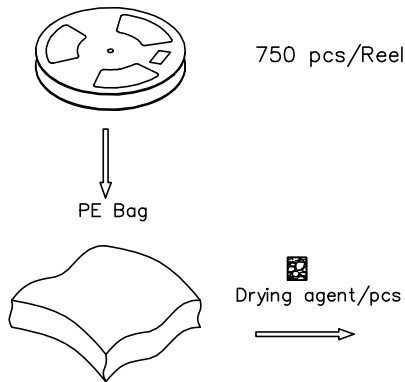
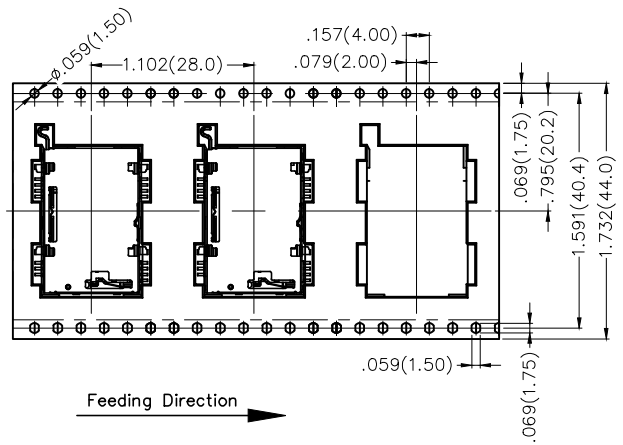
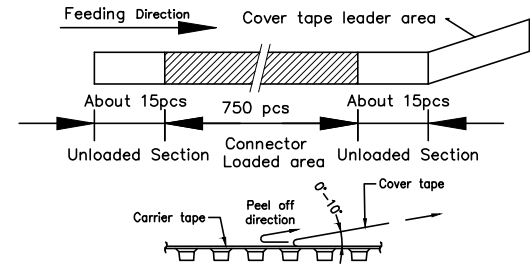

<p>THIRD ANGLE PROJECTION</p>	GENERAL TOLERANCES (UNLESS SPECIFIED)		APPROVE BY FRANK	DATE 12/JUL/19	PART NO. FCD907-7M	ITEM NO. FCD907	<p>Leader Of Industry</p>
	X.±.012(0.30)	X.'±5'	CHECKED BY CHERRY	DATE 12/JUL/19	TITLE Nano sim+Micro SD card connector (H=1.65mm)		
DESIGN UNITS Inch (metric)	X.X±.008(0.20)	X.'±2'	DRAWN BY KATE	DATE 12/JUL/19	THIS DRAWING CONTAINS INFORMATION THAT IS PROPRIETARY TO TXGA INDUSTRIAL ELECTRONICS(S.Z)CO.,LTD AND SHOULD NOT BE USED WITHOUT WRITTEN PERMISSION		
SCALE 5:1	SIZE A4	X.XX±.006(0.15)	X.'±1'				
		X.XXX±.004(0.10)	X.'±0.5'				