

REV	LOCATIONS	DESCRIPTION	DATE	REVISER	APPD
1	△	Size change	21/MAR/22	MATT	KATE

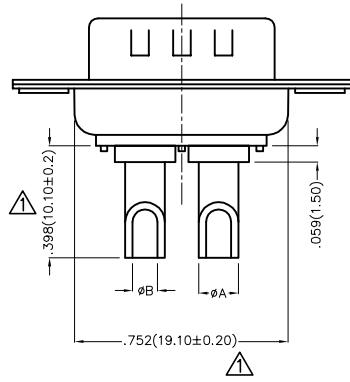
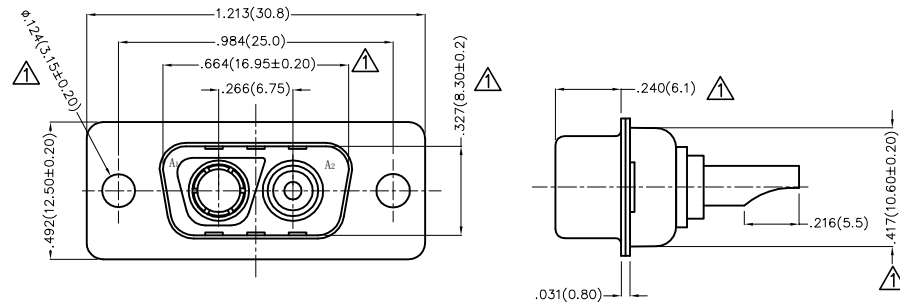

1. Electrical Characteristic

- 1.1 Current Characteristic  
Power Contacts: 10 to 40A
- 1.2 Voltage Rating: 500V
- 1.3 Contact Resistance: 30 Milliohms Max
- 1.4 Insulation Resistance: 3000 Megaohms Min.
- 1.5 Dielectric Withstanding Voltage : 1000V AC r.m.s Min

2. Materials And Finish

- 2.1 Shell: Steel Material, Front Nickel Plated 80u" Min  
Back Shell Tin Plated 100u" Min
- 2.2 Insulator: Glass Filled Thermoplastic, UL 94V-0 , Colour: Black
- 2.3 Power Contacts: Copper alloy/Gold Plated 1u~30u
- 3. Temperature Range-Operating: -55°C ~ +105°C

Type	Part NO.	A △	B △	Wire	Current Rating(A)
A	FDV0201-MOWS1XXK6KA	$\phi .102 (2.60)$	.071 (1.80)	14#~16#	10
B	FDV0201-MOWS1XXK6KB	$\phi .142 (3.60)$	.110 (2.80)	10#~12#	20
C	FDP0201-MOWS1XXK6KC	$\phi .177 (4.50)$	.138 (3.50)	8#~10#	30
D	FDP0201-MOWS1XXK6KD	$\phi .213 (5.40)$	.181 (4.60)	6#~8#	40

Ordering Information

FDV 02 01 — M0 W S 1 XX K6 K X  
 1 2 3 4 5 6 7 8 9 10 11

1	D-sub Connector Series Name FDV-Power Type	2	Circuits 02-2V2	3	Distinction No. 01	4	Type M0-Male	5	Assembly Layout W-Welding Type	6	Entry Type S-Top entry type
7	Plating 1-Gold Flash	8	Thickness of Plating 01-1u" 03-3u" 15-15u" 30-30u" .....	9	Plastic Colour K6-Black	10	Packaging K-Tray	11	Type A-Type A C-Type C B-Type B D-Type D		

<p>THIRD ANGLE PROJECTION</p>	GENERAL TOLERANCES (UNLESS SPECIFIED) X.±.012(0.30) X:±5' X.X±.008(0.20) .X:±2'		APPROVE BY FRANK	DATE 19/JUL/13	PART NO. FDV0201-MOWS1XXK6KX	ITEM NO. FDV0201-M	<p>Leader Of Industry</p>
	DESIGN UNITS Inch (metric)	X.XX±.006(0.15) .XX±1' X.XXX±.004(0.10) .XXX±0.5'	CHECKED BY CHERRY	DATE 19/JUL/13	TITLE POWER MACHINED CONTACT MALE 2V2 CONN		
SCALE 5:1	SIZE A4	DRAWN BY JACOB		DATE 19/JUL/13	THIS DRAWING CONTAINS INFORMATION THAT IS PROPRIETARY TO TXGA INDUSTRIAL ELECTRONICS(S.Z)CO.,LTD AND SHOULD NOT BE USED WITHOUT WRITTEN PERMISSION		