

1 2 3 4 5 6 7 8

REV	LOCATIONS	DESCRIPTION	DATE	REVISER	APPD

Notes:

Material: Brass  
 Insulator: PVC (UL 94V-0) Red  
 Plating: Matte tin plated  
 Wire range: 0.5~1.5mm<sup>2</sup>/ (22~16AWG)  
 Temperature Range-Operating: 0°C~75°C  
 Maximum electrical rating: 300V  
 Max current: 10A

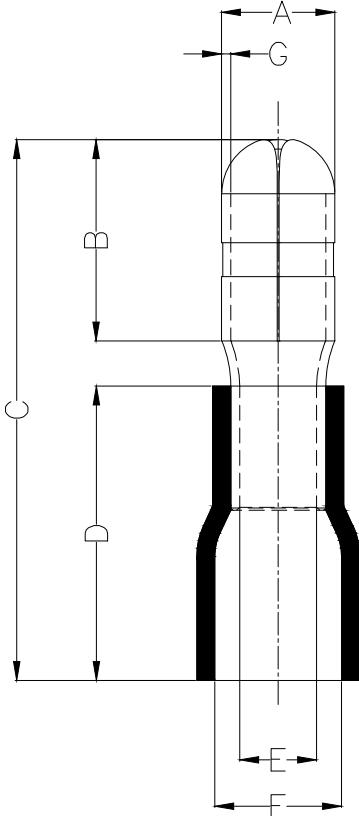

Dimensions						
A	B	C	D	E	F	G
±0.5	±1	±1	±1	±0.5	±0.5	±0.05
4.0	9.0	21.4	10.3	1.7	3.8	0.4

<p>THIRD ANGLE PROJECTION</p>	GENERAL TOLERANCES (UNLESS SPECIFIED)		APPROVE BY	DATE	PART NO.	ITEM NO.	<p>Building Technology Cornerstone</p>
	X. ±0.30	X.* ±5'	LEO	16/JAN/21	FBT01-M001250ARD2B	PBT01	
	X.X ±0.20	X.X' ±2'	CHECKED BY	DATE	TITLE		
	X.XX ±0.15	X.XX' ±1'	GISELLE	16/JAN/21	Bullet termina		
SCALE	SIZE	X.XXX ±0.10	X.XXX' ±0.5'	DRAWN BY	DATE	THIS DRAWING CONTAINS INFORMATION THAT IS PROPRIETARY TO TXGA INDUSTRIAL ELECTRONICS(S.Z)CO.,LTD AND SHOULD NOT BE USED WITHOUT WRITTEN PERMISSION	
5:1	A4			PYD	16/JAN/21	REV 0	SHEET NO. 1/1

1 2 3 4 5 6 7 8

A

B

C

D

E

F

A

B

C

D

E

F