

1 2 3 4 5 6 7 8

REV	LOCATIONS	DESCRIPTION	DATE	REVISER	APPD

A

B

C

D

E

F

Notes:

Material: Copper
 Plating: Matte tin plated
 Insulator: PVC (UL 94V-0)
 Wire range: 2.5~4mm² / (14~12AWG)
 Applicable screw: #8 UNC
 Temperature Range-Operating: 0°C~75°C
 Maximum electrical rating: 600V
 Max current: 37A

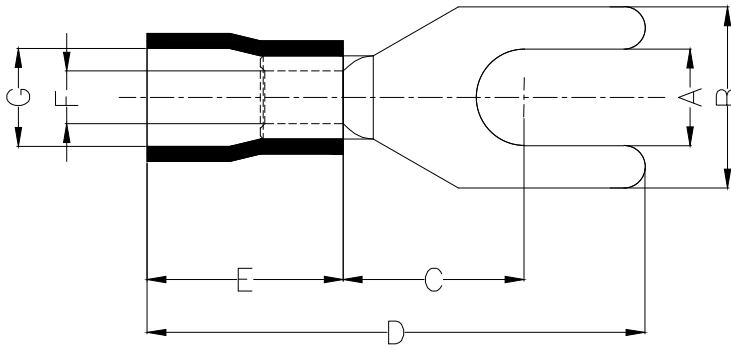
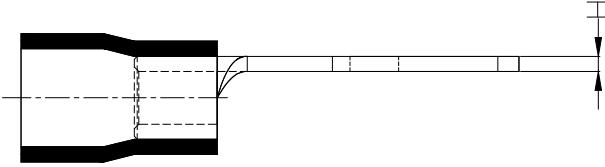

Dimensions							
A	B	C	D	E	F	G	H
±0.3	±0.5	±1	±1	±1	±0.5	±0.5	±0.05
4.3	7.2	7.7	25.5	13.0	2.9	6.2	1.0

PART NO.	Color Of Insulator
FYT02-00350040SARD2	Red
FYT02-00350040SABU2	Blue
FYT02-00350040SABK2	Black

<p>THIRD ANGLE PROJECTION</p>	GENERAL TOLERANCES (UNLESS SPECIFIED)		APPROVE BY	DATE
	X. ±0.30	X.* ±5'	LEO	10/JAN/21
	DESIGN UNITS METRIC(mm)	X.X ±0.20	CHECKED BY	DATE
	SCALE 5:1	X.XX ±0.15	GISELLE	10/JAN/21
	X.PYD ±0.10	X.XX' ±1'	DRAWN BY	DATE
	X.PYD' ±0.5'		PYD	10/JAN/21

PART NO.	ITEM NO.	<p>Building Technology Cornerstone</p>
FYT02-00350040SAXX2	FYT02	
TITLE		REV 0
Spade tongue terminal		SHEET NO. 1/1
THIS DRAWING CONTAINS INFORMATION THAT IS PROPRIETARY TO TXGA INDUSTRIAL ELECTRONICS(S.Z)CO.,LTD AND SHOULD NOT BE USED WITHOUT WRITTEN PERMISSION		

1 2 3 4 5 6 7 8