

1 2 3 4 5 6 7 8

REV	LOCATIONS	DESCRIPTION	DATE	REVISER	APPD

Notes:

Material: Copper
 Insulator: PVC (UL 94V-0) Blue
 Plating: Matte tin plated
 Wire range: 1.5~2.5mm² / (16~14AWG)
 Applicable screw: #8 UNC
 Temperature Range-Operating: 0°C~75°C
 Maximum electrical rating: 600V
 Max current: 27A

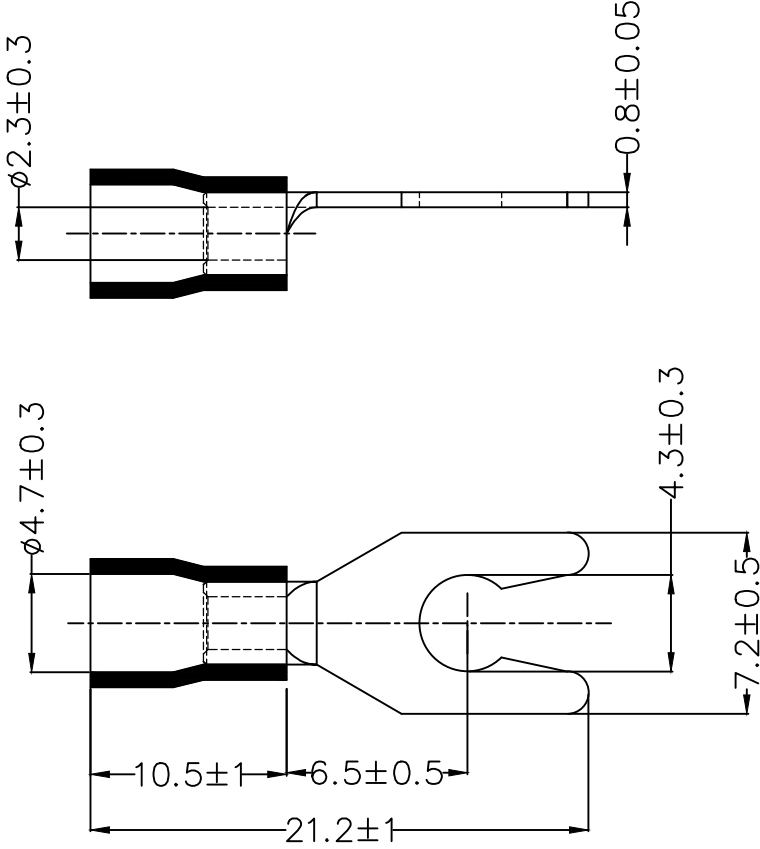

A

B

C

D

E

F

A

B

C

D

E

F

 THIRD ANGLE PROJECTION	GENERAL TOLERANCES (UNLESS SPECIFIED)		APPROVE BY	DATE	PART NO.	ITEM NO.	 Building Technology Cornerstone
	X. ± 0.30	X.' $\pm 5^\circ$	LEO	10/JAN/21	FYT05-002000400ABU2	FYT05	
DESIGN UNITS METRIC(mm)	X.X ± 0.20	X.X' $\pm 2^\circ$	CHECKED BY	DATE	TITLE		REV 0 SHEET NO. 1/1
SCALE 5:1 SIZE A4	X.XX ± 0.15	X.XX' $\pm 1^\circ$	GISELLE	10/JAN/21	Spade tongue terminal		
	X.PYD ± 0.10	X.PYD' $\pm 0.5^\circ$	DRAWN BY	DATE	THIS DRAWING CONTAINS INFORMATION THAT IS PROPRIETARY TO TXGA INDUSTRIAL ELECTRONICS(S.Z)CO.,LTD AND SHOULD NOT BE USED WITHOUT WRITTEN PERMISSION		
			PYD	10/JAN/21			

1 2 3 4 5 6 7 8