

REV	LOCATIONS	DESCRIPTION	DATE	REVISER	APPD
1	△	1. Size change 2. Structure change	01/APR/20	KATE	CHERRY

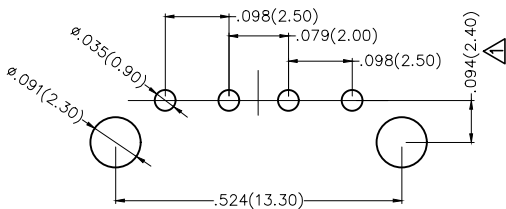
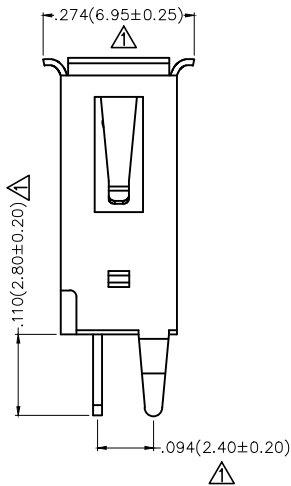
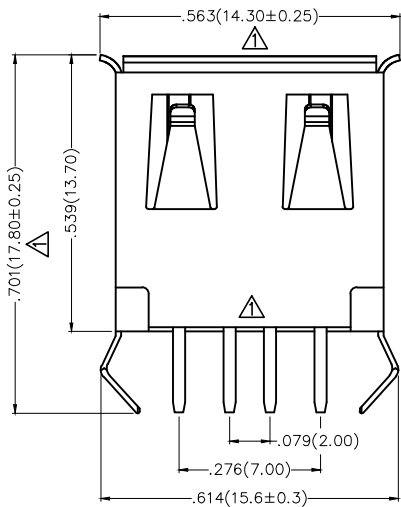
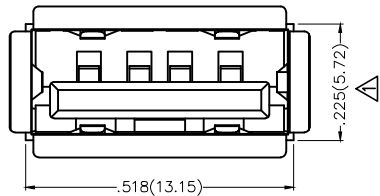

Recommended P.C.Board Layout

Electrical

Current Rating: 1.0A AC(rms)/DC
Voltage Rating: 30V AC(rms)/DC
Contact Resistance: 30 mΩ Max
Insulation Resistance: 1000 MΩ MIN
Withstanding Voltage: 500V AC r.m.s
Temperature Range—Operating: -40°C~+85°C

Material

Housing: PBT (UL 94V-0)
Contact: Copper alloy
Shell: Copper alloy

Plating

Contact: Gold in contact area, tin on tail
Shell: Nickel plated

Ordering Informaion

FUS 2 06 — F D S XX K
1 2 3 4 5 6 7 8

1	Category FUS-USB	2	Series Number 2-USB	3	Distinction No. 06	4	Type F-Female	5	Assembly Layout D-DIP
6	Entry Angle S-180° Vertical	7	Color-Resin K6-Black W3-White	8	Packaging K-Tray				

 THIRD ANGLE PROJECTION	GENERAL TOLERANCES (UNLESS SPECIFIED)		APPROVE BY FRANK	DATE 21/JUN/13	PART NO. FUS206-FDSXXK	ITEM NO. FUS206	 Leader Of Industry	
	DESIGN UNITS Inch (metric)	X.±.012(0.30) X.X±.008(0.20)	X.'±5' .X'±2'	CHECKED BY CHERRY	DATE 21/JUN/13	TITLE USB A-type 4Circuits 180°Vertical Female(DIP)		REV 1
SCALE 5:1	SIZE A4	X.XX±.006(0.15) X.XXX±.004(0.10)	.XX'±1' .XXX'±0.5'	DRAWN BY JACOB	DATE 21/JUN/13	THIS DRAWING CONTAINS INFORMATION THAT IS PROPRIETARY TO TXGA INDUSTRIAL ELECTRONICS(S.Z)CO.,LTD AND SHOULD NOT BE USED WITHOUT WRITTEN PERMISSION		