

1	2	3	4	5	6	7	8			
Pin No. Coded	4PIN				REV 0	LOCATIONS	DESCRIPTION New Release	DATE 4/DEC	REVISER	APPD FRANK

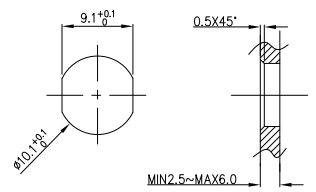

Note:  
 1. Ⓞ Important Dimension  
 2. Waterproof Rate: IP68  
 3. This product must meet IEC61076-2-114  
 4. This product must meet 2011/65/EU ROHS compliance.  
 5. Not note tolerances: ±0.20

Recommended Panel Cut-Out

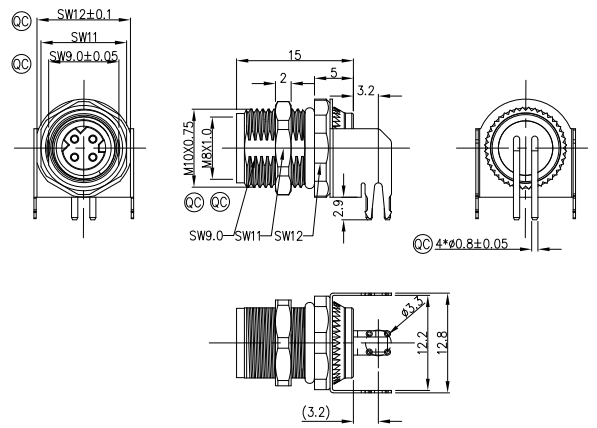

PCB Layout Thickness of PCB: ≤1.75mm

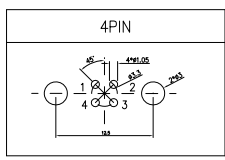

Ordering Information

F002M8 - S D 04 P R D 1 - 00  
 1 2 3 4 5 6 7 8 9

1 Series Name F002M8-FM8 2 Category S-socket 3 Coded D-D CODED 4 Circuits 04-4Circuits 5 Contact P-Plug

6 Entry Angle R-90° Angle 7 Wiring type D-Through Hole 8 Shield 1-with shield 9 SN 00

Connector locking system	Screw
Wiring type	Through Hole
Degree of protection	IP68(in mated condition)
Mechanical operation	> 100 mating cycles
Upper temperature	105°C
Lower temperature	-40°C
Pollution degree	3
Overvoltage categorie	II
Material group	II
Material of contact	CuZn (Messing/brass)
Contact plating	Au
Material of contact body	PA
Sealing	NBR
Material of housing	Brass nickel plated

Pin Assignments Front View	Rated Voltage	Rated impulse Voltage	Rated Currnt(40°C)	Contact resistance	Insulation resistance
	63V	1500V	4A	≤5mΩ	≥100MΩ

 THIRD ANGLE PROJECTION DESIGN UNITS Metric SCALE 2:1 SIZE A4	GENERAL TOLERANCES (UNLESS SPECIFIED)		APPROVE BY FRANK	DATE 4/DEC/23	PART NO. F002M8-SD04PRD1-00	ITEM NO. F002M8	 Building Technology Cornerstone REV 0 SHEET NO. 1/1
	X.±.012(0.30)	.X'±5'	CHECKED BY CHERRY	DATE 4/DEC/23	TITLE M8X1.0 D Coded female socket 90°【THT】 front fastened M10X0.75 with shield		
	X.XX±.008(0.20)	.X'±2'	DRAWN BY DANIEL	DATE 4/DEC/23	THIS DRAWING CONTAINS INFORMATION THAT IS PROPRIETARY TO TXGA INDUSTRIAL ELECTRONICS(S,Z)CO.,LTD AND SHOULD NOT BE USED WITHOUT WRITTEN PERMISSION		
	X.XX±.006(0.15)	.XX'±1'					
X.XXX±.004(0.10)	.XXX'±0.5'						