

Pin No. Coded	4PIN
D-Coded	

REV	LOCATIONS	DESCRIPTION	DATE	REVISER	APPD
0		New Release	4/DEC		FRANK

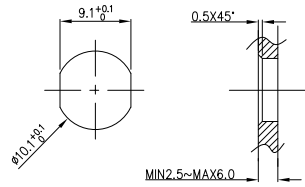

Recommended Panel Cut-Out

- Note:
- ◎ Important Dimension
 - Waterproof Rate: IP68
 - This product must meet IEC61076-2-114
 - This product must meet 2011/65/EU ROHS compliance.
 - Not note tolerances: ±0.20

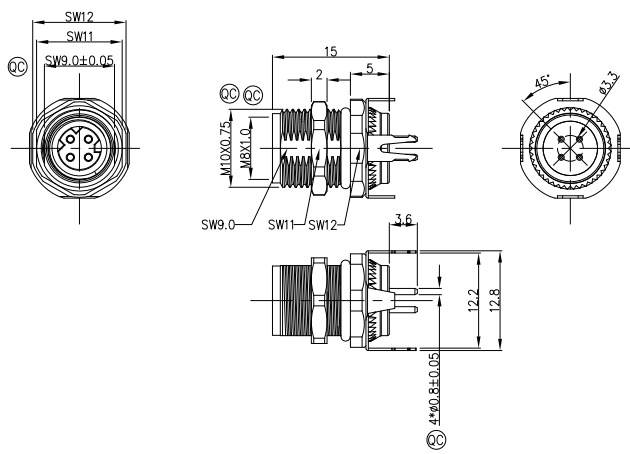

PCB Layout Thickness of PCB: ≤1.75mm

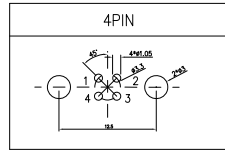

Connector locking system	Screw
Wiring type	Through Hole
Degree of protection	IP68(in mated condition)
Mechanical operation	> 100 mating cycles
Upper temperature	105°C
Lower temperature	-40°C
Pollution degree	3
Overvoltage categorie	II
Material group	II
Material of contact	CuZn (Messing/brass)
Contact plating	Au
Material of contact body	PA
Sealing	NBR
Material of housing	Brass nickel plated

Ordering Information

F002M8 - S D 04 P S 1 0 - XX
 1 2 3 4 5 6 7 8 9

1 Series Name - 2 Category - 3 Coded - 4 Circuits - 5 Contact
 F002M8-FM8 - S-Socket - D-D CODED - 04-4Circuits - P-Plug

6 Entry Angle - 7 Shield - 8 reserve - 9 SN
 S-180° Vertical - 1-with shield - 0 - 00

Pin Assignments Front View	Rated Voltage	Rated impulse Voltage	Rated Currnt(40°C)	Contact resistance	Insulation resistance
	63V	1500V	4A	≤5mΩ	≥100MΩ

 THIRD ANGLE PROJECTION DESIGN UNITS Inch (metric) SCALE 2:1 SIZE A4	GENERAL TOLERANCES (UNLESS SPECIFIED)		APPROVE BY	DATE	PART NO.	ITEM NO.	 Building Technology Cornerstone REV 0 SHEET NO. 1/1
	X.±.012(0.30)	X.±5°	FRANK	4/DEC/23	F002M8-SD04PS10-00	F002M8	
	X.X±.008(0.20)	.X'±2°	CHECKED BY	DATE	TITLE		
	X.XX±.006(0.15)	.XX±1°	CHERRY	4/DEC/23	M8X1.0 D Coded female socket 180° [THT] front fastened M10X0.75 with shield		
X.XXX±.004(0.10)	.XXX±0.5°	DRAWN BY	DATE	THIS DRAWING CONTAINS INFORMATION THAT IS PROPRIETARY TO TXGA INDUSTRIAL ELECTRONICS(S,Z)CO.,LTD AND SHOULD NOT BE USED WITHOUT WRITTEN PERMISSION			
		DANIEL	4/DEC/23				