

1 2 3 4 5 6 7 8

REV	LOCATIONS	DESCRIPTION	DATE	REVISER	APPD
1	△	Update structural dimensions and tolerances Update marking	26/JAN/26	MATT	LEO

SPECIFICATIONS

Electrical  
 Current Rating: 75A  
 Voltage Rating: 1000V AC  
 Contact Resistance: 1mΩ Max  
 Insulation Resistance: 3000 MΩ Min.  
 Withstanding Voltage: 3000V AC  
 Temperature Range—Operating: -55°C~+125°C

Mechanical  
 Durability: 500 Cycles

Material and Plating  
 Housing: PBT (UL 94V-0) ,Black  
 Pawl spring: Beryllium copper

Applicable contact socket: FOCLCT-05004120-01

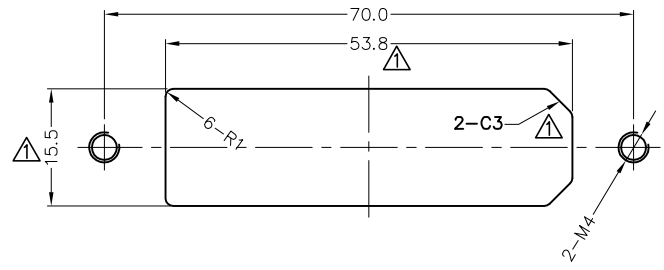
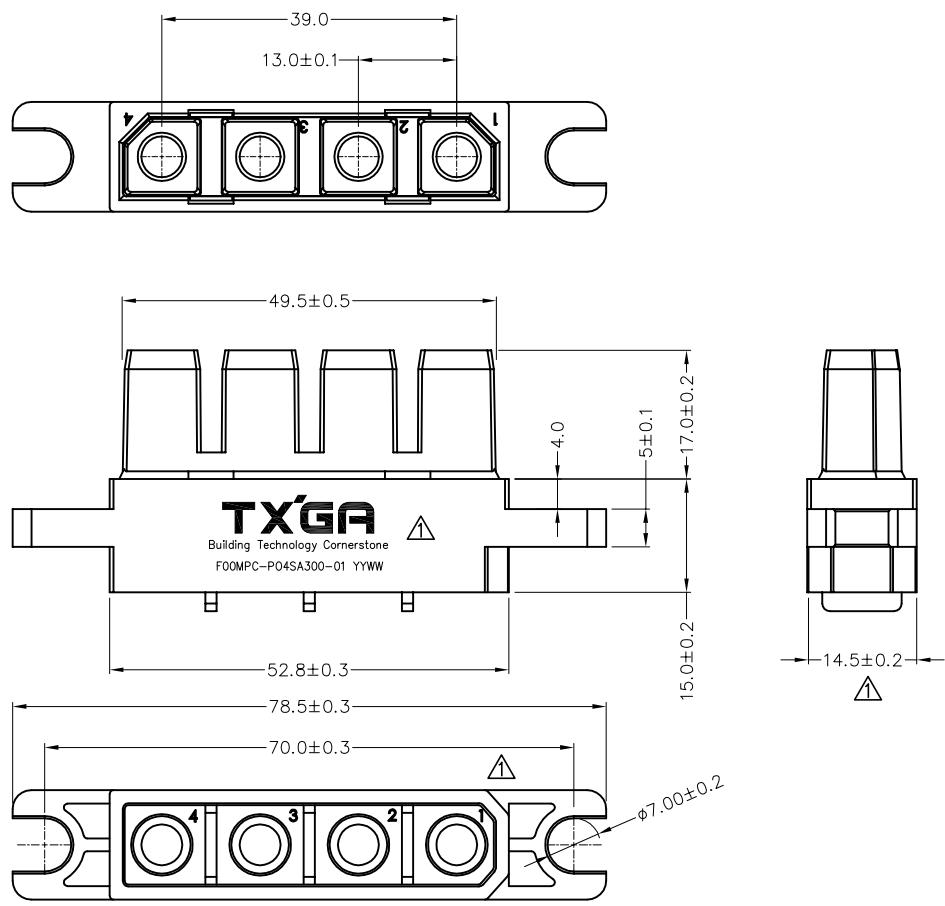

Recommended Panel Cut Out

The view direction is the surface for inserting components and the 1 # hole is on the right side

 THIRD ANGLE PROJECTION	GENERAL TOLERANCES (UNLESS SPECIFIED)		APPROVE BY	DATE	PART NO.	ITEM NO.	 Building Technology Cornerstone
	X. ±0.30	X.* ±5°	FRANK	27/AUG/21	F00MPC-P04SA300-01	F00MPC	
DESIGN UNITS Metric	X.X ±0.20	X.X* ±2°	CHECKED BY	DATE	TITLE		REV 1    SHEET NO. 1/1
SCALE 1:1    SIZE A4	X.XX ±0.15	X.XX* ±1°	CHERRY	27/AUG/21	Charging Pile Module Power Connector AC 30KW 4Circuits Plug		
	X.XXX ±0.10	X.XXX* ±0.5°	DRAWN BY	DATE	THIS DRAWING CONTAINS INFORMATION THAT IS PROPRIETARY TO TXGA INDUSTRIAL ELECTRONICS(S.Z)CO.,LTD AND SHOULD NOT BE USED WITHOUT WRITTEN PERMISSION		
			MATT	27/AUG/21			

1 2 3 4 5 6 7 8