

| REV | LOCATIONS | DESCRIPTION | DATE | REVISER | APPD |
|-----|-----------|-------------|------|---------|------|
| | | | | | |

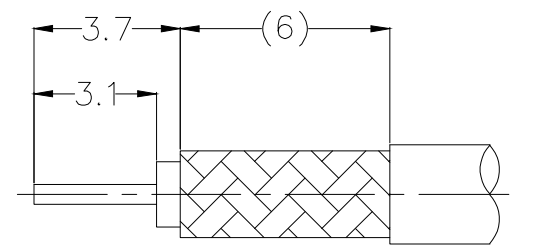
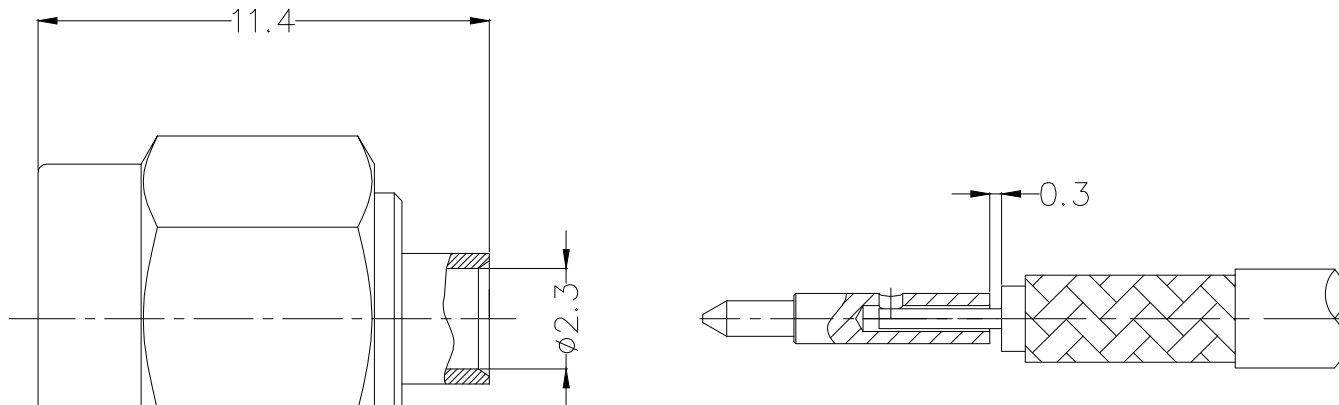

Recommended cable stripping dimension

SPECIFICATION

Technical Parameters

- Temperature range: -45~+125°C;
- Characteristic impedance: 50Ω;
- Frequency range: DC~18GHz;
- Dielectric withstanding voltage: 500V rms;
- Insulation resistance: ≥1000MΩ;
- VSWR: ≤1.2(DC~6GHz)

Mechanical

- Durability: 500 cycles
- Salt spray: 96h

Material and Plating

- Insulators: PTFE(UL 94V-0), White
- Contact: Brass, 0.1μm Gold plated
- Body: Brass, 0.06μm Gold plated
- Nut: Brass, 0.06μm Gold plated

Hex. 8

| | | | | | | | | | |
|-------------------------------|---------------------------------------|-------------|--------------|------------|--------------------|---|--|--|---------------|
| <p>THIRD ANGLE PROJECTION</p> | GENERAL TOLERANCES (UNLESS SPECIFIED) | | APPROVE BY | DATE | PART NO. | ITEM NO. | <p>Building Technology Cornerstone</p> | | |
| | X. ±0.30 | X.* ±5' | LEO | 04/JAN/22 | F00SMA-P50P0SSP-05 | F00SMA | | | |
| | DESIGN UNITS | X.X ±0.20 | X.X' ±2' | CHECKED BY | DATE | TITLE | | REV 0 | SHEET NO. 1/1 |
| | mm | X.XX ±0.15 | X.XX' ±1' | GISELLE | 04/JAN/22 | SMA Plug 180°Vertical For RG405&.086 cable | | THIS DRAWING CONTAINS INFORMATION THAT IS PROPRIETARY TO TXGA INDUSTRIAL ELECTRONICS(S.Z)CO.,LTD AND SHOULD NOT BE USED WITHOUT WRITTEN PERMISSION | |
| SCALE | SIZE | X.XXX ±0.10 | X.XXX' ±0.5' | DRAWN BY | DATE | | | | |
| 5:1 | A4 | | | PYD | 04/JAN/22 | | | | |