

REV	LOCATIONS	DESCRIPTION	DATE	REVISER	APPD

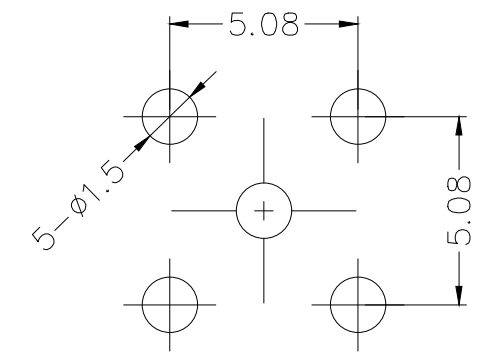
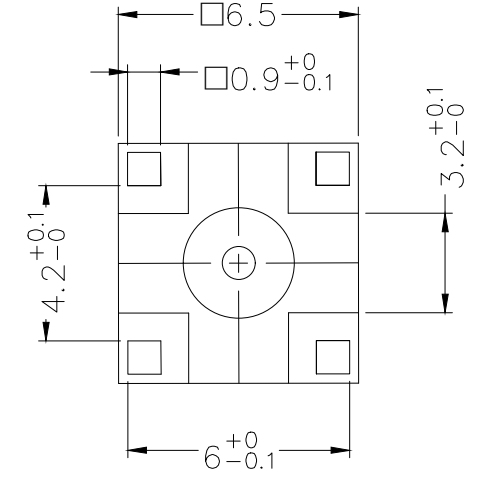
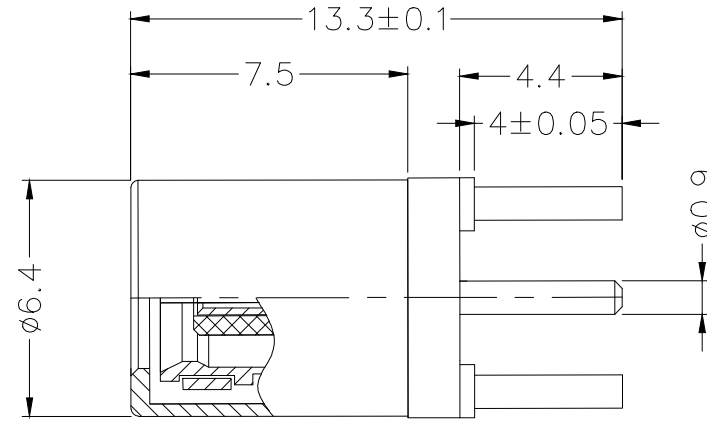

Recommended P.C.Board Layout

SPECIFICATION

Technical Parameters

- Temperature range:  $-40\sim+125^{\circ}\text{C}$ ;
- Characteristic impedance:  $50\Omega$ ;
- Ferquency range:  $\text{DC}\sim 4\text{GHz}$ ;
- Voltage Rating:  $350\text{V rms}$ ;
- Dielectric withstanding voltage:  $750\text{V rms}$ ;
- Insulation resistance:  $\geq 1000\text{M}\Omega$ ;
- VSWR:  $\leq 1.2(\text{DC}\sim 4\text{GHz})$
- Inner Conductor Contact Resistance:  $5\text{m}\Omega \text{ MAX}$ ;
- Outer Conductor Contact Resistance:  $2.5\text{m}\Omega \text{ MAX}$ ;
- Insertion Loss:  $\leq 0.15\text{dB}$

Mechanical

Durability: 500 cycles

Material and Plating

- Insulators: PTFE(UL 94V-0),White
- Contact: Phosphor Bronze,  $1\mu$ ” Gold plated
- Body: Brass,  $1\mu$ ” Gold plated

 THIRD ANGLE PROJECTION	GENERAL TOLERANCES (UNLESS SPECIFIED)		APPROVE BY	DATE	PART NO.	ITEM NO.	 Building Technology Cornerstone
	X. $\pm 0.30$	X.' $\pm 5^{\circ}$	CHECKED BY	DATE	TITLE	REV 0	
	X.X $\pm 0.20$	X.X' $\pm 2^{\circ}$	GISELLE	04/JAN/22	SMB Plug 180°Vertical For PCB Through Hole	SHEET NO. 1/1	
	X.XX $\pm 0.15$	X.XX' $\pm 1^{\circ}$	DRAWN BY	DATE	THIS DRAWING CONTAINS INFORMATION THAT IS PROPRIETARY TO TXGA INDUSTRIAL ELECTRONICS(S.Z)CO.,LTD AND SHOULD NOT BE USED WITHOUT WRITTEN PERMISSION		
SCALE	SIZE	X.XXX $\pm 0.10$	X.XXX' $\pm 0.5^{\circ}$	PYD	04/JAN/22		
5:1	A4						