

REV	LOCATIONS	DESCRIPTION	DATE	REVISER	APPD

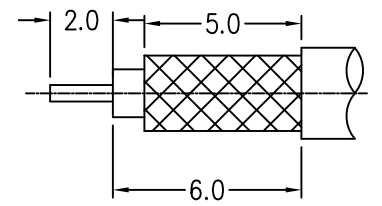
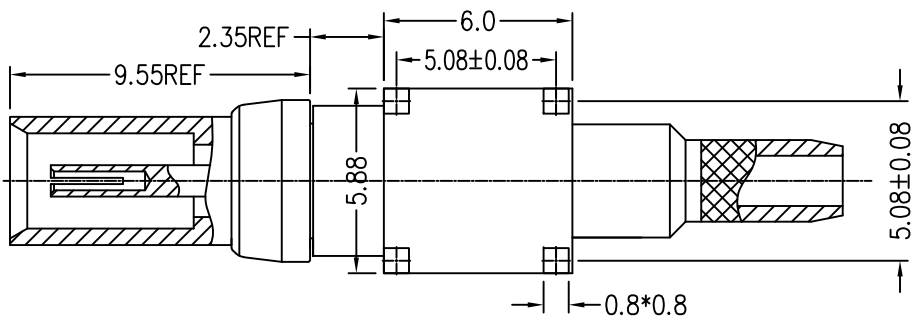
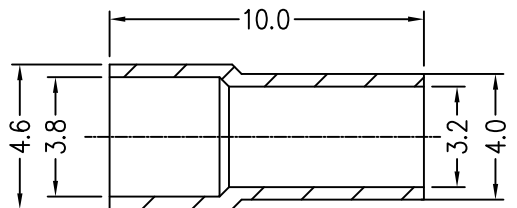
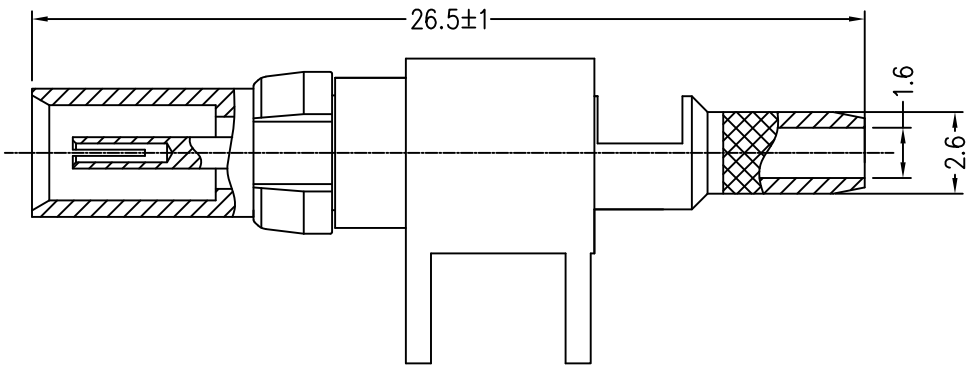
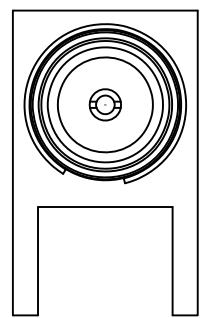
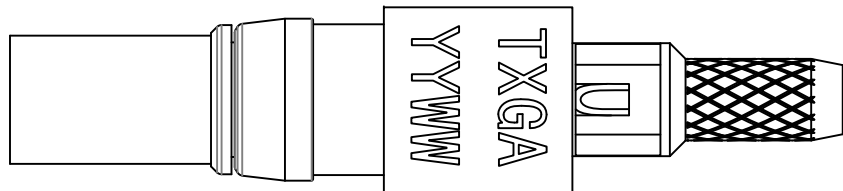

RECOMMENDED CABLE STRIPPING DIMENSIONS

**SPECIFICATIONS**

Technical Parameters  
 Impedance: 50Ω  
 Frequency range: DC 0~4GHz  
 Dielectric withstand voltage: 500V r.m.s Sea Level  
 Temperature Range-Operating: -45°C~+85°C  
 Insulation resistance: ≥1000MΩ;  
 Mechanical  
 Durability: 500 cycles

Material and Plating  
 Body assembly: Brass, Gold plated  
 Contact: Beryllum bronze, Gold plated  
 Insulator: PTFE (UL 94V-0), White  
 Tube: Brass, Gold plated  
 C-Ring: Beryllum bronze Nickel plated

<p>THIRD ANGLE PROJECTION</p>	GENERAL TOLERANCES (UNLESS SPECIFIED)		APPROVE BY	DATE	PART NO.	ITEM NO.	<p>Building Technology Cornerstone</p>
	X. ±0.30	X.' ±5'	FRANK	18/MAR/25	F01023-S50S0B0D-02	F01023	
	DESIGN UNITS	X.X ±0.20	X.X' ±2'	CHECKED BY	DATE	TITLE	
	Metric	X.XX ±0.15	X.XX' ±1'	CHERRY	18/MAR/25	RF / Coaxial Connectors DIN 41626 1.0/2.3 For RG316	
SCALE	SIZE	X.XXX ±0.10	X.XXX' ±0.5'	DRAWN BY	DATE	THIS DRAWING CONTAINS INFORMATION THAT IS PROPRIETARY TO TXGA INDUSTRIAL ELECTRONICS(S.Z)CO.,LTD AND SHOULD NOT BE USED WITHOUT WRITTEN PERMISSION	
1:1	A4			HUANG	18/MAR/25	REV 0	SHEET NO. 1/1