

REV	LOCATIONS	DESCRIPTION	DATE	REVISER	APPD
1		Dimensions change	24/JUN/22	KATE	CHERRY
2		Correct the structure	02/DEC/24	MATT	LEO

SPECIFICATIONS

Electrical

Current Rating: 1.0A
Voltage Rating: 300V AC(rms)
Contact Resistance: 12.5 mΩ Max.
Insulation Resistance: 5000 MΩ Min.
Withstanding Voltage: 1000V AC r.m.s
Temperature Range—Operating: -65°C~+125°C

Mechanical

Durability: 500 Cycles
Vibration: Frequency 10Hz~2000Hz, Acceleration 147m/s², Discontinuity 1μs Max.
Shock: Peak acceleration 980m/s², Discontinuity 1μs Max.
Material and Plating
Housing: Thermoplastic (UL 94V-0) ,Green
Terminal: Brass/ Gold Plated

Ordering Information

FOJL24 — P XX S W 000 — 01
 1 2 3 4 5

1 | Category | 2 | Type | 3 | Circuits | 4 | Entry Angle | 5 | Wiring Type
FOJL24—JL24 | P—Plug | XX | S—180° Vertical | W—Soldering

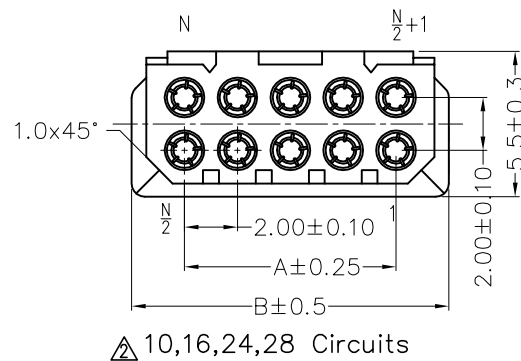
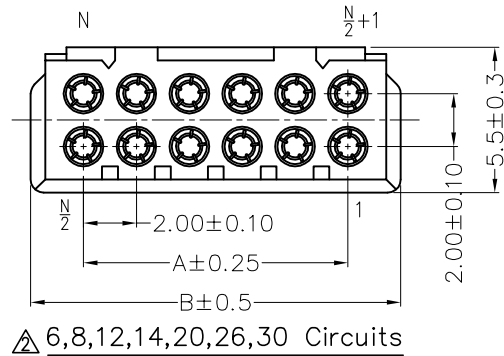
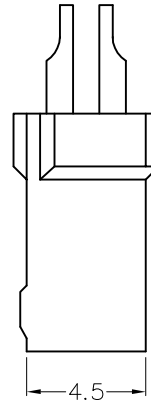
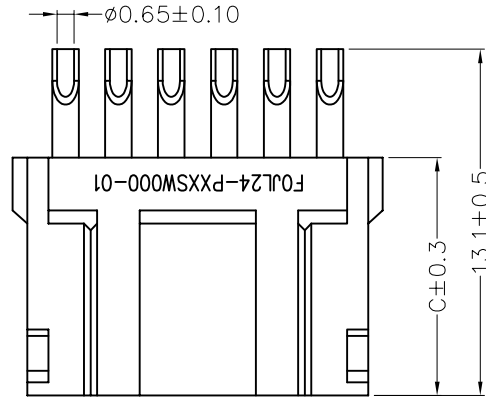

Circuits (n)	Part No.	Dimensions			Circuits (n)	Part No.	Dimensions		
		A	B	C			A	B	C
6	FOJL24-P06SW000-01	4.00	8.00	9.0	20	FOJL24-P20SW000-01	18.00	22.00	9.0
8	FOJL24-P08SW000-01	6.00	10.00	9.0	22	FOJL24-P22SW000-01	20.00	24.00	9.0
10	FOJL24-P10SW000-01	8.00	12.00	9.0	24	FOJL24-P24SW000-01	22.00	26.00	9.0
12	FOJL24-P12SW000-01	10.00	14.00	9.0	26	FOJL24-P26SW000-01	24.00	28.00	9.0
14	FOJL24-P14SW000-01	12.00	16.00	9.0	28	FOJL24-P28SW000-01	26.00	30.00	9.0
16	FOJL24-P16SW000-01	14.00	18.00	9.0	30	FOJL24-P30SW000-01	28.00	32.00	9.0
18	FOJL24-P18SW000-01	16.00	20.00	9.0					

	GENERAL TOLERANCES (UNLESS SPECIFIED)		APPROVE BY	DATE	PART NO.	ITEM NO.	
			FRANK	23/JUL/21			
DESIGN UNITS Metric	X. ±0.30	X.* ±5°	CHECKED BY	DATE	TITLE		REV 2
	X.X ±0.20	X.X* ±2°	CHERRY	23/JUL/21	JL24 Series Connector Pitch 2mm 180° Vertical		
SCALE 1:1	SIZE A4	X.XX ±0.15	X.XX* ±1°	DRAWN BY	DATE	THIS DRAWING CONTAINS INFORMATION THAT IS PROPRIETARY TO TXGA INDUSTRIAL ELECTRONICS(S.Z)CO.,LTD AND SHOULD NOT BE USED WITHOUT WRITTEN PERMISSION	
		X.XXX ±0.10	X.XXX* ±0.5°	KATE	23/JUL/21		