

REV	LOCATIONS	DESCRIPTION	DATE	REVISER	APPD

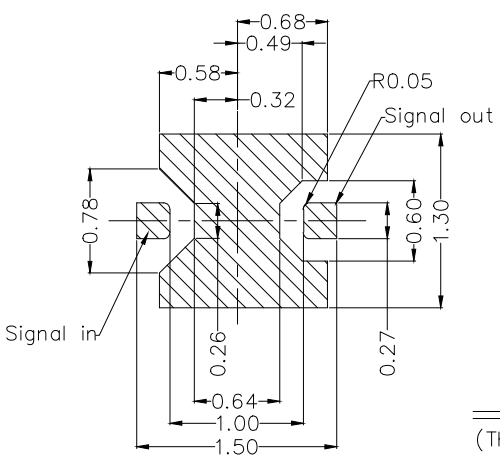

Recommended Footprint Pattern
Tolerance ±0.02mm

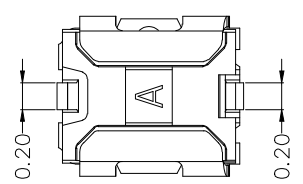
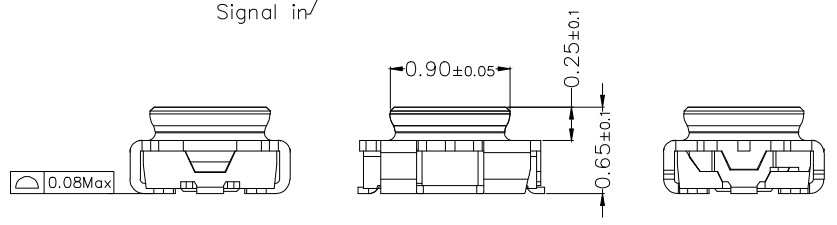
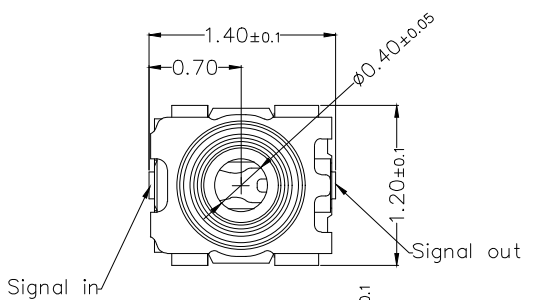
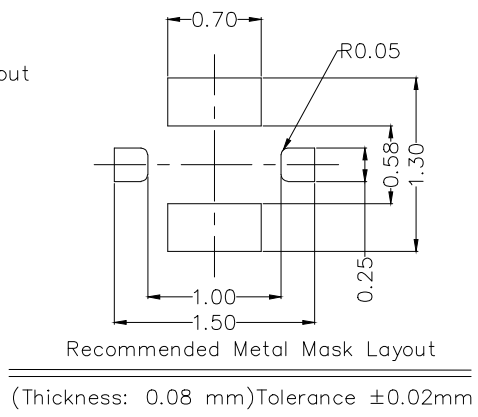

Recommended Metal Mask Layout
(Thickness: 0.08 mm) Tolerance ±0.02mm

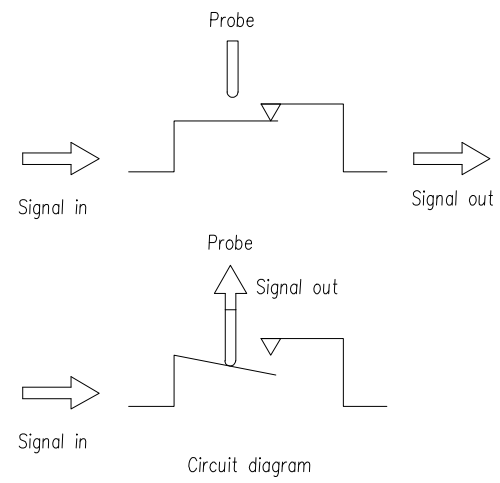

SPECIFICATION:

Electrical

Voltage Rating: 30V AC/DC
 Impedance: 50Ω
 Power Rating: 2W
 Contact Resistance: Signal Pin 100 mΩ Max; Shell 50 mΩ Max
 Insulation Resistance: 300MΩ Min Initial, 100MΩ Min After Test
 Dielectric Withstanding Voltage: 100V AC For One Minute
 VSWR: 1.2 Max At DC~3 GHz;
 1.3 Max At 3~6 GHz;
 1.5 Max At 6~11 GHz
 Insertion Loss: -0.1 dB Max At DC~3 GHz;
 -0.2 dB Max At 3~6 GHz;
 -0.4 dB Max At 6~11 GHz
 Isolation: -20 dB Min At DC~3 GHz;
 -15 dB Min At 3~6 GHz;
 -10 dB Min At 6~11 GHz
 Operating Temperature Range: -40°C ~ +85°C
 Durability: 30 mating cycles
 IR Reflow Cycles: 2 Cycles Max

Material and Plating

Insulator: LCP(UL 94V-0), Black
 Signal Pin: Stainless Steel,
 Contact Areas: 4 μ" Min Gold Plating.
 Solder Tails: 2 μ" Min Gold Plating.
 Underplate: 50 ~ 150 μ" Nickel Plating.
 Grounding Shell: Copper Alloy,
 Overall: 30 ~ 150 μ" Nickel Plating.
 Solder Tails Only: 1 μ" Min Gold Plating.

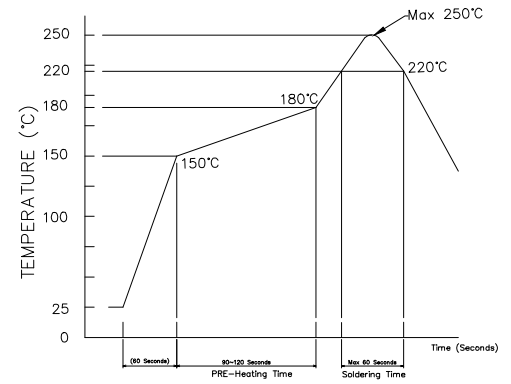

RECOMMENDED REFLOW TEMPERATURE PROFILE
USIN LEAD-FREE SOLDER PASTE

 THIRD ANGLE PROJECTION DESIGN UNITS mm SCALE 5:1 SIZE A4	GENERAL TOLERANCES (UNLESS SPECIFIED)		APPROVE BY	DATE	PART NO.	ITEM NO.	 Building Technology Cornerstone
	X. ±0.30	X.* ±5'	LEO	30/JAN/23	FOMCRF-J50S0S0S-02	FOMCRF	
	X.X ±0.20	X.X' ±2'	CHECKED BY	DATE	TITLE	MCRF 6rd Switch Coaxial Socket φ0.9mm(HO.65) SMT	REV 0 SHEET NO. 1/2
	X.XX ±0.15	X.XX' ±1'	GISELLE	30/JAN/23	THIS DRAWING CONTAINS INFORMATION THAT IS PROPRIETARY TO TXGA INDUSTRIAL ELECTRONICS(S.Z)CO.,LTD AND SHOULD NOT BE USED WITHOUT WRITTEN PERMISSION		
	X.XXX ±0.10	X.XXX' ±0.5'	DRAWN BY	DATE			
			PYD	30/JAN/23			

REV	LOCATIONS	DESCRIPTION	DATE	REVISER	APPD

Note:
 1.10 sprocket hole cumulative tolerance±0.2
 2.Carrier camber is within 1.0mm in 250mm
 3.Material: White conductive polystyrene Alloy 100% recyclable
 4.All dimensions meet EIA-481-3 requirements
 5.Peel off force of cover tape & carrier tape: 20g~130g (0.2N~1.3N)
 6.Component load per 13" reel: See table

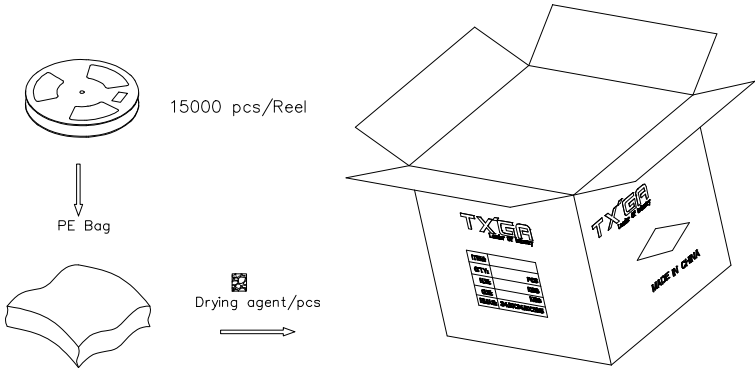
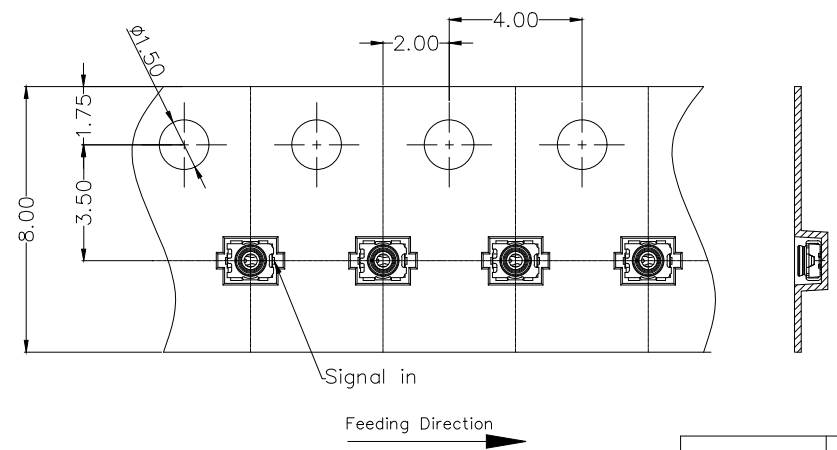
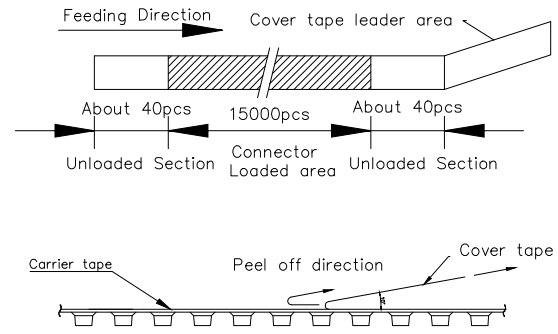
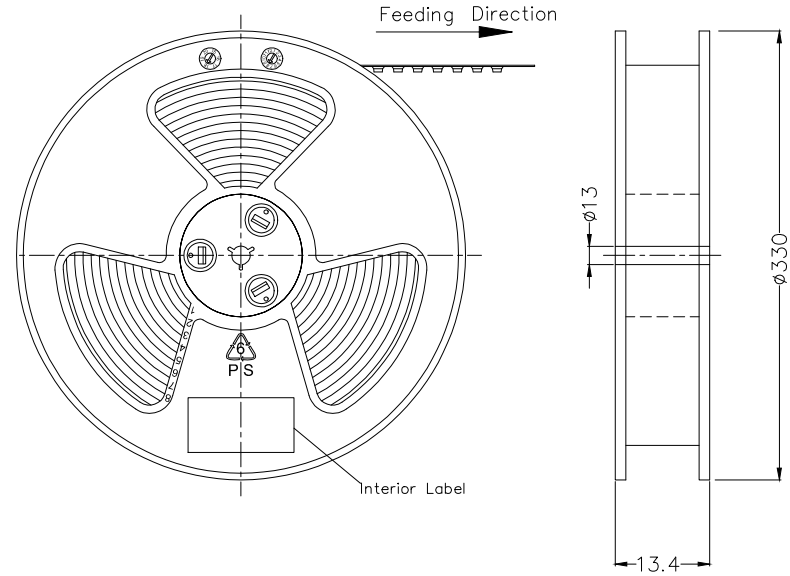

<p>THIRD ANGLE PROJECTION</p>	GENERAL TOLERANCES (UNLESS SPECIFIED)		APPROVE BY	DATE	PART NO.	ITEM NO.	<p>Building Technology Cornerstone</p>
	X. ±0.30	X.* ±5'	LEO	30/JAN/23	FOMCRF-J50S0S0S-02	FOMCRF	
	DESIGN UNITS	X.X ±0.20	X.X' ±2'	CHECKED BY	DATE	TITLE	REV 0 SHEET NO. 2/2
	mm	X.XX ±0.15	X.XX' ±1'	GISELLE	30/JAN/23	MCRF 6rd Switch Coaxial Socket ø0.9mm(HO.65) SMT	
SCALE	SIZE	X.XXX ±0.10	X.XXX' ±0.5'	DRAWN BY	DATE	THIS DRAWING CONTAINS INFORMATION THAT IS PROPRIETARY TO TXGA INDUSTRIAL ELECTRONICS(S.Z)CO.,LTD AND SHOULD NOT BE USED WITHOUT WRITTEN PERMISSION	
5:1	A4			PYD	30/JAN/23		