

REV	LOCATIONS	DESCRIPTION	DATE	REVISER	APPD

A

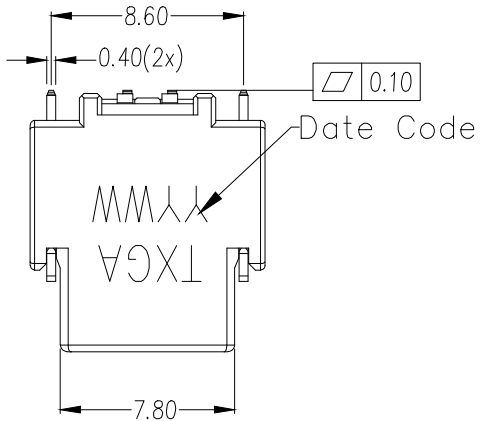

B

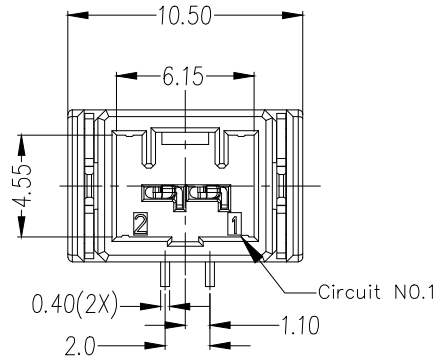

C

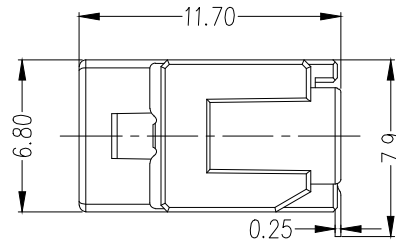

D

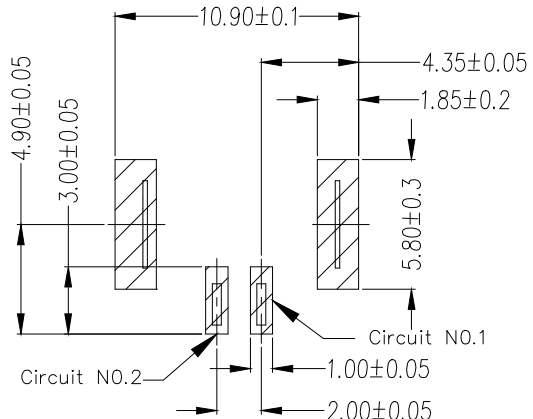

Recommended P.C. Board Layout

E

F

SPECIFICATIONS

Electrical

Current Rating: 3.0A AC(rms)/DC
 Voltage Rating: 50V AC(rms)/DC
 Contact Resistance: 30 mΩ Max
 Insulation Resistance: 100 MΩ Min
 Withstanding Voltage: 1000V AC r.m.s
 Temperature Range—Operating: -40°C~+125°C

Material and Plating

Housing: LCP (UL 94V-0), Black
 Terminal: Copper alloy, Selective gold on contact area, matte tin on tail
 Solder tab: Brass, Tin plated
 Mates With Housing: FAH20001 Series

Ordering Information

FAS 200 02 — S 02 S 7 XX 3 BK M A
 1 2 3 4 5 6 7 8 9 10 11 12

1	Category FAS—Socket	2	Pitch 200—Pitch 2mm	3	Distinction No. 02	4	Row Option S—Single row	5	Circuits 02	6	Orientation S—Vertical(180°)
7	Plating 7—Gold on contact, matte tin on tail	8	Plating Thickness 01—1μ" 05—5μ" 10—10μ" 15—15μ" 30—30μ"	9	Material—Resin 3—LCP	10	Color BK—Black	11	Packaging M—Reel	12	Type A—Type A

<p>THIRD ANGLE PROJECTION</p>	GENERAL TOLERANCES (UNLESS SPECIFIED)		APPROVE BY LEO	DATE 04/JUL/22	PART NO. FAS20002-S02S7XX3BKMA	ITEM NO. FAS20002	<p>Building Technology Cornerstone</p>
	X. ±0.30	X.' ±5'	CHECKED BY GISELLE	DATE 04/JUL/22	TITLE Automotive Connector (WTB) Pitch 2mm SMT (Socket)	REV 0	
	DESIGN UNITS mm	X.X ±0.20	X.X' ±2'	DRAWN BY PYD	DATE 04/JUL/22	THIS DRAWING CONTAINS INFORMATION THAT IS PROPRIETARY TO TXGA INDUSTRIAL ELECTRONICS(S.Z)CO.,LTD AND SHOULD NOT BE USED WITHOUT WRITTEN PERMISSION	

REV	LOCATIONS	DESCRIPTION	DATE	REVISER	APPD

Note:

- 10 sprocket hole cumulative tolerance ± 0.2
- Carrier camber is within 1.0mm in 250mm
- Material: Clear conductive polystyrene Alloy 100% recyclable
- All dimensions meet EIA-481-3 requirements
- Peel off force of cover tape & carrier tape: 20g~130g (0.2N~1.3N)
- Component load per 13" reel: 370 pcs

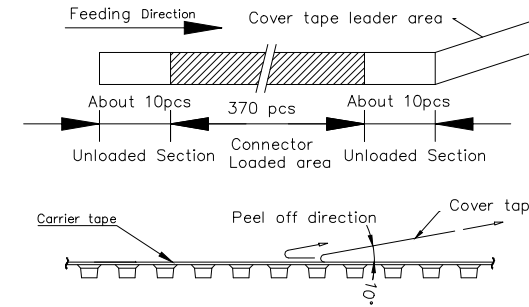

A

B

C

A

B

C

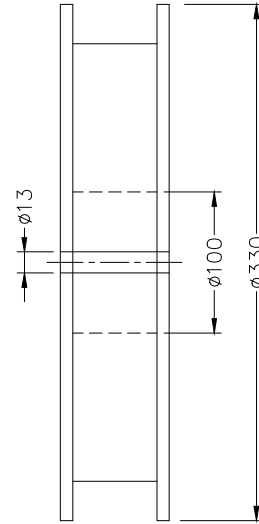
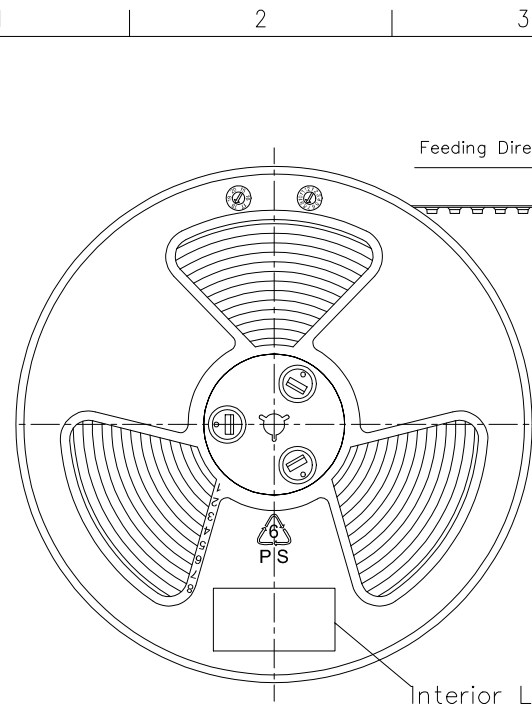

D

E

F

D

E

F

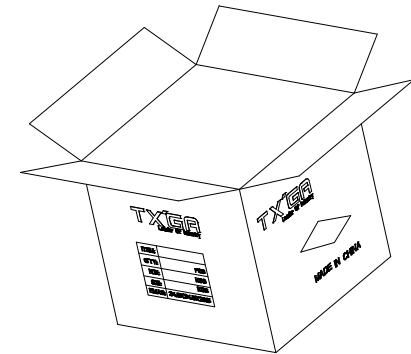
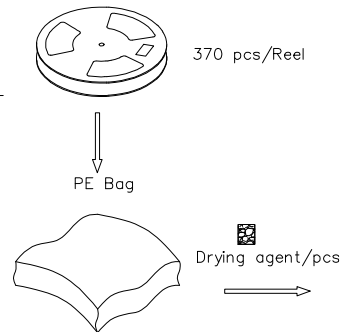
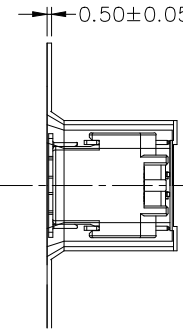
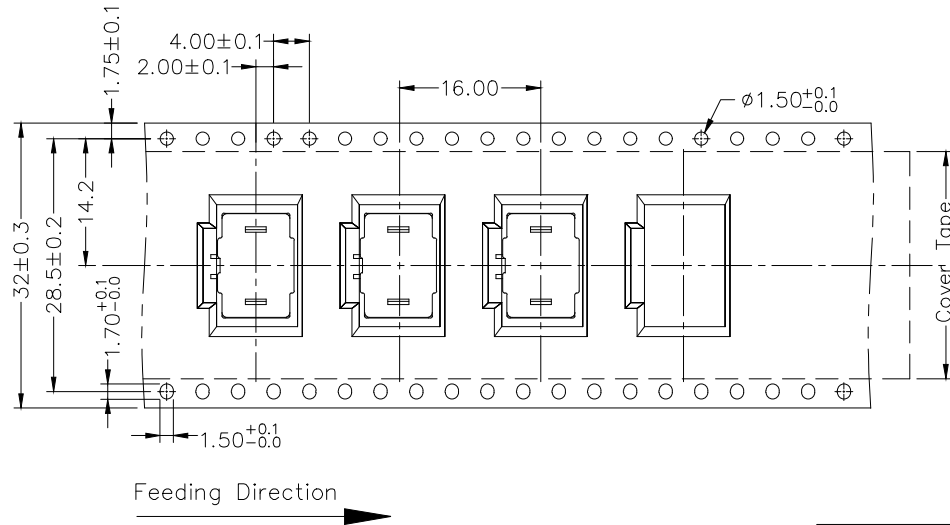

 THIRD ANGLE PROJECTION	GENERAL TOLERANCES (UNLESS SPECIFIED)		APPROVE BY	DATE	PART NO.	ITEM NO.	 Building Technology Cornerstone	
	X. ± 0.30	X.* $\pm 5^*$	LEO	04/JUL/22	FAS20002-S02S7XX3BKMA	FAS20002		
	DESIGN UNITS	X.X ± 0.20	X.X* $\pm 2^*$	CHECKED BY	DATE	TITLE		REV 0 SHEET NO. 2/2
	mm	X.XX ± 0.15	X.XX* $\pm 1^*$	GISELLE	04/JUL/22	Automotive Connector (WTB) Pitch 2mm SMT (Socket)		
SCALE	SIZE	X.XXX ± 0.10	X.XXX* $\pm 0.5^*$	DRAWN BY	DATE	THIS DRAWING CONTAINS INFORMATION THAT IS PROPRIETARY TO TXGA INDUSTRIAL ELECTRONICS(S.Z)CO.,LTD AND SHOULD NOT BE USED WITHOUT WRITTEN PERMISSION		
NTS	A4			PYD	04/JUL/22			