

REV	LOCATIONS	DESCRIPTION	DATE	REVISER	APPD

SPECIFICATIONS

Electrical

Current Rating: 3.0A AC(rms)/DC
Voltage Rating: 50V AC(rms)/DC
Contact Resistance: 30 mΩ Max
Insulation Resistance: 100 MΩ Min
Withstanding Voltage: 1000V AC r.m.s
Temperature Range-Operating: -40°C~+125°C

Material and Plating

Housing: LCP (UL 94V-0), Black
Terminal: Copper alloy, Selective gold on contact area, matte tin on tail
Solder tab: Brass, Tin plated
Mates With Housing: FAH20002 Series

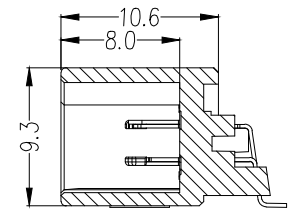
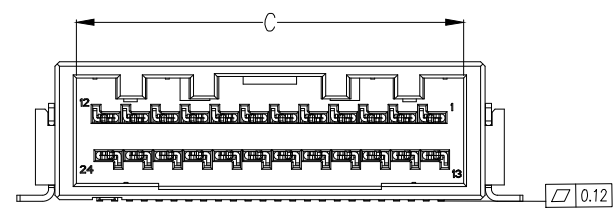
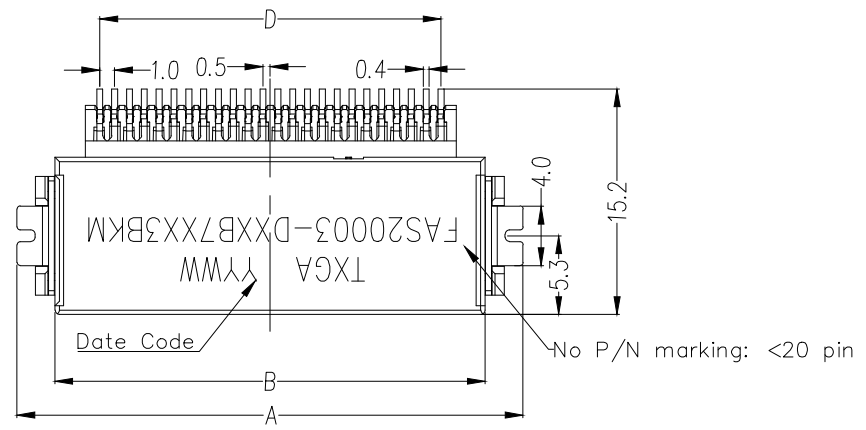

Circuits (n)	Part No.	Dimensions					
		A	B	C	D	E	F
8	FAS20003-D08B7XX3BKM	18.1	13	10.1	7	7	19.8
12	FAS20003-D12B7XX3BKM	22.1	17	14.1	11	11	23.8
16	FAS20003-D16B7XX3BKM	26.1	21	18.1	15	15	27.8
20	FAS20003-D20B7XX3BKM	30.1	25	22.1	19	19	31.5
24	FAS20003-D24B7XX3BKM	34.1	29	26.1	23	23	35.8

Ordering Information

FAS 200 03 — D XX B 7 XX 3 BK M
1 2 3 4 5 6 7 8 9 10 11

1 Category FAS-Socket	2 Pitch 200-Pitch 2mm	3 Distinction No. 03	4 Row Option D-Dual row	5 Circuits XX	6 Orientation B-Right angle(90°)
7 Plating 7-Gold on contact, matte tin on tail	8 Plating Thickness 01-1μ" 05-5μ" 10-10μ" 15-15μ" 30-30μ"	9 Material-Resin 3-LCP	10 Color BK-Black	11 Packaging M-Reel	

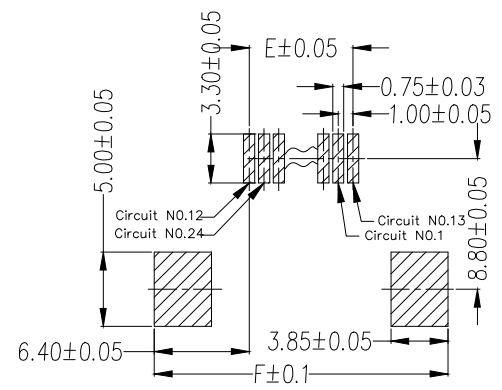

 THIRD ANGLE PROJECTION DESIGN UNITS mm SCALE 1:1 SIZE A4	GENERAL TOLERANCES (UNLESS SPECIFIED)		APPROVE BY LEO	DATE 04/JUL/22	PART NO. FAS20003-DXXB7XX3BKM	ITEM NO. FAS20003	 Building Technology Cornerstone
	X. ±0.30	X.* ±5°	CHECKED BY GISELLE	DATE 04/JUL/22	TITLE Automotive Connector (WTB) Pitch 2mm SMT (Socket)		
	X.XX ±0.15	X.XX' ±1°	DRAWN BY PYD	DATE 04/JUL/22	THIS DRAWING CONTAINS INFORMATION THAT IS PROPRIETARY TO TXGA INDUSTRIAL ELECTRONICS(S.Z)CO.,LTD AND SHOULD NOT BE USED WITHOUT WRITTEN PERMISSION		
	X.XXX ±0.10	X.XXX' ±0.5°					

1 2 3 4 5 6 7 8

REV	LOCATIONS	DESCRIPTION	DATE	REVISER	APPD

A

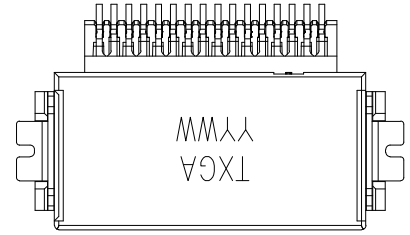
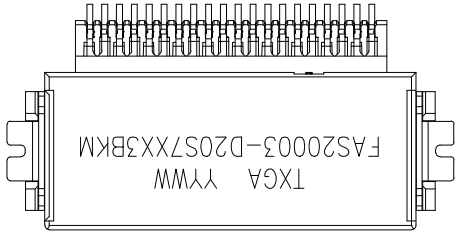
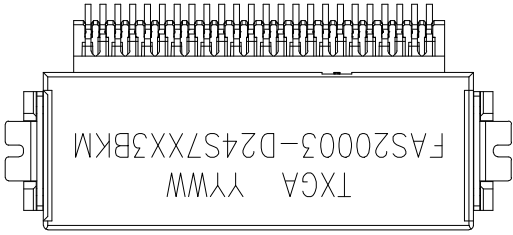

B

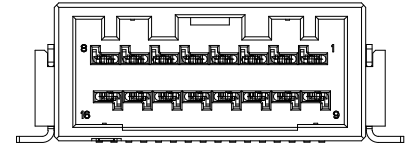
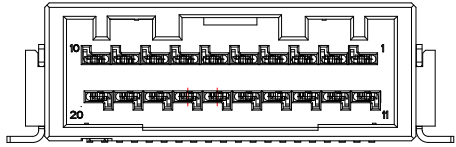
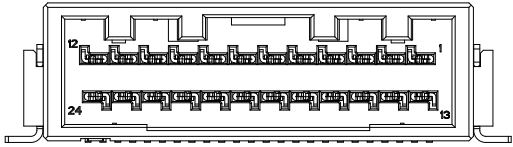

C

24 Circuits

20 Circuits

16 Circuits

D

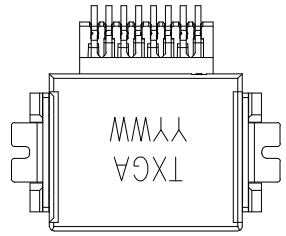
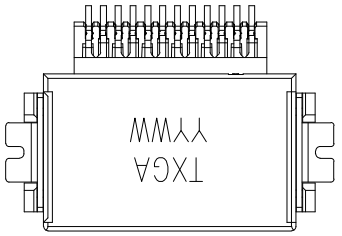

E

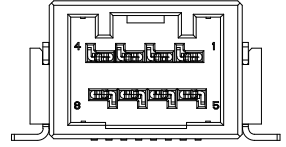
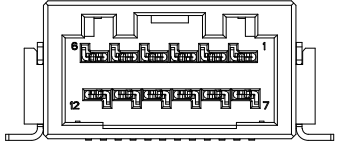

F

12 Circuits

8 Circuits

<p>THIRD ANGLE PROJECTION</p>	GENERAL TOLERANCES (UNLESS SPECIFIED)		APPROVE BY	DATE	PART NO.	ITEM NO.	<p>Building Technology Cornerstone</p>	
	X. ±0.30	X.* ±5°	LEO	04/JUL/22	FAS20003-DXXB7XX3BKM	FAS20003		
	DESIGN UNITS mm		CHECKED BY	DATE	TITLE		REV 0	SHEET NO. 2/3
	SCALE 1:1	SIZE A4	GISELLE	04/JUL/22	Automotive Connector (WTB) Pitch 2mm SMT (Socket)		THIS DRAWING CONTAINS INFORMATION THAT IS PROPRIETARY TO TXGA INDUSTRIAL ELECTRONICS(S.Z)CO.,LTD AND SHOULD NOT BE USED WITHOUT WRITTEN PERMISSION	
		X.XX ±0.15	X.XX* ±1°	DRAWN BY	DATE			
		X.XXX ±0.10	X.XXX* ±0.5°	PYD	04/JUL/22			

1 2 3 4 5 6 7 8

REV	LOCATIONS	DESCRIPTION	DATE	REVISER	APPD

Note:

- 10 sprocket hole cumulative tolerance ± 0.2
- Carrier camber is within 1.0mm in 250mm
- Material: Clear conductive polystyrene Alloy 100% recyclable
- All dimensions meet EIA-481-3 requirements
- Peel off force of cover tape & carrier tape: 20g~130g (0.2N~1.3N)
- Component load per 13" reel: 390 pcs

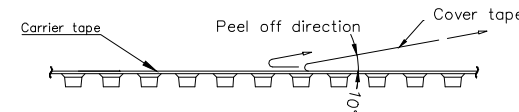
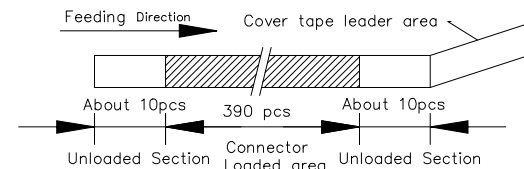

Circuits (n)	Dimensions		
	W	S	F
8-16	44	40.5	20.2
20-24	56	52.5	26.2

A
B
C
D
E
F

A
B
C
D
E
F

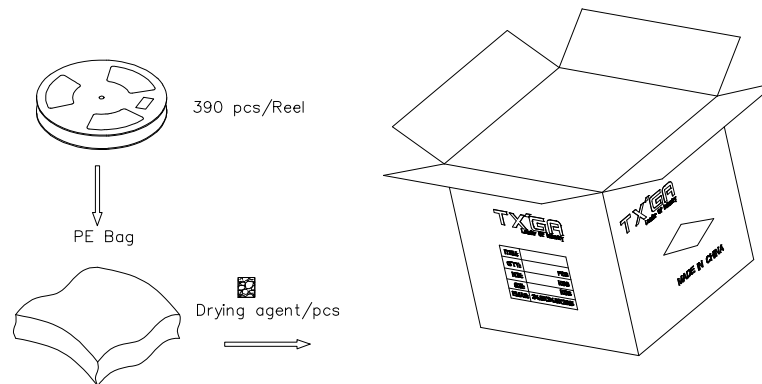
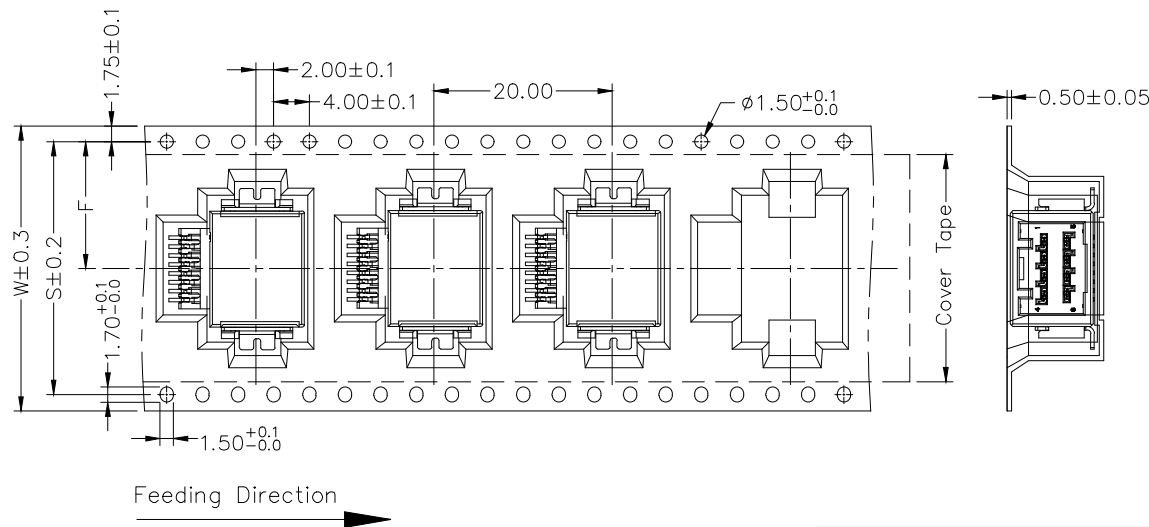
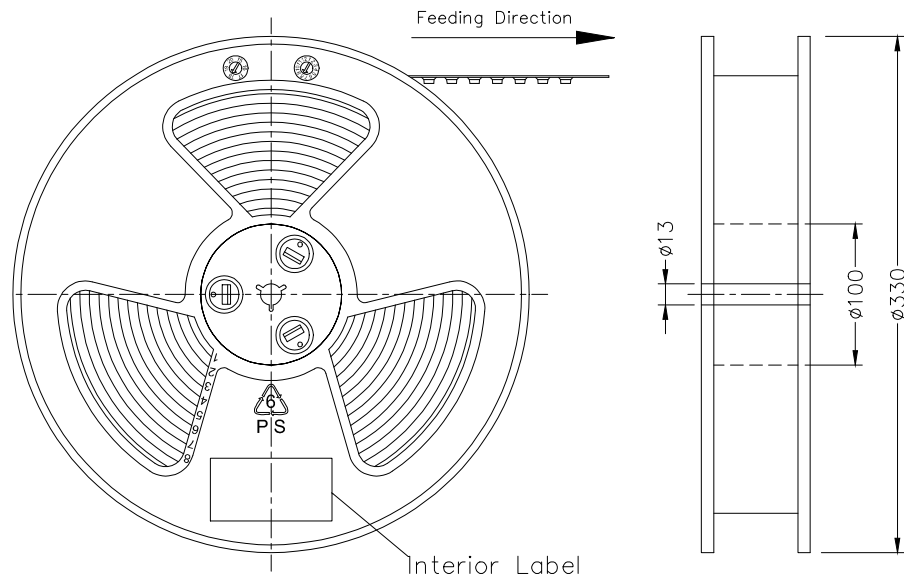

 THIRD ANGLE PROJECTION	GENERAL TOLERANCES (UNLESS SPECIFIED)		APPROVE BY	DATE	PART NO.	ITEM NO.	 Building Technology Cornerstone		
	X. ± 0.30	X.* $\pm 5^*$	LEO	04/JUL/22	FAS20003-DXXB7XX3BK M	FAS20003			
	DESIGN UNITS mm	X.X ± 0.20	X.X* $\pm 2^*$	CHECKED BY	DATE	TITLE		REV 0	SHEET NO. 3/3
	SCALE NTS	X.XX ± 0.15	X.XX* $\pm 1^*$	GISELLE	04/JUL/22	Automotive Connector (WTB) Pitch 2mm SMT (Socket)			
	X.XXX ± 0.10	X.XXX* $\pm 0.5^*$	DRAWN BY	DATE	THIS DRAWING CONTAINS INFORMATION THAT IS PROPRIETARY TO TXGA INDUSTRIAL ELECTRONICS(S.Z)CO.,LTD AND SHOULD NOT BE USED WITHOUT WRITTEN PERMISSION				
			PYD	04/JUL/22					

1 2 3 4 5 6 7 8