

1 2 3 4 5 6 7 8

REV	LOCATIONS	DESCRIPTION	DATE	REVISER	APPD

SPECIFICATIONS

Electrical

Voltage Rating: 3V AC(rms)/DC  
 Contact Resistance: 30 mΩ Max  
 Insulation Resistance: 1000 MΩ Min  
 Withstanding Voltage: 500V AC r.m.s  
 Temperature Range-Operating: -25°C~+85°C

Material And Plating

Housing: PPS (UL 94V-0) Brown  
 Contact: Phosphor bronze  
 Finish: Gold flash/Over Nickel Plate

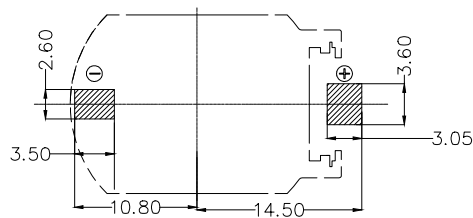
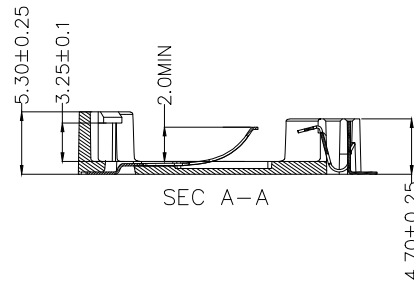
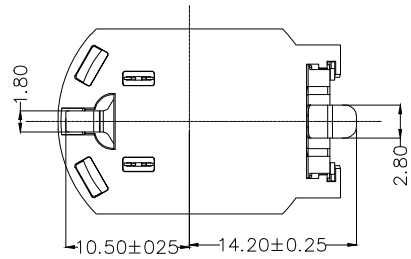
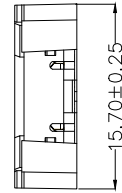
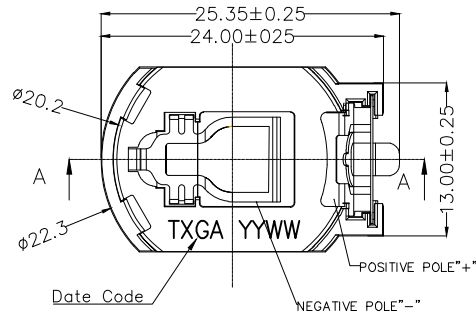

Recommended P.C.Board Layout

Ordering Information

FBA 000 15 — 02 S 1 00 8 X  
 1 2 3 4 5 6 7 8 9

1	Category FBA-Battery Holder	2	Pitch 000	3	Distinction No. 15	4	Circuits 02	5	Entry Angle S-180° Vertical
6	Plating 1-Gold Plated	7	Thickness of Plating 00-Gold Flash	8	Material-Resin 8-PPS	9	Packaging K-Tray M-Reel		

<p>THIRD ANGLE PROJECTION</p>	<p>GENERAL TOLERANCES (UNLESS SPECIFIED)</p>		<p>APPROVE BY LEO</p>	<p>DATE 28/JAN/22</p>	<p>PART NO. FBA00015-02S1008X</p>	<p>ITEM NO. FBA00015</p>	<p>Building Technology Cornerstone</p>
	<p>X. ±0.30</p>	<p>X.' ±5'</p>	<p>CHECKED BY GISELLE</p>	<p>DATE 28/JAN/22</p>	<p>TITLE Battery Connector 180° Vertical(SMT)</p>		
<p>DESIGN UNITS METRIC</p>	<p>X.X ±0.20</p>	<p>X.X' ±2'</p>	<p>DRAWN BY NICK</p>	<p>DATE 28/JAN/22</p>	<p>THIS DRAWING CONTAINS INFORMATION THAT IS PROPRIETARY TO TXGA INDUSTRIAL ELECTRONICS(S.Z)CO.,LTD AND SHOULD NOT BE USED WITHOUT WRITTEN PERMISSION</p>		
<p>SCALE 5:1</p>	<p>SIZE A4</p>	<p>X.XX ±0.15</p>	<p>X.XX' ±1'</p>	<p>X.XXX ±0.10</p>	<p>X.XXX' ±0.5'</p>		

1 2 3 4 5 6 7 8

1 2 3 4 5 6 7 8

REV	LOCATIONS	DESCRIPTION	DATE	REVISER	APPD

**Note:**

1. 10 sprocket hole cumulative tolerance  $\pm 0.2$
2. Carrier camber is within 1.0mm in 250mm
3. Material: White Conductive polystyrene Alloy 100% recyclable
4. All dimensions meet EIA-481-3 requirements
5. Peel off force of cover tape & carrier tape: 20g~130g (0.2N~1.3N)
6. Component load per 13" reel: 500 pcs

A  
B  
C  
D  
E  
F

A  
B  
C  
D  
E  
F

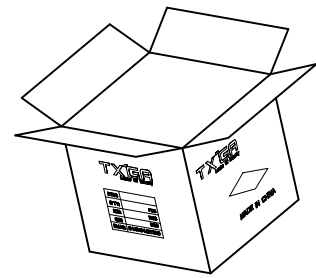
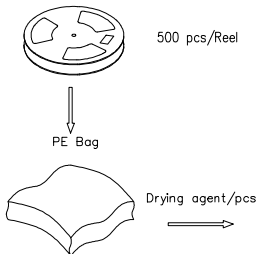
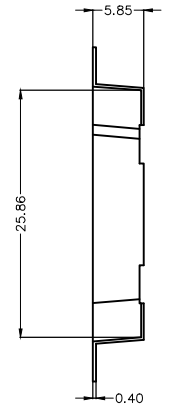
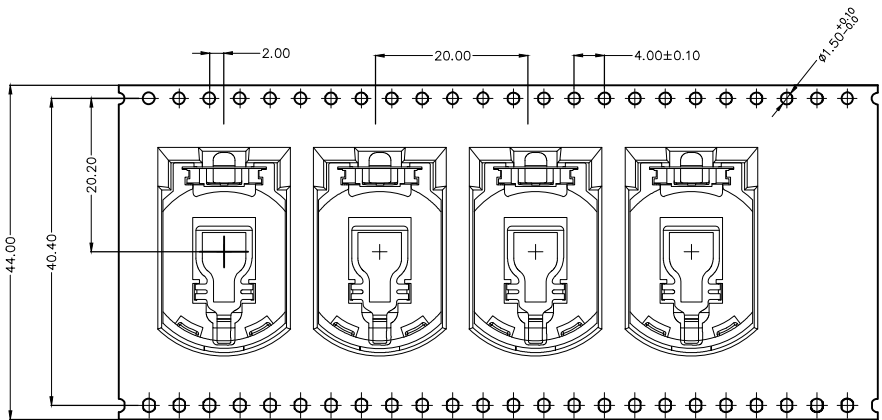
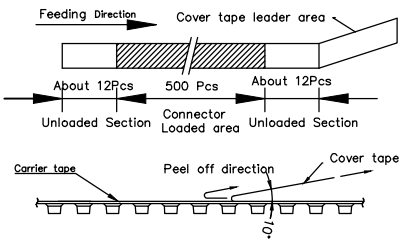
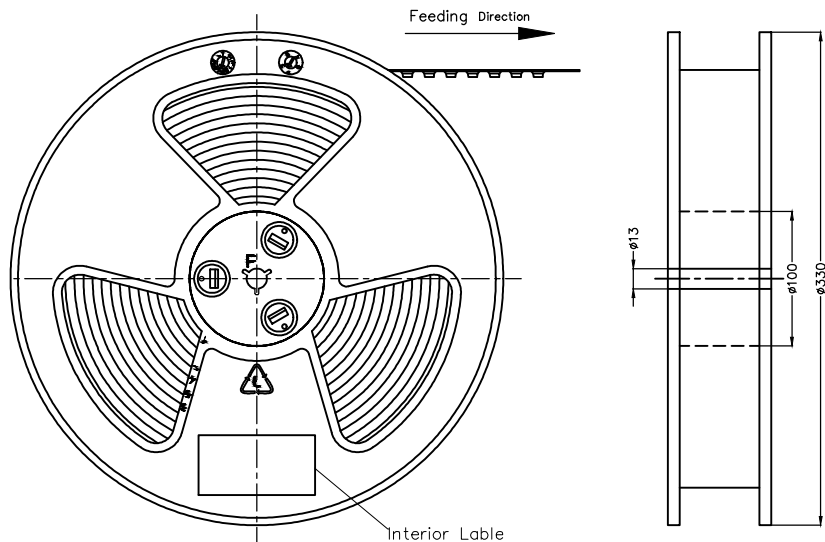

Feeding Direction →

1 2 3 4 5 6 7 8

<p>THIRD ANGLE PROJECTION</p>	<p>GENERAL TOLERANCES (UNLESS SPECIFIED)</p>		<p>APPROVE BY</p> <p>LEO</p>	<p>DATE</p> <p>28/JAN/22</p>	<p>PART NO.</p> <p>FBA00015-02S1008X</p>	<p>ITEM NO.</p> <p>FBA00015</p>	<p>Building Technology Cornerstone</p>
	<p>X. <math>\pm 0.30</math></p>	<p>X.' <math>\pm 5'</math></p>	<p>CHECKED BY</p> <p>GISELLE</p>	<p>DATE</p> <p>28/JAN/22</p>	<p>TITLE</p> <p>Battery Connector 180° Vertical(SMT)</p>	<p>REV 0</p>	
<p>DESIGN UNITS</p> <p>METRIC</p>	<p>X.X <math>\pm 0.20</math></p>	<p>X.X' <math>\pm 2'</math></p>	<p>DRAWN BY</p> <p>NICK</p>	<p>DATE</p> <p>28/JAN/22</p>	<p>THIS DRAWING CONTAINS INFORMATION THAT IS PROPRIETARY TO TXGA INDUSTRIAL ELECTRONICS(S.Z)CO.,LTD AND SHOULD NOT BE USED WITHOUT WRITTEN PERMISSION</p>		
<p>SCALE</p> <p>5:1</p>	<p>SIZE</p> <p>A4</p>	<p>X.XX <math>\pm 0.15</math></p> <p>X.XXX <math>\pm 0.10</math></p>	<p>X.XX' <math>\pm 1'</math></p> <p>X.XXX' <math>\pm 0.5'</math></p>				