

REV	LOCATIONS	DESCRIPTION	DATE	REVISER	APPD

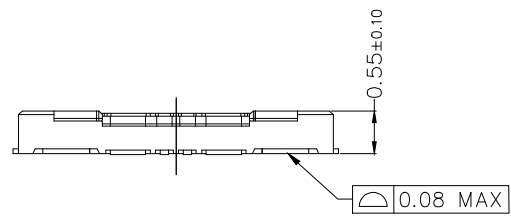

SPECIFICATION:
Electrical
Voltage Rating: 60V AC/DC
Rated Current: Signal Contact 0.3 AMPS/Pin
Power Contact 15 AMPS Max (All power pins)
Contact Resistance:
Signalpin: Initial 50mΩ MAX
After Test Δ20mΩ
Power pin: Initial 15mΩ MAX
After Test 15mΩ MAX
Insulation Resistance:
Initial: 500 MΩ Minimum.
After Test: 500 MΩ Minimum.
Dielectric Withstanding Voltage:
No breakdown at AC 100V for 1 minute
Salt Water Spray Test: Temperature 35°C±2°C
Density of Salt Density 5±1%
Duration 48±2 hours
Operating Temperature Range: -40 °C ~ +85°C
Storage Temperature Range : -40°C ~ +85°C,
0 ~ 90 % RH (Relative humidity).
Mating/Unmating Force: Mating Force 30N MAX
Unmating Force 3N MIN

Material and Plating
Housing: LCP(UL 94V-0), Black
Contact: Copper Alloy,
Overall: 50μ" MIN NI plated
Contact Areas: 4μ" MIN gold plated
Non-contact Areas: 1μ" MIN gold plated

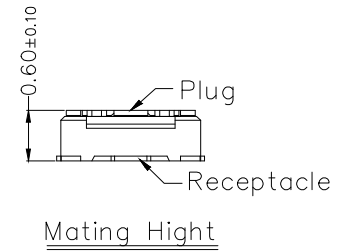
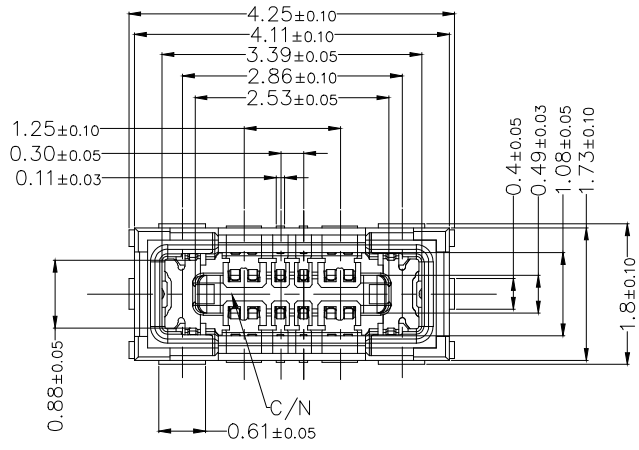
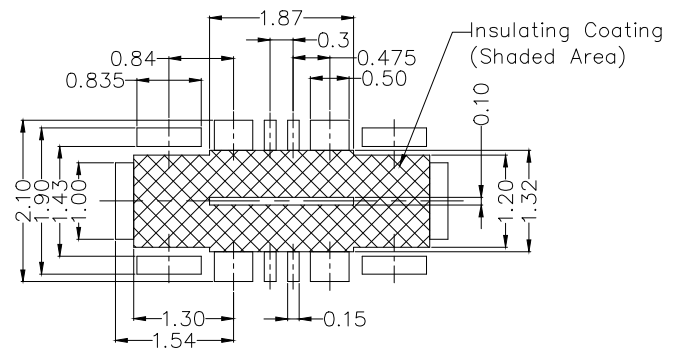

Recommended P.C.B Layout
Tolerance ±0.03mm

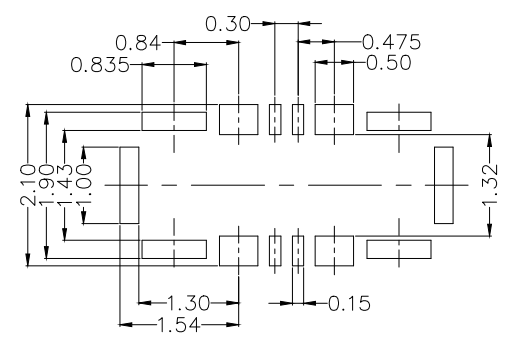

Recommended Metal Dimensions
(Thickness: 0.08 mm) Tolerance ±0.01mm

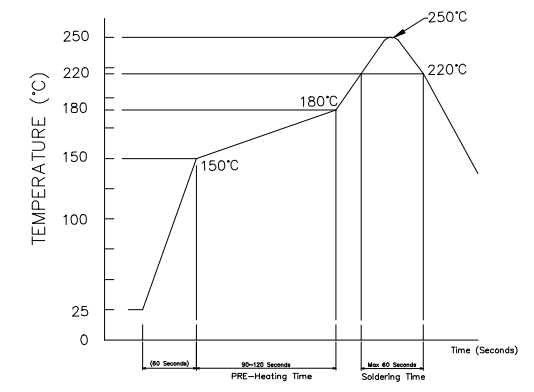

RECOMMENDED REFLOW TEMPERATURE PROFILE
USIN LEAD-FREE SOLDER PASTE

 THIRD ANGLE PROJECTION DESIGN UNITS mm SCALE 5:1 SIZE A4	GENERAL TOLERANCES (UNLESS SPECIFIED)		APPROVE BY	DATE	PART NO.	ITEM NO.	 Building Technology Cornerstone
	X. ±0.30	X.* ±5'	LEO	30/JAN/23	FBB03002-F04S1143BKM	FBB03002	
	X.X ±0.20	X.X' ±2'	CHECKED BY	DATE	TITLE	Board to Board 4+6 Circuits Pitch 0.30mm 180° Vertical (SMT)	
	X.XX ±0.15	X.XX' ±1'	GISELLE	30/JAN/23	REV 0		
X.XXX ±0.10	X.XXX' ±0.5'	DRAWN BY	DATE	THIS DRAWING CONTAINS INFORMATION THAT IS PROPRIETARY TO TXGA INDUSTRIAL ELECTRONICS(S.Z)CO.,LTD AND SHOULD NOT BE USED WITHOUT WRITTEN PERMISSION			
		PYD	30/JAN/23				

1 2 3 4 5 6 7 8

REV	LOCATIONS	DESCRIPTION	DATE	REVISER	APPD

- Note:
- 1.10 sprocket hole cumulative tolerance ± 0.2
 2. Carrier camber is within 1.0mm in 250mm
 3. Material: White conductive polystyrene Alloy 100% recyclable
 4. All dimensions meet EIA-481-3 requirements
 5. Peel off force of cover tape & carrier tape: 20g~130g (0.2N~1.3N)
 6. Component load per 13" reel: See table

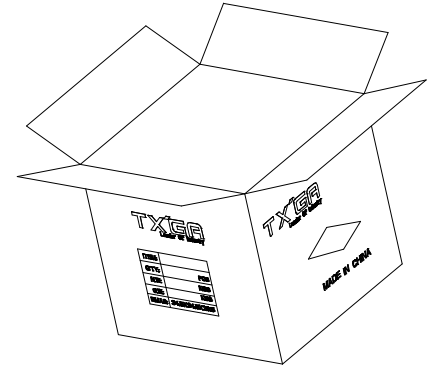
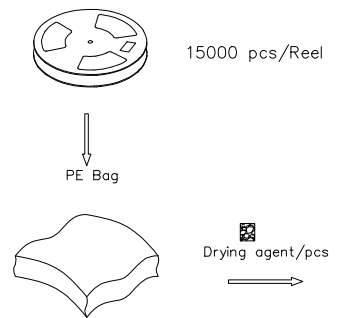
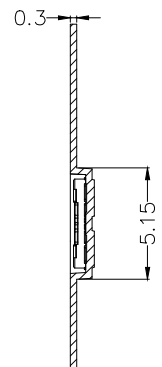
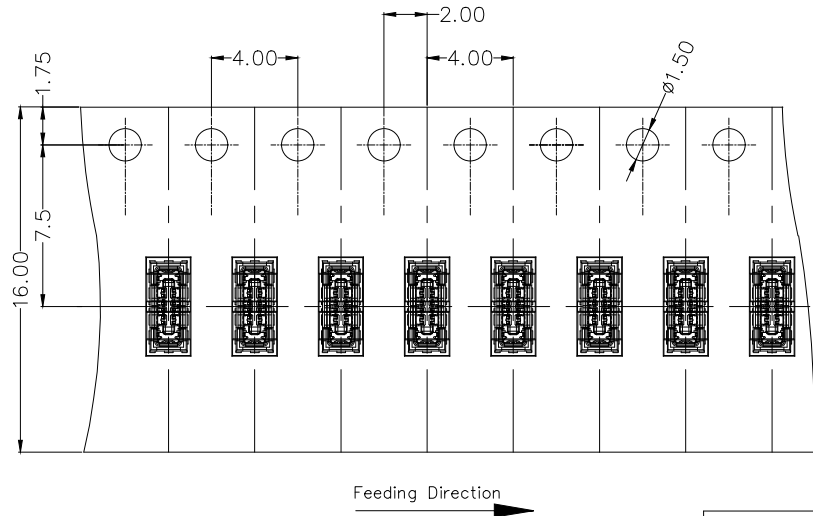
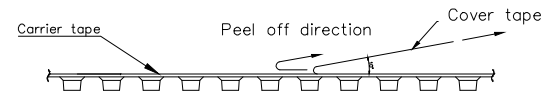
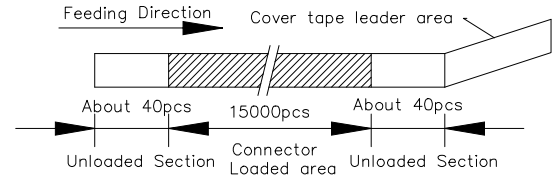
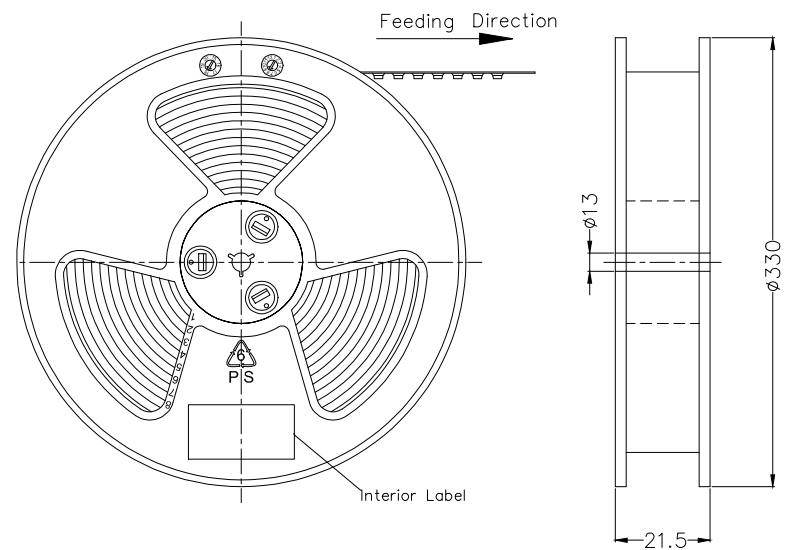

 THIRD ANGLE PROJECTION	GENERAL TOLERANCES (UNLESS SPECIFIED)		APPROVE BY	DATE	PART NO.	ITEM NO.	 Building Technology Cornerstone
	X. ± 0.30	X.' $\pm 5'$	LEO	30/JAN/23	FBB03002-F04S1143BKM	FBB03002	
	X.X ± 0.20	X.X' $\pm 2'$	CHECKED BY	DATE	TITLE		
	X.XX ± 0.15	X.XX' $\pm 1'$	GISELLE	30/JAN/23	Board to Board 4+6 Circuits Pitch 0.30mm 180° Vertical (SMT)		
SCALE	SIZE	X.XXX ± 0.10	X.XXX' $\pm 0.5'$	DRAWN BY	DATE	THIS DRAWING CONTAINS INFORMATION THAT IS PROPRIETARY TO TXGA INDUSTRIAL ELECTRONICS(S.Z)CO.,LTD AND SHOULD NOT BE USED WITHOUT WRITTEN PERMISSION	
5:1	A4			PYD	30/JAN/23	REV 0	SHEET NO. 2/2

1 2 3 4 5 6 7 8