

REV	LOCATIONS	DESCRIPTION	DATE	REVISER	APPD

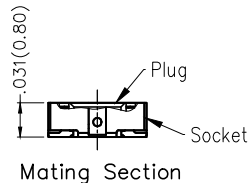

Electrical  
 Current Rating: 0.3A AC(rms)/DC  
 Voltage Rating: 30V AC(rms)/DC  
 Contact Resistance: 100 mΩ Max  
 Insulation Resistance: 50 MΩ MIN  
 Withstanding Voltage: 100V AC r.m.s  
 Temperature Range—Operating: -35°C~+85°C  
 Material and Plating  
 Housing: LCP( UL 94V-0)  
 Contact Pin: Phosphor Bronze  
 Plating: Tin Plated/Gold Plated Over Nickel

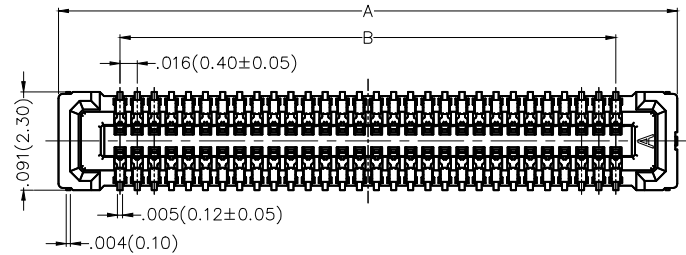
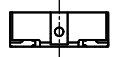
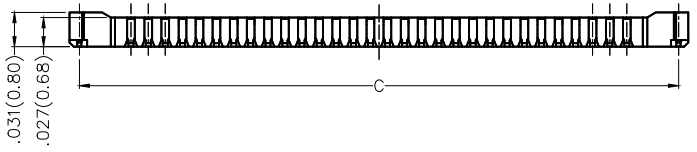

Circuits (n)	Part No.	Dimensions(in/mm)		
		A	B	C
16	FBB04005-F16S1033K6M	.224(5.68)	.110(2.80)	.206(5.22)
20	FBB04005-F20S1033K6M	.255(6.48)	.142(3.60)	.237(6.02)
24	FBB04005-F24S1033K6M	.287(7.28)	.173(4.40)	.269(6.82)
30	FBB04005-F30S1033K6M	.334(8.48)	.220(5.60)	.316(8.02)
40	FBB04005-F40S1033K6M	.413(10.48)	.299(7.60)	.394(10.02)
50	FBB04005-F50S1033K6M	.491(12.48)	.378(9.60)	.473(12.02)

### Ordering Information

FBB 040 05 — F XX S 1 03 3 K6 M  
 1 2 3 4 5 6 7 8 9 10 11

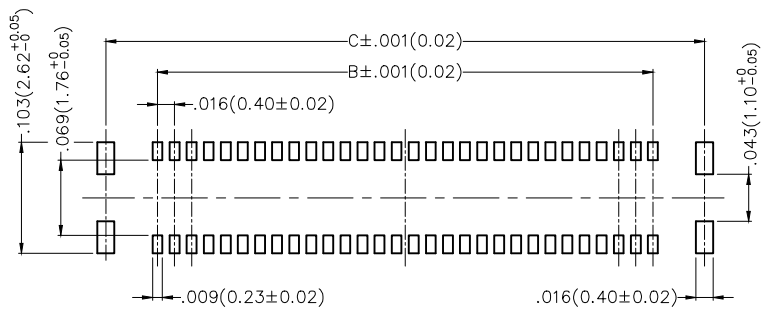

Recommended P.C.Board Layout  
 General Tolerances: ±0.05mm

- 1 Category: FBB-Board to Board
- 2 Series Number: 040-Pitch 0.4mm
- 3 Distinction No.: 05
- 4 Type: F-Female
- 5 Circuits: XX
- 6 Entry Angle: S-180° Vertical
- 7 Plating: 1-Gold Plated
- 8 Thickness of Plating: 00-Gold Flash, 03-3μ"
- 9 Material-Resin: 3-LCP
- 10 Color-Resin: K6-Black
- 11 Packaging: M-Reel

<p>THIRD ANGLE PROJECTION</p>	GENERAL TOLERANCES (UNLESS SPECIFIED)		APPROVE BY: FRANK	DATE: 04/JUL/16	PART NO.: FBB04005-FXXS1033K6M	ITEM NO.: FBB04005	<p>Leader Of Industry</p>
	X.±.012(0.30)	X.±5'	CHECKED BY: CHERRY	DATE: 04/JUL/16	TITLE: Board to Board Pitch 0.4mm 180° Vertical (SMT)		
DESIGN UNITS: Inch (metric)	X.X±.008(0.20)	X.±2'	DRAWN BY: KATE	DATE: 04/JUL/16	THIS DRAWING CONTAINS INFORMATION THAT IS PROPRIETARY TO TXGA INDUSTRIAL ELECTRONICS(S.Z)CO.,LTD AND SHOULD NOT BE USED WITHOUT WRITTEN PERMISSION		
SCALE: 5:1	SIZE: A4	X.XX±.006(0.15)					
		X.XXX±.004(0.10)					