

1 2 3 4 5 6 7 8

REV	LOCATIONS	DESCRIPTION	DATE	REVISER	APPD

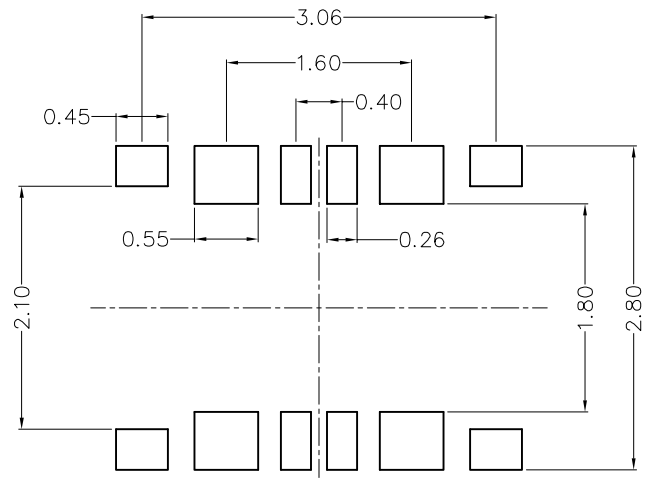
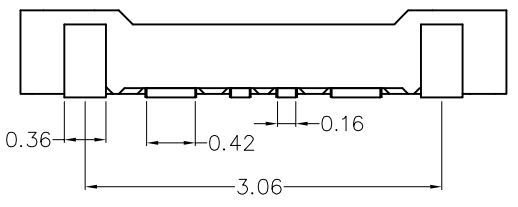
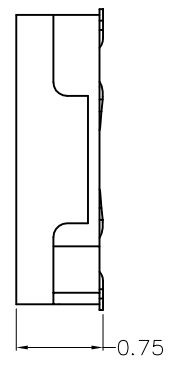
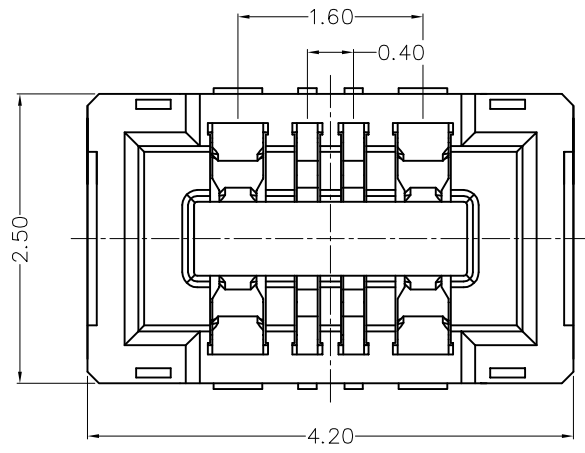

Recommended P.C.Board Layout  
General tolerances: ±0.05

SPECIFICATIONS

Electrical  
 Current Rating: 0.3A AC(rms)/DC (Signal contact)  
 3A AC(rms)/DC (Power contact)  
 Voltage Rating: 30V AC(rms)/DC  
 Contact Resistance: 50 mΩ Max.  
 Insulation Resistance: 500 MΩ Min.  
 Withstanding Voltage: 100V AC r.m.s  
 Temperature Range—Operating: -25°C~+85°C

Material  
 Housing: Thermoplastic (UL 94V-0), Black  
 Contact: Copper alloy/ gold plated,1.25μm Min.Nickel plated over all  
 Fittings: Copper alloy/2.5μm Min.Tin plated,1.25μm Min.Nickel plated over all

Ordering Information

FBB 040 11 — F 08 S 1 XX 3 BK M  
 1 2 3 4 5 6 7 8 9 10 11

1 Category FBB—Board to Board	2 Series Number 040—Pitch 0.4mm	3 Distinction No. 11	4 Type F—Female	5 Circuits 08	6 Entry Angle S—180° Vertical	7 Plating 1—Gold plated
8 Thickness of Plating 01—0.025μm Custom plate available	9 Material—Resin 3—LCP	10 Color—Resin BK—Black	11 Packaging M—Reel			

 THIRD ANGLE PROJECTION	GENERAL TOLERANCES (UNLESS SPECIFIED)		APPROVE BY LEO	DATE 25/AUG/23	PART NO. FBB04011—F08S1XX3BKM	ITEM NO. FBB04011	 Building Technology Cornerstone	
	X. ±0.30	X.* ±5°	CHECKED BY GISELLE	DATE 25/AUG/23	TITLE Board to Board Pitch 0.4mm 180° Vertical (SMT)			REV 0
	DESIGN UNITS METRIC (mm)	X.X ±0.20	X.X* ±2°	DRAWN BY MATT	DATE 25/AUG/23	THIS DRAWING CONTAINS INFORMATION THAT IS PROPRIETARY TO TXGA INDUSTRIAL ELECTRONICS(S.Z)CO.,LTD AND SHOULD NOT BE USED WITHOUT WRITTEN PERMISSION		
SCALE 5:1	SIZE A4	X.XX ±0.15	X.XX* ±1°					
		X.XXX ±0.10	X.XXX* ±0.5°					

1 2 3 4 5 6 7 8

REV	LOCATIONS	DESCRIPTION	DATE	REVISER	APPD

A  
B  
C  
D  
E  
F

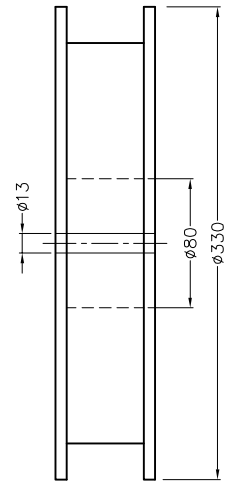
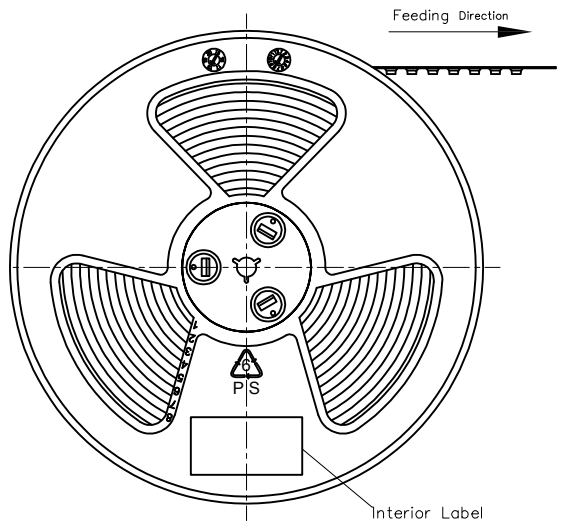

- Note:
1. 10 sprocket hole cumulative tolerance  $\pm 0.2$
  2. Carrier camber is within 1mm in 100mm
  3. Material: Black Conductive polystyrene Alloy 100% recyclable
  4. All dimensions meet EIA-481-3 requirements
  5. Component load per 13" reel: 5,000 pcs

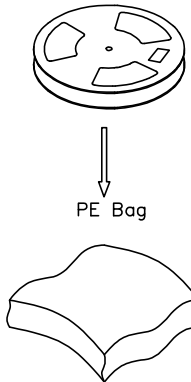
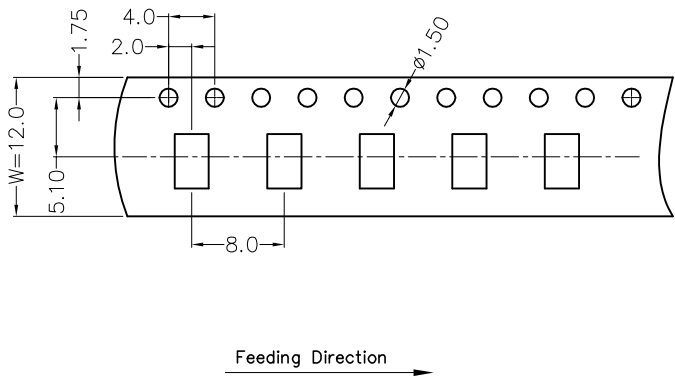
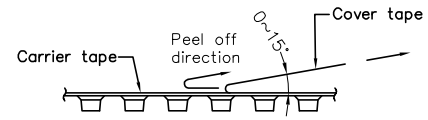
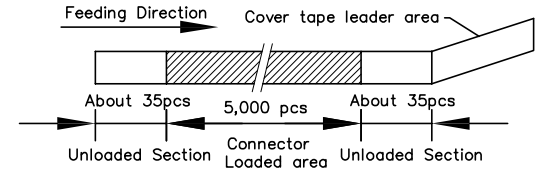

5,000 pcs/Reel

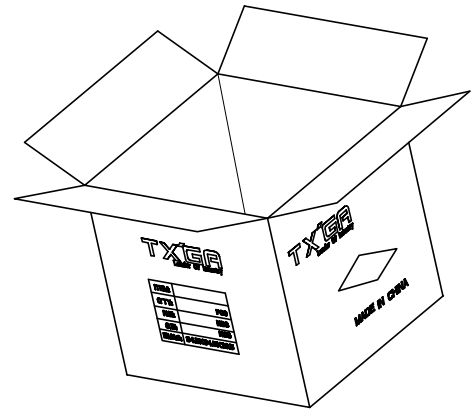

<p>THIRD ANGLE PROJECTION</p>	GENERAL TOLERANCES (UNLESS SPECIFIED)		APPROVE BY	DATE	PART NO.	ITEM NO.	<p>Building Technology Cornerstone</p>
	X. $\pm 0.30$	X.* $\pm 5^\circ$	LEO	25/AUG/23	FBB04011-F08S1XX3BKM	FBB04011	
	X.X $\pm 0.20$	X.X* $\pm 2^\circ$	CHECKED BY	DATE	TITLE		
	X.XX $\pm 0.15$	X.XX* $\pm 1^\circ$	GISELLE	25/AUG/23	Board to Board Pitch 0.4mm 180° Vertical (SMT)		
SCALE	SIZE	X.XXX $\pm 0.10$	X.XXX* $\pm 0.5^\circ$	DRAWN BY	DATE	THIS DRAWING CONTAINS INFORMATION THAT IS PROPRIETARY TO TXGA INDUSTRIAL ELECTRONICS(S.Z)CO.,LTD AND SHOULD NOT BE USED WITHOUT WRITTEN PERMISSION	
5:1	A4			MATT	25/AUG/23	REV 0	SHEET NO. 2/2