

REV	LOCATIONS	DESCRIPTION	DATE	REVISER	APPD

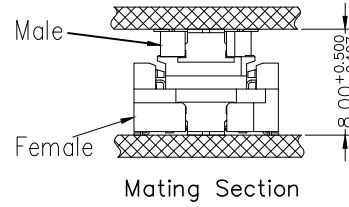
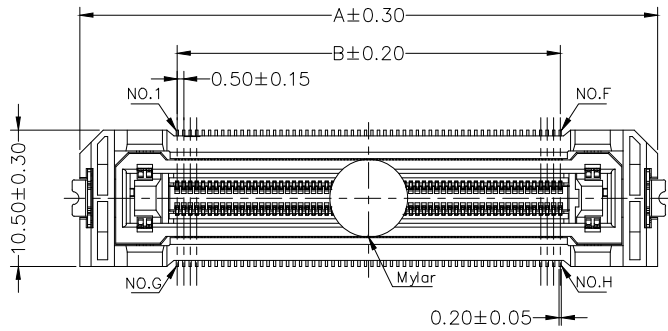

**SPECIFICATION**  
Electrical

Current Rating: 0.5A AC(rms)/DC (Signal Contact)  
 3A AC(rms)/DC (Power Contact)  
 Voltage Rating: 50V AC(rms)/DC (Signal Contact)  
 200V AC(rms)/DC (Power Contact)  
 Contact Resistance: 40 mΩ Max  
 Insulation Resistance: 100 MΩ MIN (Signal Contact)  
 1000 MΩ MIN (Power Contact)  
 Withstanding Voltage: 300V AC r.m.s  
 Temperature Range-Operating: -55°C~+85°C  
 Floating Ability : XY-AXIS±0.6MM

**Material**

Housing: LCP, (UL 94V-0)  
 Contact: Copper Alloy/Gold Plated  
 Metal Fittings : Copper Alloy/Tin 80u" Min. Over Nickel 50u" Min.

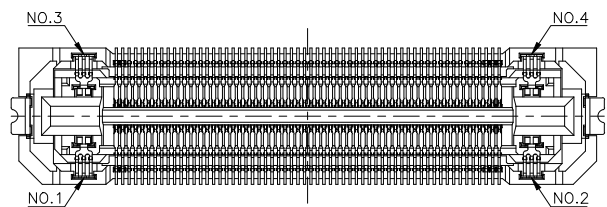
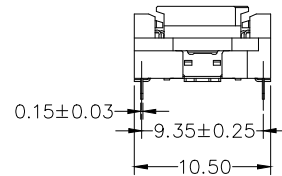
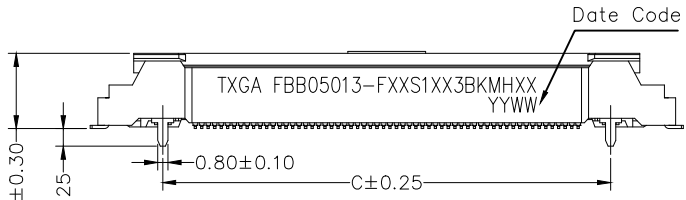

Circuits(n)	Part NO.	Dimensions					PIN NO.		
		A	B	C	D	E	F	G	H
60	FBB05013-F60S1XX3BKM H58	29.5	14.5	19.5	14.8	27.2	30	31	60
80	FBB05013-F80S1XX3BKM H58	34.5	19.5	24.5	19.8	32.2	40	41	80
100	FBB05013-F100S1XX3BKM H58	39.5	24.5	29.5	24.8	37.2	50	51	100
120	FBB05013-F120S1XX3BKM H58	44.5	29.5	34.5	29.8	42.2	60	61	120

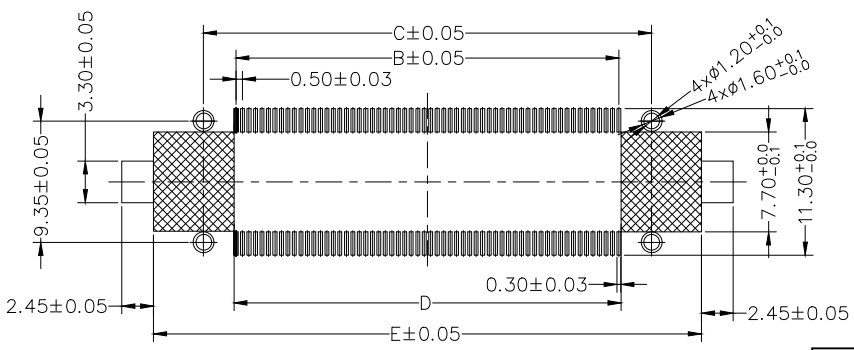

Recommended P.C.Board Layout  
 General tolerances:±0.05

**Ordering Information**

FBB 050 13 F XX S 1 XX 3 BK M HXX  
 1 2 3 4 5 6 7 8 9 10 11 12

1 Category FBB-Board To Board	2 Series Number 050-Pitch 0.50mm	3 Distinction No. 13	4 Type F-Female	5 Circuits XX	6 Entry Angle S-180°Vertical
7 Plating 1-Gold Plated	8 thickness of Gold Plating 00-Gold Flash 03-3u" 05-05u"	9 Material-Resin 3-LCP	10 Color-Resin BK-Black	11 Packaging M-Reel	12 Male height H58-5.80mm

<p>THIRD ANGLE PROJECTION</p>	<p>GENERAL TOLERANCES (UNLESS SPECIFIED)</p> <p>X. ±0.30 X.* ±5'</p>		<p>APPROVE BY</p> <p>LEO</p>	<p>DATE</p> <p>19/Sept/23</p>	<p>PART NO.</p> <p>FBB05013-FXXS1XX3BKM HXX</p>	<p>ITEM NO.</p> <p>FBB05013</p>	<p>Building Technology Cornerstone</p>
	<p>DESIGN UNITS METRIC(mm)</p> <p>X.X ±0.20 X.X' ±2'</p>	<p>X.XX ±0.15 X.XX' ±1'</p>	<p>CHECKED BY</p> <p>GISELLE</p>	<p>DATE</p> <p>19/Sept/23</p>	<p>TITLE</p> <p>Board to Board Floating Connector Pitch 0.5mm 180°Vertical (SMT)</p>	<p>REV 0</p>	
<p>SCALE</p> <p>5:1</p>	<p>SIZE</p> <p>A4</p>	<p>X.XXX ±0.10 X.XXX' ±0.5'</p>	<p>DRAWN BY</p> <p>Hejianpeng</p>	<p>DATE</p> <p>19/Sept/23</p>	<p>THIS DRAWING CONTAINS INFORMATION THAT IS PROPRIETARY TO TXGA INDUSTRIAL ELECTRONICS(S.Z)CO.,LTD AND SHOULD NOT BE USED WITHOUT WRITTEN PERMISSION</p>		

REV	LOCATIONS	DESCRIPTION	DATE	REVISER	APPD

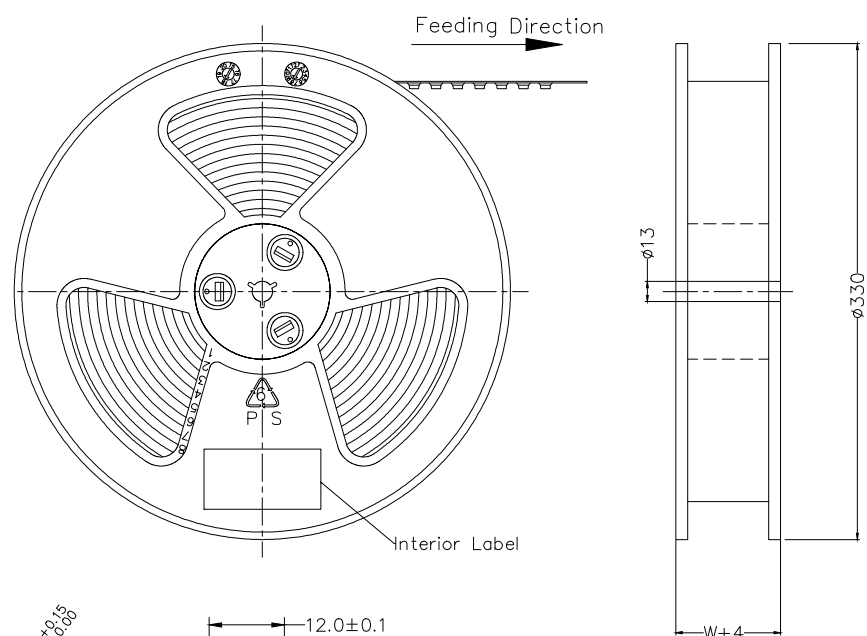

- Note:
- 1.0 sprocket hole cumulative tolerance  $\pm 0.2$
  2. Carrier camber is within 1.0mm in 250mm
  3. Material: White conductive polystyrene Alloy 100% recyclable
  4. All dimensions meet EIA-481-3 requirements
  5. Peel off force of cover tape & carrier tape: 20g~130g (0.2N~1.3N)
  6. Component load per 13" reel: 500 pcs

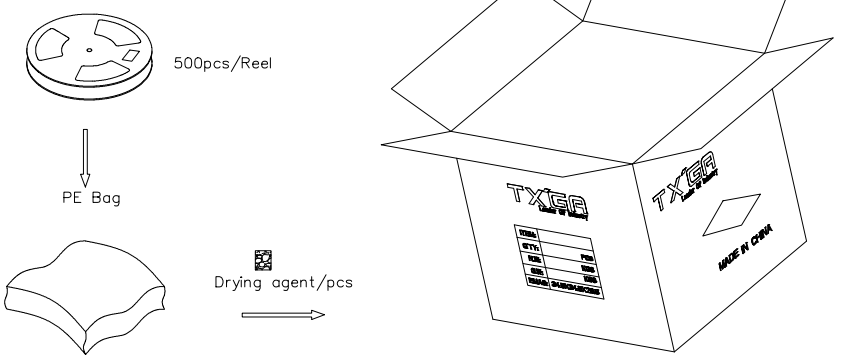
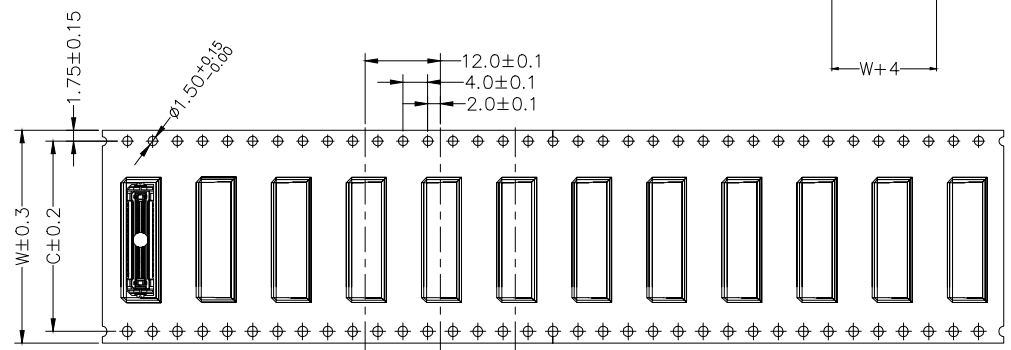
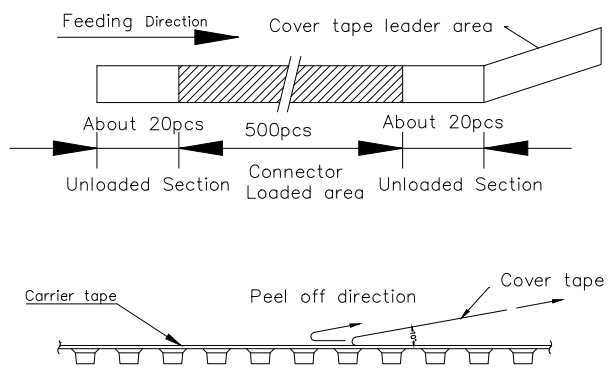

Feeding Direction

Circuits(n)	Dimensions	
	W	C
60	56	52.4
80	56	52.4
100	72	64.4
120	72	64.4

 THIRD ANGLE PROJECTION	GENERAL TOLERANCES (UNLESS SPECIFIED)		APPROVE BY LEO	DATE 19/Sept/23	PART NO. FBB05013-FXXS1XX3BKMHXX	ITEM NO. FBB05013	 Building Technology Cornerstone
	DESIGN UNITS METRIC(mm)	X. $\pm 0.30$	X.* $\pm 5^*$	CHECKED BY GISELLE	DATE 19/Sept/23	TITLE Board to Board Floating Connector Pitch 0.5mm 180°Vertical (SMT)	
SCALE 1:1	SIZE A4	X.XX $\pm 0.15$	X.XX* $\pm 1^*$	DRAWN BY Hejianpeng	DATE 19/Sept/23	THIS DRAWING CONTAINS INFORMATION THAT IS PROPRIETARY TO TXGA INDUSTRIAL ELECTRONICS(S,Z)CO.,LTD AND SHOULD NOT BE USED WITHOUT WRITTEN PERMISSION	
		X.XXX $\pm 0.10$	X.XXX* $\pm 0.5^*$			REV 0	SHEET NO. 2/2