

REV	LOCATIONS	DESCRIPTION	DATE	REVISER	APPD

**SPECIFICATION**

**Electrical**  
 Current Rating: 0.5A AC(rms)/DC (Signal Contact)  
 3A AC(rms)/DC (Power Contact)  
 Voltage Rating: 50V AC(rms)/DC (Signal Contact)  
 200V AC(rms)/DC (Power Contact)  
 Contact Resistance: 40 mΩ Max  
 Insulation Resistance: 100 MΩ MIN (Signal Contact)  
 1000 MΩ MIN (Power Contact)  
 Withstanding Voltage: 300V AC r.m.s  
 Temperature Range-Operating: -55°C~+85°C  
 Floating Ability : XY-AXIS±0.6MM

**Material**  
 Housing: LCP, (UL 94V-0)  
 Contact: Copper Alloy/Gold Plated  
 Metal Fittings : Copper Alloy/Tin 80u" Min. Over Nickel 50u"Min.

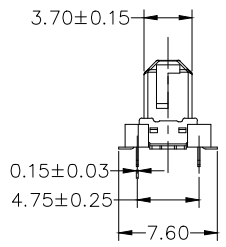
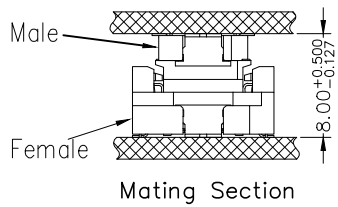
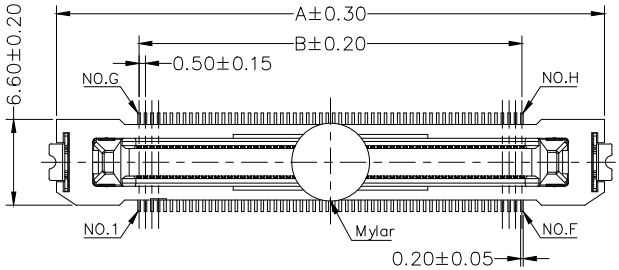

Circuits(n)	Part NO.	Dimensions					PIN NO.		
		A	B	C	D	E	F	G	H
60	FBB05013-M60S1XX3BKM H68	27.2	14.5	21.65	19.5	24.9	30	31	60
80	FBB05013-M80S1XX3BKM H68	32.2	19.5	26.65	24.5	29.9	40	41	80
100	FBB05013-M100S1XX3BKM H68	37.2	24.5	31.65	29.5	34.9	50	51	100
120	FBB05013-M120S1XX3BKM H68	42.2	29.5	36.65	34.5	39.9	60	61	120

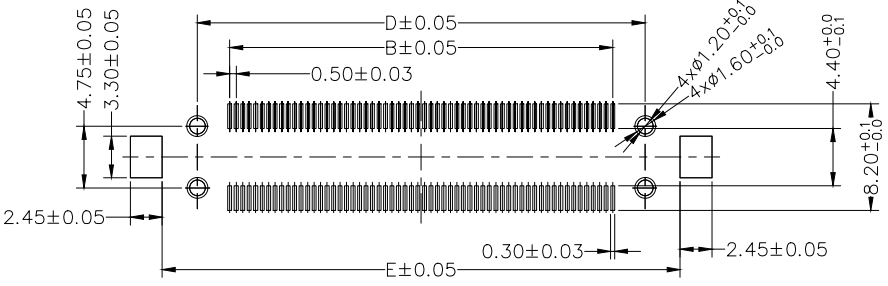
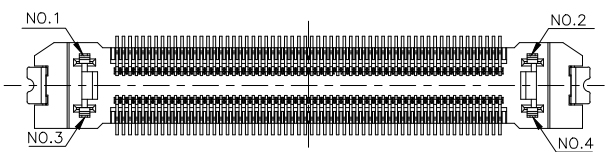

**Ordering Information**

FBB 050 13 M XX S 1 XX 3 BK M HXX  
 1 2 3 4 5 6 7 8 9 10 11 12

1	Category FBB-Board To Board	2	Series Number 050-Pitch0.50mm	3	Distinction No. 13	4	Type M-Male	5	Circuits XX	6	Entry Angle S-180°Vertical
7	Plating 1-Gold Plated	8	thickness of Gold Plating 00-Gold Flash 03-3u" 05-05u"	9	Material-Resin 3-LCP	10	Color-Resin BK-Black	11	Packaging M-Reel	12	Male height H68-6.85mm

Recommended P.C.Board Layout  
 General tolerances:±0.05

 THIRD ANGLE PROJECTION DESIGN UNITS METRIC(mm) SCALE 5:1 SIZE A4	GENERAL TOLERANCES (UNLESS SPECIFIED) X. ±0.30 X.* ±5° X.X ±0.20 X.X* ±2° X.XX ±0.15 X.XX* ±1° X.XXX ±0.10 X.XXX* ±0.5°		APPROVE BY LEO CHECKED BY GISELLE DRAWN BY Hejianpeng	DATE 19/Sept/23 DATE 19/Sept/23 DATE 19/Sept/23	PART NO. FBB05013-MXXS1XX3BKM HXX TITLE Board to Board Floating Connector Pitch 0.5mm 180°Vertical (SMT)	ITEM NO. FBB05013 THIS DRAWING CONTAINS INFORMATION THAT IS PROPRIETARY TO TXGA INDUSTRIAL ELECTRONICS(S.Z)CO.,LTD AND SHOULD NOT BE USED WITHOUT WRITTEN PERMISSION	 Building Technology Cornerstone REV 0 SHEET NO. 1/2
--	---	--	--	--	---	--	--

1 2 3 4 5 6 7 8

REV	LOCATIONS	DESCRIPTION	DATE	REVISER	APPD

Note:  
 1.10 sprocket hole cumulative tolerance±0.2  
 2.Carrier camber is within 1.0mm in 250mm  
 3.Material: White conductive polystyrene Alloy 100% recyclable  
 4.All dimensions meet EIA-481-3 requirements  
 5.Peel off force of cover tape & carrier tape: 20g~130g (0.2N~1.3N)  
 6.Component load per 13" reel: 500 pcs

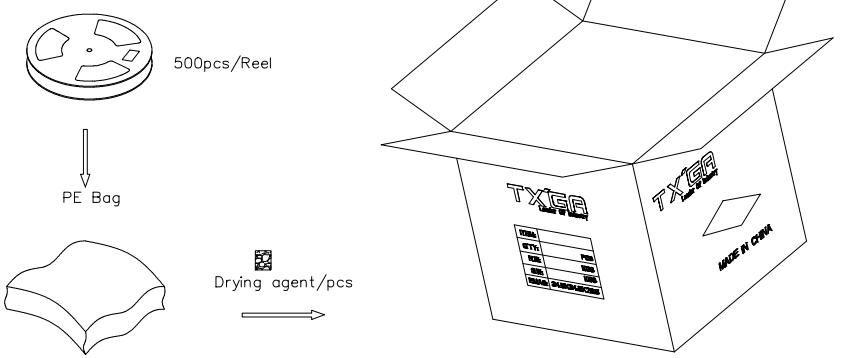
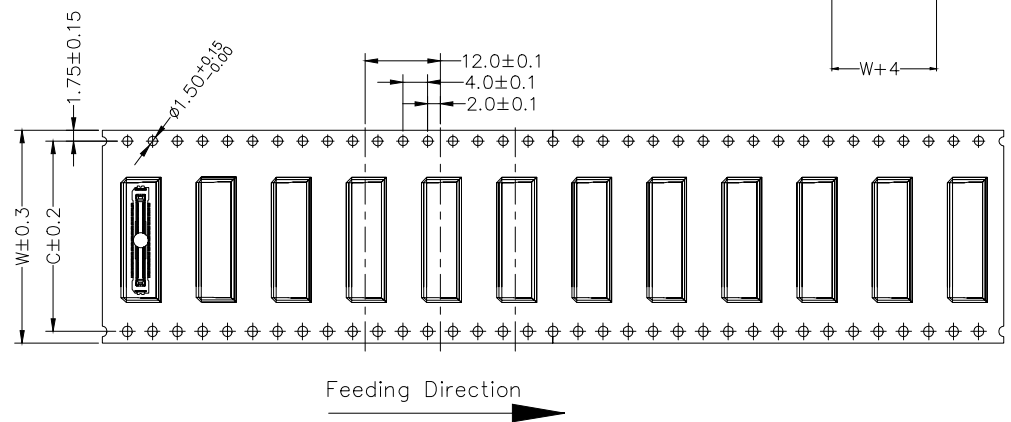
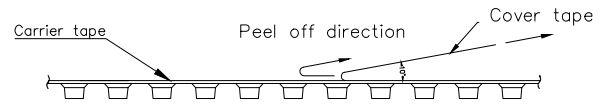
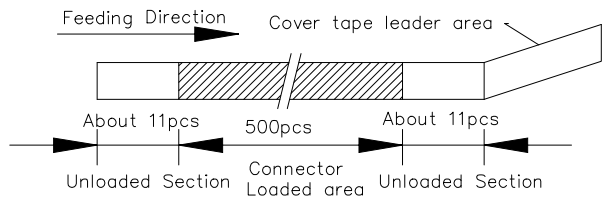
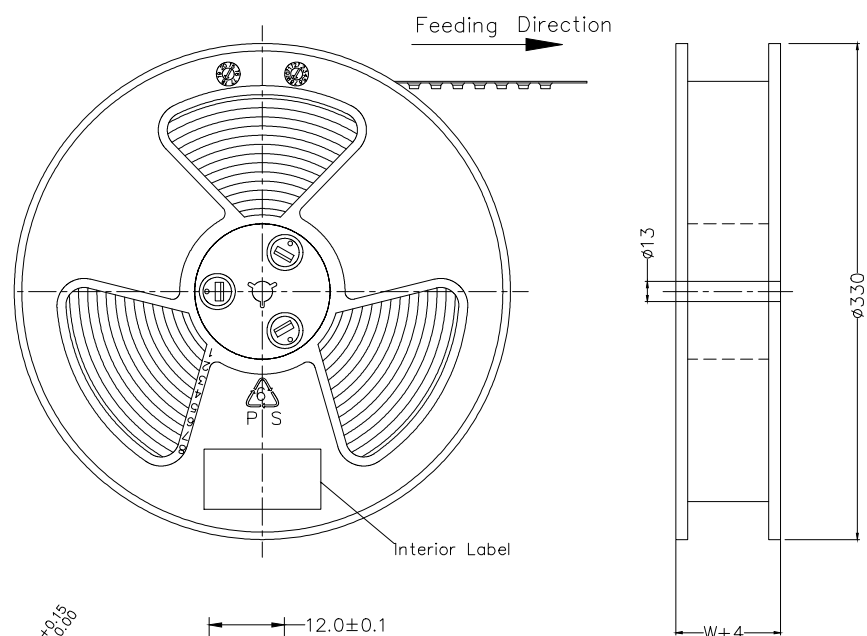

Circuits(n)	Dimensions	
	W	C
60	56	52.4
80	56	52.4
100	72	64.4
120	72	64.4

 THIRD ANGLE PROJECTION	GENERAL TOLERANCES (UNLESS SPECIFIED)		APPROVE BY	DATE	PART NO.	ITEM NO.	 Building Technology Cornerstone
	X. ±0.30	X.* ±5°	LEO	19/Sept/23	FBB05013-MXXS1XX3BKMHXX	FBB05013	
DESIGN UNITS METRIC(mm)	X.X ±0.20	X.X* ±2°	CHECKED BY	DATE	TITLE		THIS DRAWING CONTAINS INFORMATION THAT IS PROPRIETARY TO TXGA INDUSTRIAL ELECTRONICS(S,Z)CO.,LTD AND SHOULD NOT BE USED WITHOUT WRITTEN PERMISSION
SCALE 1:1	X.XX ±0.15	X.XX* ±1°	Hejianpeng	19/Sept/23	Board to Board Floating Connector Pitch 0.5mm 180°Vertical (SMT)		
SIZE A4	X.XXX ±0.10	X.XXX* ±0.5°	DRAWN BY	DATE	REV 0	SHEET NO. 2/2	

1 2 3 4 5 6 7 8