

REV	LOCATIONS	DESCRIPTION	DATE	REVISER	APPD

SPECIFICATIONS

Electrical
 Current Rating: 0.5A AC(rms)/DC
 Voltage Rating: 50V AC(rms)/DC
 Contact Resistance: 40 mΩ Max
 Insulation Resistance: 500 MΩ Min
 Withstanding Voltage: 200V AC r.m.s
 Operating Temperature: -25°C~+85°C

Material and plating
 Housing: LCP (UL 94V-0)
 Contacts: Copper Alloy/Gold plated

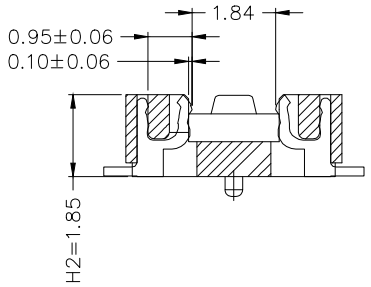
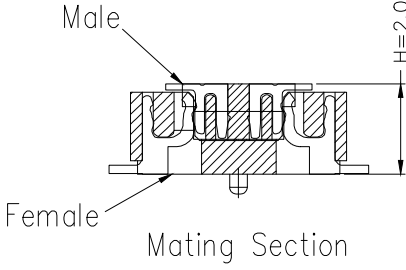
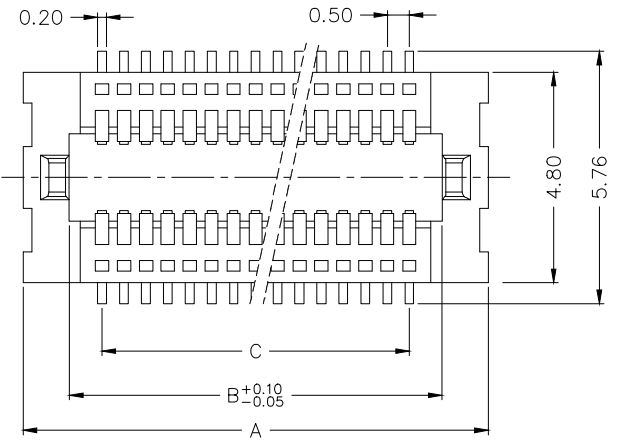

Circuits (n)	Part NO.	Dimensions			
		A	B	C	D
40	FBB05016-F40S1XX3NAMHXX	13.10	11.00	9.50	11.40
50	FBB05016-F50S1XX3NAMHXX	15.60	13.50	12.00	13.90
60	FBB05016-F60S1XX3NAMHXX	18.10	16.00	14.50	16.40
80	FBB05016-F80S1XX3NAMHXX	23.10	21.00	19.50	21.40

Dimensions(mm)				Female series
Height H	Male H1	Female H2	Female H3	
1.50	1.28	1.35	0.27	FBB05015-F
2.50	1.28	2.35	1.27	FBB05016-F
2.00	1.28	1.85	-	

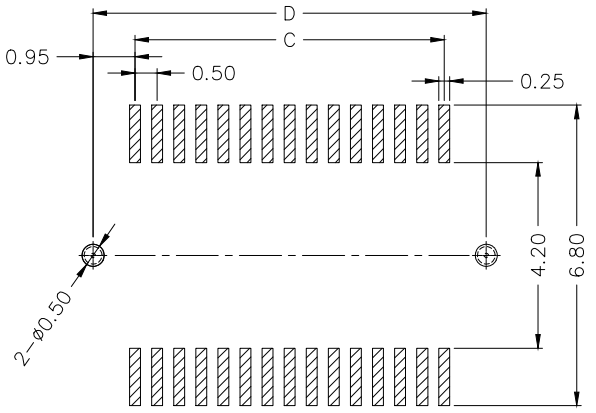
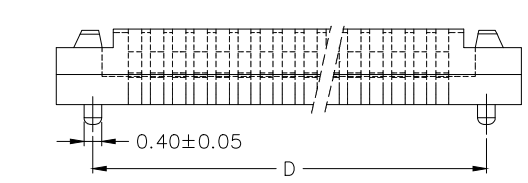

Recommended P.C.Board Layout
 General tolerances:±0.05

Ordering Information

FBB 050 16 - F XX S 1 XX 3 NA M HXX
 1 2 3 4 5 6 7 8 9 10 11 12

1 Category FBB-Board To Board	2 Series Number 050-Pitch0.50mm	3 Distinction No. 16	4 Type F-Female	5 Circuits XX	6 Entry Angle S-180°Vertical
7 Plating 1-Gold plated	8 thickness of Gold Plating 01-1u"	9 Material-Resin 3-LCP	10 Color-Resin NA-Natural	11 Packaging M-Reel	12 Female height H18-H2=1.85mm

<p>THIRD ANGLE PROJECTION</p>	<p>GENERAL TOLERANCES (UNLESS SPECIFIED)</p>		<p>APPROVE BY LEO</p>	<p>DATE 19/Sept/23</p>	<p>PART NO. FBB05016-FXXS1XX3NAMHXX</p>	<p>ITEM NO. FBB05016</p>	<p>Building Technology Cornerstone</p>	
	<p>X. ±0.30</p>	<p>X.* ±5*</p>	<p>CHECKED BY GISELLE</p>	<p>DATE 19/Sept/23</p>	<p>TITLE Board to Board Pitch 0.5mm 180°Vertical (SMT)</p>			<p>REV 0</p>
	<p>DESIGN UNITS METRIC(mm)</p>	<p>X.X ±0.20</p>	<p>X.X* ±2*</p>	<p>DRAWN BY Hejianpeng</p>	<p>DATE 19/Sept/23</p>	<p>THIS DRAWING CONTAINS INFORMATION THAT IS PROPRIETARY TO TXGA INDUSTRIAL ELECTRONICS(S.Z)CO.,LTD AND SHOULD NOT BE USED WITHOUT WRITTEN PERMISSION</p>		<p>SHEET NO. 1/2</p>

REV	LOCATIONS	DESCRIPTION	DATE	REVISER	APPD

Note:
 1.10 sprocket hole cumulative tolerance±0.2
 2.Carrier camber is within 1.0mm in 250mm
 3.Material: White conductive polystyrene Alloy 100% recyclable
 4.All dimensions meet EIA-481-3 requirements
 5.Peel off force of cover tape & carrier tape: 20g~130g (0.2N~1.3N)
 6.Component load per 13" reel: See table

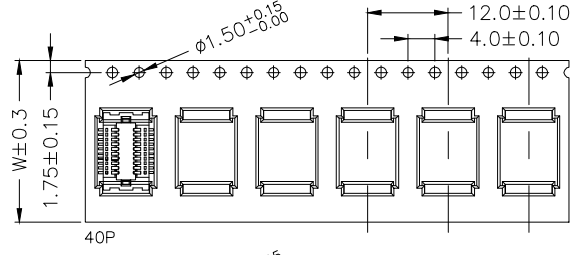
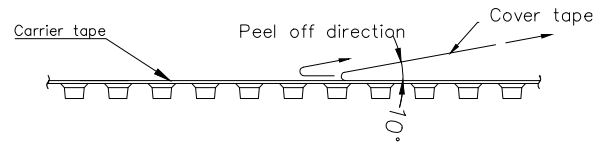
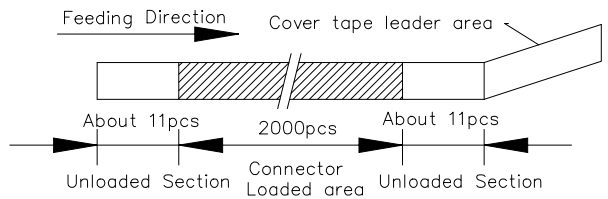
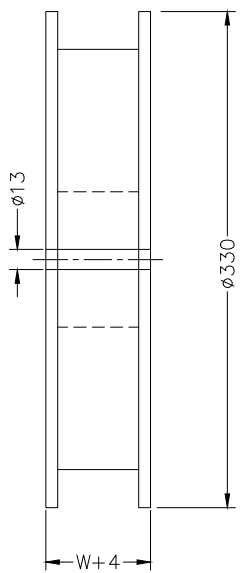
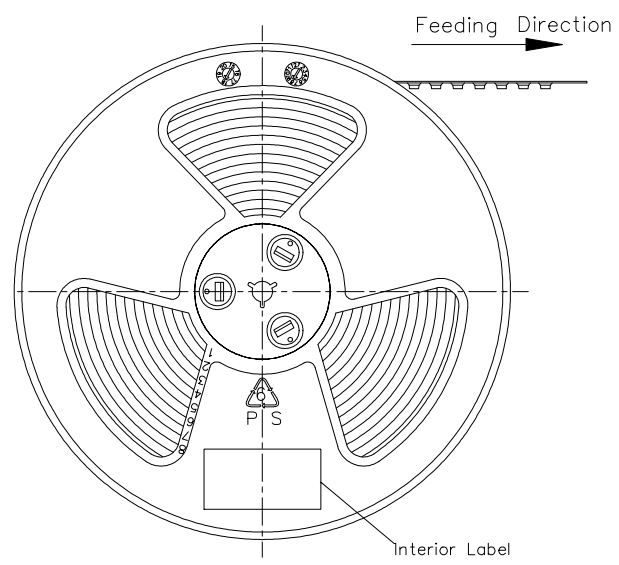

Circuits (n)	Dimensions	
	W	C
40	24	28.4
50-60	32	28.4
80	44	40.4

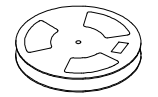

PE Bag

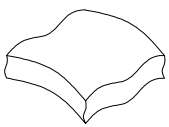

Drying agent/pcs

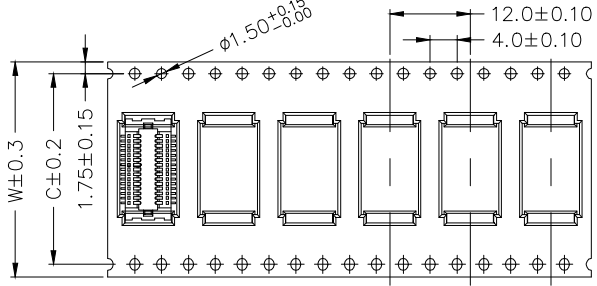
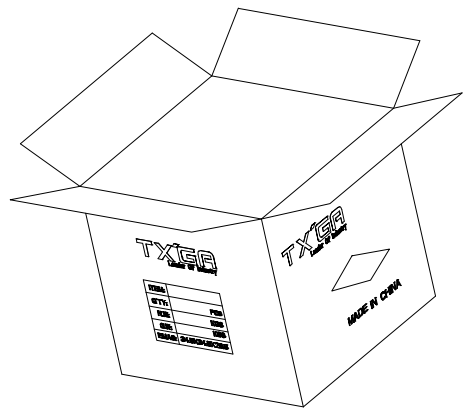

<p>THIRD ANGLE PROJECTION</p>	GENERAL TOLERANCES (UNLESS SPECIFIED)		APPROVE BY LEO	DATE 19/Sept/23	PART NO. FBB05016--FXXS1XX3NAMHXX	ITEM NO. FBB05016	<p>Building Technology Cornerstone</p>	
	X. ±0.30	X.' ±5°	CHECKED BY GISELLE	DATE 19/Sept/23	TITLE Board to Board Pitch 0.5mm 180°Vertical (SMT)			REV 0 SHEET NO. 2/2
	DESIGN UNITS METRIC(mm)	X.X ±0.20	X.X' ±2°	DRAWN BY Hejianpeng	DATE 19/Sept/23	THIS DRAWING CONTAINS INFORMATION THAT IS PROPRIETARY TO TXGA INDUSTRIAL ELECTRONICS(S,Z)CO.,LTD AND SHOULD NOT BE USED WITHOUT WRITTEN PERMISSION		
	SCALE 1:1	SIZE A4	X.XX ±0.15	X.XX' ±1°	X.XXX ±0.10	X.XXX' ±0.5°		