

REV	LOCATIONS	DESCRIPTION	DATE	REVISER	APPD

SPECIFICATIONS

Electrical
 Current Rating: 0.5A AC(rms)/DC
 Voltage Rating: 100V AC(rms)/DC
 Contact Resistance: 40 mΩ Max (Before Test)
 60 mΩ Max (After Test)
 Insulation Resistance: 1000 MΩ Min
 Withstanding Voltage: 250V AC r.m.s
 Operating Temperature: -55°C~+105°C

Material and plating
 Housing: LCP (UL 94V-0)
 Contacts: Copper Alloy/Selective gold plated on contact area and matte tin plated on tails area
 CAP: SUS T=0.2mm

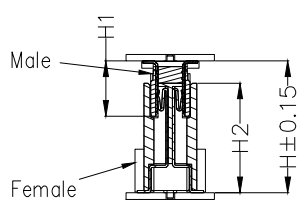
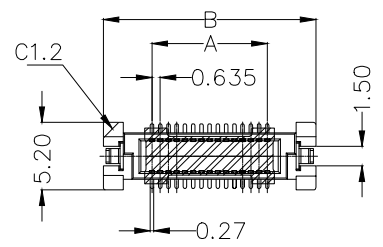

Mating Section

Dimensions(mm)		
Height H	Male H1	Female H2
10.00	5.00	8.00
12.00	5.00	10.00
13.00	6.00	10.00

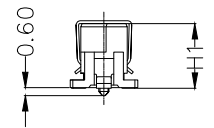
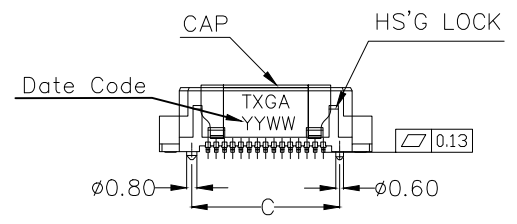

Circuits (n)	Part NO.	Dimensions				HS'G LOCK
		A	B	C	D	
20	FBB063501-M20S7XX3BKMHXX	5.715	13.22	8.22	9.32	With
30	FBB063501-M30S7XX3BKMHXX	8.89	16.4	11.4	12.5	
60	FBB063501-M60S7XX3BKMHXX	18.415	25.92	20.92	22.02	
70	FBB063501-M70S7XX3BKMHXX	21.59	29.1	24.1	25.2	
160	FBB063501-M160S7XX3BKMHXX	50.165	57.67	52.67	53.77	Without

Ordering Information

FBB 0635 01 — M XX S 7 XX 3 BK M HXX
 1 2 3 4 5 6 7 8 9 10 11 12

- 1 Category: FBB-Board To Board
- 2 Series Number: 0635-Pitch0.635mm
- 3 Distinction No.: 01
- 4 Type: M-Male
- 5 Circuits: XX
- 6 Entry Angle: S-180°Vertical
- 7 Plating: 7-Selective gold plated on contact area and matte tin plated on tails area
- 8 thickness of Gold Plating: 03-3u", 08-8u", 10-10u"
- 9 Material-Resin: 3-LCP
- 10 Color-Resin: BK-Black
- 11 Packaging: M-Reel
- 12 Male height: H50-H1=5.0mm, H60-H1=6.0mm

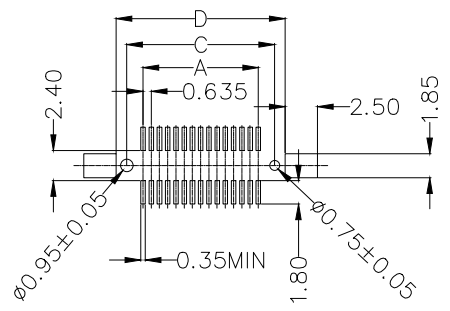

Recommended P.C.Board Layout
 General tolerances:±0.05

<p>THIRD ANGLE PROJECTION</p>	GENERAL TOLERANCES (UNLESS SPECIFIED) X. ±0.30 X.* ±5° X.X ±0.20 X.X* ±2° X.XX ±0.15 X.XX* ±1° X.XXX ±0.10 X.XXX* ±0.5°		APPROVE BY LEO	DATE 19/Sept/23	PART NO. FBB063501-MXXS7XX3BKMHXX	ITEM NO. FBB063501	<p>TXGA Building Technology Cornerstone</p>
	DESIGN UNITS METRIC(mm)	SCALE 5:1	SIZE A4	CHECKED BY GISELLE	DATE 19/Sept/23	TITLE Board to Board Pitch 0.635mm 180°Vertical (SMT)	
DRAWN BY Hejianpeng					DATE 19/Sept/23	THIS DRAWING CONTAINS INFORMATION THAT IS PROPRIETARY TO TXGA INDUSTRIAL ELECTRONICS(S.Z)CO.,LTD AND SHOULD NOT BE USED WITHOUT WRITTEN PERMISSION	

REV	LOCATIONS	DESCRIPTION	DATE	REVISER	APPD

Note:
 1.10 sprocket hole cumulative tolerance±0.2
 2.Carrier camber is within 1.0mm in 250mm
 3.Material: White conductive polystyrene Alloy 100% recyclable
 4.All dimensions meet EIA-481-3 requirements
 5.Peel off force of cover tape & carrier tape: 20g~130g (0.2N~1.3N)
 6.Component load per 13" reel: See table

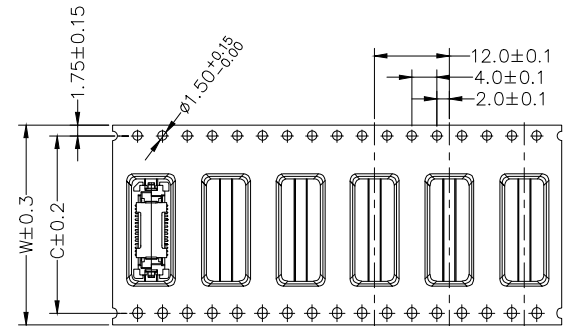
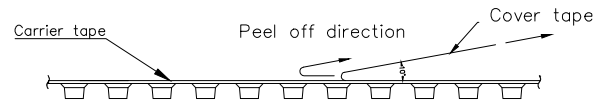
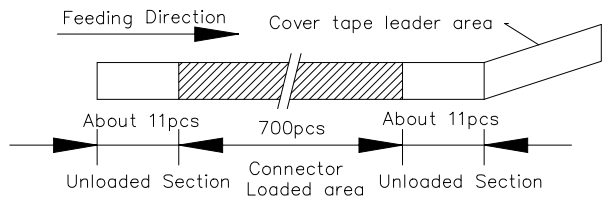
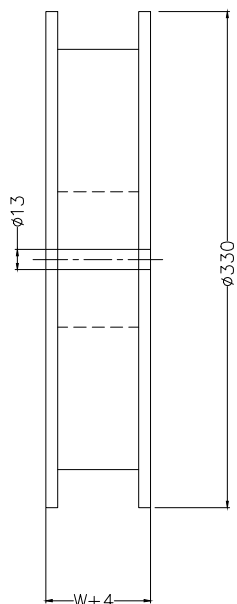
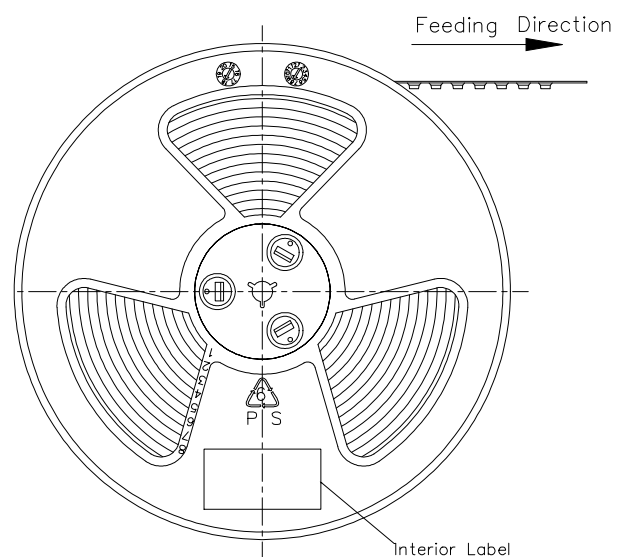

Circuits (n)	Dimensions		PCS/Reel	
	W	C	H1=5.0	H1=6.0
20-30	32	28.4	700PCS	700PCS
60-70	44	40.4	700PCS	700PCS
160	72	64.4	700PCS	700PCS

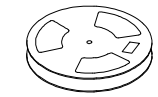

PE Bag

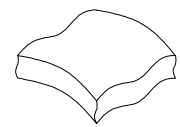

Drying agent/pcs

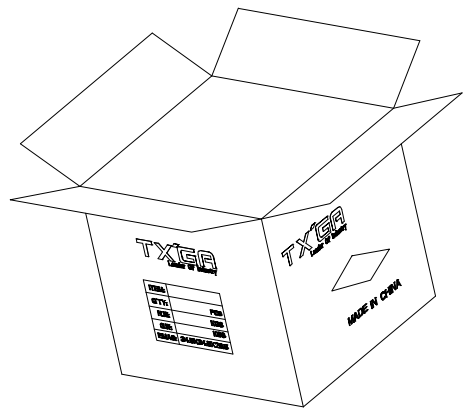

<p>THIRD ANGLE PROJECTION</p>	GENERAL TOLERANCES (UNLESS SPECIFIED)		APPROVE BY	DATE	PART NO.	ITEM NO.	<p>Building Technology Cornerstone</p>	
	X. ±0.30	X.* ±5°	LEO	19/Sept/23	FBB063501-MXXS7XX3BKMHXX	FBB063501		
	DESIGN UNITS METRIC(mm)		CHECKED BY	DATE	TITLE		REV 0	SHEET NO. 2/2
	X.X ±0.20	X.X* ±2°	GISELLE	19/Sept/23	Board to Board Pitch 0.635mm 180°Vertical (SMT)			
SCALE 1:1	SIZE A4	X.XX ±0.15	X.XX* ±1°	DRAWN BY	DATE	THIS DRAWING CONTAINS INFORMATION THAT IS PROPRIETARY TO TXGA INDUSTRIAL ELECTRONICS(S,Z)CO.,LTD AND SHOULD NOT BE USED WITHOUT WRITTEN PERMISSION		
		X.XXX ±0.10	X.XXX* ±0.5°	Hejianpeng	19/Sept/23			