

REV	LOCATIONS	DESCRIPTION	DATE	REVISER	APPD

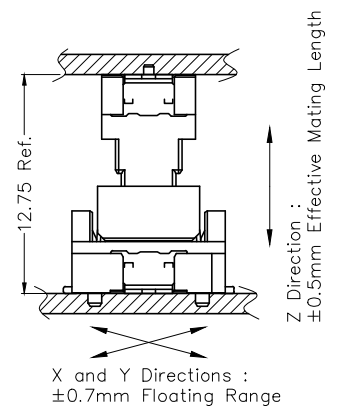
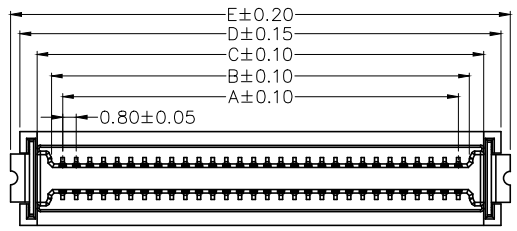

SPECIFICATIONS

Electrical
 Current Rating: 0.5A AC(rms)/DC
 Voltage Rating: 50V AC(rms)/DC
 Contact Resistance: 100 mΩ Max
 Insulation Resistance: 500 MΩ Min
 Withstanding Voltage: 250V AC r.m.s
 Temperature Range—Operating: $-40^{\circ}\text{C} \sim +105^{\circ}\text{C}$

Mechanical
 Durability: 30 cycles

Material
 Housing: Thermoplastic (UL 94V-0), Color: Black
 Contacts: Copper alloy/ Gold flash
 Solder tab: Copper alloy/ Bright tin plated

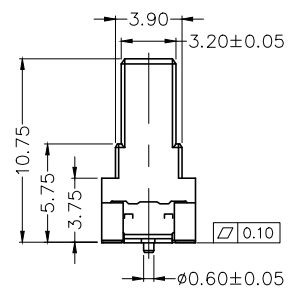
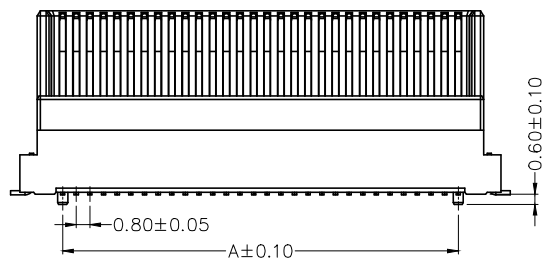

Ordering Information

FBB 080 10 — M XX S 1 00 3 BK M
 1 2 3 4 5 6 7 8 9 10 11

1 Category FBB—Board to Board	2 Series Number 080—Pitch 0.80mm	3 Distinction No. 10	4 Type M—Male	5 Circuits XX	6 Entry Angle S—180° Vertical
7 Plating 1—Gold plated	8 Thickness of Plating 00—Gold flash	9 Material—Resin 3—LCP	10 Color—Resin BK—Black	11 Packaging M—Reel	

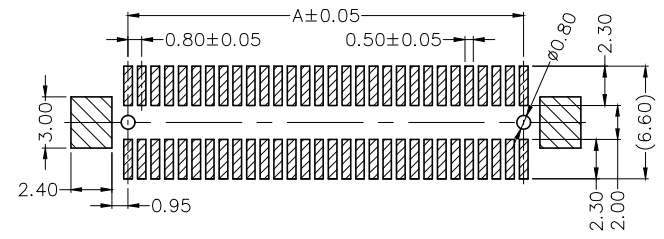
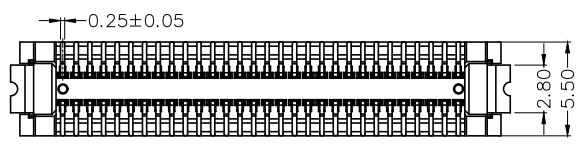

Recommended P.C.Board Layout
 General tolerances: ± 0.05

Circuits (n)	Part No.	Dimensions(in/mm)				
		A	B	C	D	E
30	FBB08010—M30S1003BKM	11.20	12.50	14.20	16.20	17.30
60	FBB08010—M60S1003BKM	23.20	24.50	26.20	28.20	29.30

 THIRD ANGLE PROJECTION	GENERAL TOLERANCES (UNLESS SPECIFIED) $X. \pm 0.30$ $X.' \pm 5'$		APPROVE BY FRANK	DATE 23/JUN/21	PART NO. FBB08010—MXXS1003BKM	ITEM NO. FBB08010	 Leader Of Industry
	DESIGN UNITS Metric $X.X \pm 0.20$ $X.X' \pm 2'$		CHECKED BY CHERRY	DATE 23/JUN/21	TITLE Board-to-Board Floating Connector Pitch 0.8mm 180° Vertical (SMT)		
SCALE 1:1	SIZE A4	$X.XX \pm 0.15$ $X.XX' \pm 1'$ $X.XXX \pm 0.10$ $X.XXX' \pm 0.5'$		DRAWN BY KATE	DATE 23/JUN/21	THIS DRAWING CONTAINS INFORMATION THAT IS PROPRIETARY TO TXGA INDUSTRIAL ELECTRONICS(S.Z)CO.,LTD AND SHOULD NOT BE USED WITHOUT WRITTEN PERMISSION	