

REV	LOCATIONS	DESCRIPTION	DATE	REVISER	APPD

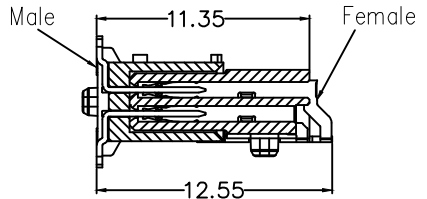

Mating Section

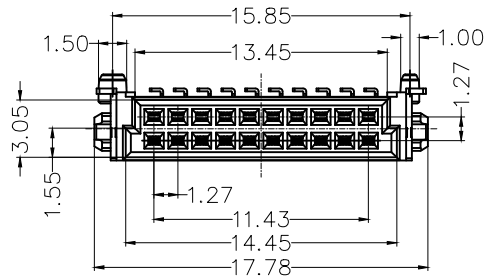
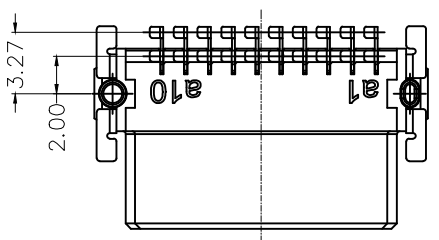
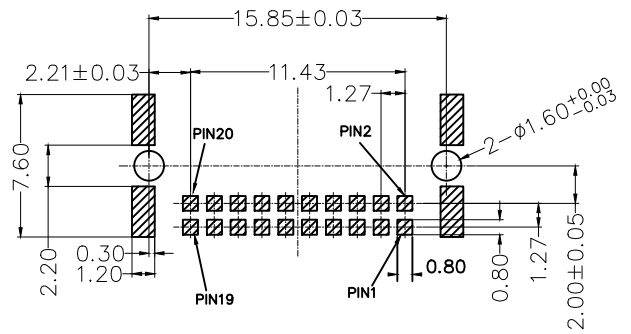
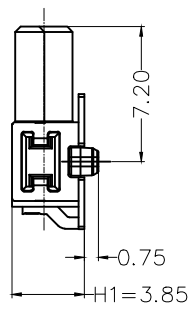
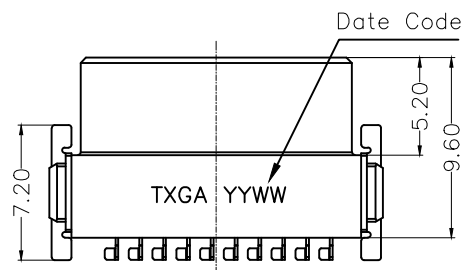

Recommended P.C.Board Layout  
General tolerances:±0.05

SPECIFICATIONS

Electrical

Current Rating: 3A AC(rms)/DC  
 Voltage Rating: 50V AC(rms)/DC  
 Contact Resistance: 35 mΩ Max  
 Insulation Resistance: 1000 MΩ Min  
 Withstanding Voltage: 500V AC r.m.s  
 Operating Temperature: -55°C~+125°C

Material and plating

Housing: LCP (UL 94V-0) Black  
 Contacts: Copper Alloy/Selective gold plated on contact area and matte tin plated on tails area  
 Pegs: Copper Alloy/Nickel plating

Ordering Information

FBB 127 07 - F 20 B 7 XX 3 BK M HXX  
 1 2 3 4 5 6 7 8 9 10 11 12

- 1 Category: FBB-Board to Board
- 2 Series Number: 127-Pitch1.27mm
- 3 Distinction No.: 07
- 4 Type: F-Female
- 5 Circuits: 20
- 6 Entry Angle: B-90° Angle
- 7 Plating: 7-Selective gold plated on contact area and matte tin plated on tails area
- 8 Thickness of Plating: 01-1u", 03-3u", 10-10u"
- 9 Material-Resin: 3-LCP
- 10 Color-Resin: BK-Black
- 11 Packaging: M-Reel
- 12 Male height: H38-H1=3.85mm

<p>THIRD ANGLE PROJECTION</p>	GENERAL TOLERANCES (UNLESS SPECIFIED)		APPROVE BY LEO	DATE 30/JAN/23	PART NO. FBB12707-F20B7XX3BKMHHX	ITEM NO. FBB12707	<p>Building Technology Cornerstone</p>
	X. ±0.30	X.* ±5°	CHECKED BY GISELLE	DATE 30/JAN/23	TITLE Board to Board Pitch 1.27mm 90° Angle (SMT)		
DESIGN UNITS METRIC(mm)	X.X ±0.20	X.X* ±2°	DRAWN BY Hejianpeng	DATE 30/JAN/23	THIS DRAWING CONTAINS INFORMATION THAT IS PROPRIETARY TO TXGA INDUSTRIAL ELECTRONICS(S.Z)CO.,LTD AND SHOULD NOT BE USED WITHOUT WRITTEN PERMISSION		
SCALE 1:1	SIZE A4	X.XX ±0.15	X.XX* ±1°				
		X.XXX ±0.10	X.XXX* ±0.5°				

1 2 3 4 5 6 7 8

REV	LOCATIONS	DESCRIPTION	DATE	REVISER	APPD

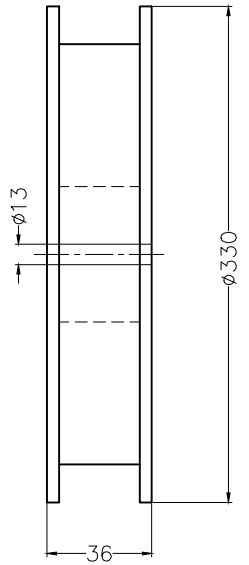
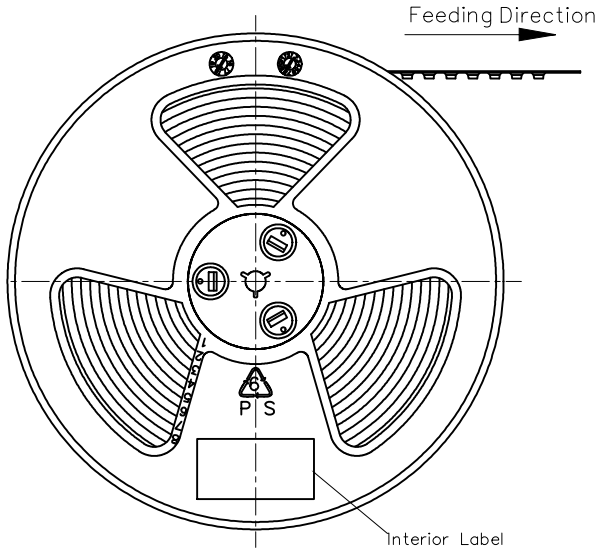

- Note:
- 1.10 sprocket hole cumulative tolerance  $\pm 0.2$
  2. Carrier camber is within 1.0mm in 250mm
  3. Material: Clear conductive polystyrene Alloy 100% recyclable
  4. All dimensions meet EIA-481-3 requirements
  5. Peel off force of cover tape & carrier tape: 20g~130g (0.2N~1.3N)
  6. Component load per 13" reel: 560 pcs

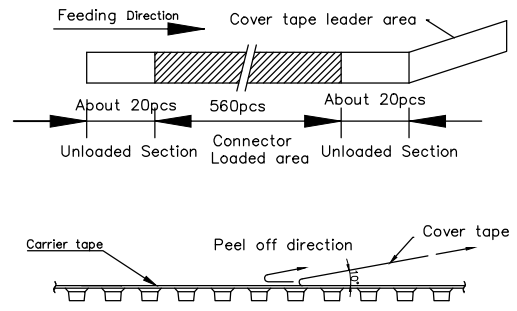

Feeding Direction

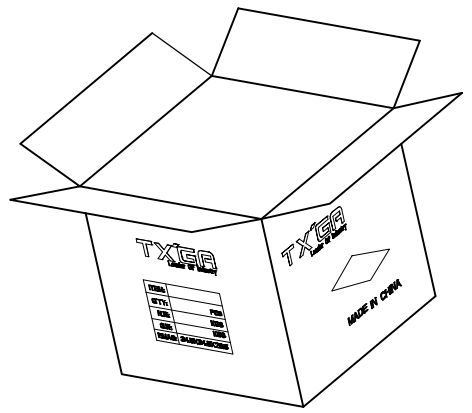
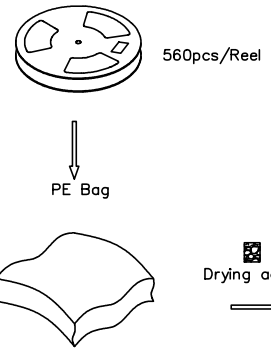
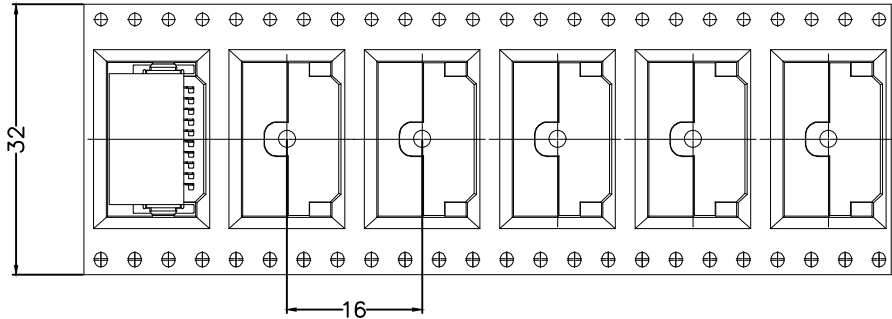

<p>THIRD ANGLE PROJECTION</p>	GENERAL TOLERANCES (UNLESS SPECIFIED)		APPROVE BY LEO	DATE 30/JAN/23	PART NO. FBB12707-F20B7XX3BKMHHX	ITEM NO. FBB12707	<p>Building Technology Cornerstone</p>	
	X. $\pm 0.30$	X.' $\pm 5^{\circ}$	CHECKED BY GISELLE	DATE 30/JAN/23	TITLE Board to Board Pitch 1.27mm 90° Angle (SMT)			REV 0
	DESIGN UNITS METRIC(mm)	X.X $\pm 0.20$	X.X' $\pm 2^{\circ}$	DRAWN BY Hejianpeng	DATE 30/JAN/23	THIS DRAWING CONTAINS INFORMATION THAT IS PROPRIETARY TO TXGA INDUSTRIAL ELECTRONICS(S,Z)CO.,LTD AND SHOULD NOT BE USED WITHOUT WRITTEN PERMISSION		
	SCALE 1:1	SIZE A4	X.XX $\pm 0.15$	X.XX' $\pm 1^{\circ}$	X.XXX $\pm 0.10$	X.XXX' $\pm 0.5^{\circ}$		

1 2 3 4 5 6 7 8