

| REV | LOCATIONS | DESCRIPTION | DATE | REVISER | APPD |
|-----|-----------|---------------------------|-----------|---------|--------|
| 1 | | Change the Material-Resin | 03/JUN/21 | KATE | CHERRY |

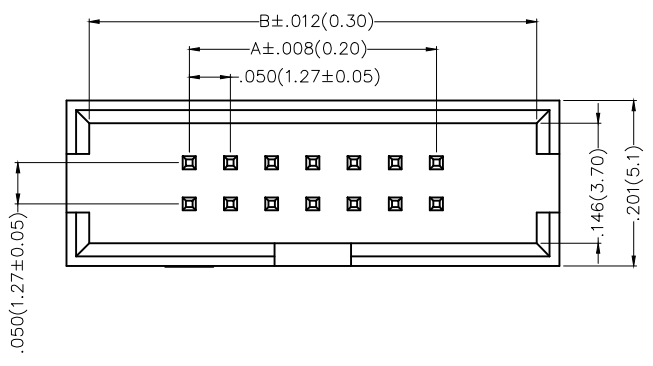

Electrical
 Current Rating: 1.0A AC(rms)/DC
 Voltage Rating: 250V AC(rms)/DC
 Contact Resistance: 20 mΩ Max
 Insulation Resistance: 1000 MΩ MIN
 Withstanding Voltage: 500V AC r.m.s
 Temperature Range-Operating: -40°C~+105°C

Material and Plating
 Insulator Material: PA9T (UL 94V-0)
 Contact Material: Brass /Gold Plated

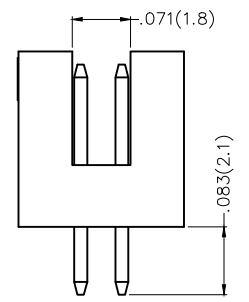
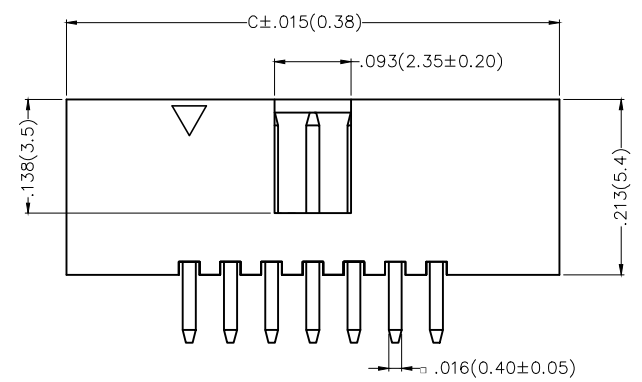

| Circuits (n) | Part No. | Dimensions(in/mm) | | |
|--------------|----------------------|-------------------|--------------|--------------|
| | | A | B | C |
| 10 | FBH12716-D10S1XX4K6L | .200(5.08) | .443(11.25) | .498(12.65) |
| 14 | FBH12716-D14S1XX4K6L | .300(7.62) | .543(13.79) | .598(15.19) |
| 16 | FBH12716-D16S1XX4K6L | .350(8.89) | .593(15.06) | .648(16.46) |
| 20 | FBH12716-D20S1XX4K6L | .450(11.43) | .693(17.60) | .748(19.00) |
| 26 | FBH12716-D26S1XX4K6L | .600(15.24) | .843(21.41) | .898(22.81) |
| 30 | FBH12716-D30S1XX4K6L | .700(17.78) | .943(23.95) | .998(25.35) |
| 34 | FBH12716-D34S1XX4K6L | .800(20.32) | 1.043(26.49) | 1.098(27.89) |
| 40 | FBH12716-D40S1XX4K6L | .950(24.13) | 1.193(30.30) | 1.248(31.70) |
| 50 | FBH12716-D50S1XX4K6L | 1.200(30.48) | 1.443(36.65) | 1.498(38.05) |
| 60 | FBH12716-D60S1XX4K6L | 1.450(36.83) | 1.693(43.00) | 1.748(44.40) |

Ordering Information

FBH 127 16 — D XX S 1 XX 4 K6 L
 1 2 3 4 5 6 7 8 9 10 11

| | | | | | | | | | | | |
|---|--------------------------------|---|----------------------------------|---|---|---|----------------------------|----|-------------------------|----|---------------------|
| 1 | Category FBH-Box Header | 2 | Series Number 127-Pitch1.27mm | 3 | Distinction No. 16 | 4 | Row Option D-Double Row | 5 | Circuits XX | | |
| 6 | Entry Angle S-180° Vertical | 7 | Plating 1-Gold Plated | 8 | Thickness of Plating 00-Gold Flash 03-3μ" Custom plate available | 9 | Material-Resin 4-PA9T | 10 | Color-Resin K6-Black | 11 | Packaging L-Tube |

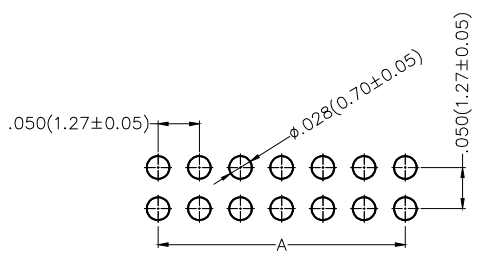

Recommended P.C.Board Layout

| | | | | | | | |
|--------------|---------------------------------------|---|--|--|----------------------------------|--|---------------|
| | GENERAL TOLERANCES (UNLESS SPECIFIED) | | APPROVE BY FRANK | DATE 20/APR/17 | PART NO. FBH12716-DXXS1XX4K6L | ITEM NO. FBH12716 | |
| | DESIGN UNITS Inch (metric) | X.X±.012(0.30) X.X±.008(0.20) X.XX±.006(0.15) X.XXX±.004(0.10) | X'±5' 'X'±2' 'XX'±1' 'XXX'±0.5' | CHECKED BY CHERRY | DATE 20/APR/17 | TITLE Wire to Board(Box Header) Pitch 1.27mm 180° Vertical (DIP) | |
| SCALE 5:1 | SIZE A4 | DRAWN BY LXF | DATE 20/APR/17 | THIS DRAWING CONTAINS INFORMATION THAT IS PROPRIETARY TO TXGA INDUSTRIAL ELECTRONICS(S.Z)CO.,LTD AND SHOULD NOT BE USED WITHOUT WRITTEN PERMISSION | | REV 1 | SHEET NO. 1/1 |