

REV	LOCATIONS	DESCRIPTION	DATE	REVISER	APPD

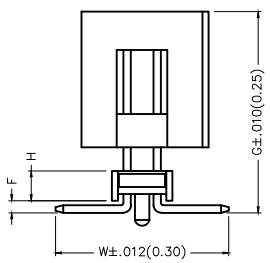
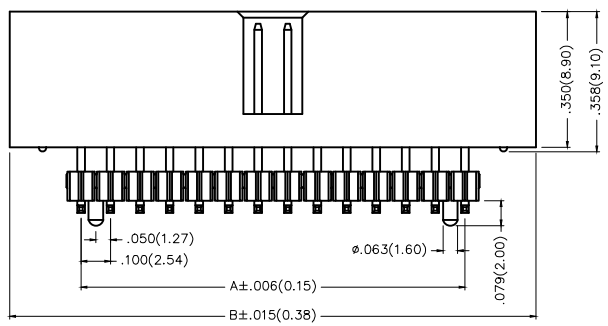
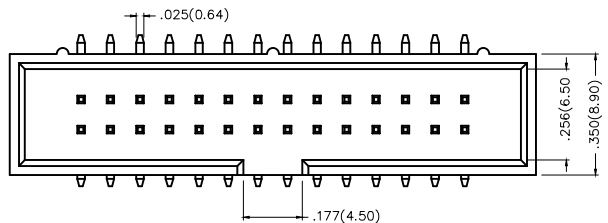

Electrical
 Current Rating: 3.0A AC(rms)/DC
 Voltage Rating: 250V AC(rms)/DC
 Contact Resistance: 20 mΩ Max
 Insulation Resistance: 1000 MΩ MIN
 Withstanding Voltage: 500V AC r.m.s
 Temperature Range—Operating: -40°C~+105°C

Material and Plating
 Housing: Polyester (UL94V-0)
 Contact Pin: Brass
 Plating: Gold Plated/Selective gold in contact area, tin on tail

Ordering Information

FBH 254 20 — D XX S X XX 4 K6 X XX
 1 2 3 4 5 6 7 8 9 10 11 12

1	Category FBH—Box Header	2	Series Number 254—Pitch 2.54mm	3	Distinction No. 20	4	Row Option D—Double Row	5	Row Option XX	6	Circuits XX	7	Entry Angle S—Vertical
7	Plating 1—Gold Plated 3—Selective gold in contact area, tin on tail	8	Thickness of Plating 00—Gold Flash 05—5μ" Custom plate available	9	Material—Resin 4—PA9T	10	Color—Resin K6—Black	11	Packaging K—Tray M—Reel	12	Size 01,02... —Serial number (See Table1) Custom Length Available		

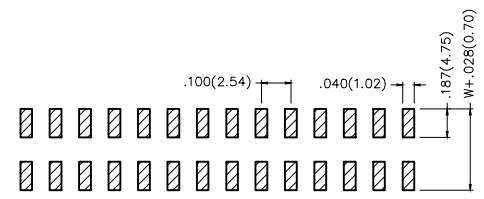

Recommended P.C.Board Layout

Circuits (h)	Part No.	Dimensions(in/mm)		Circuits (h)	Part No.	Dimensions(in/mm)	
		A	B			A	B
6	FBH25420-D06SXXX4K6XXX	.200(5.08)	.601(15.27)	30	FBH25420-D30SXXX4K6XXX	1.400(35.56)	1.901(45.75)
8	FBH25420-D08SXXX4K6XXX	.300(7.62)	.701(17.81)	32	FBH25420-D32SXXX4K6XXX	1.500(38.10)	1.901(48.29)
10	FBH25420-D10SXXX4K6XXX	.400(10.16)	.801(20.35)	34	FBH25420-D34SXXX4K6XXX	1.600(40.64)	2.001(50.83)
12	FBH25420-D12SXXX4K6XXX	.500(12.70)	.901(22.89)	40	FBH25420-D40SXXX4K6XXX	1.900(48.28)	2.301(58.45)
14	FBH25420-D14SXXX4K6XXX	.600(15.24)	1.101(25.43)	50	FBH25420-D50SXXX4K6XXX	2.400(60.96)	2.801(71.15)
16	FBH25420-D16SXXX4K6XXX	.700(17.78)	1.201(27.97)	60	FBH25420-D60SXXX4K6XXX	2.900(73.66)	3.301(83.85)
20	FBH25420-D20SXXX4K6XXX	.900(22.86)	1.401(33.05)	64	FBH25420-D64SXXX4K6XXX	3.100(78.74)	3.501(88.93)
26	FBH25420-D26SXXX4K6XXX	1.200(30.48)	1.701(40.67)				

<p>THIRD ANGLE PROJECTION</p>	GENERAL TOLERANCES (UNLESS SPECIFIED)		APPROVE BY FRANK	DATE 19/JUL/17	PART NO. FBH25420-DXXSXXX4K6XXX	ITEM NO. FBH25420	<p>Leader Of Industry</p>		
	X.±.012(0.30)	X.±5'	CHECKED BY CHERRY	DATE 19/JUL/17	TITLE Wire to Board(Box Header) Pitch 2.54mm Vertical 180°(SMT)			REV 0	SHEET NO. 1/2
	X.XX±.008(0.20)	.X'±2'	DRAWN BY JACOB	DATE 19/JUL/17	THIS DRAWING CONTAINS INFORMATION THAT IS PROPRIETARY TO TXGA INDUSTRIAL ELECTRONICS(S.Z)CO.,LTD AND SHOULD NOT BE USED WITHOUT WRITTEN PERMISSION				
	X.XX±.006(0.15)	.XX'±1'							
SCALE 5:1	SIZE A4	X.XXX±.004(0.10)	.XX'±0.5'						

1 2 3 4 5 6 7 8

REV	LOCATIONS	DESCRIPTION	DATE	REVISER	APPD

Table1

Serial number	Pin Length(in/mm)				Canceled No.	NOTE
	G	H	F	W		
01	.504(12.80)	.100(2.54)	.054(1.36)	.406(10.30)		
02	.713(18.10)	.100(2.54)	.054(1.36)	.406(10.30)		

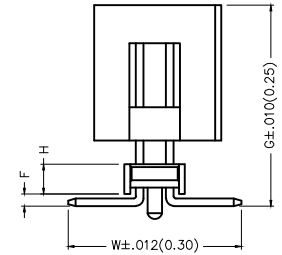

A
B
C
D
E
F

A
B
C
D
E
F

 THIRD ANGLE PROJECTION	GENERAL TOLERANCES (UNLESS SPECIFIED)		APPROVE BY FRANK	DATE 19/JUL/17	PART NO. FBH25420-DXXSXX4K6XXX	ITEM NO. FBH25420	 Leader Of Industry
	X.±.012(0.30)	X.±5°	CHECKED BY CHERRY	DATE 19/JUL/17	TITLE Wire to Board(Box Header) Pitch 2.54mm Vertical 180°(SMT)		
DESIGN UNITS Inch (metric)	X.X±.008(0.20)	.X°±2°	DRAWN BY JACOB	DATE 19/JUL/17	THIS DRAWING CONTAINS INFORMATION THAT IS PROPRIETARY TO TXGA INDUSTRIAL ELECTRONICS(S.Z)CO.,LTD AND SHOULD NOT BE USED WITHOUT WRITTEN PERMISSION		
SCALE 5:1	SIZE A4	X.XX±.006(0.15)	.XX°±1°	X.XXX±.004(0.10)	.XXX°±0.5°		

1 2 3 4 5 6 7 8