

REV	LOCATIONS	DESCRIPTION	DATE	REVISER	APPD
1	△	Add the "TXGA" logo	26/OCT/18	KATE	ANDY
2	△	1:Update structure and dimensions 2:Correction of coating description	25/DEC/25	MATT	LEO

SPECIFICATIONS

Electrical

Current Rating: 0.5A AC(rms)/DC
Voltage Rating: 50V AC(rms)/DC
Contact Resistance: 50 mΩ Max
Insulation Resistance: 100 MΩ MIN
Withstanding Voltage: 100V AC r.m.s
Durability Cycles: 5000 Cycles
Solder Ability: 245±5°C, 5±0.5°C
Temperature Range—Operating: -40°C~+85°C
Humidity: 80% R.H Max

Material and Plating

Housing: High Temperature Thermoplastic
(UL 94V-0) Black

- △ Contact: Copper Alloy/ Gold flash on contact area, Gold flash on tail, Nickel under overall
- △ Shell: Stainless Steel/Clear Only

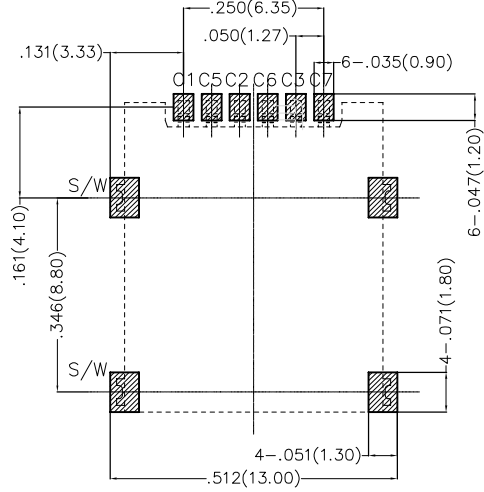
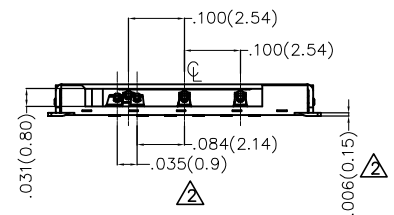
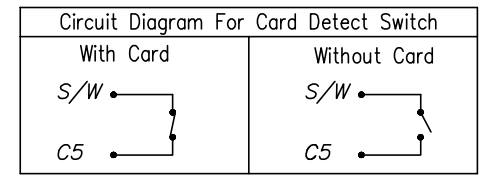
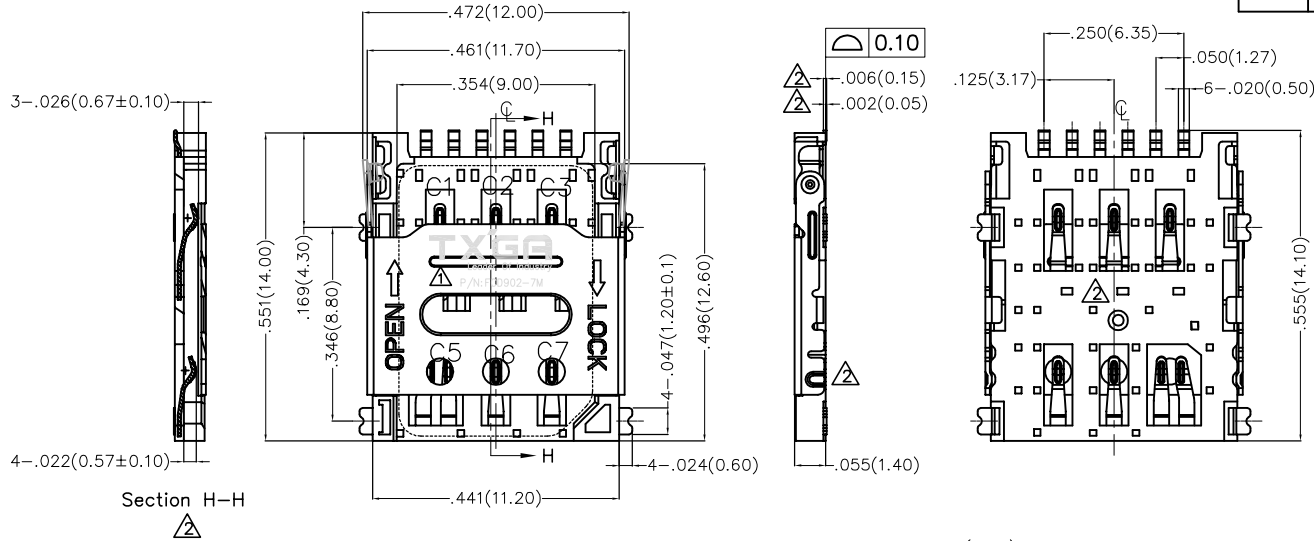

Recommended P.C.Board Layout
GENERAL TOLERANCES: ±0.05mm

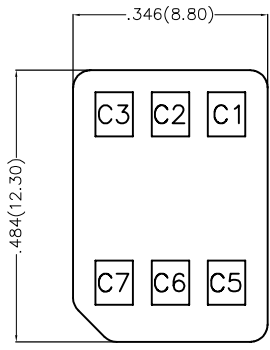

Part No.	Pin Name
C1	VCC
C2	RST
C3	CLK
C5	GND
C6	VPP
C7	I/O
S/W	Switch Pin

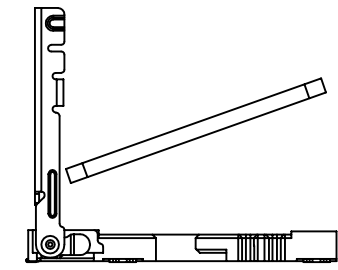

STEP 1 INSERT NANO SIM CARD

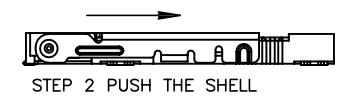

STEP 2 PUSH THE SHELL

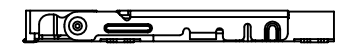

STEP 3 FINISH

 THIRD ANGLE PROJECTION DESIGN UNITS Inch (metric) SCALE 5:1 SIZE A4	GENERAL TOLERANCES (UNLESS SPECIFIED) X.±.014(0.35) X'±5' X.X±.012(0.30) .X'±2' X.XX±.008(0.20) .XX'±1' X.XXX±.004(0.10) .XXX'±0.5'		APPROVE BY VERNON CHECKED BY KATE DRAWN BY LXF	DATE 14/AUG/17 DATE 14/AUG/17 DATE 14/AUG/17	PART NO. FCD902-7M TITLE Nano SIM card connector(H:1.4mm) THIS DRAWING CONTAINS INFORMATION THAT IS PROPRIETARY TO TXGA INDUSTRIAL ELECTRONICS(S.Z)CO.,LTD AND SHOULD NOT BE USED WITHOUT WRITTEN PERMISSION	ITEM NO. FCD902 REV 2 SHEET NO. 1/2	 Building Technology Cornerstone
--	---	--	--	--	--	---	-------------------------------------

REV	LOCATIONS	DESCRIPTION	DATE	REVISER	APPD

Note:

- 10 sprocket hole cumulative tolerance ± 0.2
- Carrier camber is within 1.0mm in 100mm
- Material: White Conductive polystyrene Alloy 100% recyclable
- All dimensions meet EIA-481-3 requirements
- Component load per 13" reel: 1,500 pcs

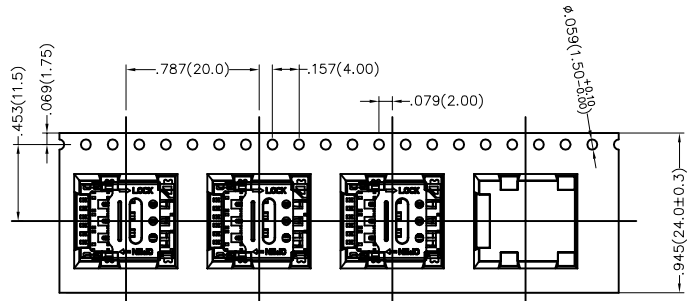
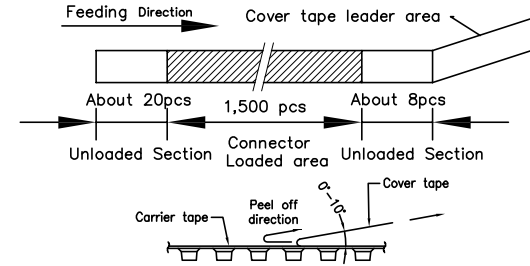
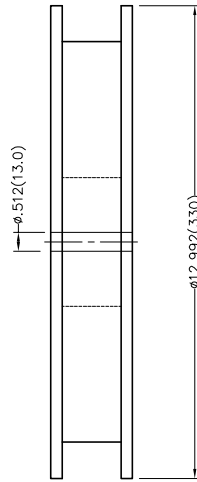
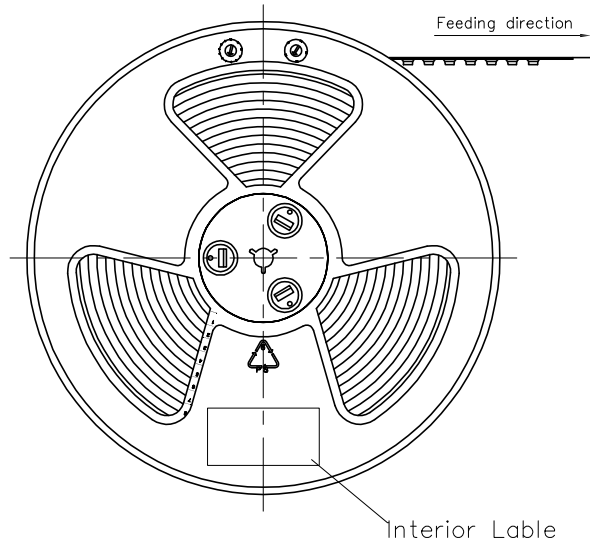

Feeding Direction →

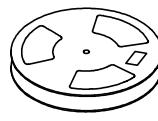

1,500 pcs/Reel

PE Bag

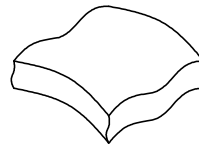

Drying agent/pcs

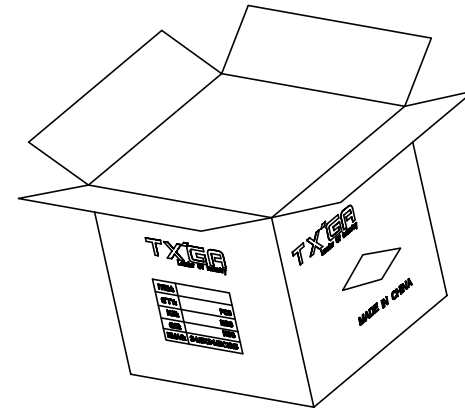

 THIRD ANGLE PROJECTION	GENERAL TOLERANCES (UNLESS SPECIFIED)		APPROVE BY VERNON	DATE 14/AUG/17	PART NO. FCD902-7M	ITEM NO. FCD902	 Building Technology Cornerstone	
	DESIGN UNITS Inch (metric)	X.±.012(0.30)	X.±5'	CHECKED BY KATE	DATE 14/AUG/17	TITLE Nano SIM card connector(H:1.4mm)		REV 2
SCALE 5:1	SIZE A4	X.XX±.006(0.15)	.XX±1'	DRAWN BY LXF	DATE 14/AUG/17	THIS DRAWING CONTAINS INFORMATION THAT IS PROPRIETARY TO TXGA INDUSTRIAL ELECTRONICS(S.Z)CO.,LTD AND SHOULD NOT BE USED WITHOUT WRITTEN PERMISSION		
		X.XXX±.004(0.10)	.XXX±0.5'					