

REV	LOCATIONS	DESCRIPTION	DATE	REVISER	APPD

SPECIFICATIONS

Electrical
 Current Rating: 1A AC(rms)/DC
 Voltage Rating: 250V AC(rms) 500V DC
 Contact Resistance: 35 mΩ Max
 Insulation Resistance: 500 MΩ Min
 Withstanding Voltage: 500V AC r.m.s
 Temperature Range—Operating: -25°C~+85°C

Material and Plating
 Housing: PBT+G.F.30% (UL 94V-0), Black
 Contact: Phosphor bronze/ Selective gold plated on contact area and tin plated on tails area
 Shell: SPCC/ Nickel plated

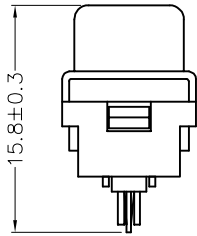
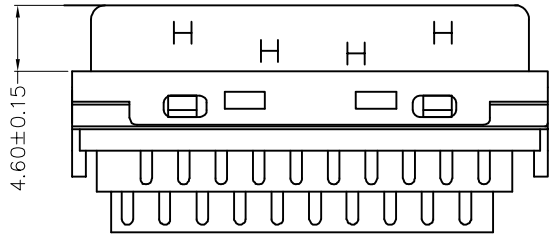
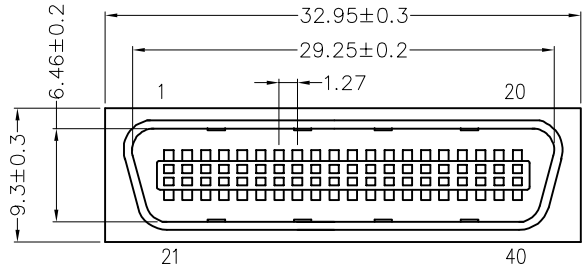

Ordering Information

FCS 40 08 — MO W S 3 XX BK K
 1 2 3 4 5 6 7 8 9 10

1	Category FCS-SCSI	2	Circuits 40	3	Distinction No. 11	4	Type MO—Male	5	Assembly Layout W—Welding Type	6	Entry Angle S—180° Vertical
7	Plating 3—Selective gold plated on contact area and tin plated on tails area		8	Thickness of Plating 05—5μ" Custom plate available		9	Color—Resin BK—Black		10	Packaging K—Tray	

<p>THIRD ANGLE PROJECTION</p>	GENERAL TOLERANCES (UNLESS SPECIFIED)		APPROVE BY FRANK	DATE 26/APR/21	PART NO. FCS4008—MOWS3XXBKK	ITEM NO. FCS4008	<p>Leader Of Industry</p>		
	X. ±0.30	X.* ±5°	CHECKED BY CHERRY	DATE 26/APR/21	TITLE SCSI Connector Pitch 1.27mm 180° Vertical Male			REV 0	SHEET NO. 1/1
	X.X ±0.20	X.X* ±2°	DRAWN BY KATE	DATE 26/APR/21	THIS DRAWING CONTAINS INFORMATION THAT IS PROPRIETARY TO TXGA INDUSTRIAL ELECTRONICS(S.Z)CO.,LTD AND SHOULD NOT BE USED WITHOUT WRITTEN PERMISSION				
SCALE 5:1	SIZE A4	X.XX ±0.15	X.XX* ±1°	X.XXX ±0.10	X.XXX* ±0.5°				