

REV	LOCATIONS	DESCRIPTION	DATE	REVISER	APPD
1	△	Change the P.C.Board layout	15/MAR/21	KATE	CHERRY
2	△	Update the shell structure and dimensions	05/JAN/24	MATT	LEO
3	△	Add marking code	28/FEB/26	NICK	LEO

SPECIFICATIONS

Electrical
 Current Rating: 1A AC(rms)/DC
 Voltage Rating: 250V AC(rms)/DC
 Contact Resistance: 30 mΩ Max
 Insulation Resistance: 500 MΩ Min
 Withstanding Voltage: 500V AC r.m.s
 Temperature Range—Operating: -55°C~+105°C

Material and Plating
 Housing: PBT (UL 94V-0)
 Contact: Phosphor Bronze
 Contact plating: Selective gold in contact area, tin on tail
 Shell: Zinc Alloy

Ordering Information

FCS 68 02 — F0 D S 3 XX K6 K A
 1 2 3 4 5 6 7 8 9 10 11

1	Category FCS-SCSI	2	Circuits 68	3	Distinction No. 02	4	Type F0-Female	5	Assembly Layout D-DIP	6	Entry Angle S-180° Vertical
7	Plating 3-Selective gold in contact area, tin on tail	8	Thickness of Plating 00-Gold flash 03-3μ" Custom plate available	9	Color-Resin K6-Black	10	Packaging K-Tray	11	Distinction Type A-Type A		

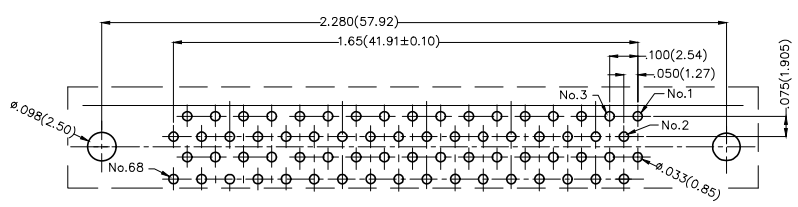
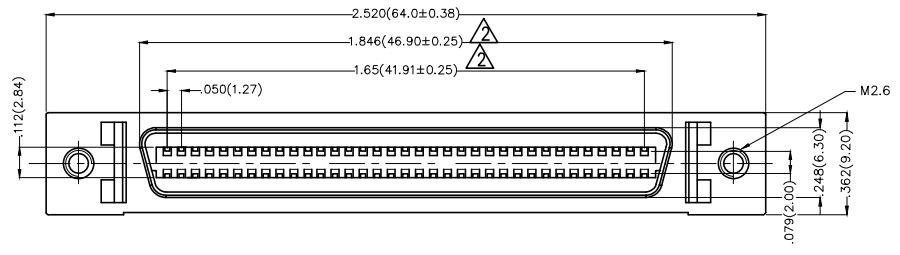
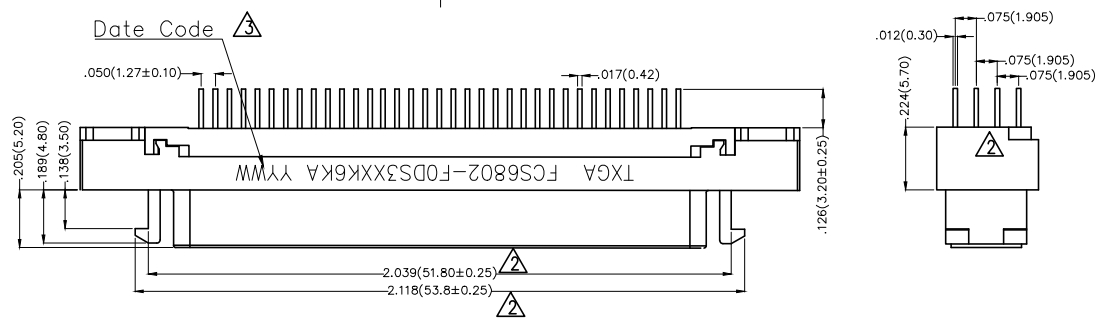
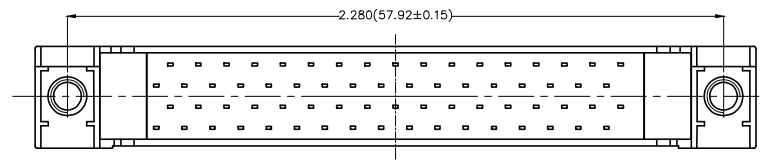

Recommended P.C.Board Layout
 General Tolerances: ±0.05mm

THIRD ANGLE PROJECTION	GENERAL TOLERANCES (UNLESS SPECIFIED)		APPROVE BY FRANK	DATE 19/JUL/13	PART NO. FCS6802-FODS3XXK6KA	ITEM NO. FCS6802		
	DESIGN UNITS Inch (metric)	X.±.012(0.30) X.X±.008(0.20) X.XX±.006(0.15) X.XXX±.004(0.10)	X.±5' .X'±2' .XX'±1' .XXX'±0.5'	CHECKED BY CHERRY	DATE 19/JUL/13	TITLE SCSI Connector Pitch 1.27mm 180° Vertical Female		
SCALE 5:1	SIZE A4		DRAWN BY KEVIN	DATE 19/JUL/13	THIS DRAWING CONTAINS INFORMATION THAT IS PROPRIETARY TO TXGA INDUSTRIAL ELECTRONICS(S.Z)CO.,LTD AND SHOULD NOT BE USED WITHOUT WRITTEN PERMISSION		REV 3	SHEET NO. 1/1

REV	LOCATIONS	DESCRIPTION	DATE	REVISER	APPD
1	△	Change the P.C.Board layout	15/MAR/21	KATE	CHERRY
2	△	Update the shell structure and dimensions	05/JAN/24	MATT	LEO
3	△	Add marking code	28/FEB/26	NICK	LEO

SPECIFICATIONS

Electrical
 Current Rating: 1A AC(rms)/DC
 Voltage Rating: 250V AC(rms)/DC
 Contact Resistance: 30 mΩ Max
 Insulation Resistance: 500 MΩ Min
 Withstanding Voltage: 500V AC r.m.s
 Temperature Range—Operating: -55°C~+105°C

Material and Plating
 Housing: PBT (UL 94V-0)
 Contact: Phosphor Bronze
 Contact plating: Selective gold in contact area, tin on tail
 Shell: Zinc Alloy

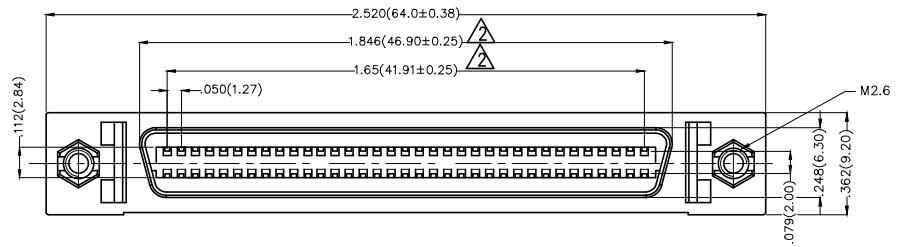
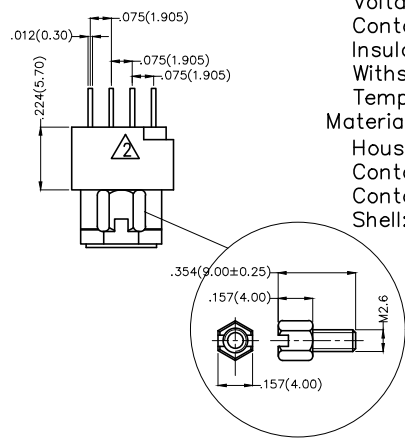
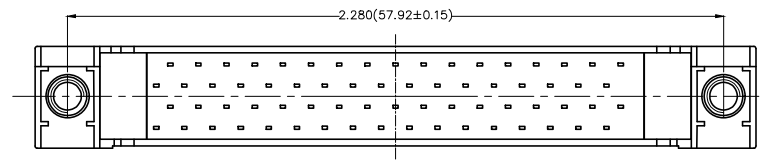

Ordering Information

FCS 68 02 — F0 D S 3 XX K6 K B
 1 2 3 4 5 6 7 8 9 10 11

1	Category FCS-SCSI	2	Circuits 68	3	Distinction No. 02	4	Type F0-Female	5	Assembly Layout D-DIP	6	Entry Angle S-180° Vertical
7	Plating 3-Selective gold in contact area, tin on tail	8	Thickness of Plating 00-Gold flash 03-3μ" Custom plate available	9	Color-Resin K6-Black	10	Packaging K-Tray	11	Distinction Type B-Type B		

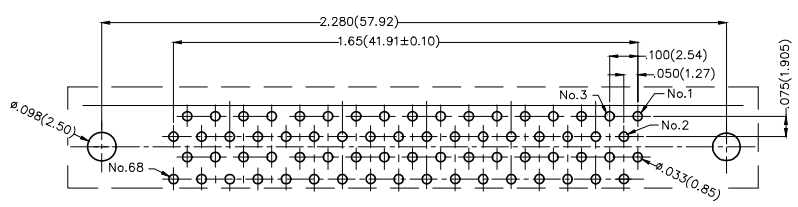

Recommended P.C.Board Layout
 General Tolerances: ±0.05mm

THIRD ANGLE PROJECTION	GENERAL TOLERANCES (UNLESS SPECIFIED)		APPROVE BY FRANK	DATE 19/JUL/13	PART NO. FCS6802-FODS3XXK6KB	ITEM NO. FCS6802		
	X.±.012(0.30)	X.±5'	CHECKED BY CHERRY	DATE 19/JUL/13	TITLE SCSI Connector Pitch 1.27mm 180° Vertical Female			
DESIGN UNITS Inch (metric)	X.X±.008(0.20)	.X'±2'	DRAWN BY KEVIN	DATE 19/JUL/13	THIS DRAWING CONTAINS INFORMATION THAT IS PROPRIETARY TO TXGA INDUSTRIAL ELECTRONICS(S.Z)CO.,LTD AND SHOULD NOT BE USED WITHOUT WRITTEN PERMISSION		REV 3	SHEET NO. 1/1
SCALE 5:1	SIZE A4	X.XX±.006(0.15)						

REV	LOCATIONS	DESCRIPTION	DATE	REVISER	APPD
1	△	Change the P.C.Board layout	15/MAR/21	KATE	CHERRY
2	△	Update the shell structure and dimensions	05/JAN/24	MATT	LEO
3	△	Add marking code	28/FEB/26	NICK	LEO

SPECIFICATIONS

Electrical
 Current Rating: 1A AC(rms)/DC
 Voltage Rating: 250V AC(rms)/DC
 Contact Resistance: 30 mΩ Max
 Insulation Resistance: 500 MΩ Min
 Withstanding Voltage: 500V AC r.m.s
 Temperature Range—Operating: -55°C~+105°C

Material and Plating
 Housing: PBT (UL 94V-0)
 Contact: Phosphor Bronze
 Contact plating: Selective gold in contact area, tin on tail
 Shell: Zinc Alloy

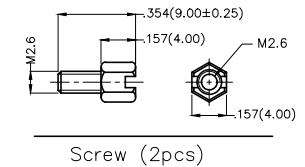

Ordering Information

FCS 68 02 — F0 D S 3 XX K6 K C
 1 2 3 4 5 6 7 8 9 10 11

1	Category FCS-SCSI	2	Circuits 68	3	Distinction No. 02	4	Type F0-Female	5	Assembly Layout D-DIP	6	Entry Angle S-180° Vertical
7	Plating 3-Selective gold in contact area, tin on tail	8	Thickness of Plating 00-Gold flash 03-3μ" Custom plate available	9	Color-Resin K6-Black	10	Packaging K-Tray	11	Distinction Type C-Type C		

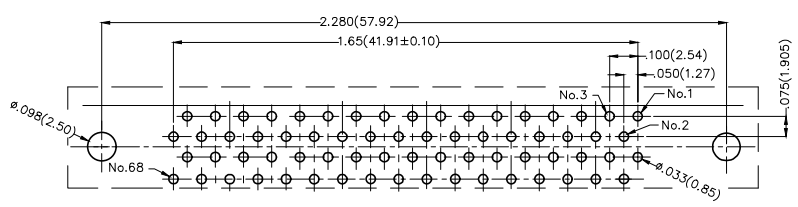
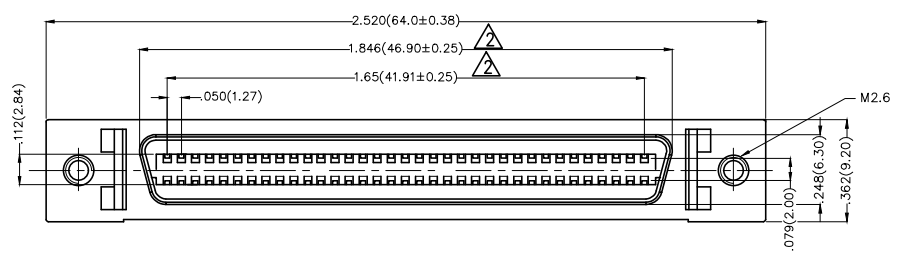
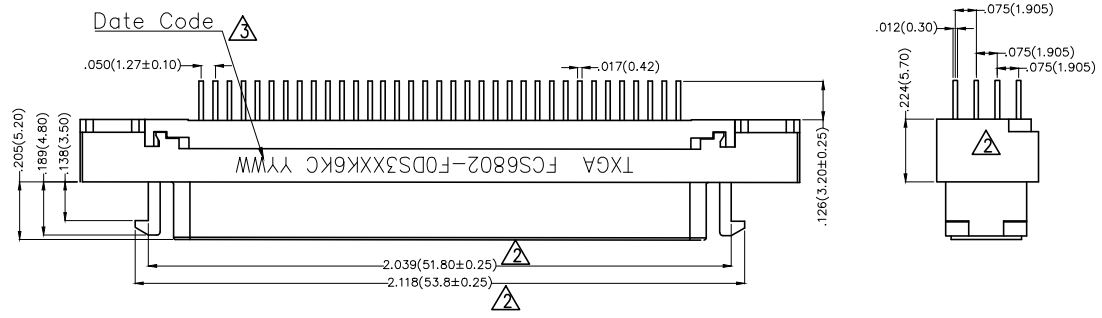
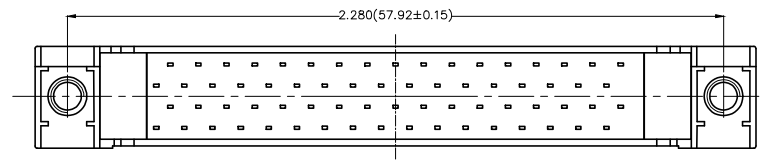

Recommended P.C.Board Layout
 General Tolerances: ±0.05mm

THIRD ANGLE PROJECTION	GENERAL TOLERANCES (UNLESS SPECIFIED)		APPROVE BY FRANK	DATE 19/JUL/13	PART NO. FCS6802-FODS3XXK6KC	ITEM NO. FCS6802	 Building Technology Cornerstone	
	DESIGN UNITS Inch (metric)	X.±.012(0.30) X.X±.008(0.20) X.XX±.006(0.15) X.XXX±.004(0.10)	X.±5' .X'±2' .XX'±1" .XXX'±0.5"	CHECKED BY CHERRY	DATE 19/JUL/13	TITLE SCSI Connector Pitch 1.27mm 180° Vertical Female		REV 3
SCALE 5:1	SIZE A4		DRAWN BY KEVIN	DATE 19/JUL/13	THIS DRAWING CONTAINS INFORMATION THAT IS PROPRIETARY TO TXGA INDUSTRIAL ELECTRONICS(S.Z)CO.,LTD AND SHOULD NOT BE USED WITHOUT WRITTEN PERMISSION			

REV	LOCATIONS	DESCRIPTION	DATE	REVISER	APPD

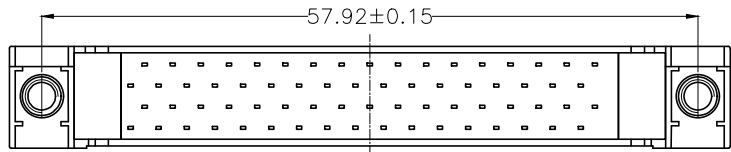

SPECIFICATIONS

Electrical
 Current Rating: 1A AC(rms)/DC
 Voltage Rating: 250V AC(rms)/DC
 Contact Resistance: 30 mΩ Max
 Insulation Resistance: 500 MΩ Min
 Withstanding Voltage: 500V AC r.m.s
 Temperature Range—Operating: -55°C~+105°C

Material and Plating
 Housing: PBT (UL 94V-0)
 Contact: Phosphor Bronze
 Contact plating: Selective gold in contact area, tin on tail
 Shell: Zinc Alloy
 Screw: Copper Alloy/Nickel Plated

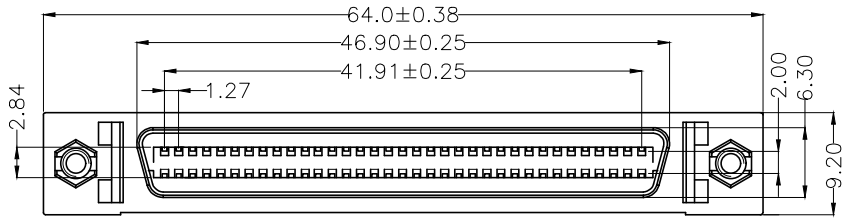
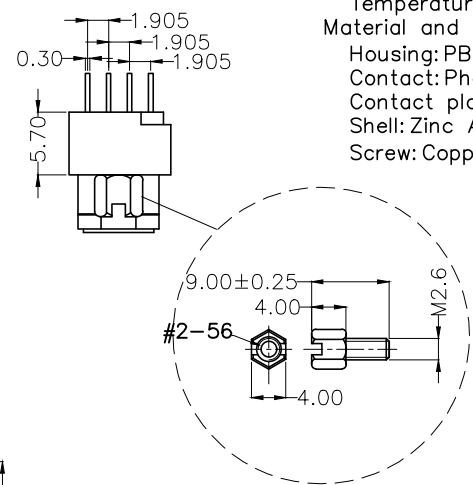
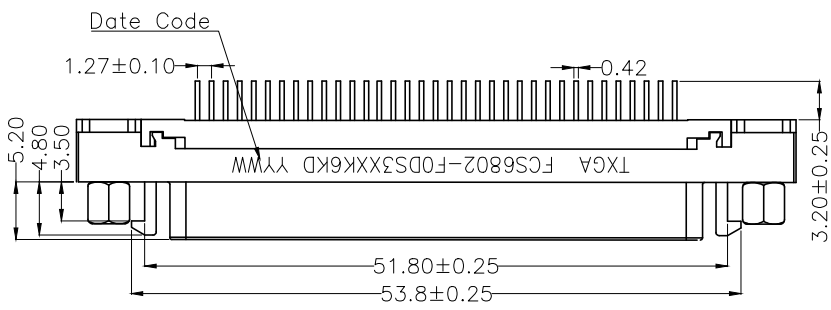

Ordering Information

FCS 68 02 — F0 D S 3 XX K6 K D
 1 2 3 4 5 6 7 8 9 10 11

1 Category FCS-SCSI	2 Circuits 68	3 Distinction No. 02	4 Type F0-Female	5 Assembly Layout D-DIP	6 Entry Angle S-180° Vertical
7 Plating 3-Selective gold in contact area, tin on tail	8 Thickness of Plating 00-Gold flash 03-3μ" Custom plate available	9 Color-Resin K6-Black	10 Packaging K-Tray	11 Distinction Type D-Type D Screw #2-56	

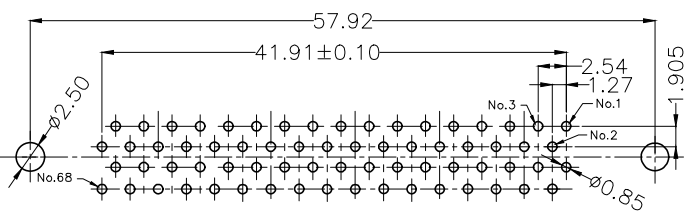

Recommended P.C.Board Layout
 General Tolerances: ±0.05mm

THIRD ANGLE PROJECTION	GENERAL TOLERANCES (UNLESS SPECIFIED)		APPROVE BY LEO	DATE 02/AUG/25	PART NO. FCS6802-F0DS3XXK6KD	ITEM NO. FCS6802	Building Technology Cornerstone
	X.X ±0.30	X.* ±5'	CHECKED BY GISELLE	DATE 02/AUG/25	TITLE SCSI Connector Pitch 1.27mm 180° Vertical Female		
DESIGN UNITS METRIC	X.X ±0.20	X.X' ±2'	DRAWN BY NICK	DATE 02/AUG/25	THIS DRAWING CONTAINS INFORMATION THAT IS PROPRIETARY TO TXGA INDUSTRIAL ELECTRONICS(S.Z)CO.,LTD AND SHOULD NOT BE USED WITHOUT WRITTEN PERMISSION		
SCALE 3:1	SIZE A4	X.XX ±0.15	X.XX' ±1'	X.XXX ±0.10	X.XXX' ±0.5'		