

| REV | LOCATIONS | DESCRIPTION | DATE | REVISER | APPD |
|-----|-----------|----------------------------|-----------|---------|--------|
| 1 | △1 | Size changes | 22/APR/22 | MATT | CHERRY |
| 2 | △2 | New Drawing & Size changes | 18/OCT/24 | MATT | LEO |
| 3 | △3 | Add marking code | 13/Jan/25 | NICK | LEO |

Electrical

Current Rating: 3A AC(rms)/DC
 Voltage Rating: 250V AC(rms)/DC
 Contact Resistance: 25 mΩ Max
 Insulation Resistance: 1000 MΩ MIN
 Withstanding Voltage: 500V AC r.m.s
 Temperature Range-Operating: -55°C~+105°C

Material and Plating

Housing: PBT(UL 94V-0)
 Contact Pin: Phosphor Bronze
 Plating: Gold Plated/Selective gold in contact area,tin on tail

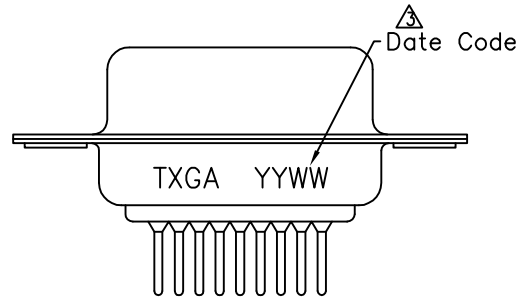
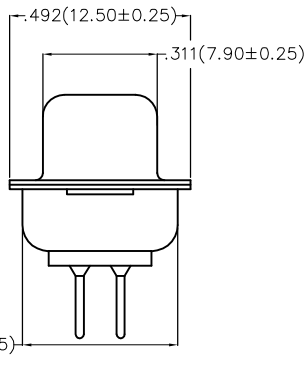
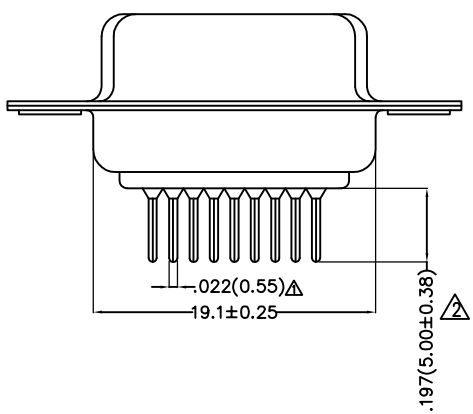
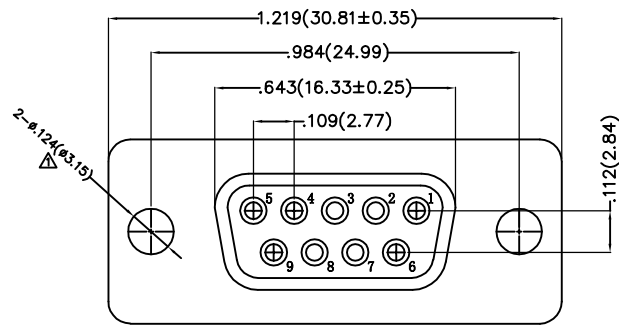

Ordering Information

FDB 09 04 - F0 D S X XX XX X A
 1 2 3 4 5 6 7 8 9 10 11

| | | | | | | | | | | | |
|---|--|---|---|---|------------------------------------|----|-------------------------------|----|------------------------------|---|--------------------------------|
| 1 | Category FDB-D-SUB Connectors | 2 | Circuits 09-9Circuits | 3 | Distinction No. 04 | 4 | Type F0-Female | 5 | Assembly Layout D-DIP | 6 | Entry Angle S-180° Vertical |
| 7 | Plating 1-Gold Plated 3-Selective gold in contact area, tin on tail | 8 | Thickness of Plating 00-Gold Flash 03-3μ" Custom plate available | 9 | Color-Resin K6-Black U1-Blue | 10 | Packaging L-Tube K-Tray | 11 | Distinction Type A-A Type | | |

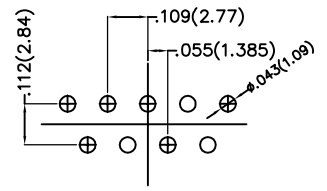

Recommended P.C.Board Layout

| | | | | | | | |
|------------------------|---------------------------------------|--|--|---------------------|---------------------------------|--|--|
| THIRD ANGLE PROJECTION | GENERAL TOLERANCES (UNLESS SPECIFIED) | | APPROVE BY FRANK | DATE 28/JUN/13 | PART NO. FDB0904-FODSXXXXXXA | ITEM NO. FDB0904 | Building Technology Cornerstone REV 3 SHEET NO. 1/1 |
| | DESIGN UNITS Inch (metric) | X.±.012(0.30) X.X±.008(0.20) X.XX±.006(0.15) X.XXX±.004(0.10) | X'±5' .X'±2' .XX'±1' .XXX'±0.5' | CHECKED BY JACOB | DATE 28/JUN/13 | TITLE D-SUB Connectors 9 Circuits 180° Vertical Female | |
| SCALE 5:1 | SIZE A4 | | DRAWN BY CHERRY | DATE 28/JUN/13 | | | |

| REV | LOCATIONS | DESCRIPTION | DATE | REVISER | APPD |
|-----|-----------|----------------------------|-----------|---------|--------|
| 1 | △1 | Size changes | 22/APR/22 | MATT | CHERRY |
| 2 | △2 | New Drawing & Size changes | 18/OCT/24 | MATT | LEO |
| 3 | △3 | Add marking code | 13/Jan/25 | NICK | LEO |

Electrical

Current Rating: 3A AC(rms)/DC
 Voltage Rating: 250V AC(rms)/DC
 Contact Resistance: 25 mΩ Max
 Insulation Resistance: 1000 MΩ MIN
 Withstanding Voltage: 500V AC r.m.s
 Temperature Range—Operating: -55°C~+105°C

Material and Plating

Housing: PBT(UL 94V-0)
 Contact Pin: Phosphor Bronze
 Plating: Gold Plated/Selective gold in contact area,tin on tail
 Shell: SPCC/Front Shell Nickel Plated ;Back Shell Tin plated
 Screws: Copper Alloy/ Nickel Plated

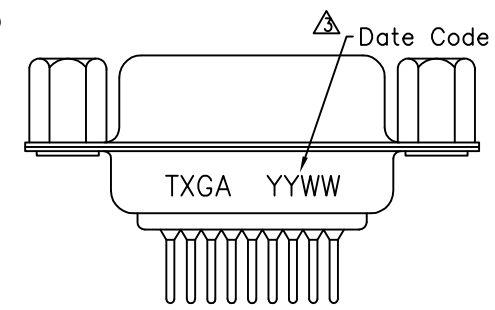
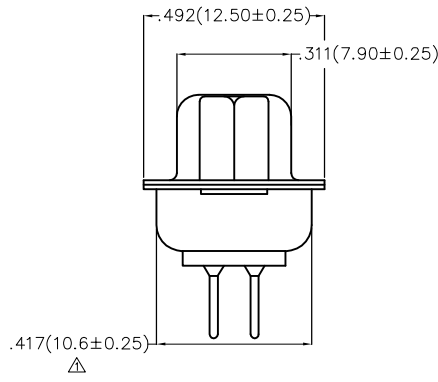
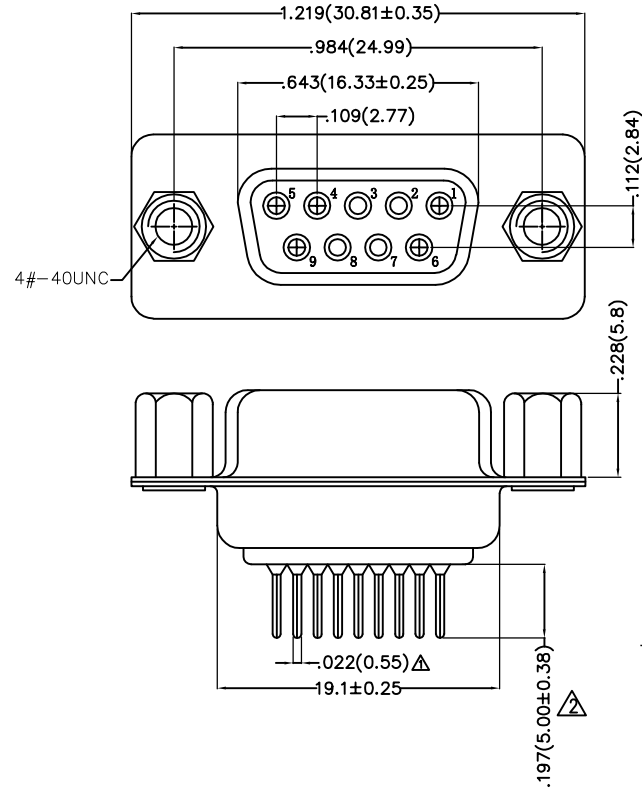

Ordering Information

FDB 09 04 — F0 D S X XX XX X B
 1 2 3 4 5 6 7 8 9 10 11

| | | | | | | | | | | | |
|---|--|---|---|---|------------------------------------|----|-------------------------------|----|------------------------------|---|--------------------------------|
| 1 | Category FDB-D-SUB Connectors | 2 | Circuits 09-9Circuits | 3 | Distinction No. 04 | 4 | Type F0-Female | 5 | Assembly Layout D-DIP | 6 | Entry Angle S-180° Vertical |
| 7 | Plating 1-Gold Plated 3-Selective gold in contact area, tin on tail | 8 | Thickness of Plating 00-Gold Flash 03-3μ" Custom plate available | 9 | Color-Resin K6-Black U1-Blue | 10 | Packaging L-Tube K-Tray | 11 | Distinction Type B-B Type | | |

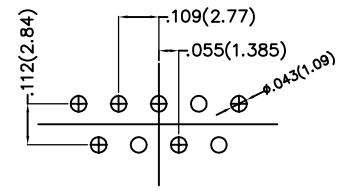

Recommended P.C.Board Layout

| | | | | | | | |
|------------------------|---------------------------------------|--|--|---------------------|--|--|---------------------------------|
| THIRD ANGLE PROJECTION | GENERAL TOLERANCES (UNLESS SPECIFIED) | | APPROVE BY FRANK | DATE 28/JUN/13 | PART NO. FDB0904-FODSXXXXXXB | ITEM NO. FDB0904 | Building Technology Cornerstone |
| | DESIGN UNITS Inch (metric) | X.±.012(0.30) X.X±.008(0.20) X.XX±.006(0.15) X.XXX±.004(0.10) | X'±5' .X'±2' .XX'±1' .XXX'±0.5' | CHECKED BY JACOB | DATE 28/JUN/13 | TITLE D-SUB Connectors 9 Circuits 180° Vertical Female | |
| SCALE 5:1 | SIZE A4 | | DRAWN BY CHERRY | DATE 28/JUN/13 | THIS DRAWING CONTAINS INFORMATION THAT IS PROPRIETARY TO TXGA INDUSTRIAL ELECTRONICS(S.Z)CO.,LTD AND SHOULD NOT BE USED WITHOUT WRITTEN PERMISSION | | |

| REV | LOCATIONS | DESCRIPTION | DATE | REVISER | APPD |
|-----|-----------|----------------------------|-----------|---------|--------|
| 1 | △1 | Size changes | 22/APR/22 | MATT | CHERRY |
| 2 | △2 | New Drawing & Size changes | 18/OCT/24 | MATT | LEO |
| 3 | △3 | Add marking code | 13/Jan/25 | NICK | LEO |

Electrical

Current Rating: 3A AC(rms)/DC
 Voltage Rating: 250V AC(rms)/DC
 Contact Resistance: 25 mΩ Max
 Insulation Resistance: 1000 MΩ MIN
 Withstanding Voltage: 500V AC r.m.s
 Temperature Range—Operating: -55°C~+105°C

Material and Plating

Housing: PBT(UL 94V-0)
 Contact Pin: Phosphor Bronze
 Plating: Gold Plated/Selective gold in contact area,tin on tail
 Shell: SPCC/Front Shell Nickel Plated ;Back Shell Tin plated
 Screws: Copper Alloy/ Nickel Plated

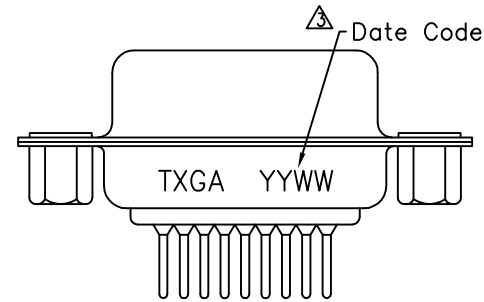
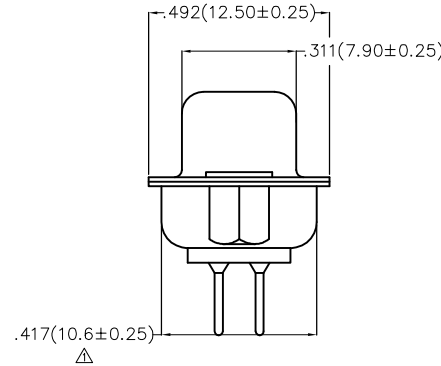
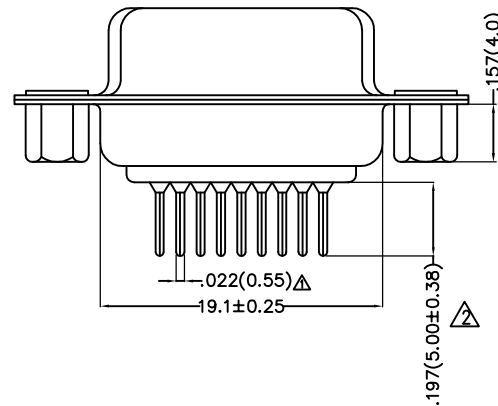
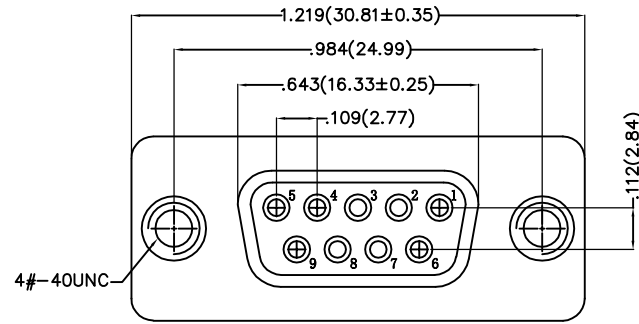

Ordering Information

FDB 09 04 — F0 D S X XX XX X D
 1 2 3 4 5 6 7 8 9 10 11

| | | | | | | | | | | | |
|---|--|---|---|---|------------------------------------|----|-------------------------------|----|------------------------------|---|--------------------------------|
| 1 | Category FDB-D-SUB Connectors | 2 | Circuits 09-9Circuits | 3 | Distinction No. 04 | 4 | Type F0-Female | 5 | Assembly Layout D-DIP | 6 | Entry Angle S-180° Vertical |
| 7 | Plating 1-Gold Plated 3-Selective gold in contact area, tin on tail | 8 | Thickness of Plating 00-Gold Flash 03-3μ" Custom plate available | 9 | Color-Resin K6-Black U1-Blue | 10 | Packaging L-Tube K-Tray | 11 | Distinction Type D-D Type | | |

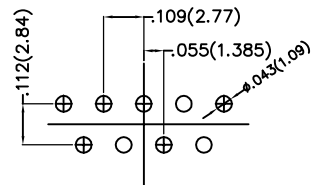

Recommended P.C.Board Layout

| | | | | | | | |
|------------------------|---------------------------------------|--|--|---------------------|--|--|---------------------------------|
| THIRD ANGLE PROJECTION | GENERAL TOLERANCES (UNLESS SPECIFIED) | | APPROVE BY FRANK | DATE 28/JUN/13 | PART NO. FDB0904-FODSXXXXXXD | ITEM NO. FDB0904 | Building Technology Cornerstone |
| | DESIGN UNITS Inch (metric) | X.±0.12(0.30) X.X±.008(0.20) X.XX±.006(0.15) X.XXX±.004(0.10) | X'±5' .X'±2' .XX'±1' .XXX'±0.5' | CHECKED BY JACOB | DATE 28/JUN/13 | TITLE D-SUB Connectors 9 Circuits 180° Vertical Female | |
| SCALE 5:1 | SIZE A4 | | DRAWN BY CHERRY | DATE 28/JUN/13 | THIS DRAWING CONTAINS INFORMATION THAT IS PROPRIETARY TO TXGA INDUSTRIAL ELECTRONICS(S.Z)CO.,LTD AND SHOULD NOT BE USED WITHOUT WRITTEN PERMISSION | | |

| REV | LOCATIONS | DESCRIPTION | DATE | REVISER | APPD |
|-----|-----------|----------------------------|-----------|---------|--------|
| 1 | △1 | Size changes | 22/APR/22 | MATT | CHERRY |
| 2 | △2 | New Drawing & Size changes | 18/OCT/24 | MATT | LEO |
| 3 | △3 | Add marking code | 13/Jan/25 | NICK | LEO |

Electrical

Current Rating: 3A AC(rms)/DC
 Voltage Rating: 250V AC(rms)/DC
 Contact Resistance: 25 mΩ Max
 Insulation Resistance: 1000 MΩ MIN
 Withstanding Voltage: 500V AC r.m.s
 Temperature Range—Operating: -55°C~+105°C

Material and Plating

Housing: PBT(UL 94V-0)
 Contact Pin: Phosphor Bronze
 Plating: Gold Plated/Selective gold in contact area,tin on tail
 Shell: SPCC/Front Shell Nickel Plated ;Back Shell Tin plated
 Screws: Copper Alloy/ Nickel Plated

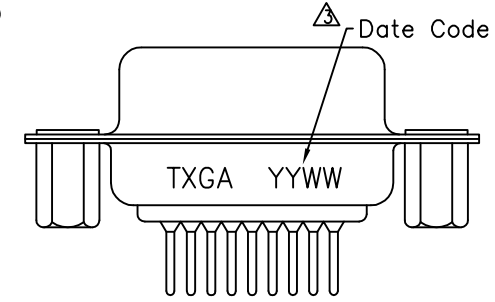
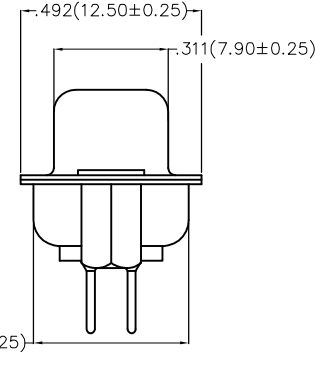
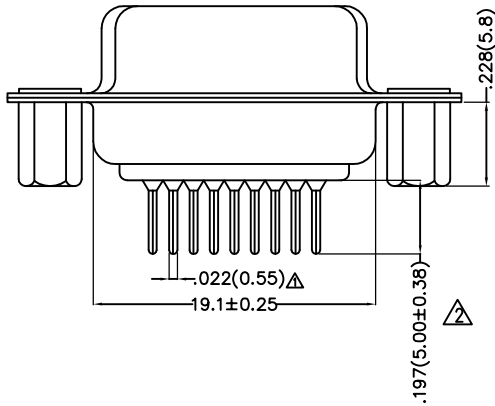
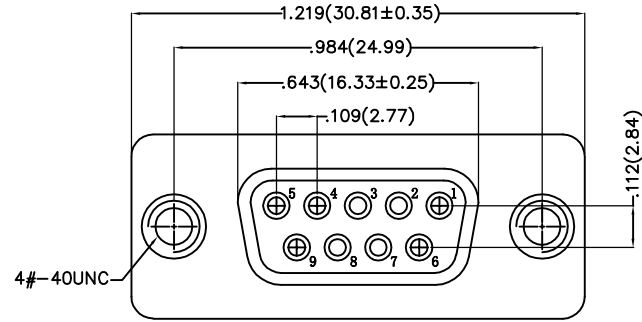

Ordering Information

FDB 09 04 — F0 D S X XX XX X E
 1 2 3 4 5 6 7 8 9 10 11

| | | | | | | | | | | | |
|---|--|---|---|---|------------------------------------|----|-------------------------------|----|------------------------------|---|--------------------------------|
| 1 | Category FDB-D-SUB Connectors | 2 | Circuits 09-9Circuits | 3 | Distinction No. 04 | 4 | Type F0-Female | 5 | Assembly Layout D-DIP | 6 | Entry Angle S-180° Vertical |
| 7 | Plating 1-Gold Plated 3-Selective gold in contact area, tin on tail | 8 | Thickness of Plating 00-Gold Flash 03-3μ" Custom plate available | 9 | Color-Resin K6-Black U1-Blue | 10 | Packaging L-Tube K-Tray | 11 | Distinction Type E-E Type | | |

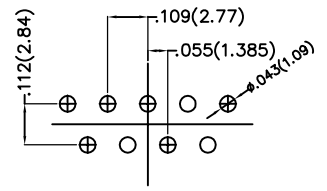

Recommended P.C.Board Layout

| | | | | | | | |
|------------------------|---------------------------------------|--|--|---------------------|--|--|---------------------------------|
| THIRD ANGLE PROJECTION | GENERAL TOLERANCES (UNLESS SPECIFIED) | | APPROVE BY FRANK | DATE 28/JUN/13 | PART NO. FDB0904-FODSXXXXXXE | ITEM NO. FDB0904 | Building Technology Cornerstone |
| | DESIGN UNITS Inch (metric) | X.±.012(0.30) X.X±.008(0.20) X.XX±.006(0.15) X.XXX±.004(0.10) | X'±5' .X'±2' .XX'±1' .XXX'±0.5' | CHECKED BY JACOB | DATE 28/JUN/13 | TITLE D-SUB Connectors 9 Circuits 180° Vertical Female | |
| SCALE 5:1 | SIZE A4 | DRAWN BY CHERRY | | DATE 28/JUN/13 | THIS DRAWING CONTAINS INFORMATION THAT IS PROPRIETARY TO TXGA INDUSTRIAL ELECTRONICS(S.Z)CO.,LTD AND SHOULD NOT BE USED WITHOUT WRITTEN PERMISSION | | |

| REV | LOCATIONS | DESCRIPTION | DATE | REVISER | APPD |
|-----|-----------|----------------------------|-----------|---------|--------|
| 1 | △1 | Size changes | 22/APR/22 | MATT | CHERRY |
| 2 | △2 | New Drawing & Size changes | 18/OCT/24 | MATT | LEO |
| 3 | △3 | Add marking code | 13/Jan/25 | NICK | LEO |

Electrical

Current Rating: 3A AC(rms)/DC
 Voltage Rating: 250V AC(rms)/DC
 Contact Resistance: 25 mΩ Max
 Insulation Resistance: 1000 MΩ MIN
 Withstanding Voltage: 500V AC r.m.s
 Temperature Range—Operating: -55°C~+105°C

Material and Plating

Housing: PBT(UL 94V-0)
 Contact Pin: Phosphor Bronze
 Plating: Selective gold in contact area, tin on tail
 Shell: SPCC/Front Shell Nickel Plated ;Back Shell Tin plated
 Screws: Copper Alloy/ Nickel Plated
 Board lock: Copper Alloy/ Tin Plated

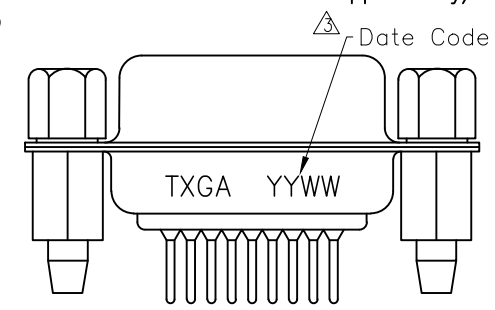
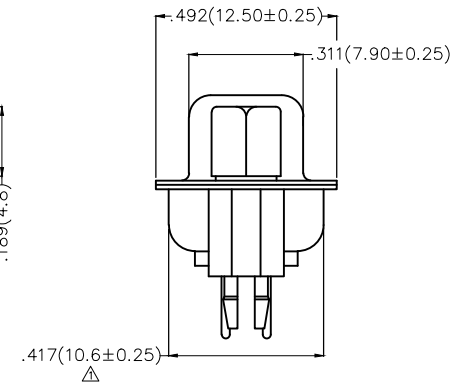
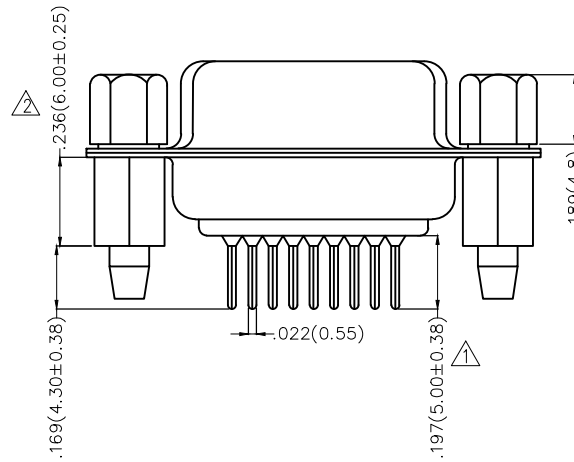
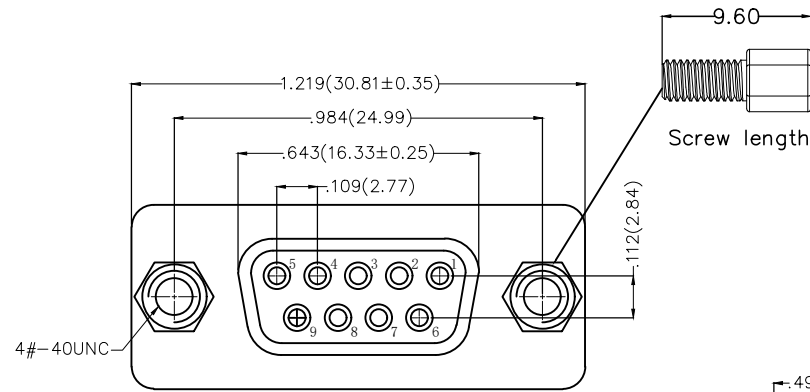

Ordering Information

FDB 09 04 — FO D S X XX XX X F
 1 2 3 4 5 6 7 8 9 10 11

| | | | | | |
|--|---|--------------------------------------|----------------------------------|---------------------------------|----------------------------------|
| 1 Category FDB-D-SUB Connectors | 2 Circuits 09-9Circuits | 3 Distinction No. 04 | 4 Type FO-Female | 5 Assembly Layout D-DIP | 6 Entry Angle S-180° Vertical |
| 7 Plating 1-Gold Plated 3-Selective gold in contact area, tin on tail | 8 Thickness of Plating 00-Gold Flash 03-3μ" Custom plate available | 9 Color-Resin K6-Black U1-Blue | 10 Packaging L-Tube K-Tray | 11 Distinction Type F-F Type | |

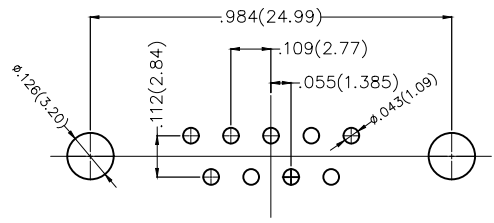

Recommended P.C.Board Layout

| | | | | | | | |
|------------------------|---------------------------------------|--|--|---------------------|--|--|-------------------------------------|
| THIRD ANGLE PROJECTION | GENERAL TOLERANCES (UNLESS SPECIFIED) | | APPROVE BY FRANK | DATE 28/JUN/13 | PART NO. FDB0904-FODSXXXXXXF | ITEM NO. FDB0904 | Building Technology Cornerstone |
| | DESIGN UNITS Inch (metric) | X.±.012(0.30) X.X±.008(0.20) X.XX±.006(0.15) X.XXX±.004(0.10) | X'±5' ,X'±2' ,XX'±1' ,XXX'±0.5' | CHECKED BY JACOB | DATE 28/JUN/13 | TITLE D-SUB Connectors 9 Circuits 180° Vertical Female | |
| SCALE 5:1 | SIZE A4 | | DRAWN BY CHERRY | DATE 28/JUN/13 | THIS DRAWING CONTAINS INFORMATION THAT IS PROPRIETARY TO TXGA INDUSTRIAL ELECTRONICS(S.Z)CO.,LTD AND SHOULD NOT BE USED WITHOUT WRITTEN PERMISSION | | |

| REV | LOCATIONS | DESCRIPTION | DATE | REVISER | APPD |
|-----|-----------|----------------------------|-----------|---------|--------|
| 1 | △ | Size changes | 22/APR/22 | MATT | CHERRY |
| 2 | △ | New Drawing & Size changes | 18/OCT/24 | MATT | LEO |
| 3 | △ | Add marking code | 13/Jan/25 | NICK | LEO |

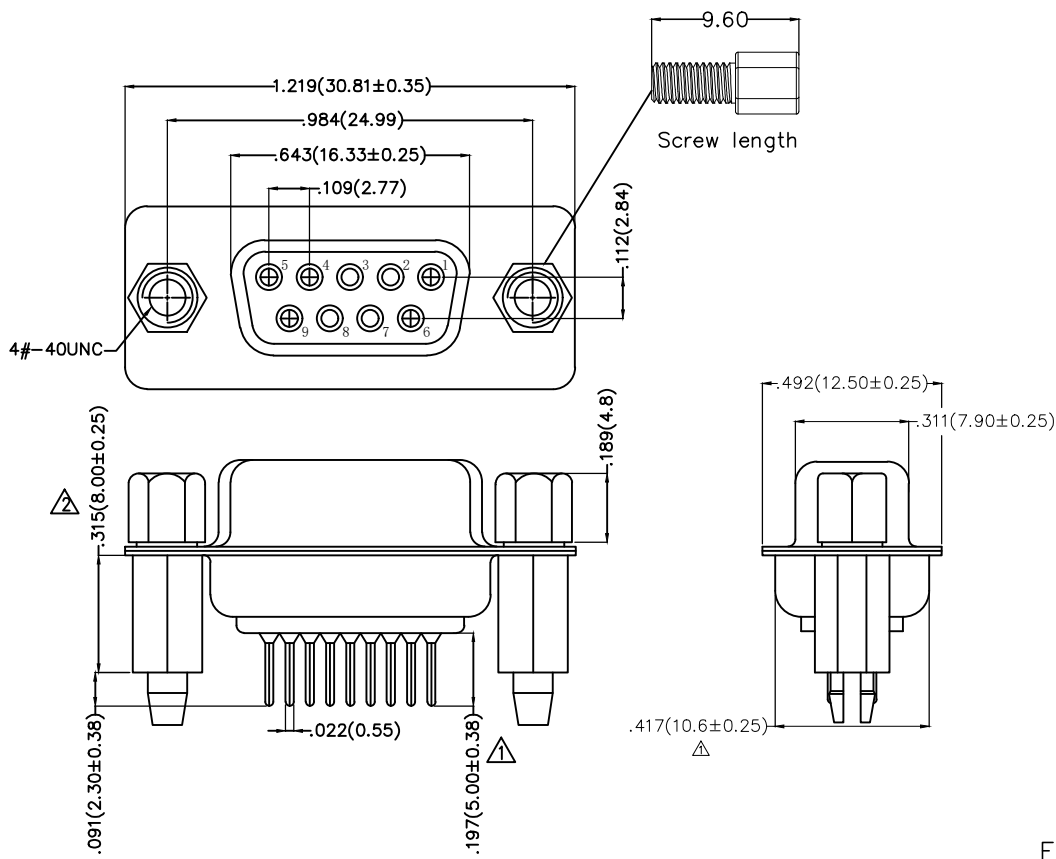

Electrical
 Current Rating: 3A AC(rms)/DC
 Voltage Rating: 250V AC(rms)/DC
 Contact Resistance: 25 mΩ Max
 Insulation Resistance: 1000 MΩ MIN
 Withstanding Voltage: 500V AC r.m.s
 Temperature Range-Operating: -55°C~+105°C

Material and Plating
 Housing: PBT(UL 94V-0)
 Contact Pin: Phosphor Bronze
 Plating: Selective gold in contact area, tin on tail
 Shell: SPCC/Front Shell Nickel Plated ;Back Shell Tin plated
 Screws: Copper Alloy/ Nickel Plated
 Board Lock: Copper Alloy/ Tin Plated

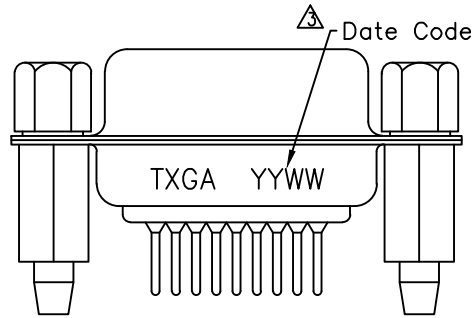

Ordering Information

FDB 09 04 - F0 D S X XX XX X G
 1 2 3 4 5 6 7 8 9 10 11

| | | | | | | | | | | | |
|---|---|---|---|---|------------------------------------|----|-------------------------------|----|------------------------------|---|--------------------------------|
| 1 | Category FDB-D-SUB Connectors | 2 | Circuits 09-9Circuits | 3 | Distinction No. 04 | 4 | Type F0-Female | 5 | Assembly Layout D-DIP | 6 | Entry Angle S-180° Vertical |
| 7 | Plating 1-Gold Plated 3-Selective gold in contact area, tin on tail | 8 | Thickness of Plating 00-Gold Flash 03-3μ" Custom plate available | 9 | Color-Resin K6-Black U1-Blue | 10 | Packaging L-Tube K-Tray | 11 | Distinction Type G-G Type | | |

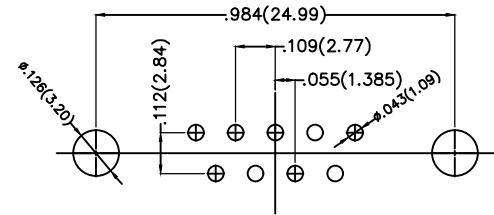

Recommended P.C. Board Layout

| | | | | | | | |
|------------------------|---------------------------------------|--|--|---------------------|--|--|--|
| THIRD ANGLE PROJECTION | GENERAL TOLERANCES (UNLESS SPECIFIED) | | APPROVE BY FRANK | DATE 28/JUN/13 | PART NO. FDB0904-F0DSXXXXXXG | ITEM NO. FDB0904 | TXGA Building Technology Cornerstone |
| | DESIGN UNITS Inch (metric) | X.±.012(0.30) X.X±.008(0.20) X.XX±.006(0.15) X.XXX±.004(0.10) | X.±5' .X'±2' .XX'±1" .XXX'±0.5" | CHECKED BY JACOB | DATE 28/JUN/13 | TITLE D-SUB Connectors 9 Circuits 180° Vertical Female | |
| SCALE 5:1 | SIZE A4 | DRAWN BY CHERRY | | DATE 28/JUN/13 | THIS DRAWING CONTAINS INFORMATION THAT IS PROPRIETARY TO TXGA INDUSTRIAL ELECTRONICS(S.Z)CO.,LTD AND SHOULD NOT BE USED WITHOUT WRITTEN PERMISSION | | |

| REV | LOCATIONS | DESCRIPTION | DATE | REVISER | APPD |
|-----|-----------|----------------------------|-----------|---------|--------|
| 1 | △ | Size changes | 22/APR/22 | MATT | CHERRY |
| 2 | △ | New Drawing & Size changes | 18/OCT/24 | MATT | LEO |
| 3 | △ | Add marking code | 13/Jan/25 | NICK | LEO |

Electrical

Current Rating: 3A AC(rms)/DC
Voltage Rating: 250V AC(rms)/DC
Contact Resistance: 25 mΩ Max
Insulation Resistance: 1000 MΩ MIN
Withstanding Voltage: 500V AC r.m.s
Temperature Range-Operating: -55°C~+105°C

Material and Plating

Housing: PBT(UL 94V-0)
Contact Pin: Phosphor Bronze
Plating: Selective gold in contact area, tin on tail
Shell: SPCC/Front Shell Nickel Plated ;Back Shell Tin plated
Board Lock: Copper Alloy/ Tin Plated

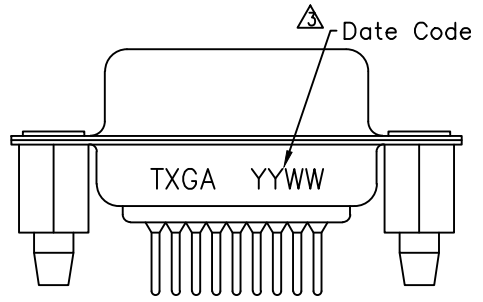
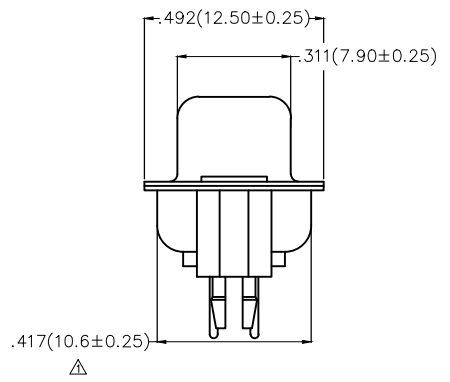
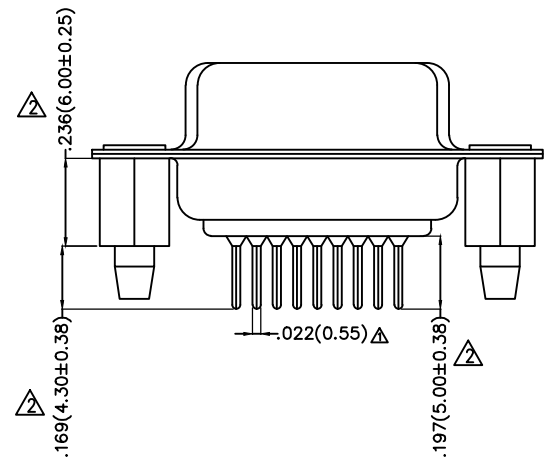
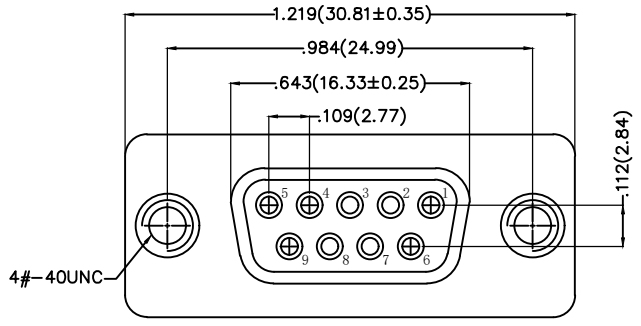

Ordering Information

FDB 09 04 - F0 D S X XX XX X H
1 2 3 4 5 6 7 8 9 10 11

| | | | | | | | | | | | |
|---|---|---|---|---|------------------------------------|----|-------------------------------|----|------------------------------|---|--------------------------------|
| 1 | Category FDB-D-SUB Connectors | 2 | Circuits 09-9Circuits | 3 | Distinction No. 04 | 4 | Type F0-Female | 5 | Assembly Layout D-DIP | 6 | Entry Angle S-180° Vertical |
| 7 | Plating 1-Gold Plated 3-Selective gold in contact area, tin on tail | 8 | Thickness of Plating 00-Gold Flash 03-3μ" Custom plate available | 9 | Color-Resin K6-Black U1-Blue | 10 | Packaging L-Tube K-Tray | 11 | Distinction Type H-H Type | | |

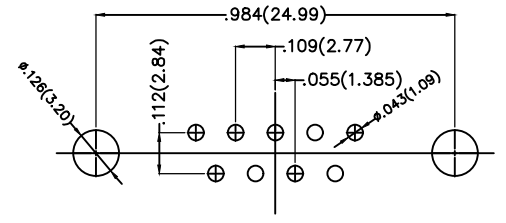

Recommended P.C.Board Layout

| | | | | | | | |
|----------------------------|---------------------------------------|-------------------------------------|-----------------------|---------------------|---------------------------------|--|-------------------------------------|
| THIRD ANGLE PROJECTION | GENERAL TOLERANCES (UNLESS SPECIFIED) | | APPROVE BY FRANK | DATE 28/JUN/13 | PART NO. FDB0904-F0DSXXXXXXH | ITEM NO. FDB0904 | Building Technology Cornerstone |
| | DESIGN UNITS Inch (metric) | X.±.012(0.30) X.X±.008(0.20) | X'.±5' .X'±2' | CHECKED BY JACOB | DATE 28/JUN/13 | TITLE D-SUB Connectors 9 Circuits 180° Vertical Female | |
| SCALE 5:1 | SIZE A4 | X.XX±.006(0.15) X.XXX±.004(0.10) | .XX'±1' .XXX'±0.5' | DRAWN BY CHERRY | DATE 28/JUN/13 | THIS DRAWING CONTAINS INFORMATION THAT IS PROPRIETARY TO TXGA INDUSTRIAL ELECTRONICS(S.Z)CO.,LTD AND SHOULD NOT BE USED WITHOUT WRITTEN PERMISSION | |

| REV | LOCATIONS | DESCRIPTION | DATE | REVISER | APPD |
|-----|-----------|-------------|------|---------|------|
| | | | | | |

Electrical

Current Rating: 3A AC(rms)/DC
Voltage Rating: 250V AC(rms)/DC
Contact Resistance: 25 mΩ Max
Insulation Resistance: 1000 MΩ MIN
Withstanding Voltage: 500V AC r.m.s
Temperature Range—Operating: -55°C~+105°C

Material and Plating

Housing: PBT(UL 94V-0)
Contact Pin: Copper Alloy/(1.Gold plated/2.Selective gold in contact area, tin on tail)
Shell: SPCC/Front Shell Nickel Plated ;Back Shell Tin plated
Screws: Copper Alloy/ Nickel Plated
Board Lock: Copper Alloy/ Tin Plated
Salt spray : 24H Min.

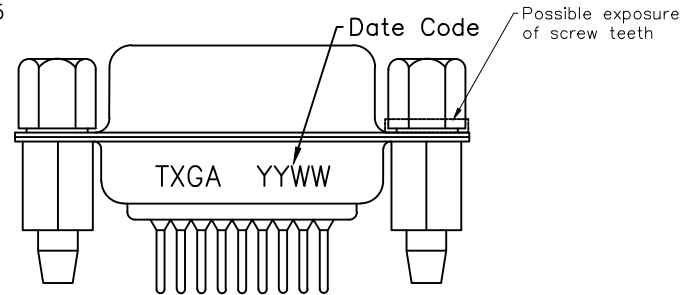
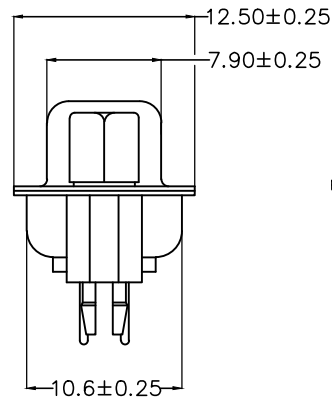
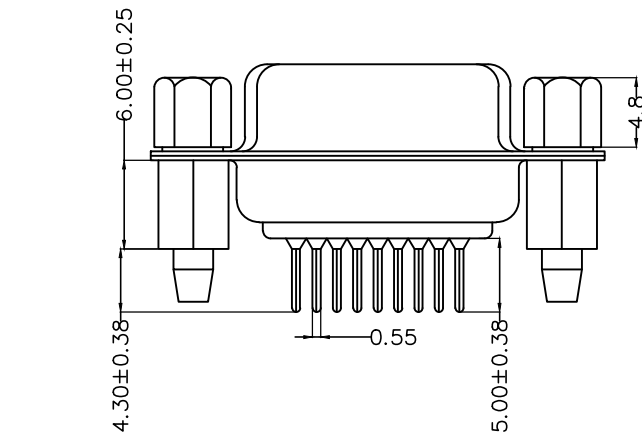
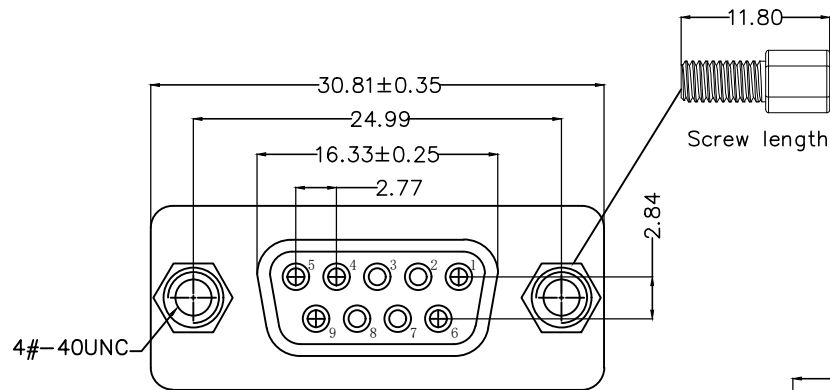

Ordering Information

FDB 09 04 — F0 D S X XX XX X J
1 2 3 4 5 6 7 8 9 10 11

| | | | | | |
|--|---|--------------------------------------|------------------------|---------------------------------|----------------------------------|
| 1 Category FDB-D-SUB Connectors | 2 Circuits 09-9Circuits | 3 Distinction No. 04 | 4 Type F0-Female | 5 Assembly Layout D-DIP | 6 Entry Angle S-180° Vertical |
| 7 Plating 1-Gold Plated 3-Selective gold in contact area, tin on tail | 8 Thickness of Plating 00-Gold Flash 03-3μ" Custom plate available | 9 Color-Resin K6-Black U1-Blue | 10 Packaging K-Tray | 11 Distinction Type J-J Type | |

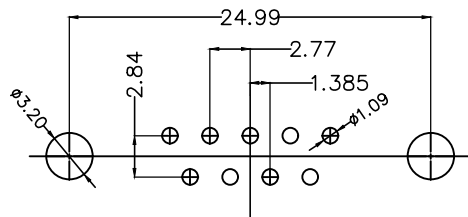

Recommended P.C.Board Layout

| | | | | | | | |
|----------------------------|---------------------------------------|-------------|-----------------------|-------------------|--|---------------------|-------------------------------------|
| THIRD ANGLE PROJECTION | GENERAL TOLERANCES (UNLESS SPECIFIED) | | APPROVE BY LEO | DATE 02/AUG/25 | PART NO. FDB0904-F0DSXXXXXJ | ITEM NO. FDB0904 | Building Technology Cornerstone |
| | X. ±0.30 | X.* ±5° | CHECKED BY GISELLE | DATE 02/AUG/25 | TITLE D-SUB Connectors 9 Circuits 180° Vertical Female | | |
| DESIGN UNITS METRIC | X.X ±0.20 | X.X* ±2° | DRAWN BY NICK | DATE 02/AUG/25 | THIS DRAWING CONTAINS INFORMATION THAT IS PROPRIETARY TO TXGA INDUSTRIAL ELECTRONICS(S.Z)CO.,LTD AND SHOULD NOT BE USED WITHOUT WRITTEN PERMISSION | | |
| SCALE 5:1 | SIZE A4 | X.XX ±0.15 | X.XX* ±1° | | | | |
| | | X.XXX ±0.10 | X.XXX* ±0.5° | | | | |

| REV | LOCATIONS | DESCRIPTION | DATE | REVISER | APPD |
|-----|-----------|-------------|------|---------|------|
| | | | | | |

Electrical

Current Rating: 3A AC(rms)/DC
Voltage Rating: 250V AC(rms)/DC
Contact Resistance: 25 mΩ Max
Insulation Resistance: 1000 MΩ MIN
Withstanding Voltage: 500V AC r.m.s
Temperature Range—Operating: -55°C~+105°C

Material and Plating

Housing: PBT(UL 94V-0)
Contact Pin: Copper Alloy/(1.Gold plated/2.Selective gold in contact area, tin on tail)
Shell: SPCC/Front Shell Nickel Plated ;Back Shell Tin plated
Screws: Copper Alloy/ Nickel Plated
Board Lock: Copper Alloy/ Tin Plated
Salt spray : 24H Min.

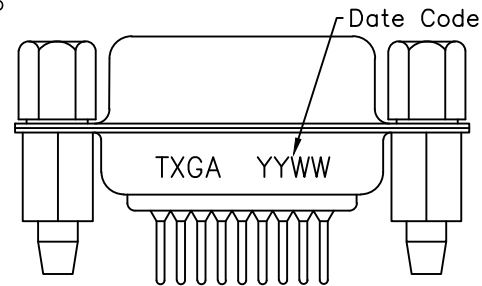
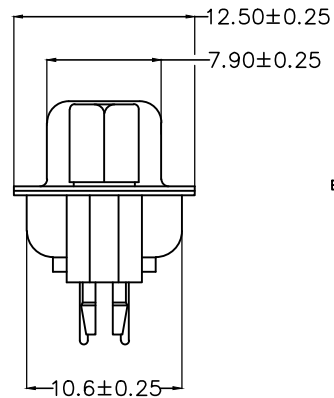
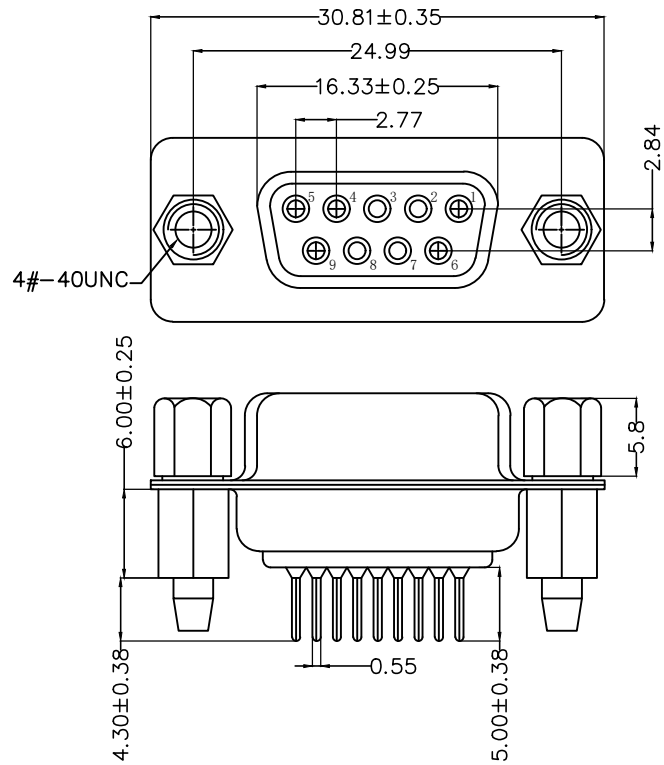

Ordering Information

FDB 09 04 — F0 D S X XX XX X K
1 2 3 4 5 6 7 8 9 10 11

| | | | | | |
|--|---|--------------------------------------|------------------------|---------------------------------|----------------------------------|
| 1 Category FDB-D-SUB Connectors | 2 Circuits 09-9Circuits | 3 Distinction No. 04 | 4 Type F0-Female | 5 Assembly Layout D-DIP | 6 Entry Angle S-180° Vertical |
| 7 Plating 1-Gold Plated 3-Selective gold in contact area, tin on tail | 8 Thickness of Plating 00-Gold Flash 03-3μ" Custom plate available | 9 Color-Resin K6-Black U1-Blue | 10 Packaging K-Tray | 11 Distinction Type K-K Type | |

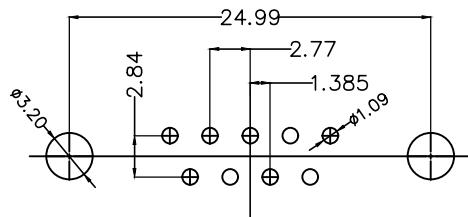

Recommended P.C.Board Layout

| | | | | | | | |
|----------------------------|---------------------------------------|-------------|-----------------------|-------------------|--|---------------------|-------------------------------------|
| THIRD ANGLE PROJECTION | GENERAL TOLERANCES (UNLESS SPECIFIED) | | APPROVE BY LEO | DATE 02/AUG/25 | PART NO. FDB0904-F0DSXXXXXXK | ITEM NO. FDB0904 | Building Technology Cornerstone |
| | X. ±0.30 | X.* ±5° | CHECKED BY GISELLE | DATE 02/AUG/25 | TITLE D-SUB Connectors 9 Circuits 180° Vertical Female | | |
| DESIGN UNITS METRIC | X.X ±0.20 | X.X* ±2° | DRAWN BY NICK | DATE 02/AUG/25 | THIS DRAWING CONTAINS INFORMATION THAT IS PROPRIETARY TO TXGA INDUSTRIAL ELECTRONICS(S.Z)CO.,LTD AND SHOULD NOT BE USED WITHOUT WRITTEN PERMISSION | | |
| SCALE 5:1 | SIZE A4 | X.XX ±0.15 | X.XX* ±1° | | | | |
| | | X.XXX ±0.10 | X.XXX* ±0.5° | | | | |