

REV	LOCATIONS	DESCRIPTION	DATE	REVISER	APPD
1		New Drawing	18/MAR/24	MATT	CHERRY
2	△	Add marking code	13/Jan/25	NICK	LEO

### SPECIFICATIONS

#### Electrical

Current Rating: 3A AC(rms)/DC  
Voltage Rating: 250V AC(rms)/DC  
Contact Resistance: 25 mΩ Max  
Insulation Resistance: 1000 MΩ Min  
Withstanding Voltage: 500V AC r.m.s  
Temperature Range-Operating: -55°C~+105°C

#### Material and plating

Housing: PBT UL 94V-0  
Contact: Copper Alloy/ Gold Plated/Selective gold in contact area, tin on tail  
Shell: SPCC/ Nickel Plated

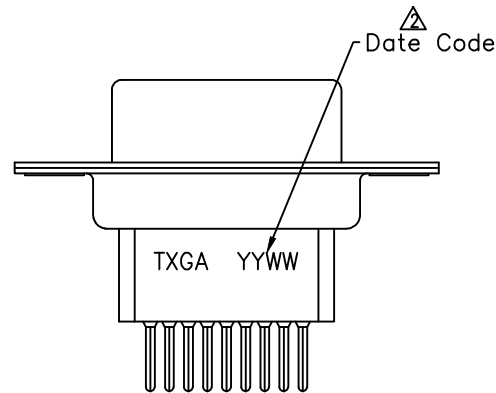
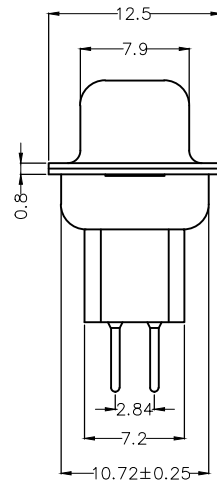
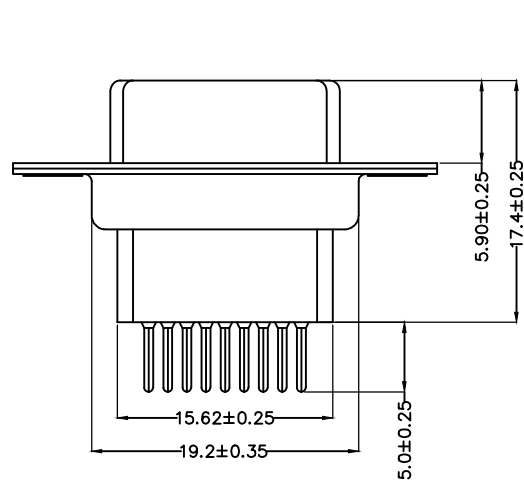
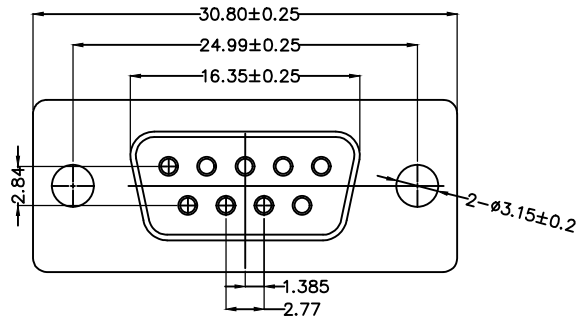

### Ordering Information

FDB 09 26 - F0 D S X XX XX K A  
1 2 3 4 5 6 7 8 9 10 11

1	Category FDB-D-SUB Connectors	2	Circuits 09	3	Distinction No. 26	4	Type F0-Female	5	Assembly Layout D-DIP	6	Entry Angle S-180° Vertical
7	Plating 1-Gold Plated 3-Selective gold in contact area, tin on tail	Thickness of Plating 00-Gold Flash 03-3μ" Custom plate available		9	Color-Resin K6-Black U1-Blue	10	Packaging K-Tray	11	Distinction Type A-A Type		

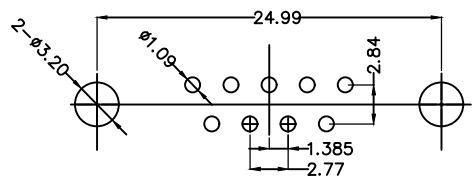

Recommended P.C.Board Layout

THIRD ANGLE PROJECTION	GENERAL TOLERANCES (UNLESS SPECIFIED)		APPROVE BY FRANK	DATE 25/JUN/13	PART NO. FDB0926-FODSXXXXXKA	ITEM NO. FDB0926	 Building Technology Cornerstone	
	DESIGN UNITS Metric(mm)	X.±0.30	.X'±5'	CHECKED BY JACOB	DATE 25/JUN/13	TITLE D-SUB Connectors 9 Circuits 180° Vertical Female		REV 2
SCALE 5:1	SIZE A4	X.XX±0.15	.XX'±1"	DRAWN BY CHERRY	DATE 25/JUN/13	THIS DRAWING CONTAINS INFORMATION THAT IS PROPRIETARY TO TXGA INDUSTRIAL ELECTRONICS(S.Z)CO.,LTD AND SHOULD NOT BE USED WITHOUT WRITTEN PERMISSION		

REV	LOCATIONS	DESCRIPTION	DATE	REVISER	APPD
1		New Drawing	18/MAR/24	MATT	CHERRY
2	△	Add marking code	13/Jan/25	NICK	LEO

### SPECIFICATIONS

#### Electrical

Current Rating: 3A AC(rms)/DC  
Voltage Rating: 250V AC(rms)/DC  
Contact Resistance: 25 mΩ Max  
Insulation Resistance: 1000 MΩ Min  
Withstanding Voltage: 500V AC r.m.s  
Temperature Range-Operating: -55°C~+105°C

#### Material and plating

Housing: PBT UL 94V-0  
Contact: Copper Alloy/  
Selective gold in contact area, tin on tail  
Shell: SPCC/ Nickel Plated  
Board Lock: Copper Alloy/ Tin Plated  
Screws: Copper Alloy/ Nickel Plated

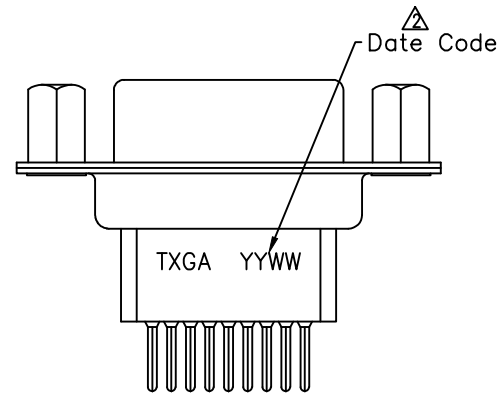
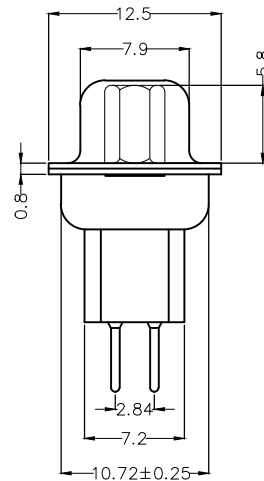
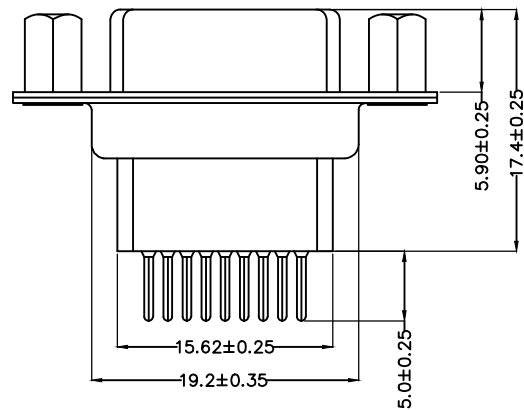
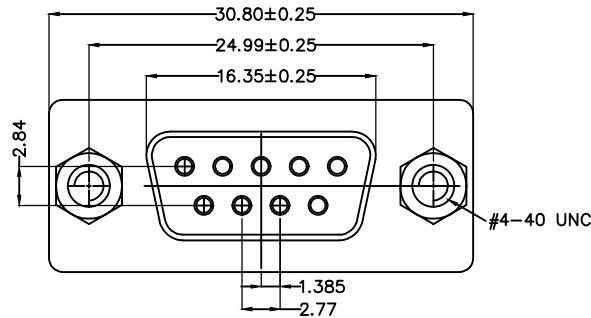

### Ordering Information

FDB 09 26 - F0 D S X XX XX K B  
1 2 3 4 5 6 7 8 9 10 11

1	Category FDB-D-SUB Connectors	2	Circuits 09	3	Distinction No. 26	4	Type F0-Female	5	Assembly Layout D-DIP	6	Entry Angle S-180° Vertical
7	Plating 1-Gold Plated 3-Selective gold in contact area, tin on tail	Thickness of Plating 00-Gold Flash 03-3μ" Custom plate available		9	Color-Resin K6-Black U1-Blue	10	Packaging K-Tray	11	Distinction Type B-B Type		

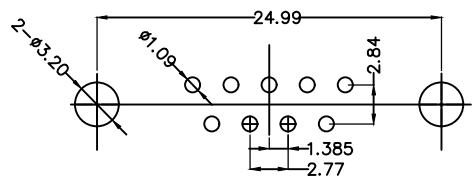

Recommended P.C.Board Layout

THIRD ANGLE PROJECTION	GENERAL TOLERANCES (UNLESS SPECIFIED)		APPROVE BY FRANK	DATE 25/JUN/13	PART NO. FDB0926-FODSXXXXXKB	ITEM NO. FDB0926	 Building Technology Cornerstone	
	DESIGN UNITS Metric(mm)	X.±0.30	X'.±5'	CHECKED BY JACOB	DATE 25/JUN/13	TITLE D-SUB Connectors 9 Circuits 180° Vertical Female		REV 2
SCALE 5:1	SIZE A4	X.XX±0.20	X'±2'	DRAWN BY CHERRY	DATE 25/JUN/13	THIS DRAWING CONTAINS INFORMATION THAT IS PROPRIETARY TO TXGA INDUSTRIAL ELECTRONICS(S.Z)CO.,LTD AND SHOULD NOT BE USED WITHOUT WRITTEN PERMISSION		

REV	LOCATIONS	DESCRIPTION	DATE	REVISER	APPD
1		New Drawing	18/MAR/24	MATT	CHERRY
2	△	Add marking code	13/Jan/25	NICK	LEO

SPECIFICATIONS

Electrical

Current Rating: 3A AC(rms)/DC  
Voltage Rating: 250V AC(rms)/DC  
Contact Resistance: 25 mΩ Max  
Insulation Resistance: 1000 MΩ Min  
Withstanding Voltage: 500V AC r.m.s  
Temperature Range-Operating: -55°C~+105°C

Material and plating

Housing: PBT UL 94V-0  
Contact: Copper Alloy/  
Selective gold in contact area, tin on tail  
Shell: SPCC/ Nickel Plated  
Board Lock: Copper Alloy/ Tin Plated  
Screws: Copper Alloy/ Nickel Plated

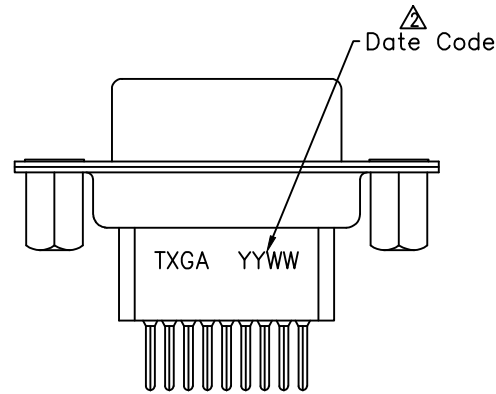
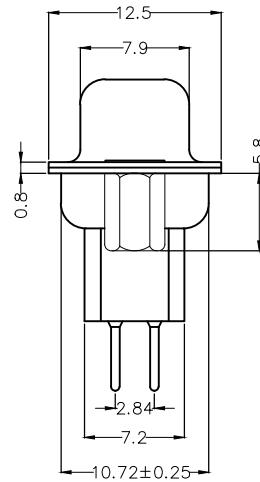
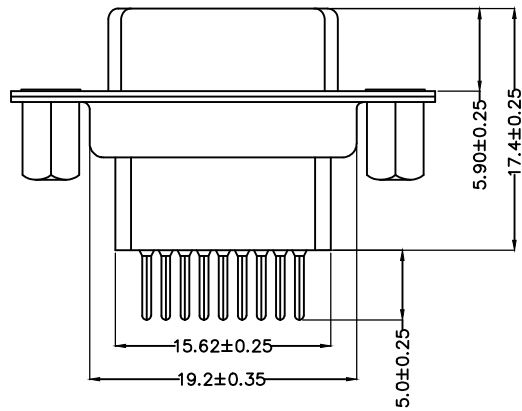
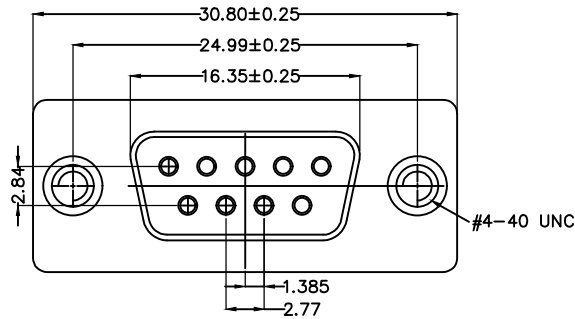

Ordering Information

FDB 09 26 - F0 D S X XX XX K E  
1 2 3 4 5 6 7 8 9 10 11

1	Category FDB-D-SUB Connectors	2	Circuits 09	3	Distinction No. 26	4	Type F0-Female	5	Assembly Layout D-DIP	6	Entry Angle S-180° Vertical
7	Plating 1-Gold Plated 3-Selective gold in contact area, tin on tail	Thickness of Plating 00-Gold Flash 03-3μ" Custom plate available		9	Color-Resin K6-Black U1-Blue	10	Packaging K-Tray	11	Distinction Type E-E Type		

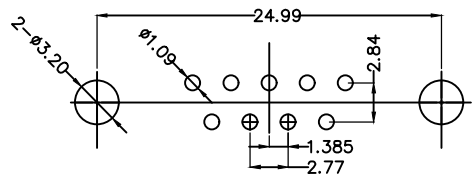

Recommended P.C.Board Layout

THIRD ANGLE PROJECTION	GENERAL TOLERANCES (UNLESS SPECIFIED)		APPROVE BY FRANK	DATE 25/JUN/13	PART NO. FDB0926-FODSXXXXXKE	ITEM NO. FDB0926	 Building Technology Cornerstone	
	DESIGN UNITS Metric(mm)	X.±0.30	X'.±5'	CHECKED BY JACOB	DATE 25/JUN/13	TITLE D-SUB Connectors 9 Circuits 180° Vertical Female		REV 2
SCALE 5:1	SIZE A4	X.XX±0.20	X'±2'	DRAWN BY CHERRY	DATE 25/JUN/13	THIS DRAWING CONTAINS INFORMATION THAT IS PROPRIETARY TO TXGA INDUSTRIAL ELECTRONICS(S.Z)CO.,LTD AND SHOULD NOT BE USED WITHOUT WRITTEN PERMISSION		

REV	LOCATIONS	DESCRIPTION	DATE	REVISER	APPD
1		New Drawing	18/MAR/24	MATT	CHERRY
2	△	Add marking code	13/Jan/25	NICK	LEO

SPECIFICATIONS

Electrical

Current Rating: 3A AC(rms)/DC  
Voltage Rating: 250V AC(rms)/DC  
Contact Resistance: 25 mΩ Max  
Insulation Resistance: 1000 MΩ Min  
Withstanding Voltage: 500V AC r.m.s  
Temperature Range-Operating: -55°C~+105°C

Material and plating

Housing: PBT UL 94V-0  
Contact: Copper Alloy/  
Selective gold in contact area, tin on tail  
Shell: SPCC/ Nickel Plated  
Board Lock: Copper Alloy/ Tin Plated  
Screws: Copper Alloy/ Nickel Plated

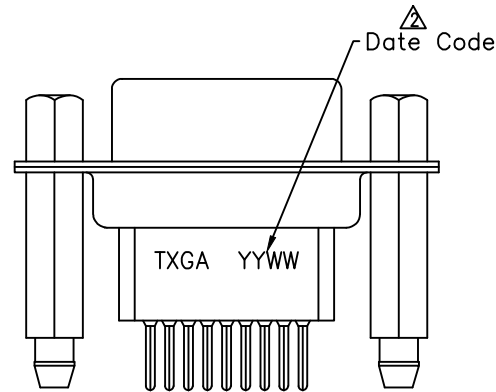
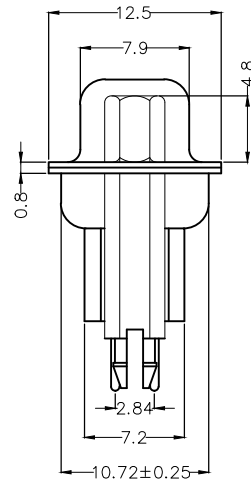
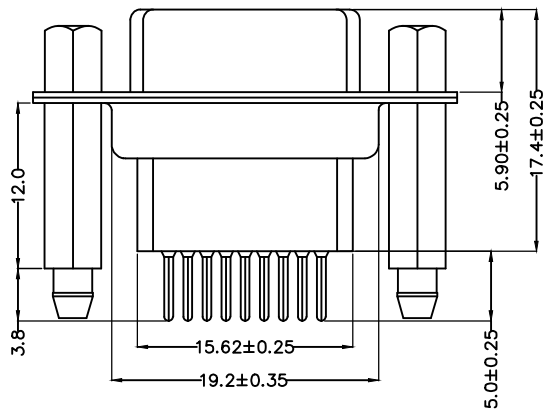
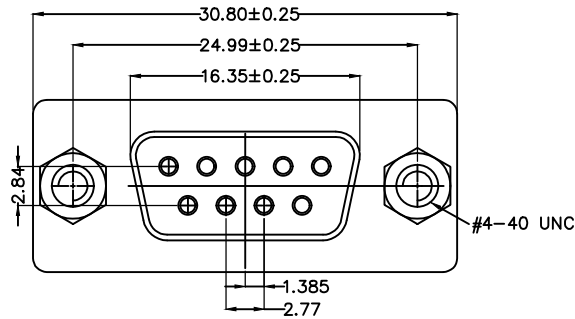

Ordering Information

FDB 09 26 - F0 D S X XX XX K F  
1 2 3 4 5 6 7 8 9 10 11

1	Category FDB-D-SUB Connectors	2	Circuits 09	3	Distinction No. 26	4	Type F0-Female	5	Assembly Layout D-DIP	6	Entry Angle S-180° Vertical
7	Plating 1-Gold Plated 3-Selective gold in contact area, tin on tail	Thickness of Plating 00-Gold Flash 03-3μ" Custom plate available		9	Color-Resin K6-Black U1-Blue	10	Packaging K-Tray	11	Distinction Type F-F Type		

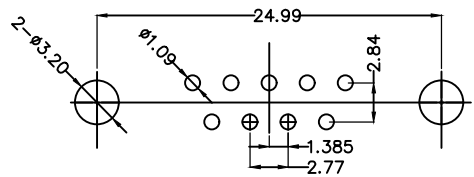

Recommended P.C.Board Layout

THIRD ANGLE PROJECTION	GENERAL TOLERANCES (UNLESS SPECIFIED)		APPROVE BY FRANK	DATE 25/JUN/13	PART NO. FDB0926-FODSXXXXXKF	ITEM NO. FDB0926	 Building Technology Cornerstone	
	DESIGN UNITS Metric(mm)	X.±0.30	X'.±5'	CHECKED BY JACOB	DATE 25/JUN/13	TITLE D-SUB Connectors 9 Circuits 180° Vertical Female		REV 2
SCALE 5:1	SIZE A4	X.XX±0.15	.XX'±1"	DRAWN BY CHERRY	DATE 25/JUN/13	THIS DRAWING CONTAINS INFORMATION THAT IS PROPRIETARY TO TXGA INDUSTRIAL ELECTRONICS(S.Z)CO.,LTD AND SHOULD NOT BE USED WITHOUT WRITTEN PERMISSION		

REV	LOCATIONS	DESCRIPTION	DATE	REVISER	APPD
1		New Drawing	18/MAR/24	MATT	CHERRY
2	△	Add marking code	13/Jan/25	NICK	LEO

SPECIFICATIONS

Electrical

Current Rating: 3A AC(rms)/DC  
Voltage Rating: 250V AC(rms)/DC  
Contact Resistance: 25 mΩ Max  
Insulation Resistance: 1000 MΩ Min  
Withstanding Voltage: 500V AC r.m.s  
Temperature Range-Operating: -55°C~+105°C

Material and plating

Housing: PBT UL 94V-0  
Contact: Copper Alloy/  
Selective gold in contact area, tin on tail  
Shell: SPCC/ Nickel Plated  
Board Lock: Copper Alloy/ Tin Plated

△  
Date Code

Ordering Information

FDB 09 26 - F0 D S X XX XX K G  
1 2 3 4 5 6 7 8 9 10 11

1	Category FDB-D-SUB Connectors	2	Circuits 09	3	Distinction No. 26	4	Type F0-Female	5	Assembly Layout D-DIP	6	Entry Angle S-180° Vertical
7	Plating 1-Gold Plated 3-Selective gold in contact area, tin on tail	Thickness of Plating 00-Gold Flash 03-3μ" Custom plate available		9	Color-Resin K6-Black U1-Blue	10	Packaging K-Tray	11	Distinction Type G-G Type		

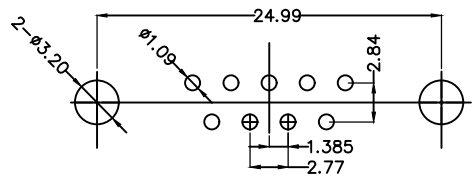

Recommended P.C.Board Layout

THIRD ANGLE PROJECTION	GENERAL TOLERANCES (UNLESS SPECIFIED)		APPROVE BY FRANK	DATE 25/JUN/13	PART NO. FDB0926-FODSXXXXXKG	ITEM NO. FDB0926	 Building Technology Cornerstone	
	DESIGN UNITS Metric(mm)	X.±0.30	X'.±5'	CHECKED BY JACOB	DATE 25/JUN/13	TITLE D-SUB Connectors 9 Circuits 180° Vertical Female		REV 2
SCALE 5:1	SIZE A4	X.XX±0.15	.XX'±1'	DRAWN BY CHERRY	DATE 25/JUN/13	THIS DRAWING CONTAINS INFORMATION THAT IS PROPRIETARY TO TXGA INDUSTRIAL ELECTRONICS(S.Z)CO.,LTD AND SHOULD NOT BE USED WITHOUT WRITTEN PERMISSION		