

REV	LOCATIONS	DESCRIPTION	DATE	REVISER	APPD
1	△	1.Update version 2.Add marking code	21/Jan/26	NICK	LEO

SPECIFICATIONS

Electrical

- 1.Current Rating: 3A AC(rms)/DC
- 2.Voltage Rating: 250V AC(rms)/DC
- 3.Contact Resistance: 25 mΩ Max
- 4.Insulation Resistance: 1000 MΩ MIN
- 5.Withstanding Voltage: 500V AC r.m.s
- 6.Temperature Range—Operating: -55°C~+105°C

Material and Finish

- 1.Housing: PBT UL 94V-0
- 2.Contact: Brass/Gold Flash Plated On Contact Area Tin Plated On Solderails,Nickel Under Plated Over All/Gold Plated Options
- 3.Shell: Spcc/Nickel Plated Over All
- 4.Board Lock: Copper Alloy/Tin Plated Over All
- 5.Screws: Copper Alloy/Nickel Plated Over All

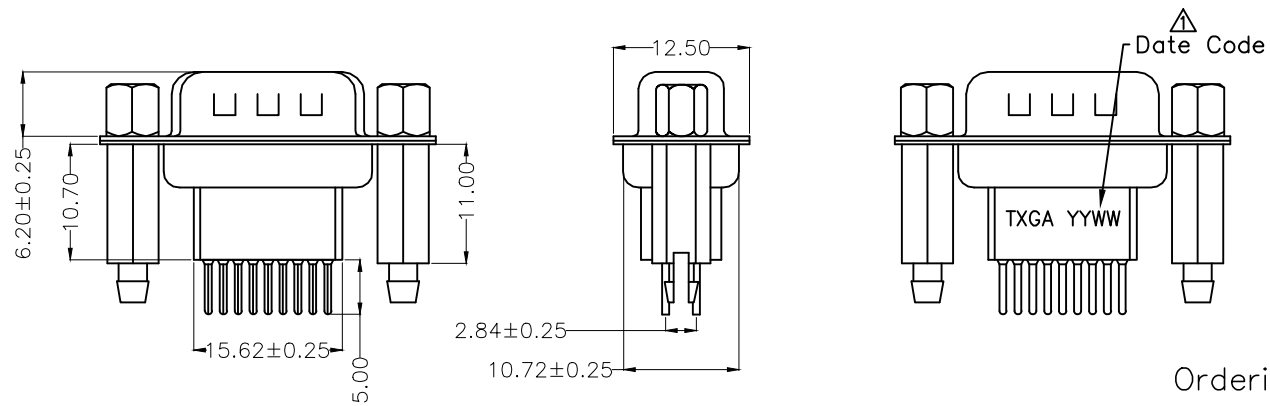
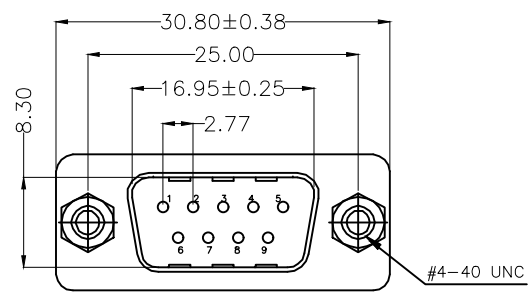

Ordering Information

FDB 09 27 — M0 D S X XX K6 K
1 2 3 4 5 6 7 8 9 10

1 Category FDB- D-SUB	2 Circuits 09	3 Distinction No. 27	4 Type M0—Male	5 Assembly Layout D—DIP	6 Entry Angle S—Vertical
7 Plating 1—Gold Plated 3—Half Gold/Tin	8 Thickness of Gold Plating 00—Gold Flash 03—3μ"..... Custom Plate Available	9 Color—Resin K6—Black	10 Packaging K—Tray		

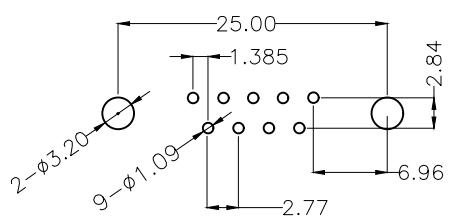

Recommended P.C.Board Layout

THIRD ANGLE PROJECTION	GENERAL TOLERANCES (UNLESS SPECIFIED)		APPROVE BY FRANK	DATE 28/JUN/13	PART NO. FDB0927—MODSXXXK6K	ITEM NO. FDB0927		
	DESIGN UNITS metric	X.±0.30	X.±1"	CHECKED BY JACOB	DATE 28/JUN/13	TITLE D-SUB 9PIN MALE CONN		REV 1
SCALE 5:1	SIZE A4	X.XX±0.15	.XX±1"	DRAWN BY CHERRY	DATE 28/JUN/13	THIS DRAWING CONTAINS INFORMATION THAT IS PROPRIETARY TO TXGA INDUSTRIAL ELECTRONICS(S.Z)CO.,LTD AND SHOULD NOT BE USED WITHOUT WRITTEN PERMISSION		