

REV	LOCATIONS	DESCRIPTION	DATE	REVISER	APPD
1	△	Size changes	08/JUL/21	KATE	CHERRY
2	△	Add spray code	13/Jan/25	NICK	LEO

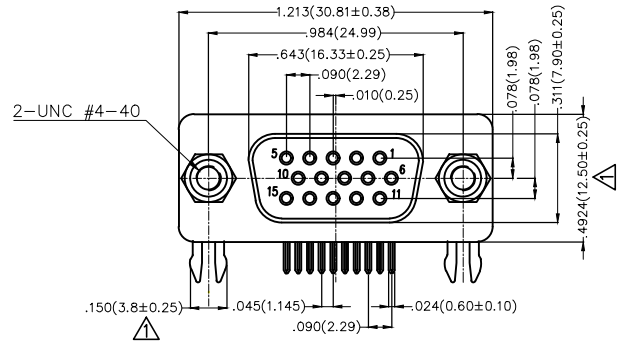

**Electrical**

Current Rating: 3A AC(rms)/DC  
Voltage Rating: 250V AC(rms)/DC  
Contact Resistance: 25 mΩ Max  
Insulation Resistance: 1000 MΩ MIN  
Withstanding Voltage: 500V AC r.m.s  
Temperature Range-Operating: -55°C ~ +105°C

**Material and Plating**

Housing: PBT( UL 94V-0)  
Contact Pin: Phosphor Bronze/Selective gold on contact area, tin on tail  
Shell: SPCC/ Nickel plated  
Nuts: Copper alloy/ Nickel plated

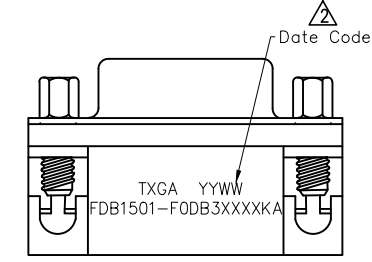
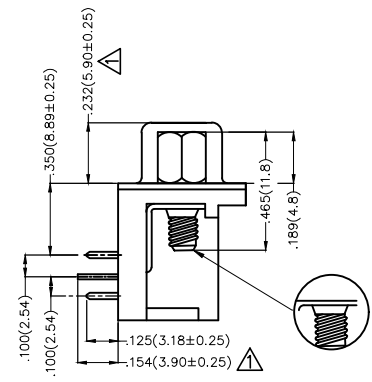
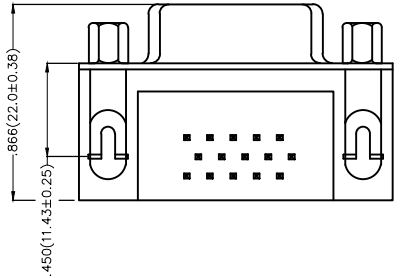

**Ordering Information**

FDB 15 01 - F0 D B 3 XX XX K A  
1 2 3 4 5 6 7 8 9 10 11

1   Category FDB-D-SUB Connectors	2   Circuits 09-9Circuits	3   Distinction No. 01	4   Type F0-Female	5   Assembly Layout D-DIP	6   Entry Angle B-90° Angle
7   Plating 3-Selective gold on contact area, tin on tail	8   Thickness of Plating 00-Gold Flash 03-3μ" Custom plate available	9   Color-Resin K6-Black U1-Blue	10   Packaging K-Tray	11   Distinction Type A-A Type	

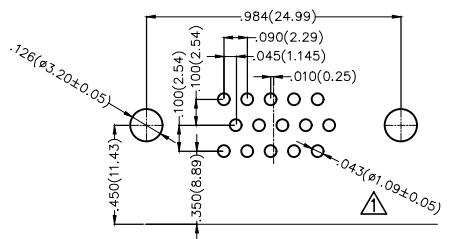

Recommended P.C.Board Layout

 <b>THIRD ANGLE PROJECTION</b>	GENERAL TOLERANCES (UNLESS SPECIFIED)		APPROVE BY FRANK	DATE 28/JUN/13	PART NO. FDB1501-F0DB3XXXXXA	ITEM NO. FDB1501	 <b>TXGA</b> Building Technology Cornerstone	
	X.±.012(0.30)	X'.±5'	CHECKED BY JACOB	DATE 28/JUN/13	TITLE D-SUB Connectors 15 Circuits 90° Angle Female			REV 2
	DESIGN UNITS Inch (metric)	X.XX±.008(0.20)	X'±2'	DRAWN BY CHERRY	DATE 28/JUN/13	THIS DRAWING CONTAINS INFORMATION THAT IS PROPRIETARY TO TXGA INDUSTRIAL ELECTRONICS(S.Z)CO.,LTD AND SHOULD NOT BE USED WITHOUT WRITTEN PERMISSION		SHEET NO. 1/1
	SCALE 5:1	SIZE A4	X.XXX±.004(0.10)	X'XX±0.5'				

REV	LOCATIONS	DESCRIPTION	DATE	REVISER	APPD
1	△	Size changes	26/JUL/22	MATT	CHERRY
2	△	Add spray code	13/Jan/25	NICK	LEO

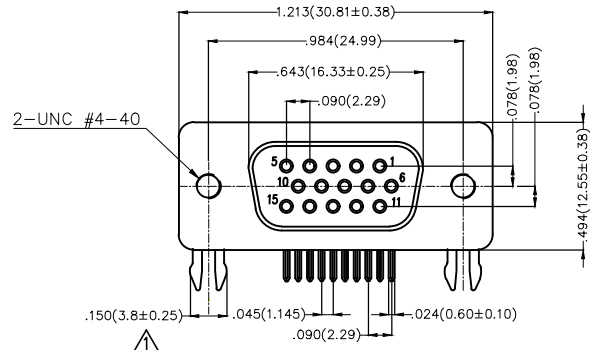

**Electrical**

Current Rating: 3A AC(rms)/DC  
Voltage Rating: 250V AC(rms)/DC  
Contact Resistance: 25 mΩ Max  
Insulation Resistance: 1000 MΩ MIN  
Withstanding Voltage: 500V AC r.m.s  
Temperature Range-Operating: -55°C ~ +105°C

**Material and Plating**

Housing: PBT( UL 94V-0)  
Contact Pin: Phosphor Bronze/Selective gold on contact area, tin on tail  
Shell: SPCC/ Nickel plated  
Nuts: Copper alloy/ Nickel plated

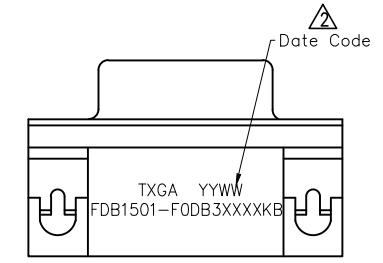
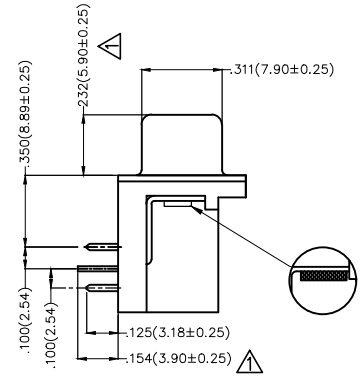
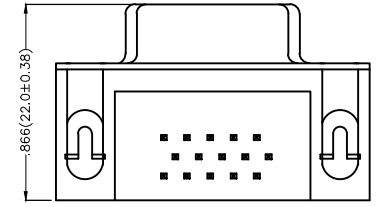

**Ordering Information**

FDB 15 01 - F0 D B 3 XX XX K B  
1 2 3 4 5 6 7 8 9 10 11

1	Category FDB-D-SUB Connectors	2	Circuits 09-9Circuits	3	Distinction No. 01	4	Type F0-Female	5	Assembly Layout D-DIP	6	Entry Angle B-90° Angle
7	Plating 3-Selective gold on contact area, tin on tail	8	Thickness of Plating 00-Gold Flash 03-3μ" Custom plate available	9	Color-Resin K6-Black U1-Blue	10	Packaging K-Tray	11	Distinction Type B-B Type		

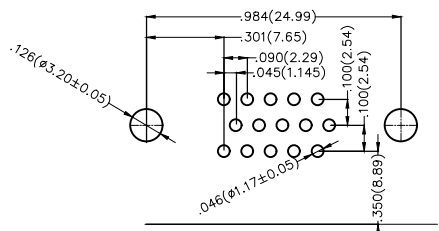

Recommended P.C.Board Layout

 <b>THIRD ANGLE PROJECTION</b>	GENERAL TOLERANCES (UNLESS SPECIFIED)		APPROVE BY FRANK	DATE 28/JUN/13	PART NO. FDB1501-F0DB3XXXXKB	ITEM NO. FDB1501	 <b>TXGA</b> Building Technology Cornerstone	
	X.±.012(0.30)	X'.±5'	CHECKED BY JACOB	DATE 28/JUN/13	TITLE D-SUB Connectors 15 Circuits 90° Angle Female			REV 2
	DESIGN UNITS Inch (metric)	X.X±.008(0.20)	X'±2'	DRAWN BY CHERRY	DATE 28/JUN/13	THIS DRAWING CONTAINS INFORMATION THAT IS PROPRIETARY TO TXGA INDUSTRIAL ELECTRONICS(S.Z)CO.,LTD AND SHOULD NOT BE USED WITHOUT WRITTEN PERMISSION		
	SCALE 5:1	SIZE A4	X.XX±.006(0.15)	X'±1'				

REV	LOCATIONS	DESCRIPTION	DATE	REVISER	APPD
1	△	Size changes	26/JUL/22	MATT	CHERRY
2	△	Add spray code	13/Jan/25	NICK	LEO

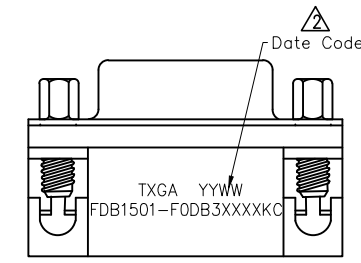
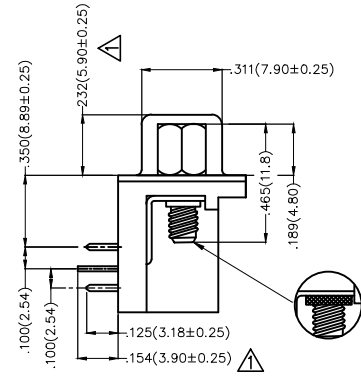
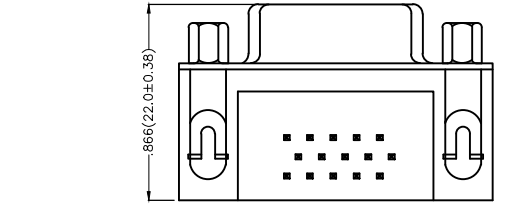
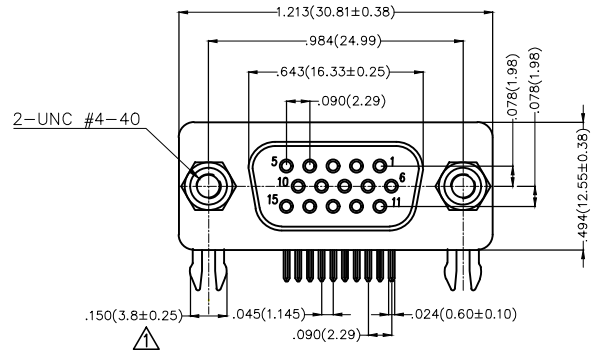

**Electrical**

Current Rating: 3A AC(rms)/DC  
Voltage Rating: 250V AC(rms)/DC  
Contact Resistance: 25 mΩ Max  
Insulation Resistance: 1000 MΩ MIN  
Withstanding Voltage: 500V AC r.m.s  
Temperature Range-Operating: -55°C ~ +105°C

**Material and Plating**

Housing: PBT( UL 94V-0)  
Contact Pin: Phosphor Bronze/Selective gold on contact area, tin on tail  
Shell: SPCC/ Nickel plated  
Nuts: Copper alloy/ Nickel plated

**Ordering Information**

FDB 15 01 - F0 D B 3 XX XX K C  
1 2 3 4 5 6 7 8 9 10 11

1   Category FDB-D-SUB Connectors	2   Circuits 09-9Circuits	3   Distinction No. 01	4   Type F0-Female	5   Assembly Layout D-DIP	6   Entry Angle B-90° Angle
7   Plating 3-Selective gold on contact area, tin on tail	8   Thickness of Plating 00-Gold Flash 03-3μ" Custom plate available	9   Color-Resin K6-Black U1-Blue	10   Packaging K-Tray	11   Distinction Type C-C Type	

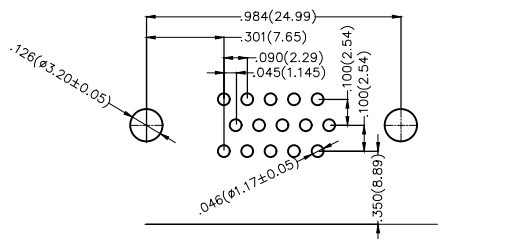

Recommended P.C.Board Layout

THIRD ANGLE PROJECTION	GENERAL TOLERANCES (UNLESS SPECIFIED)		APPROVE BY FRANK	DATE 28/JUN/13	PART NO. FDB1501-F0DB3XXXXKC	ITEM NO. FDB1501	 Building Technology Cornerstone
	DESIGN UNITS Inch (metric)	X.±.012(0.30) X.X±.008(0.20) X.XX±.006(0.15) X.XXX±.004(0.10)	X'.±5' .X'±2' .XX'±1' .XXX'±0.5'	CHECKED BY JACOB	DATE 28/JUN/13	TITLE D-SUB Connectors 15 Circuits 90° Angle Female	
SCALE 5:1	SIZE A4		DRAWN BY CHERRY	DATE 28/JUN/13	THIS DRAWING CONTAINS INFORMATION THAT IS PROPRIETARY TO TXGA INDUSTRIAL ELECTRONICS(S.Z)CO.,LTD AND SHOULD NOT BE USED WITHOUT WRITTEN PERMISSION		REV 2   SHEET NO. 1/1

REV	LOCATIONS	DESCRIPTION	DATE	REVISER	APPD
1	△	Size changes	26/JUL/22	MATT	CHERRY
2	△	Add spray code	13/Jan/25	NICK	LEO

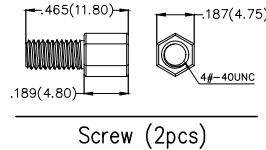
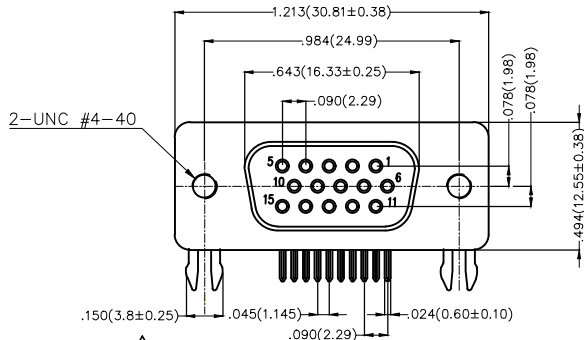

**Electrical**

Current Rating: 3A AC(rms)/DC  
Voltage Rating: 250V AC(rms)/DC  
Contact Resistance: 25 mΩ Max  
Insulation Resistance: 1000 MΩ MIN  
Withstanding Voltage: 500V AC r.m.s  
Temperature Range-Operating: -55°C ~ +105°C

**Material and Plating**

Housing: PBT( UL 94V-0)  
Contact Pin: Phosphor Bronze/Selective gold on contact area, tin on tail  
Shell: SPCC/ Nickel plated  
Nuts: Copper alloy/ Nickel plated

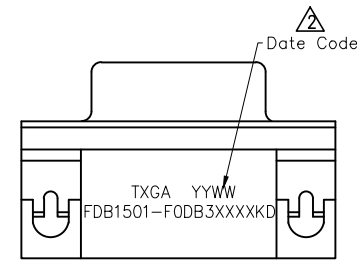
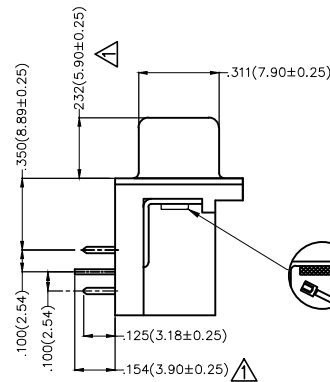
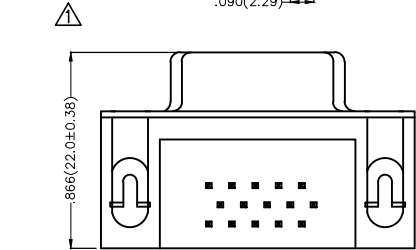

**Ordering Information**

FDB 15 01 - F0 D B 3 XX XX K D  
1 2 3 4 5 6 7 8 9 10 11

1	Category FDB-D-SUB Connectors	2	Circuits 09-9Circuits	3	Distinction No. 01	4	Type F0-Female	5	Assembly Layout D-DIP	6	Entry Angle B-90° Angle
7	Plating 3-Selective gold on contact area, tin on tail	8	Thickness of Plating 00-Gold Flash 03-3μ" Custom plate available	9	Color-Resin K6-Black U1-Blue	10	Packaging K-Tray	11	Distinction Type D-D Type		

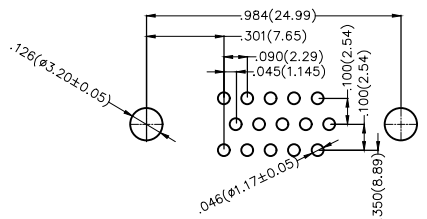

Recommended P.C.Board Layout

THIRD ANGLE PROJECTION	GENERAL TOLERANCES (UNLESS SPECIFIED)		APPROVE BY FRANK	DATE 28/JUN/13	PART NO. FDB1501-F0DB3XXXXKD	ITEM NO. FDB1501	 Building Technology Cornerstone	
	DESIGN UNITS Inch (metric)	X.±.012(0.30) X.X±.008(0.20) X.XX±.006(0.15) X.XXX±.004(0.10)	X'.±5' .X'±2' .XX'±1' .XXX'±0.5'	CHECKED BY JACOB	DATE 28/JUN/13	TITLE D-SUB Connectors 15 Circuits 90° Angle Female		REV 2
SCALE 5:1	SIZE A4		DRAWN BY CHERRY	DATE 28/JUN/13	THIS DRAWING CONTAINS INFORMATION THAT IS PROPRIETARY TO TXGA INDUSTRIAL ELECTRONICS(S.Z)CO.,LTD AND SHOULD NOT BE USED WITHOUT WRITTEN PERMISSION			

REV	LOCATIONS	DESCRIPTION	DATE	REVISER	APPD
1	△	Add spray code	13/Jan/25	NICK	LEO

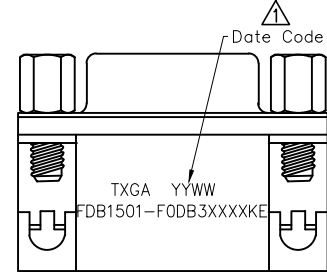
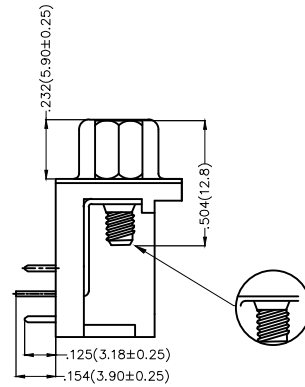
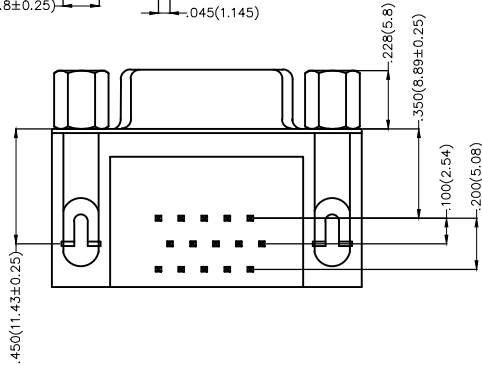
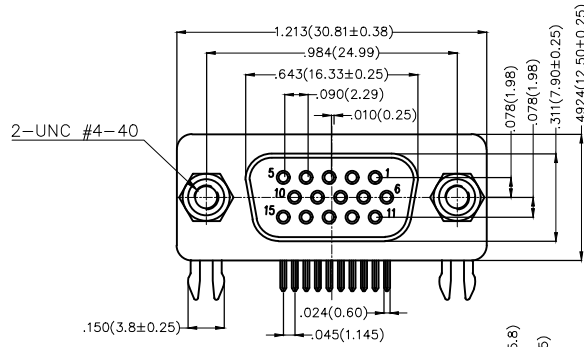

**Electrical**

Current Rating: 3A AC(rms)/DC  
Voltage Rating: 250V AC(rms)/DC  
Contact Resistance: 25 mΩ Max  
Insulation Resistance: 1000 MΩ MIN  
Withstanding Voltage: 500V AC r.m.s  
Temperature Range—Operating: -55°C ~ +105°C

**Material and Plating**

Housing: PBT( UL 94V-0)  
Contact Pin: Phosphor Bronze/Selective gold on contact area, tin on tail  
Shell: SPCC/ Nickel plated  
Nuts: Copper alloy/ Nickel plated

**Ordering Information**

FDB 15 01 - F0 D B 3 XX XX K E  
1 2 3 4 5 6 7 8 9 10 11

1   Category FDB-D-SUB Connectors	2   Circuits 09-9Circuits	3   Distinction No. 01	4   Type F0-Female	5   Assembly Layout D-DIP	6   Entry Angle B-90° Angle
7   Plating 3-Selective gold on contact area, tin on tail	8   Thickness of Plating 00-Gold Flash 03-3μ" Custom plate available	9   Color-Resin K6-Black U1-Blue	10   Packaging K-Tray	11   Distinction Type E-E Type	

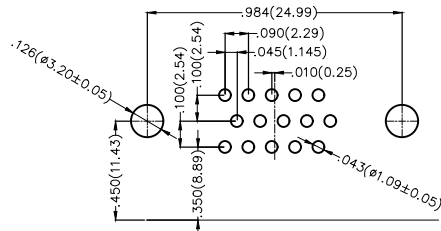

Recommended P.C.Board Layout

THIRD ANGLE PROJECTION	GENERAL TOLERANCES (UNLESS SPECIFIED)		APPROVE BY FRANK	DATE 20/FEB/24	PART NO. FDB1501-F0DB3XXXXXE	ITEM NO. FDB1501	 Building Technology Cornerstone	
	DESIGN UNITS Inch (metric)	X.±.012(0.30) X.X±.008(0.20) X.XX±.006(0.15) X.XXX±.004(0.10)	X.'±5' X.'±2' X.X'±1" X.XXX'±.05'	CHECKED BY JACOB	DATE 20/FEB/24	TITLE D-SUB Connectors 15 Circuits 90° Angle Female		REV 1
SCALE 5:1	SIZE A4	DRAWN BY MATT		DATE 20/FEB/24	THIS DRAWING CONTAINS INFORMATION THAT IS PROPRIETARY TO TXGA INDUSTRIAL ELECTRONICS(S.Z)CO.,LTD AND SHOULD NOT BE USED WITHOUT WRITTEN PERMISSION			

REV	LOCATIONS	DESCRIPTION	DATE	REVISER	APPD

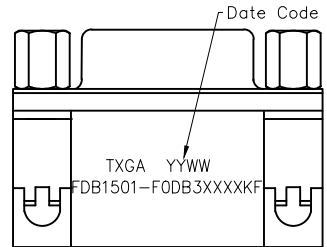
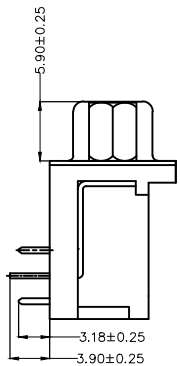
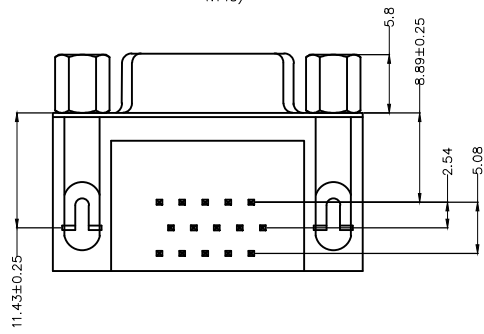
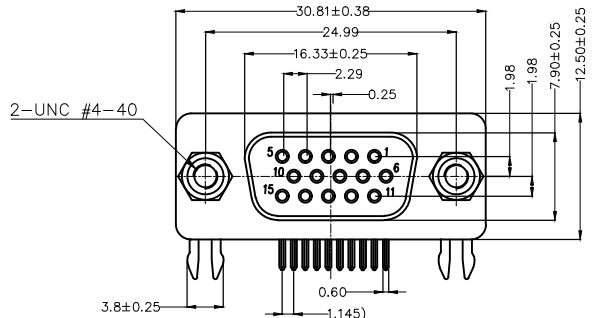

**Electrical**

Current Rating: 3A AC(rms)/DC  
 Voltage Rating: 250V AC(rms)/DC  
 Contact Resistance: 25 mΩ Max  
 Insulation Resistance: 1000 MΩ MIN  
 Withstanding Voltage: 500V AC r.m.s  
 Temperature Range-Operating: -55°C~+105°C

**Material and Plating**

Housing: PBT( UL 94V-0)  
 Contact Pin: Phosphor Bronze/Selective gold on contact area, tin on tail  
 Shell: SPCC/ Nickel plated  
 Nuts: Copper alloy/ Nickel plated

**Ordering Information**

FDB 15 01 - F0 D B 3 XX XX K F  
 1 2 3 4 5 6 7 8 9 10 11

1 Category FDB-D-SUB Connectors	2 Circuits 09-9Circuits	3 Distinction No. 01	4 Type F0-Female	5 Assembly Layout D-DIP	6 Entry Angle B-90° Angle
7 Plating 3-Selective gold on contact area, tin on tail	8 Thickness of Plating 00-Gold Flash 03-3μ" Custom plate available	9 Color-Resin K6-Black U1-Blue	10 Packaging K-Tray	11 Distinction Type F-F Type	

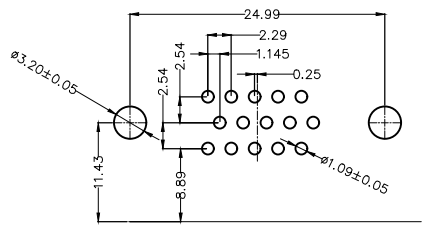

Recommended P.C.Board Layout

THIRD ANGLE PROJECTION	GENERAL TOLERANCES (UNLESS SPECIFIED)		APPROVE BY LEO	DATE 15/AUG/24	PART NO. FDB1501-F0DB3XXXXKF	ITEM NO. FDB1501	
	X. ±0.30	X.* ±5°	CHECKED BY GISELLE	DATE 15/AUG/24	TITLE D-SUB Connectors 15 Circuits 90° Angle Female		
DESIGN UNITS METRIC	X.X ±0.20	X.X* ±2°	DRAWN BY NICK	DATE 15/AUG/24	THIS DRAWING CONTAINS INFORMATION THAT IS PROPRIETARY TO TXGA INDUSTRIAL ELECTRONICS(S,Z)CO.,LTD AND SHOULD NOT BE USED WITHOUT WRITTEN PERMISSION		
SCALE 5:1	SIZE A4	X.XX ±0.15	X.XX* ±1°	X.XXX ±0.10	X.XXX* ±0.5°		