

REV	LOCATIONS	DESCRIPTION	DATE	REVISER	APPD
1		Size changes	01/SEP/21	KATE	CHERRY
2		Add spray code	13/Jan/25	NICK	LEO

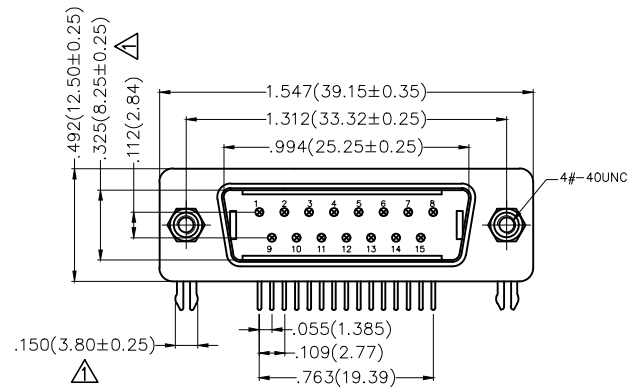

Electrical
 Current Rating: 3A AC(rms)/DC
 Voltage Rating: 250V AC(rms)/DC
 Contact Resistance: 30 mΩ Max
 Insulation Resistance: 1000 MΩ MIN
 Withstanding Voltage: 500V AC r.m.s
 Temperature Range—Operating: -55°C~+105°C

Material and Plating
 Housing: PBT (UL 94V-0)
 Contact Pin: Copper alloy
 Contact Plating: Selective gold on contact area, tin on tail
 Shell: SPCC/ Nickel plated
 Board lock: Copper alloy/ Tin plated
 Screws: Copper alloy/ Tin plated

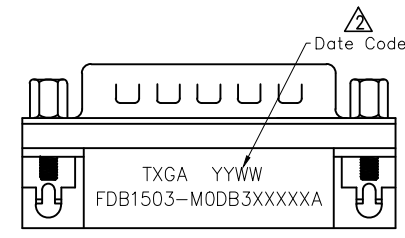
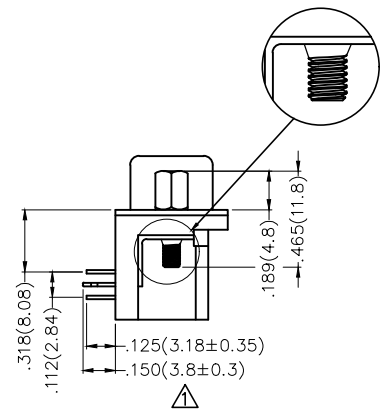
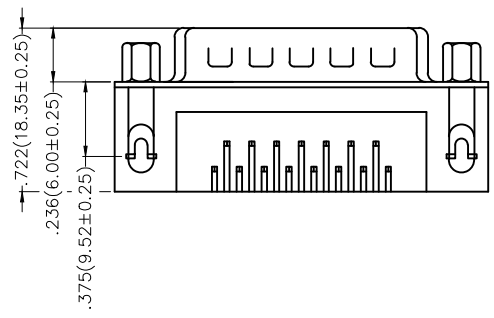

Ordering Information

FDB 15 03 — MO D B 3 XX XX X A
 1 2 3 4 5 6 7 8 9 10 11

1	Category FDB-D-SUB Connectors	2	Circuits 15-15Circuits	3	Distinction No. 03	4	Type MO-Male	5	Assembly Layout D-DIP	6	Entry Angle B-90° Angle
7	Plating 3-Selective gold on contact area, tin on tail	8	Thickness of Plating 00-Gold Flash 03-3μ" Custom plate available	9	Color-Resin K6-Black U1-Blue	10	Packaging K-Tray L-Tube	11	Distinction Type A-A Type		

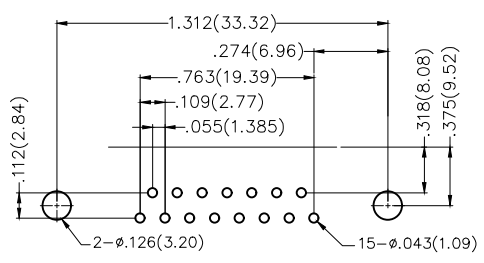

Recommended P.C.Board Layout

THIRD ANGLE PROJECTION	GENERAL TOLERANCES (UNLESS SPECIFIED)		APPROVE BY FRANK	DATE 28/JUN/13	PART NO. FDB1503-M0DB3XXXXXA	ITEM NO. FDB1503	 Building Technology Cornerstone
	X.±.012(0.30)	X.±5'	CHECKED BY JACOB	DATE 28/JUN/13	TITLE D-SUB Connectors 15 Circuits 90° Angle Male		
DESIGN UNITS Inch (metric)	X.X±.008(0.20)	.X'±2'	DRAWN BY CHERRY	DATE 28/JUN/13	THIS DRAWING CONTAINS INFORMATION THAT IS PROPRIETARY TO TXGA INDUSTRIAL ELECTRONICS(S.Z)CO.,LTD AND SHOULD NOT BE USED WITHOUT WRITTEN PERMISSION		REV 2 SHEET NO. 1/1

REV	LOCATIONS	DESCRIPTION	DATE	REVISER	APPD
1		Size changes	01/SEP/21	KATE	CHERRY
2		Add spray code	13/Jan/25	NICK	LEO

A
B
C
D
E
F

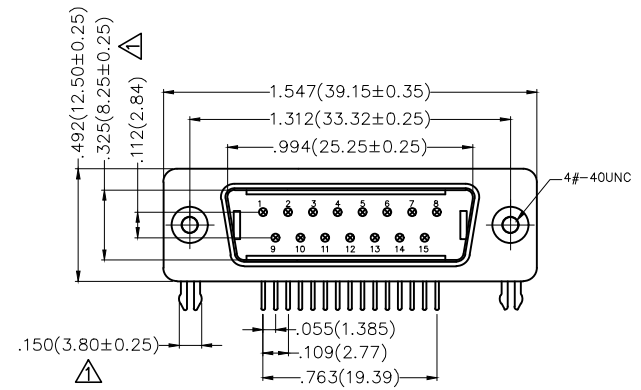

Electrical

Current Rating: 3A AC(rms)/DC
Voltage Rating: 250V AC(rms)/DC
Contact Resistance: 30 mΩ Max
Insulation Resistance: 1000 MΩ MIN
Withstanding Voltage: 500V AC r.m.s
Temperature Range—Operating: -55°C ~+105°C

Material and Plating

Housing: PBT (UL 94V-0)
Contact Pin: Copper alloy
Contact Plating: Selective gold on contact area, tin on tail
Shell: SPCC/ Nickel plated
Board lock: Copper alloy/ Tin plated

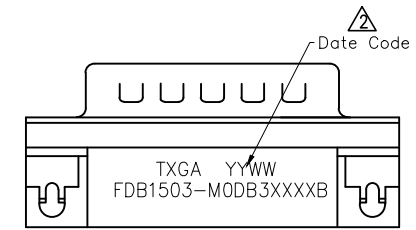
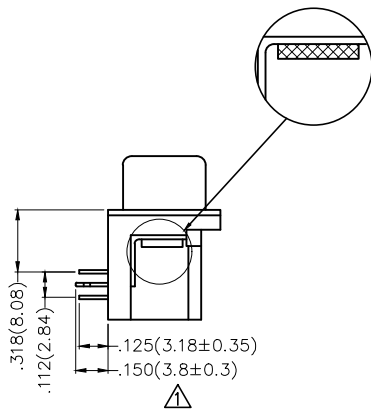
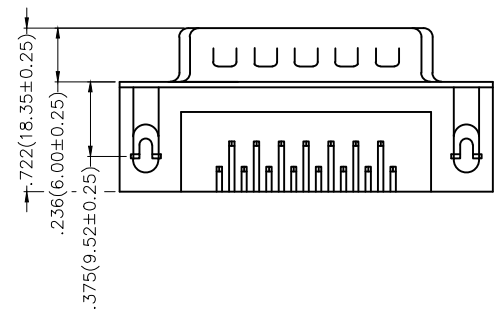

Ordering Information

FDB 15 03 — M0 D B 3 XX XX X B
1 2 3 4 5 6 7 8 9 10 11

1	Category FDB-D-SUB Connectors	2	Circuits 15-15Circuits	3	Distinction No. 03	4	Type M0-Male	5	Assembly Layout D-DIP	6	Entry Angle B-90° Angle
7	Plating 3-Selective gold on contact area, tin on tail	8	Thickness of Plating 00-Gold Flash 03-3μ" Custom plate available	9	Color-Resin K6-Black U1-Blue	10	Packaging K-Tray L-Tube	11	Distinction Type B-B Type		

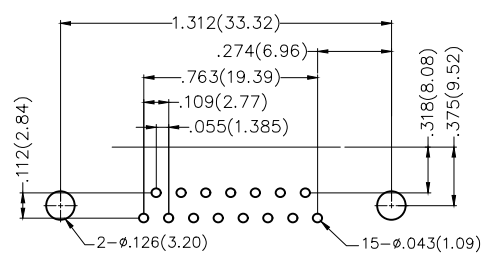

Recommended P.C.Board Layout

 THIRD ANGLE PROJECTION	GENERAL TOLERANCES (UNLESS SPECIFIED)		APPROVE BY FRANK	DATE 28/JUN/13	PART NO. FDB1503-M0DB3XXXXB	ITEM NO. FDB1503	 Building Technology Cornerstone	
	X.±.012(0.30)	.X'±5'	CHECKED BY JACOB	DATE 28/JUN/13	TITLE D-SUB Connectors 15 Circuits 90° Angle Male			REV 2
	DESIGN UNITS Inch (metric)	X.XX±.008(0.20)	.X'±2'	DRAWN BY CHERRY	DATE 28/JUN/13	THIS DRAWING CONTAINS INFORMATION THAT IS PROPRIETARY TO TXGA INDUSTRIAL ELECTRONICS(S.Z)CO.,LTD AND SHOULD NOT BE USED WITHOUT WRITTEN PERMISSION		
	SCALE 5:1	SIZE A4	X.XXX±.004(0.10)	.XX'±1'	.XXX'±0.5'			

1 2 3 4 5 6 7 8

REV	LOCATIONS	DESCRIPTION	DATE	REVISER	APPD
1	△	Size changes	01/SEP/21	KATE	CHERRY
2	△	Add spray code	13/Jan/25	NICK	LEO

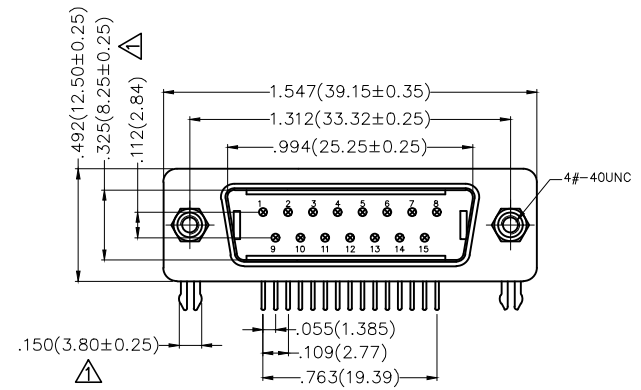

Electrical

Current Rating: 3A AC(rms)/DC
Voltage Rating: 250V AC(rms)/DC
Contact Resistance: 30 mΩ Max
Insulation Resistance: 1000 MΩ MIN
Withstanding Voltage: 500V AC r.m.s
Temperature Range—Operating: -55°C ~+105°C

Material and Plating

Housing: PBT (UL 94V-0)
Contact Pin: Copper alloy
Contact Plating: Selective gold on contact area, tin on tail
Shell: SPCC/ Nickel plated
Board lock: Copper alloy/ Tin plated
Screws: Copper alloy/ Tin plated

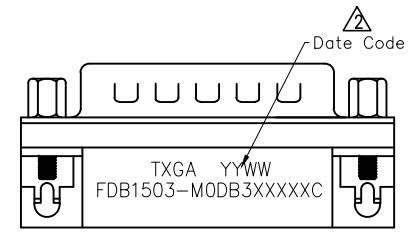
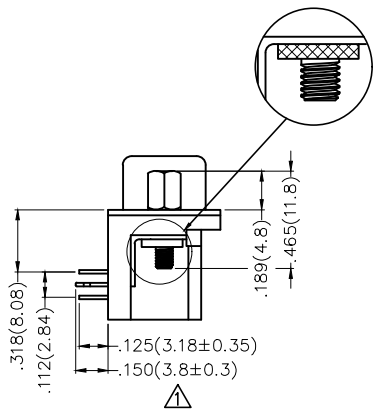
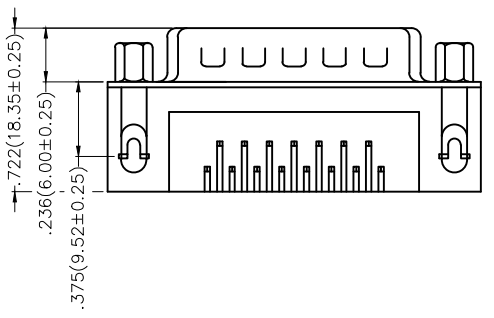

Ordering Information

FDB 15 03 — M0 D B 3 XX XX X C
1 2 3 4 5 6 7 8 9 10 11

1	Category FDB-D-SUB Connectors	2	Circuits 15-15Circuits	3	Distinction No. 03	4	Type M0-Male	5	Assembly Layout D-DIP	6	Entry Angle B-90° Angle
7	Plating 3-Selective gold on contact area, tin on tail	8	Thickness of Plating 00-Gold Flash 03-3μ" Custom plate available	9	Color-Resin K6-Black U1-Blue	10	Packaging K-Tray L-Tube	11	Distinction Type C-C Type		

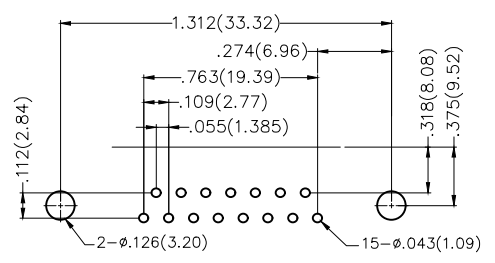

Recommended P.C.Board Layout

 THIRD ANGLE PROJECTION	GENERAL TOLERANCES (UNLESS SPECIFIED)		APPROVE BY FRANK	DATE 28/JUN/13	PART NO. FDB1503-MODB3XXXXXC	ITEM NO. FDB1503	 Building Technology Cornerstone	
	X.±.012(0.30)	.X'±5'	CHECKED BY JACOB	DATE 28/JUN/13	TITLE D-SUB Connectors 15 Circuits 90° Angle Male			REV 2
	DESIGN UNITS Inch (metric)	X.XX±.008(0.20)	.X'±2'	DRAWN BY CHERRY	DATE 28/JUN/13	THIS DRAWING CONTAINS INFORMATION THAT IS PROPRIETARY TO TXGA INDUSTRIAL ELECTRONICS(S.Z)CO.,LTD AND SHOULD NOT BE USED WITHOUT WRITTEN PERMISSION		
	SCALE 5:1	SIZE A4	X.XX±.006(0.15)	.XX'±1'				

REV	LOCATIONS	DESCRIPTION	DATE	REVISER	APPD
1		Size changes	01/SEP/21	KATE	CHERRY
2		Add spray code	13/Jan/25	NICK	LEO

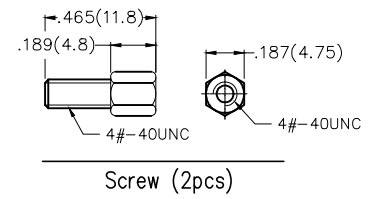
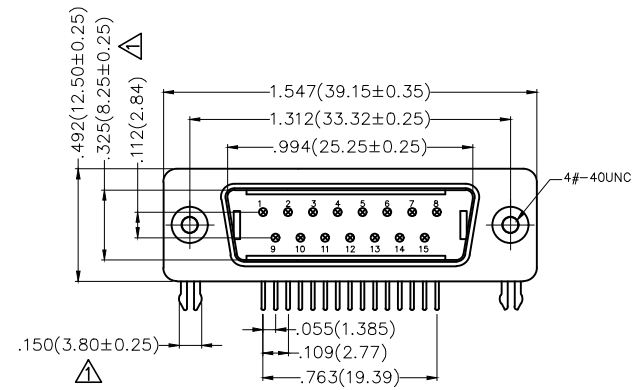

Electrical

Current Rating: 3A AC(rms)/DC
Voltage Rating: 250V AC(rms)/DC
Contact Resistance: 30 mΩ Max
Insulation Resistance: 1000 MΩ MIN
Withstanding Voltage: 500V AC r.m.s
Temperature Range—Operating: -55°C ~+105°C

Material and Plating

Housing: PBT (UL 94V-0)
Contact Pin: Copper alloy
Contact Plating: Selective gold on contact area, tin on tail
Shell: SPCC/ Nickel plated
Board lock: Copper alloy/ Tin plated
Screws: Copper alloy/ Nickel plated

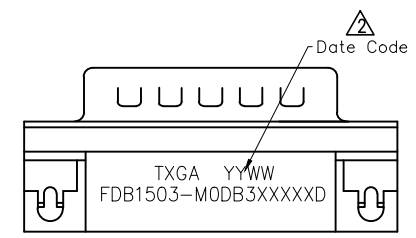
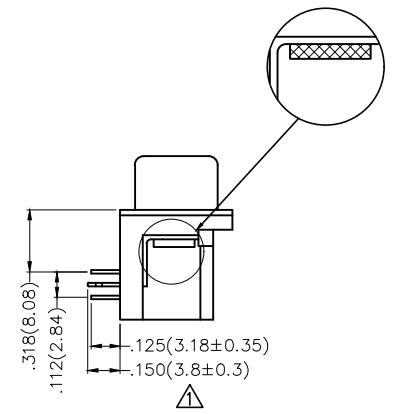
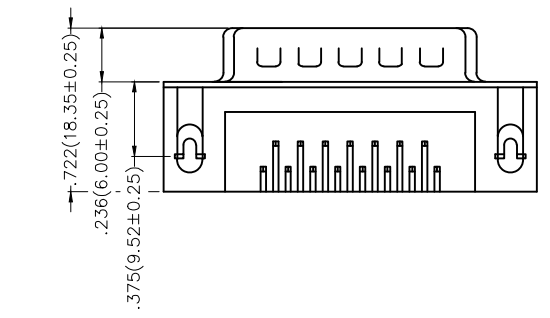

Ordering Information

FDB 15 03 — M0 D B 3 XX XX X D
1 2 3 4 5 6 7 8 9 10 11

1	Category FDB-D-SUB Connectors	2	Circuits 15-15Circuits	3	Distinction No. 03	4	Type M0-Male	5	Assembly Layout D-DIP	6	Entry Angle B-90° Angle
7	Plating 3-Selective gold on contact area, tin on tail	8	Thickness of Plating 00-Gold Flash 03-3μ Custom plate available	9	Color-Resin K6-Black U1-Blue	10	Packaging K-Tray L-Tube	11	Distinction Type D-D Type		

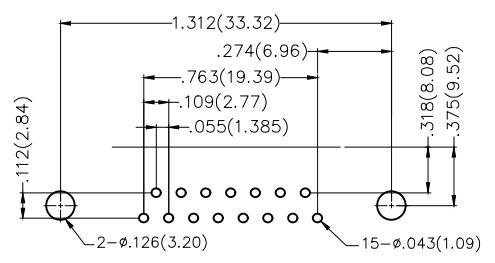

Recommended P.C.Board Layout

 THIRD ANGLE PROJECTION	GENERAL TOLERANCES (UNLESS SPECIFIED)		APPROVE BY FRANK	DATE 28/JUN/13	PART NO. FDB1503-M0DB3XXXXD	ITEM NO. FDB1503	 Building Technology Cornerstone	
	X.±.012(0.30)	.X'±5'	CHECKED BY JACOB	DATE 28/JUN/13	TITLE D-SUB Connectors 15 Circuits 90° Angle Male			REV 2
	DESIGN UNITS Inch (metric)	X.XX±.008(0.20)	.X'±2'	DRAWN BY CHERRY	DATE 28/JUN/13	THIS DRAWING CONTAINS INFORMATION THAT IS PROPRIETARY TO TXGA INDUSTRIAL ELECTRONICS(S.Z)CO.,LTD AND SHOULD NOT BE USED WITHOUT WRITTEN PERMISSION		
	SCALE 5:1	SIZE A4	X.XXX±.004(0.10)	.XXX±0.5'				

REV	LOCATIONS	DESCRIPTION	DATE	REVISER	APPD
1		Update size	12/AUG/24	MATT	LEO
2		Add spray code	13/Jan/25	NICK	LEO

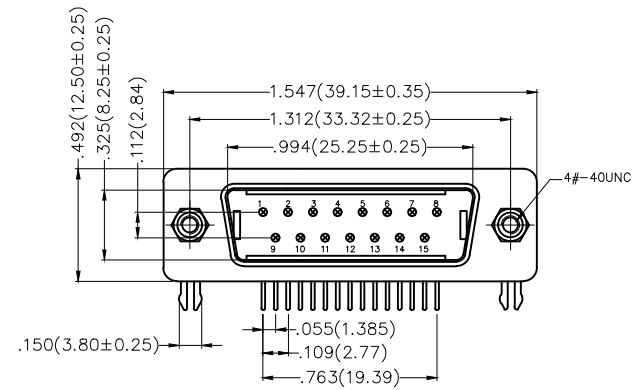

Electrical
 Current Rating: 3A AC(rms)/DC
 Voltage Rating: 250V AC(rms)/DC
 Contact Resistance: 30 mΩ Max
 Insulation Resistance: 1000 MΩ MIN
 Withstanding Voltage: 500V AC r.m.s
 Temperature Range—Operating: -55°C ~+105°C

Material and Plating
 Housing: PBT (UL 94V-0)
 Contact Pin: Copper alloy
 Contact Plating: Selective gold on contact area, tin on tail
 Shell: SPCC/ Nickel plated
 Board lock: Copper alloy/ Tin plated
 Screws: Copper alloy/ Nickel plated

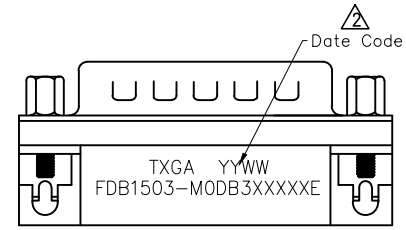
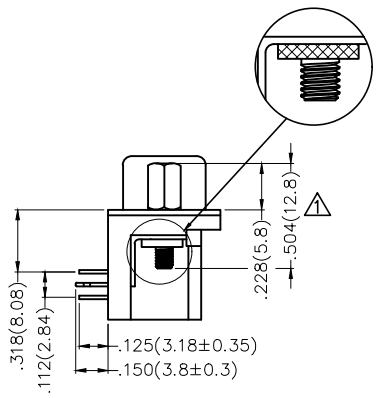
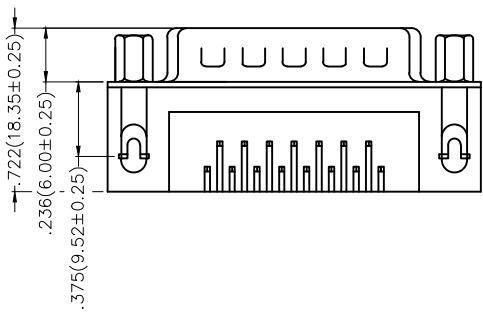

Ordering Information

FDB 15 03 — M0 D B 3 XX XX X E
 1 2 3 4 5 6 7 8 9 10 11

1 Category FDB-D-SUB Connectors	2 Circuits 15-15Circuits	3 Distinction No. 03	4 Type M0-Male	5 Assembly Layout D-DIP	6 Entry Angle B-90° Angle
7 Plating 3-Selective gold on contact area, tin on tail	8 Thickness of Plating 00-Gold Flash 03-3μ" Custom plate available	9 Color-Resin K6-Black U1-Blue	10 Packaging K-Tray L-Tube	11 Distinction Type E-E Type	

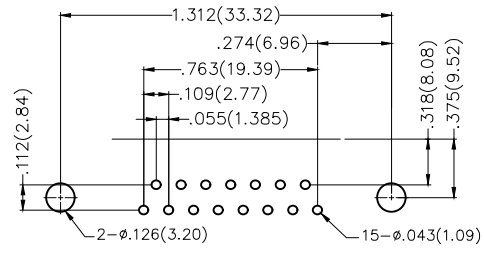

Recommended P.C.Board Layout

 THIRD ANGLE PROJECTION DESIGN UNITS Inch (metric) SCALE 5:1 SIZE A4	GENERAL TOLERANCES (UNLESS SPECIFIED)		APPROVE BY FRANK	DATE 08/MAR/23	PART NO. FDB1503-M0DB3XXXXXE	ITEM NO. FDB1503	 Building Technology Cornerstone
	X.±.012(0.30)	.X'±5'	CHECKED BY JACOB	DATE 08/MAR/23	TITLE D-SUB Connectors 15 Circuits 90° Angle Male		
	X.XX±.008(0.20)	.X'±2'	DRAWN BY MATT	DATE 08/MAR/23	THIS DRAWING CONTAINS INFORMATION THAT IS PROPRIETARY TO TXGA INDUSTRIAL ELECTRONICS(S.Z)CO.,LTD AND SHOULD NOT BE USED WITHOUT WRITTEN PERMISSION		SHEET NO. 1/1
	X.XXX±.006(0.15)	.XX'±1'					
X.XXX±.004(0.10)	.XXX'±0.5'						

REV	LOCATIONS	DESCRIPTION	DATE	REVISER	APPD
1	△	Add spray code	13/Jan/25	NICK	LEO

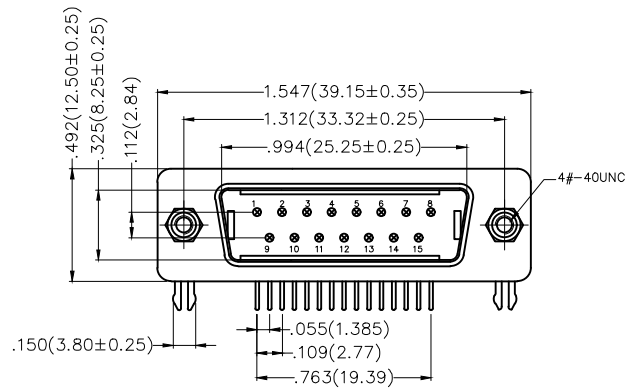

Electrical

Current Rating: 3A AC(rms)/DC
Voltage Rating: 250V AC(rms)/DC
Contact Resistance: 30 m Ω Max
Insulation Resistance: 1000 M Ω MIN
Withstanding Voltage: 500V AC r.m.s
Temperature Range—Operating: -55°C ~+105°C

Material and Plating

Housing: PBT (UL 94V-0)
Contact Pin: Copper alloy
Contact Plating: Selective gold on contact area, tin on tail
Shell: SPCC/ Nickel plated
Board lock: Copper alloy/ Tin plated
Screws: Copper alloy/ Nickel plated

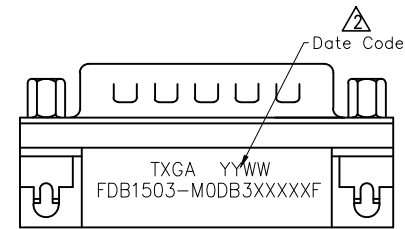
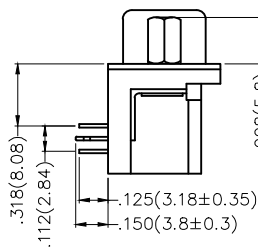
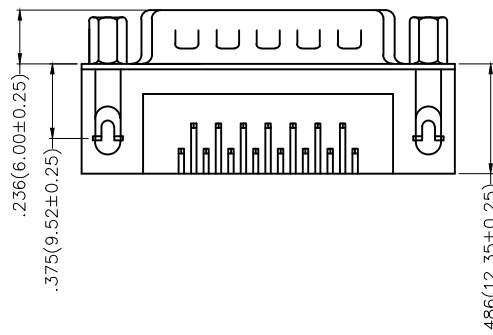

Ordering Information

FDB 15 03 — M0 D B 3 XX XX X F
1 2 3 4 5 6 7 8 9 10 11

1 Category FDB-D-SUB Connectors	2 Circuits 15-15Circuits	3 Distinction No. 03	4 Type M0-Male	5 Assembly Layout D-DIP	6 Entry Angle B-90° Angle
7 Plating 3-Selective gold on contact area, tin on tail	8 Thickness of Plating 00-Gold Flash 03-3μ" Custom plate available	9 Color-Resin K6-Black U1-Blue	10 Packaging K-Tray L-Tube	11 Distinction Type F-F Type	

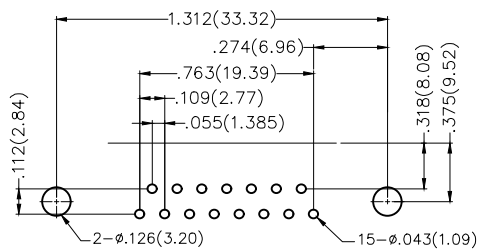

Recommended P.C.Board Layout

 THIRD ANGLE PROJECTION	GENERAL TOLERANCES (UNLESS SPECIFIED)		APPROVE BY FRANK	DATE 08/MAR/23	PART NO. FDB1503-M0DB3XXXXXF	ITEM NO. FDB1503	 TXGA Building Technology Cornerstone	
	X.±.012(0.30)	.X'±5'	CHECKED BY JACOB	DATE 08/MAR/23	TITLE D-SUB Connectors 15 Circuits 90° Angle Male			REV 2
	DESIGN UNITS Inch (metric)	X.XX±.008(0.20)	.X'±2'	DRAWN BY MATT	DATE 08/MAR/23	THIS DRAWING CONTAINS INFORMATION THAT IS PROPRIETARY TO TXGA INDUSTRIAL ELECTRONICS(S.Z)CO.,LTD AND SHOULD NOT BE USED WITHOUT WRITTEN PERMISSION		SHEET NO. 1/1
	SCALE 5:1	SIZE A4	X.XXX±.004(0.10)	.XX'±1'				