

REV	LOCATIONS	DESCRIPTION	DATE	REVISER	APPD
1		Size change	23/JUN/20	KATE	CHERRY
2		Correct dimensions	24/MAY/24	MATT	CHERRY
3		Add marking code	13/Jan/25	NICK	LEO

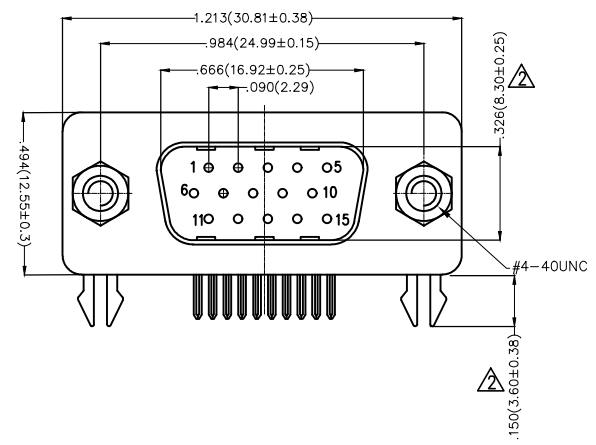

**Electrical**  
 Current Rating: 3A AC(rms)/DC  
 Voltage Rating: 250V AC(rms)/DC  
 Contact Resistance: 25 mΩ Max  
 Insulation Resistance: 1000 MΩ MIN  
 Withstanding Voltage: 500V AC r.m.s  
 Temperature Range—Operating: -45°C~+105°C

**Material and Plating**  
 Housing: PBT+30%GF( UL 94V-0)  
 Contact Pin: Brass  
 Plating: Selective gold in contact area, tin on tail  
 Shell: SPCC/ Nickel plated  
 Board lock: SPCC/ Tin plated  
 Screws: Copper alloy/ Nickel plated

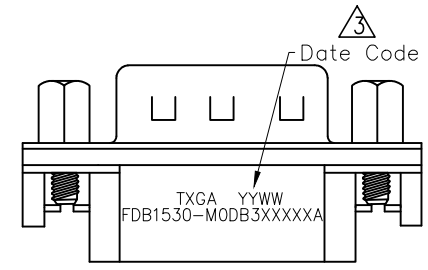
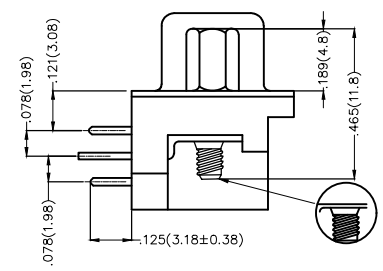
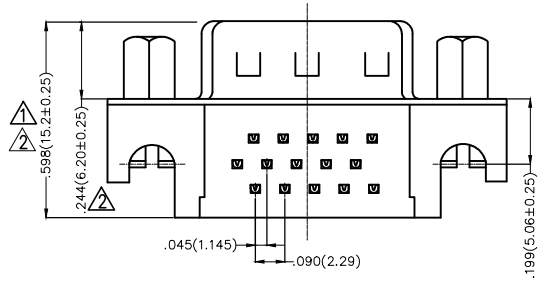

**Ordering Information**

FDB 15 30 — M0 D B 3 XX XX X A  
 1 2 3 4 5 6 7 8 9 10 11

1	Category FDB-D-SUB Connectors	2	Circuits 15-15Circuits	3	Distinction No. 30	4	Type M0-Male	5	Assembly Layout D-DIP	6	Entry Angle B-90° Angle
7	Plating 3-Selective gold in contact area, tin on tail	8	Thickness of Plating 00-Gold Flash 03-3μ" Custom plate available	9	Color-Resin K6-Black U1-Blue	10	Packaging L-Tube K-Tray	11	Distinction Type A-A Type		

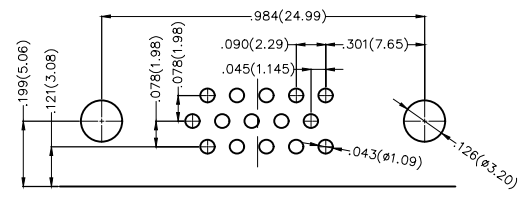

Recommended P.C.Board Layout

 THIRD ANGLE PROJECTION	GENERAL TOLERANCES (UNLESS SPECIFIED)		APPROVE BY FRANK	DATE 25/JUN/13	PART NO. FDB1530-M0DB3XXXXXA	ITEM NO. FDB1530	 Building Technology Cornerstone
	DESIGN UNITS Inch (metric)	X.±.012(0.30) X.X±.008(0.20) X.XX±.006(0.15) X.XXX±.004(0.10)	X.±5' .X'±2' .XX'±1' .XXX'±0.5'	CHECKED BY JACOB	DATE 25/JUN/13	TITLE D-SUB Connectors 15 Circuits 90° Angl Male	
SCALE 5:1	SIZE A4		DRAWN BY CHERRY	DATE 25/JUN/13	THIS DRAWING CONTAINS INFORMATION THAT IS PROPRIETARY TO TXGA INDUSTRIAL ELECTRONICS(S.Z)CO.,LTD AND SHOULD NOT BE USED WITHOUT WRITTEN PERMISSION		REV 3 SHEET NO. 1/1

REV	LOCATIONS	DESCRIPTION	DATE	REVISER	APPD
1		Size change	23/JUN/20	KATE	CHERRY
2		Correct dimensions	24/MAY/24	MATT	CHERRY
3		Add marking code	13/Jan/25	NICK	LEO

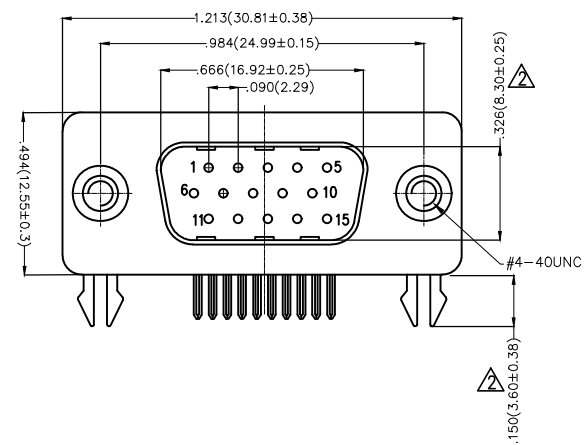

**Electrical**  
 Current Rating: 3A AC(rms)/DC  
 Voltage Rating: 250V AC(rms)/DC  
 Contact Resistance: 25 mΩ Max  
 Insulation Resistance: 1000 MΩ MIN  
 Withstanding Voltage: 500V AC r.m.s  
 Temperature Range—Operating: -45°C~+105°C

**Material and Plating**  
 Housing: PBT+30%GF( UL 94V-0)  
 Contact Pin: Brass  
 Plating: Selective gold in contact area, tin on tail  
 Shell: SPCC/ Nickel plated  
 Board lock: SPCC/ Tin plated  
 Screws: Copper alloy/ Nickel plated

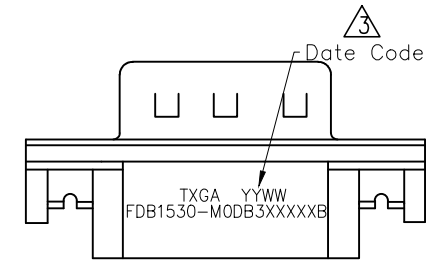
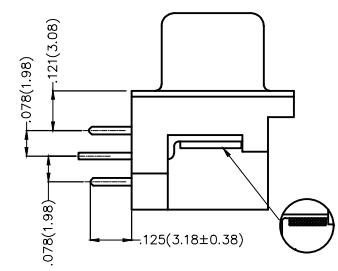
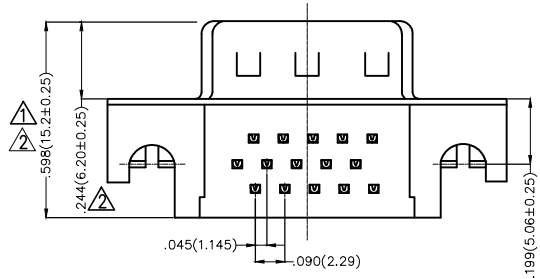

**Ordering Information**

FDB 15 30 — M0 D B 3 XX XX X B  
 1 2 3 4 5 6 7 8 9 10 11

1	Category FDB-D-SUB Connectors	2	Circuits 15-15Circuits	3	Distinction No. 30	4	Type M0-Male	5	Assembly Layout D-DIP	6	Entry Angle B-90° Angle
7	Plating 3-Selective gold in contact area, tin on tail	8	Thickness of Plating 00-Gold Flash 03-3μ" Custom plate available	9	Color-Resin K6-Black U1-Blue	10	Packaging L-Tube K-Tray	11	Distinction Type B-B Type		

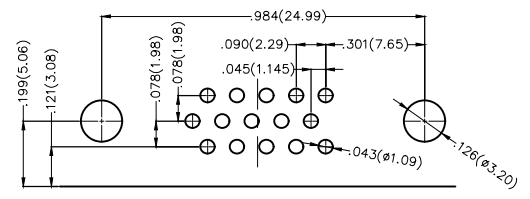

Recommended P.C.Board Layout

THIRD ANGLE PROJECTION		GENERAL TOLERANCES (UNLESS SPECIFIED)		APPROVE BY	DATE	PART NO.	ITEM NO.	TXGA	
DESIGN UNITS Inch (metric)	X.±.012(0.30)	X'.±5'	DRAWN BY	FRANK	25/JUN/13	FDB1530-MODB3XXXXXB	FDB1530	Building Technology Cornerstone	
	X.X±.008(0.20)	.X'±2'		JACOB	25/JUN/13	D-SUB Connectors 15 Circuits 90° Angl Male		REV 3	SHEET NO. 1/1
SCALE	X.XX±.006(0.15)	.XX'±1'	CHERRY	DATE	25/JUN/13	THIS DRAWING CONTAINS INFORMATION THAT IS PROPRIETARY TO TXGA INDUSTRIAL ELECTRONICS(S.Z)CO.,LTD AND SHOULD NOT BE USED WITHOUT WRITTEN PERMISSION			
5:1	X.XXX±.004(0.10)	.XXX'±0.5'							

REV	LOCATIONS	DESCRIPTION	DATE	REVISER	APPD
1		Size change	23/JUN/20	KATE	CHERRY
2		Correct dimensions	24/MAY/24	MATT	CHERRY
3		Add marking code	13/Jan/25	NICK	LEO

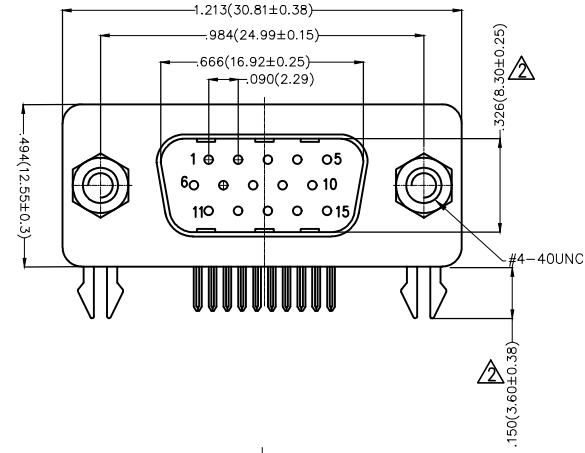

**Electrical**  
 Current Rating: 3A AC(rms)/DC  
 Voltage Rating: 250V AC(rms)/DC  
 Contact Resistance: 25 mΩ Max  
 Insulation Resistance: 1000 MΩ MIN  
 Withstanding Voltage: 500V AC r.m.s  
 Temperature Range—Operating: -45°C~+105°C

**Material and Plating**  
 Housing: PBT+30%GF( UL 94V-0)  
 Contact Pin: Brass  
 Plating: Selective gold in contact area, tin on tail  
 Shell: SPCC/ Nickel plated  
 Board lock: SPCC/ Tin plated  
 Screws: Copper alloy/ Nickel plated

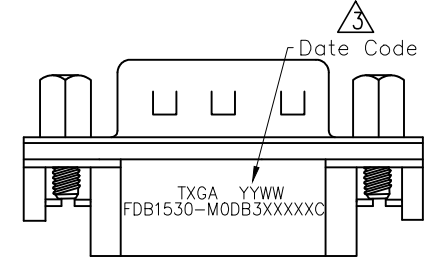
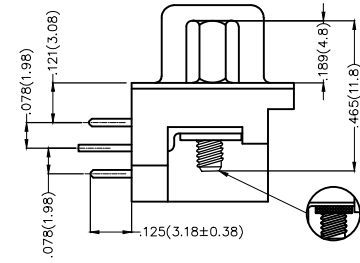
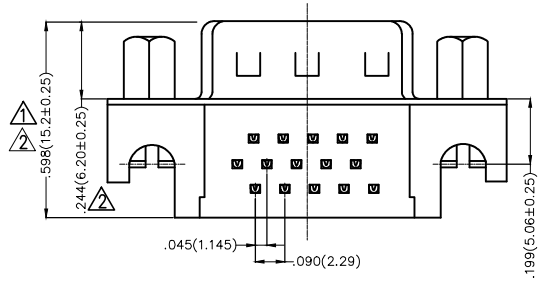

**Ordering Information**

FDB 15 30 — M0 D B 3 XX XX X C  
 1 2 3 4 5 6 7 8 9 10 11

1	Category FDB-D-SUB Connectors	2	Circuits 15-15Circuits	3	Distinction No. 30	4	Type M0-Male	5	Assembly Layout D-DIP	6	Entry Angle B-90° Angle
7	Plating 3-Selective gold in contact area, tin on tail	8	Thickness of Plating 00-Gold Flash 03-3μ" Custom plate available	9	Color-Resin K6-Black U1-Blue	10	Packaging L-Tube K-Tray	11	Distinction Type C-C Type		

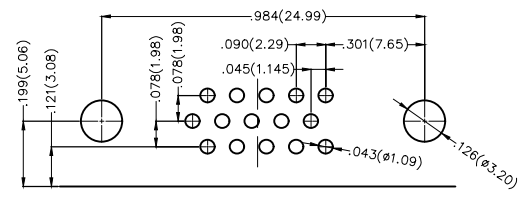

Recommended P.C.Board Layout

THIRD ANGLE PROJECTION	GENERAL TOLERANCES (UNLESS SPECIFIED)		APPROVE BY FRANK	DATE 25/JUN/13	PART NO. FDB1530-MODB3XXXXXC	ITEM NO. FDB1530	 Building Technology Cornerstone	
	DESIGN UNITS Inch (metric)	X.±.012(0.30) X.X±.008(0.20) X.XX±.006(0.15) X.XXX±.004(0.10)	X.±5' .X'±2' .XX'±1" .XXX'±0.5'	CHECKED BY JACOB	DATE 25/JUN/13	TITLE D-SUB Connectors 15 Circuits 90° Angl Male		REV 3
SCALE 5:1	SIZE A4	DRAWN BY CHERRY		DATE 25/JUN/13	THIS DRAWING CONTAINS INFORMATION THAT IS PROPRIETARY TO TXGA INDUSTRIAL ELECTRONICS(S.Z)CO.,LTD AND SHOULD NOT BE USED WITHOUT WRITTEN PERMISSION			

REV	LOCATIONS	DESCRIPTION	DATE	REVISER	APPD
1		Size change	23/JUN/20	KATE	CHERRY
2		Correct dimensions	24/MAY/24	MATT	CHERRY
3		Add marking code	13/Jan/25	NICK	LEO

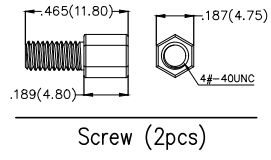
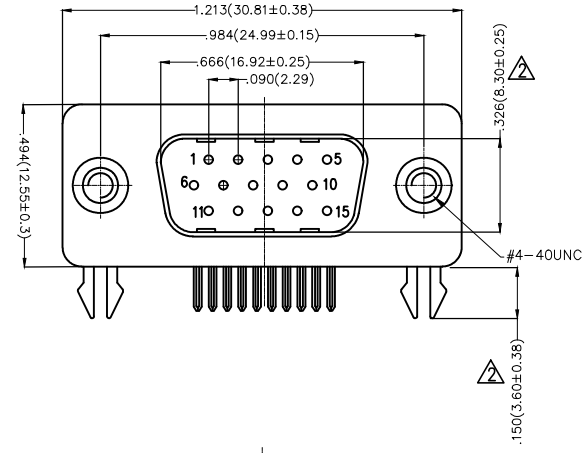

**Electrical**  
 Current Rating: 3A AC(rms)/DC  
 Voltage Rating: 250V AC(rms)/DC  
 Contact Resistance: 25 mΩ Max  
 Insulation Resistance: 1000 MΩ MIN  
 Withstanding Voltage: 500V AC r.m.s  
 Temperature Range—Operating: -45°C~+105°C

**Material and Plating**  
 Housing: PBT+30%GF( UL 94V-0)  
 Contact Pin: Brass  
 Plating: Selective gold in contact area, tin on tail  
 Shell: SPCC/ Nickel plated  
 Board lock: SPCC/ Tin plated  
 Screws: Copper alloy/ Nickel plated

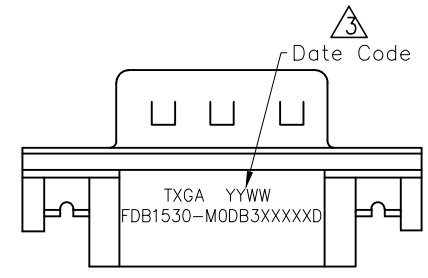
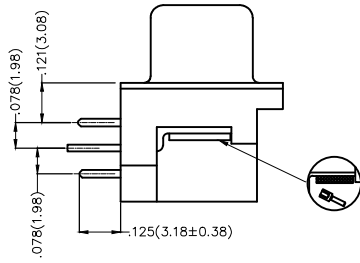
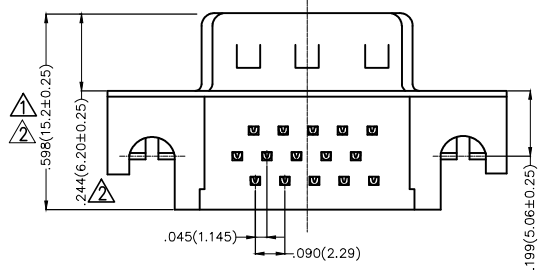

**Ordering Information**

FDB 15 30 — M0 D B 3 XX XX X D  
 1 2 3 4 5 6 7 8 9 10 11

1	Category FDB-D-SUB Connectors	2	Circuits 15-15Circuits	3	Distinction No. 30	4	Type M0-Male	5	Assembly Layout D-DIP	6	Entry Angle B-90° Angle
7	Plating 3-Selective gold in contact area, tin on tail	8	Thickness of Plating 00-Gold Flash 03-3μ" Custom plate available	9	Color-Resin K6-Black U1-Blue	10	Packaging L-Tube K-Tray	11	Distinction Type D-D Type		

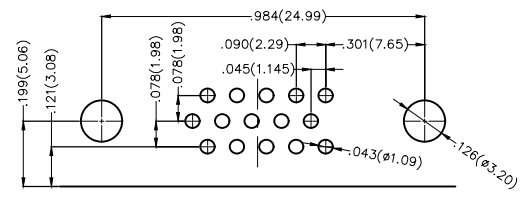

Recommended P.C.Board Layout

THIRD ANGLE PROJECTION	GENERAL TOLERANCES (UNLESS SPECIFIED)		APPROVE BY FRANK	DATE 25/JUN/13	PART NO. FDB1530-MODB3XXXXXD	ITEM NO. FDB1530	 Building Technology Cornerstone	
	DESIGN UNITS Inch (metric)	X.±.012(0.30) X.X±.008(0.20) X.XX±.006(0.15) X.XXX±.004(0.10)	X.±5' .X'±2' .XX'±1" .XXX'±0.5'	CHECKED BY JACOB	DATE 25/JUN/13	TITLE D-SUB Connectors 15 Circuits 90° Angl Male		
SCALE 5:1	SIZE A4		DRAWN BY CHERRY	DATE 25/JUN/13	THIS DRAWING CONTAINS INFORMATION THAT IS PROPRIETARY TO TXGA INDUSTRIAL ELECTRONICS(S.Z)CO.,LTD AND SHOULD NOT BE USED WITHOUT WRITTEN PERMISSION		REV 3	SHEET NO. 1/1