

REV	LOCATIONS	DESCRIPTION	DATE	REVISER	APPD
1	△	Size & structure changes	14/DEC/21	MATT	CHERRY
2	△	Add marking code	13/Jan/25	NICK	LEO

**SPECIFICATIONS**

**Electrical**  
 Current Rating: 3A AC(rms)/DC  
 Voltage Rating: 250V AC(rms)/DC  
 Contact Resistance: 25 mΩ Max  
 Insulation Resistance: 1000 MΩ Min  
 Withstanding Voltage: 500V AC r.m.s  
 Temperature Range—Operating: -55°C~+105°C

**Material and plating**  
 Housing: PBT UL 94V-0  
 Contact: Copper Alloy/  
 Selective gold in contact area, tin on tail  
 Shell: SPCC/ Nickel Plated  
 Board Lock: Copper Alloy/ Tin Plated  
 Screws: Copper Alloy/ Nickel Plated

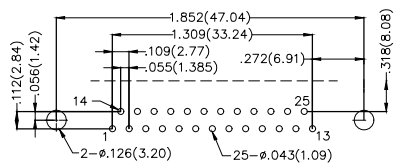
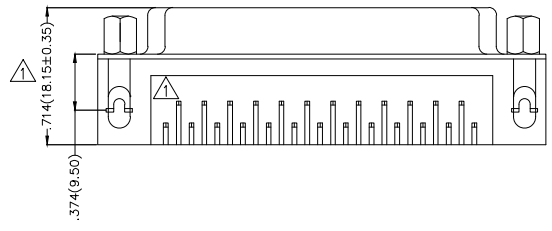
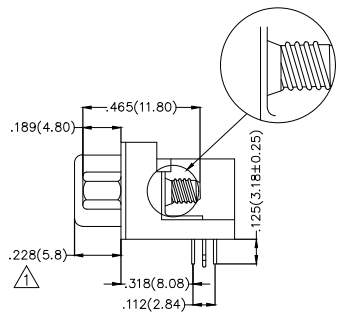
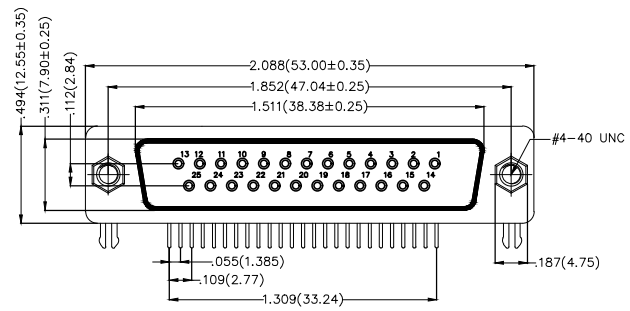
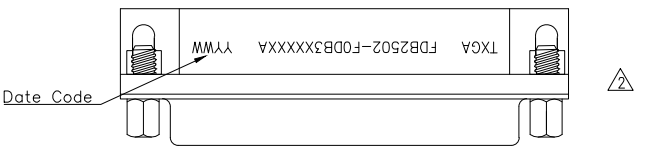

Recommended P.C.Board Layout

**Ordering Information**

FDB 25 02 — F0 D B 3 XX XX X A  
 1 2 3 4 5 6 7 8 9 10 11

1   Category FDB- D-SUB Connector	2   Circuits 25-25 Circuits	3   Distinction No. 02	4   Type F0-Female	5   Assembly Layout D-DIP	6   Entry Angle B-90° Angle
7   Plating 3-Selective gold in contact area, tin on tail	8   Thickness of Plating 00-Gold Flash 03-3μ" Custom Plate Available	9   Color-Resin K6-Black U1-Blue	10   Packaging K-Tray L-Tube	11   Distinction Type A-A Type	

THIRD ANGLE PROJECTION		GENERAL TOLERANCES (UNLESS SPECIFIED)		APPROVE BY	DATE	PART NO.	ITEM NO.	
DESIGN UNITS	SCALE	X.±.012(0.30)	X.±5'	FRANK	28/JUN/13	FDB2502-F0DB3XXXXXA	FDB2502	
Inch (metric)	5:1	X.X±.008(0.20)	.X'±2'	CHECKED BY	DATE	TITLE		
	A4	X.XX±.006(0.15)	.XX'±1'	JACOB	28/JUN/13	D-SUB connector 25 Circuits 90° Angle Female		REV 2 SHEET NO. 1/1
		X.XXX±.004(0.10)	.XXX'±0.5'	DRAWN BY	DATE	THIS DRAWING CONTAINS INFORMATION THAT IS PROPRIETARY TO TXGA INDUSTRIAL ELECTRONICS(S.Z)CO.,LTD AND SHOULD NOT BE USED WITHOUT WRITTEN PERMISSION		
				CHERRY	28/JUN/13			

REV	LOCATIONS	DESCRIPTION	DATE	REVISED	APPD
1	△	Size & structure changes	22/MAR/22	MATT	CHERRY
2	△	Add marking code	13/Jan/25	NICK	LEO

SPECIFICATIONS

Electrical

Current Rating: 3A AC(rms)/DC  
Voltage Rating: 250V AC(rms)/DC  
Contact Resistance: 25 mΩ Max  
Insulation Resistance: 1000 MΩ Min  
Withstanding Voltage: 500V AC r.m.s  
Temperature Range—Operating: -55°C~+105°C

Material and plating

Housing: PBT UL 94V-0  
Contact: Copper Alloy/  
Selective gold in contact area, tin on tail  
Shell: SPCC/ Nickel Plated  
Board Lock: Copper Alloy/ Tin Plated

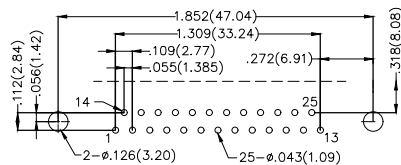
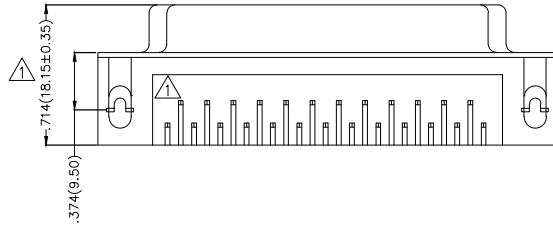
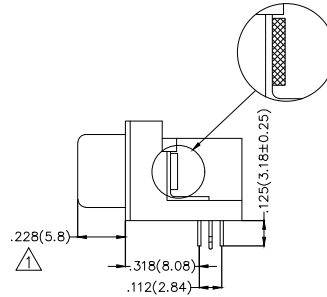
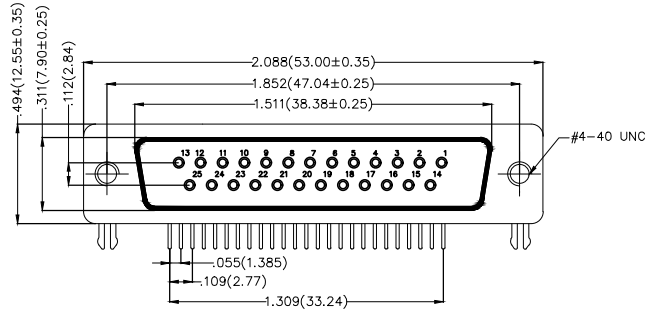
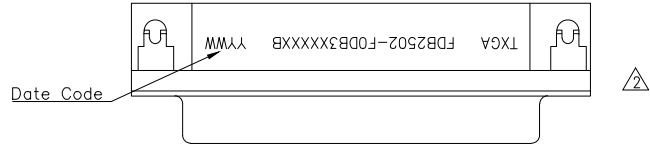

Recommended P.C.Board Layout

Ordering Information

FDB 25 02 - F0 D B 3 XX XX X B  
1 2 3 4 5 6 7 8 9 10 11

1 Category FDB- D-SUB Connector	2 Circuits 25-25 Circuits	3 Distinction No. 02	4 Type F0-Female	5 Assembly Layout D-DIP	6 Entry Angle B-90° Angle
7 Plating 3-Selective gold in contact area, tin on tail	8 Thickness of Plating 00-Gold Flash 03-3μ" Custom Plate Available	9 Color-Resin K6-Black U1-Blue	10 Packaging K-Tray L-Tube	11 Distinction Type B-B Type	

<p>THIRD ANGLE PROJECTION</p>	GENERAL TOLERANCES (UNLESS SPECIFIED)		APPROVE BY FRANK	DATE 28/JUN/13	PART NO. FDB2502-F0DB3XXXXXB	ITEM NO. FDB2502	<p>Building Technology Cornerstone</p>
	DESIGN UNITS Inch (metric)	X.±.012(0.30)	X.±5'	CHECKED BY JACOB	DATE 28/JUN/13	TITLE D-SUB connector 25 Circuits 90° Angle Female	
SCALE 5:1	SIZE A4	X.XX±.006(0.15)	.XX±1'	DRAWN BY CHERRY	DATE 28/JUN/13	THIS DRAWING CONTAINS INFORMATION THAT IS PROPRIETARY TO TXGA INDUSTRIAL ELECTRONICS(S.Z)CO.,LTD AND SHOULD NOT BE USED WITHOUT WRITTEN PERMISSION	
		X.XXX±.004(0.10)	.XXX±0.5'			REV 2	SHEET NO. 1/1

REV	LOCATIONS	DESCRIPTION	DATE	REVISED	APPD
1		Size & structure changes	22/MAR/22	MATT	CHERRY
2		Add marking code	13/Jan/25	NICK	LEO

SPECIFICATIONS

Electrical

Current Rating: 3A AC(rms)/DC  
Voltage Rating: 250V AC(rms)/DC  
Contact Resistance: 25 mΩ Max  
Insulation Resistance: 1000 MΩ Min  
Withstanding Voltage: 500V AC r.m.s  
Temperature Range-Operating: -55°C~+105°C

Material and plating

Housing: PBT UL 94V-0  
Contact: Copper Alloy/  
Selective gold in contact area, tin on tail  
Shell: SPCC/ Nickel Plated  
Board Lock: Copper Alloy/ Tin Plated  
Screws: Copper Alloy/ Nickel Plated

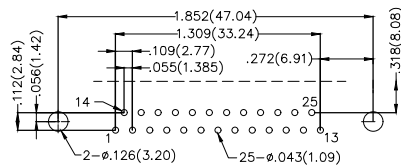
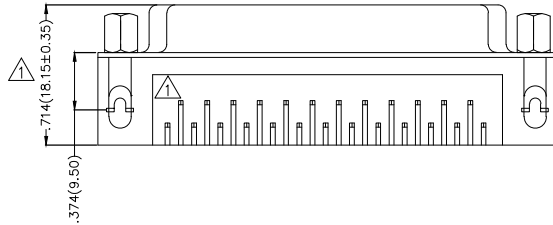
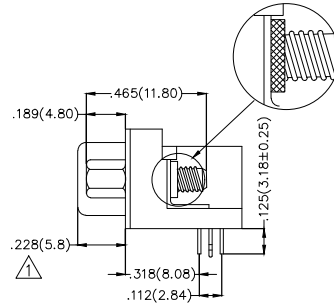
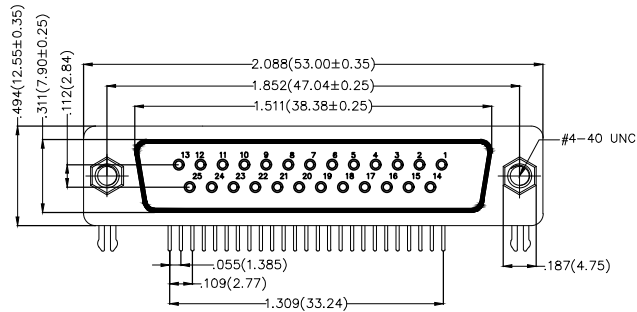
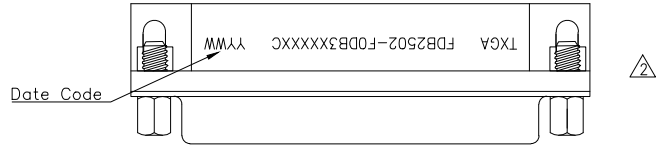

Recommended P.C.Board Layout

Ordering Information

FDB 25 02 - F0 D B 3 XX XX X C  
1 2 3 4 5 6 7 8 9 10 11

1 Category FDB- D-SUB Connector	2 Circuits 25-25 Circuits	3 Distinction No. 02	4 Type F0-Female	5 Assembly Layout D-DIP	6 Entry Angle B-90° Angle
7 Plating 3-Selective gold in contact area, tin on tail	8 Thickness of Plating 00-Gold Flash 03-3μ" Custom Plate Available	9 Color-Resin K6-Black U1-Blue	10 Packaging K-Tray L-Tube	11 Distinction Type C-C Type	

 <b>THIRD ANGLE PROJECTION</b>	<b>GENERAL TOLERANCES (UNLESS SPECIFIED)</b> X.±.012(0.30) X.±5' X.X±.008(0.20) .X'±2' X.XX±.006(0.15) .XX'±1" X.XXX±.004(0.10) .XXX'±0.5"		<b>APPROVE BY</b> FRANK <b>DATE</b> 28/JUN/13	<b>PART NO.</b> FDB2502-F0DB3XXXXXC	<b>ITEM NO.</b> FDB2502	 Building Technology Cornerstone
	<b>DESIGN UNITS</b> Inch (metric)	<b>SCALE</b> 5:1	<b>CHECKED BY</b> JACOB <b>DATE</b> 28/JUN/13	<b>TITLE</b> D-SUB connector 25 Circuits 90° Angle Female	<b>REV</b> 2	
<b>DRAWN BY</b> CHERRY <b>DATE</b> 28/JUN/13				THIS DRAWING CONTAINS INFORMATION THAT IS PROPRIETARY TO TXGA INDUSTRIAL ELECTRONICS(S.Z)CO.,LTD AND SHOULD NOT BE USED WITHOUT WRITTEN PERMISSION		

REV	LOCATIONS	DESCRIPTION	DATE	REVISER	APPD
1		Size & structure changes	22/MAR/22	MATT	CHERRY
2		Add marking code	13/Jan/25	NICK	LEO

SPECIFICATIONS

Electrical

Current Rating: 3A AC(rms)/DC  
Voltage Rating: 250V AC(rms)/DC  
Contact Resistance: 25 mΩ Max  
Insulation Resistance: 1000 MΩ Min  
Withstanding Voltage: 500V AC r.m.s  
Temperature Range-Operating: -55°C~+105°C

Material and plating

Housing: PBT UL 94V-0  
Contact: Copper Alloy/  
Selective gold in contact area, tin on tail  
Shell: SPCC/ Nickel Plated  
Board Lock: Copper Alloy/ Tin Plated  
Screws: Copper Alloy/ Nickel Plated

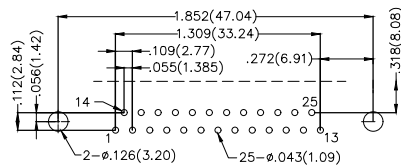
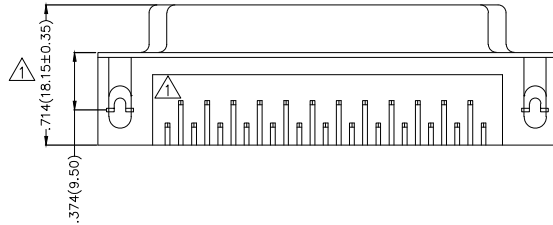
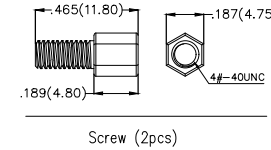
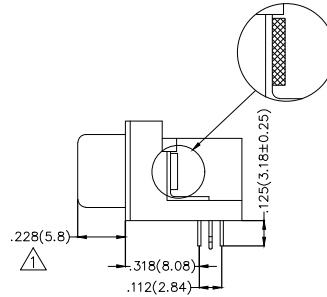
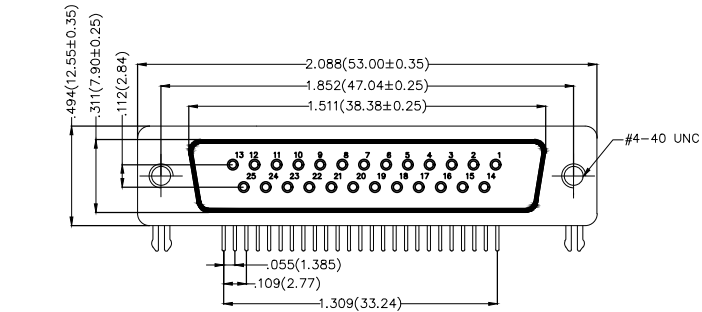
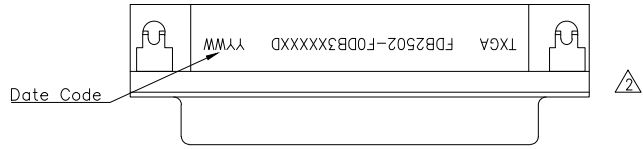

Recommended P.C.Board Layout

Ordering Information

FDB 25 02 - F0 D B 3 XX XX X D  
1 2 3 4 5 6 7 8 9 10 11

1 Category FDB- D-SUB Connector	2 Circuits 25-25 Circuits	3 Distinction No. 02	4 Type F0-Female	5 Assembly Layout D-DIP	6 Entry Angle B-90° Angle
7 Plating 3-Selective gold in contact area, tin on tail	8 Thickness of Plating 00-Gold Flash 03-3μ" Custom Plate Available	9 Color-Resin K6-Black U1-Blue	10 Packaging K-Tray L-Tube	11 Distinction Type D-D Type	

	GENERAL TOLERANCES (UNLESS SPECIFIED)		APPROVE BY FRANK	DATE 28/JUN/13	PART NO. FDB2502-F0DB3XXXXXD	ITEM NO. FDB2502		
	DESIGN UNITS Inch (metric)	X.±.012(0.30) X.X±.008(0.20) X.XX±.006(0.15) X.XXX±.004(0.10)	X.±5" .X±2" .XX±1" .XXX±0.5"	CHECKED BY JACOB	DATE 28/JUN/13	TITLE D-SUB connector 25 Circuits 90° Angle Female		Building Technology Cornerstone
SCALE 5:1	SIZE A4		DRAWN BY CHERRY	DATE 28/JUN/13	THIS DRAWING CONTAINS INFORMATION THAT IS PROPRIETARY TO TXGA INDUSTRIAL ELECTRONICS(S.Z)CO.,LTD AND SHOULD NOT BE USED WITHOUT WRITTEN PERMISSION		REV 2	SHEET NO. 1/1

REV	LOCATIONS	DESCRIPTION	DATE	REVISED	APPD
1		Size & structure changes	22/MAR/22	MATT	CHERRY
2		Add marking code	13/Jan/25	NICK	LEO

SPECIFICATIONS

Electrical

Current Rating: 3A AC(rms)/DC  
Voltage Rating: 250V AC(rms)/DC  
Contact Resistance: 25 mΩ Max  
Insulation Resistance: 1000 MΩ Min  
Withstanding Voltage: 500V AC r.m.s  
Temperature Range-Operating: -55°C~+105°C

Material and plating

Housing: PBT UL 94V-0  
Contact: Copper Alloy/  
Selective gold in contact area, tin on tail  
Shell: SPCC/ Nickel Plated  
Board Lock: Copper Alloy/ Tin Plated  
Screws: Copper Alloy/ Nickel Plated

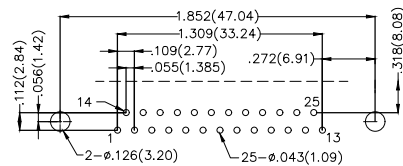
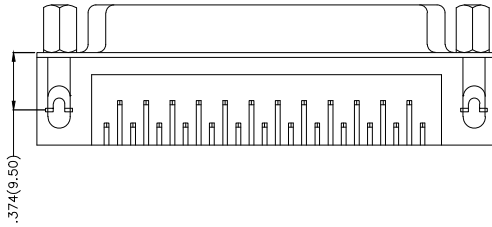
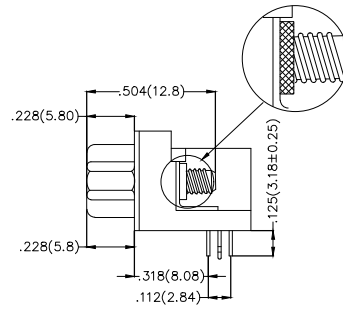
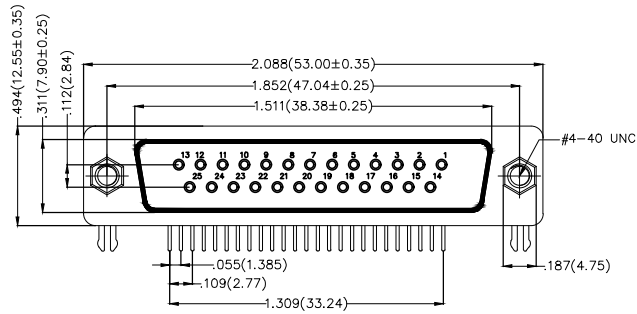
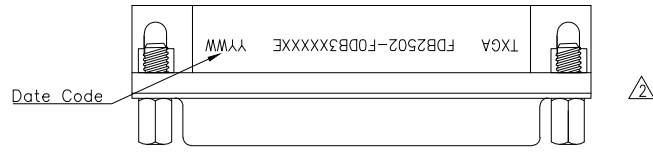

Recommended P.C.Board Layout

Ordering Information

FDB 25 02 - F0 D B 3 XX XX X E  
1 2 3 4 5 6 7 8 9 10 11

1 Category FDB- D-SUB Connector	2 Circuits 25-25 Circuits	3 Distinction No. 02	4 Type F0-Female	5 Assembly Layout D-DIP	6 Entry Angle B-90° Angle
7 Plating 3-Selective gold in contact area, tin on tail	8 Thickness of Plating 00-Gold Flash 03-3μ" Custom Plate Available	9 Color-Resin K6-Black U1-Blue	10 Packaging K-Tray L-Tube	11 Distinction Type E-E Type	

	GENERAL TOLERANCES (UNLESS SPECIFIED)		APPROVE BY FRANK	DATE 28/JUN/13	PART NO. FDB2502-F0DB3XXXXXE	ITEM NO. FDB2502		
	DESIGN UNITS Inch (metric)	X.±.012(0.30) X.X±.008(0.20) X.XX±.006(0.15) X.XXX±.004(0.10)	X.±5° .X'±2° .XX'±1° .XXX'±0.5°	CHECKED BY JACOB	DATE 28/JUN/13	TITLE D-SUB connector 25 Circuits 90° Angle Female		Building Technology Cornerstone
SCALE 5:1	SIZE A4		DRAWN BY CHERRY	DATE 28/JUN/13	THIS DRAWING CONTAINS INFORMATION THAT IS PROPRIETARY TO TXGA INDUSTRIAL ELECTRONICS(S.Z)CO.,LTD AND SHOULD NOT BE USED WITHOUT WRITTEN PERMISSION		REV 2	SHEET NO. 1/1

REV	LOCATIONS	DESCRIPTION	DATE	REVISED	APPD
1	△	Add marking code	13/Jan/25	NICK	LEO

SPECIFICATIONS

Electrical

Current Rating: 3A AC(rms)/DC  
Voltage Rating: 250V AC(rms)/DC  
Contact Resistance: 25 mΩ Max  
Insulation Resistance: 1000 MΩ Min  
Withstanding Voltage: 500V AC r.m.s  
Temperature Range-Operating: -55°C~+105°C

Material and plating

Housing: PBT UL 94V-0  
Contact: Copper Alloy/  
Selective gold in contact area, tin on tail  
Shell: SPCC/ Nickel Plated  
Board Lock: Copper Alloy/ Tin Plated  
Screws: Copper Alloy/ Nickel Plated

Ordering Information

FDB 25 02 - F0 D B 3 XX XX X F  
1 2 3 4 5 6 7 8 9 10 11

1 Category FDB- D-SUB Connector	2 Circuits 25-25 Circuits	3 Distinction No. 02	4 Type F0-Female	5 Assembly Layout D-DIP	6 Entry Angle B-90° Angle
7 Plating 3-Selective gold in contact area, tin on tail	8 Thickness of Plating 00-Gold Flash 03-3μ" Custom Plate Available	9 Color-Resin K6-Black U1-Blue	10 Packaging K-Tray L-Tube	11 Distinction Type F-F Type	

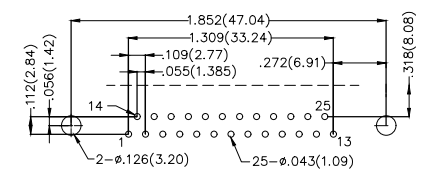
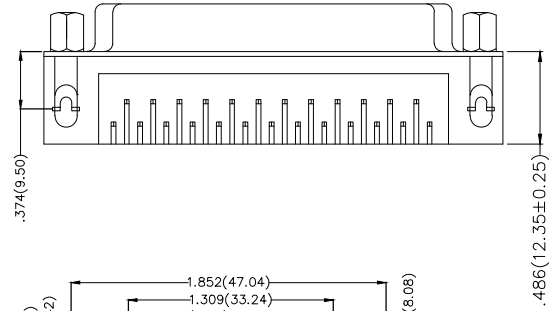
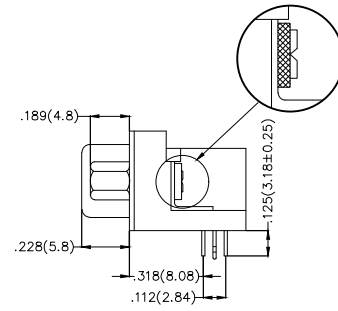
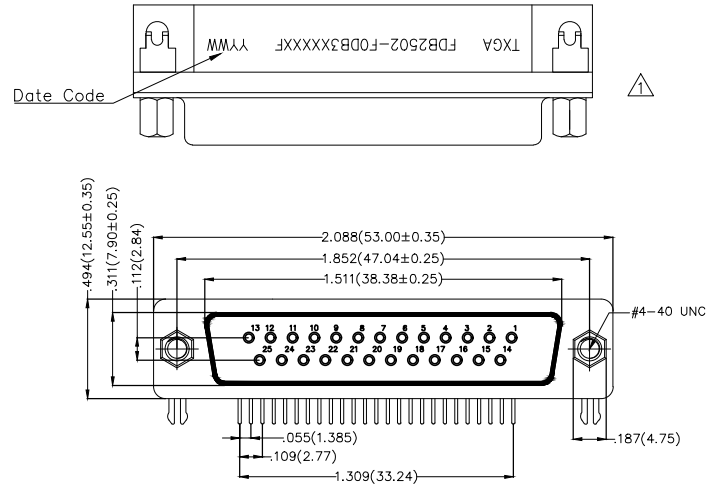

Recommended P.C.Board Layout

<p>THIRD ANGLE PROJECTION</p>	GENERAL TOLERANCES (UNLESS SPECIFIED)		APPROVE BY LEO	DATE 30/OCT/23	PART NO. FDB2502-F0DB3XXXXXF	ITEM NO. FDB2502	<p>Building Technology Cornerstone</p>			
	DESIGN UNITS Inch (metric)	X.±.012(0.30) X.X±.008(0.20) X.XX±.006(0.15) X.XXX±.004(0.10)	X.±5' .X'±2' .XX'±1' .XXX'±0.5'	CHECKED BY GISELLE	DATE 30/OCT/23	TITLE D-SUB connector 25 Circuits 90° Angle Female		REV 1	SHEET NO. 1/1	
	SCALE 5:1	SIZE A4		DRAWN BY MATT	DATE 30/OCT/23	THIS DRAWING CONTAINS INFORMATION THAT IS PROPRIETARY TO TXGA INDUSTRIAL ELECTRONICS(S.Z)CO.,LTD AND SHOULD NOT BE USED WITHOUT WRITTEN PERMISSION				

REV	LOCATIONS	DESCRIPTION	DATE	REVISER	APPD
1	△	Change screw material	12/May/25	NICK	LEO

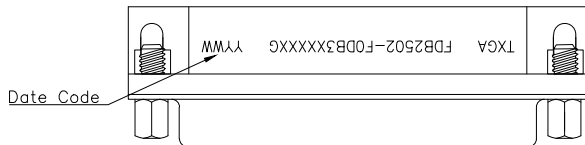

SPECIFICATIONS

Electrical  
 Current Rating: 3A AC(rms)/DC  
 Voltage Rating: 250V AC(rms)/DC  
 Contact Resistance: 25 mΩ Max  
 Insulation Resistance: 1000 MΩ Min  
 Withstanding Voltage: 500V AC r.m.s  
 Temperature Range-Operating: -55°C~+105°C

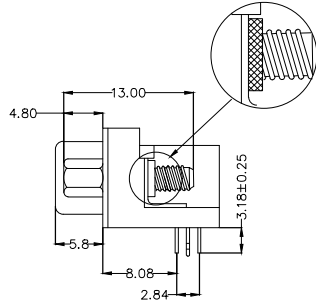
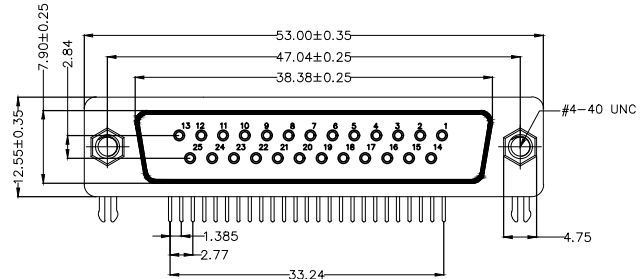

Material and plating  
 Housing: PBT UL 94V-0  
 Contact: Copper Alloy/  
 Selective gold in contact area, tin on tail  
 Shell: SPCC/ Nickel Plated  
 Board Lock: Copper Alloy/ Tin Plated  
 △ Screws: Carbon steel/ Nickel Plated

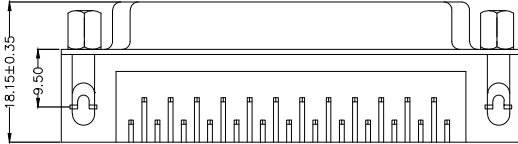

Ordering Information

FDB 25 02 - F0 D B 3 XX XX X G  
 1 2 3 4 5 6 7 8 9 10 11

1 Category FDB- D-SUB Connector	2 Circuits 25-25 Circuits	3 Distinction No. 02	4 Type FO-Female	5 Assembly Layout D-DIP	6 Entry Angle B-90° Angle
7 Plating 3-Selective gold in contact area, tin on tail	8 Thickness of Plating 00-Gold Flash 03-3μ" Custom Plate Available	9 Color-Resin K6-Black U1-Blue	10 Packaging K-Tray L-Tube	11 Distinction Type G-G Type	

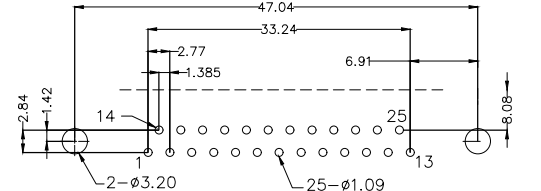

Recommended P.C.Board Layout

THIRD ANGLE PROJECTION	GENERAL TOLERANCES (UNLESS SPECIFIED)		APPROVE BY LEO	DATE 02/AUG/23	PART NO. FDB2502-F0DB3XXXXXG	ITEM NO. FDB2502	 Building Technology Cornerstone
	X. ±0.30	X.* ±5°	CHECKED BY GISELLE	DATE 02/AUG/23	TITLE D-SUB Connectors 25 Circuits 90° Angle Female		
DESIGN UNITS METRIC	X.X ±0.20	X.X* ±2°	DRAWN BY NICK	DATE 02/AUG/23	THIS DRAWING CONTAINS INFORMATION THAT IS PROPRIETARY TO TXGA INDUSTRIAL ELECTRONICS(S.Z)CO.,LTD AND SHOULD NOT BE USED WITHOUT WRITTEN PERMISSION		
SCALE 5:1	SIZE A4	X.XX ±0.15	X.XX* ±1°				
		X.XXX ±0.10	X.XXX* ±0.5°				