

1 2 3 4 5 6 7 8

REV	LOCATIONS	DESCRIPTION	DATE	REVISER	APPD
1	△	Size change	28/JUN/20	KATE	CHERRY
2	△	Add marking code	13/Jan/25	NICK	LEO

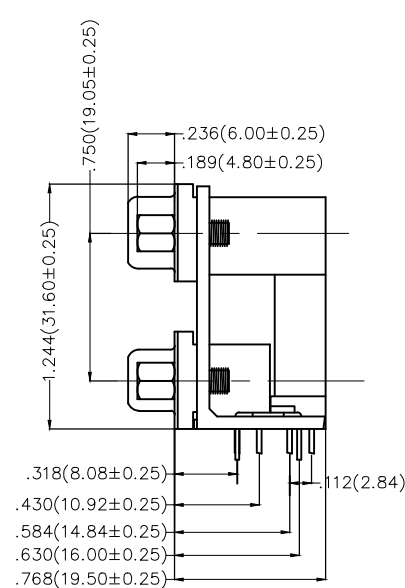
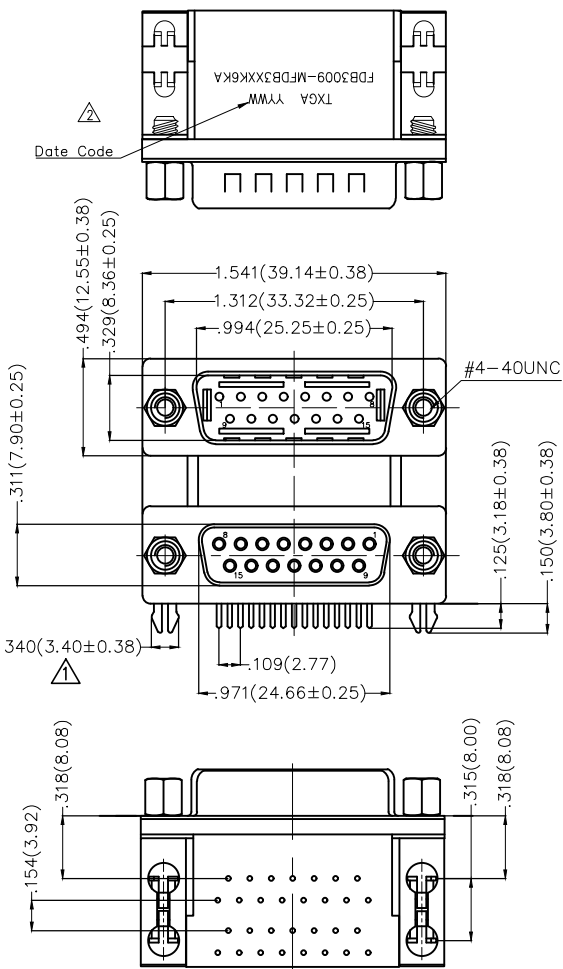

SPECIFICATIONS

Electrical
 Current Rating: 1.0A AC(rms)/DC
 Voltage Rating: 300V AC(rms)/DC
 Contact Resistance: 20 mΩ Max
 Insulation Resistance: 5000 MΩ MIN
 Withstanding Voltage: 100V AC r.m.s
 Temperature Range—Operating: -55°C~+85°C

Material and Finish
 Housing: PBT+30% (UL 94V-0)
 Contact: Copper Alloy
 Plating: Selective gold in contact area, tin on tail
 Shell: Steel/Nickel Plated
 Board Lock: Brass/Tin Plated
 Screws: Copper Alloy/Nickel Plated

Ordering Information

FDB 30 09 — MF D B 3 XX K6 K A
 1 2 3 4 5 6 7 8 9 10 11

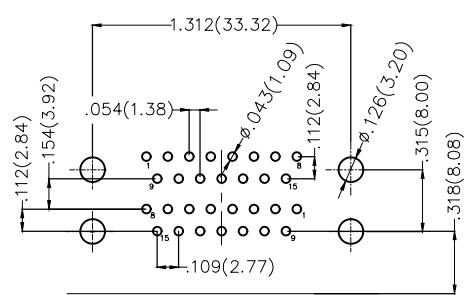

Recommended P.C.Board Layout

1	Category FDB-D-SUB Connectors	2	Circuits 30	3	Distinction No. 09	4	Type MF-Male+Female	5	Assembly Layout D-DIP	6	Entry Angle B-90° Angle
7	Plating 3-Selective gold in contact area, tin on tail	8	Thickness of Plating 00-Gold Flash 03-3μ Custom plate available	9	Color-Resin K6-Black	10	Packaging K-Tray	11	Distinction Type A-A Type		

 THIRD ANGLE PROJECTION	GENERAL TOLERANCES (UNLESS SPECIFIED)		APPROVE BY FRANK	DATE 11/DEC/19	PART NO. FDB3009-MFDB3XXK6KA	ITEM NO. FDB3009	 Leader Of Industry
	DESIGN UNITS Inch (metric)	X.±.012(0.30) X.X±.008(0.20)	X.±5° .X'±2'	CHECKED BY CHERRY	DATE 11/DEC/19	TITLE D-SUB Connectors 15+15Circuits 90° Angle	
SCALE 5:1	SIZE A4	X.XX±.006(0.15) X.XXX±.004(0.10)	.XX'±1° .XXX'±0.5°	DRAWN BY ZOEY	DATE 11/DEC/19	THIS DRAWING CONTAINS INFORMATION THAT IS PROPRIETARY TO TXGA INDUSTRIAL ELECTRONICS(S.Z)CO.,LTD AND SHOULD NOT BE USED WITHOUT WRITTEN PERMISSION	

REV 2 SHEET NO. 1/1

1 2 3 4 5 6 7 8