

REV	LOCATIONS	DESCRIPTION	DATE	REVISER	APPD
1	△1	Size changes	02/AUG/22	MATT	CHERRY
2	△2	New drawing and Add dimensions	14/JUN/24	MATT	LEO
3	△3	Add marking code	13/Jan/25	NICK	LEO
4	△4	Size changes	15/Aug/25	NICK	LEO

SPECIFICATIONS

Electrical

Current Rating: 3A AC(rms)/DC  
Voltage Rating: 250V AC(rms)/DC  
Contact Resistance: 25 mΩ Max  
Insulation Resistance: 1000 MΩ Min  
Withstanding Voltage: 500V AC r.m.s  
Temperature Range-Operating: -55°C~+105°C

Material and plating

Housing: PBT UL 94V-0  
Contact: Copper Alloy/  
Selective gold in contact area, tin on tail  
Shell: SPCC/ Nickel Plated

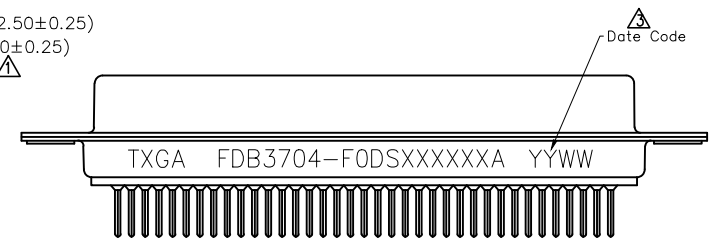
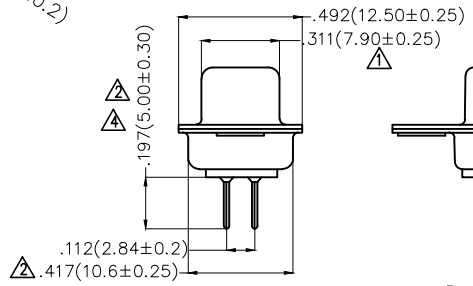
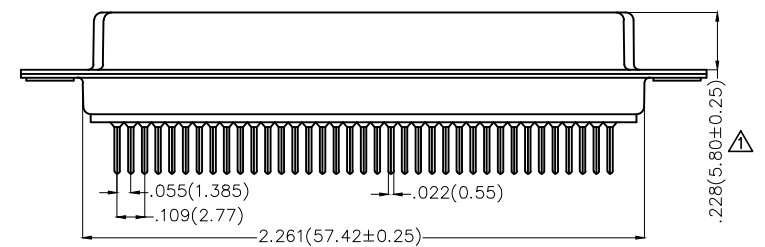
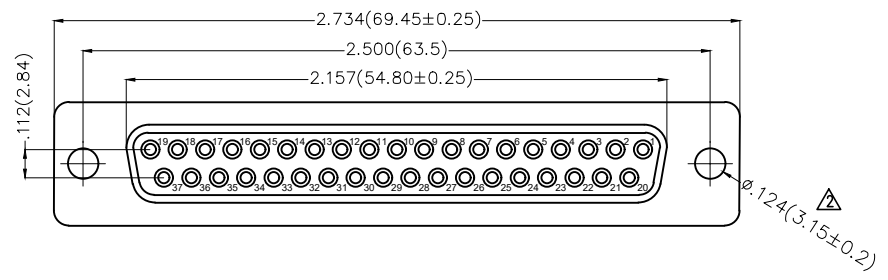

Ordering Information

FDB 37 04 — F0 D S X XX XX X A  
1 2 3 4 5 6 7 8 9 10 11

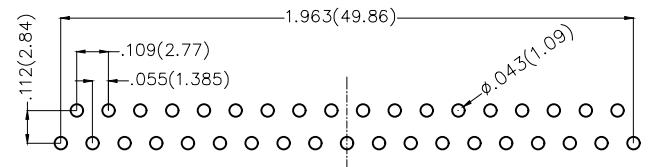

Recommended P.C.Board Layout

1	Category FDB- D-SUB Connector	2	Circuits 37-37 Circuits	3	Distinction No. 04	4	Type F0-Female	5	Assembly Layout D-DIP	6	Entry Angle S-180° Vertical
7	Plating 1-Gold Plated Plating 3-Selective gold in contact area, tin on tail	8	Thickness of Gold Plating 00-Gold Flash 03-3μ" Custom Plate Available	9	Color-Resin K6-Black U1-Blue	10	Packaging K-Tray L-Tube	11	Distinction Type A-A Type		

THIRD ANGLE PROJECTION	GENERAL TOLERANCES (UNLESS SPECIFIED)		APPROVE BY FRANK	DATE 28/JUN/13	PART NO. FDB3704-F0DSXXXXXXA	ITEM NO. FDB3704		
	DESIGN UNITS Inch (metric)	X.±.012(0.30) X.X±.008(0.20) X.XX±.006(0.15) X.XXX±.004(0.10)	X.±5' .X±2' .XX±1' .XXX±0.5'	CHECKED BY JACOB	DATE 28/JUN/13	TITLE D-SUB connector 37 Circuits 180° Vertical Female		REV 4
SCALE 5:1	SIZE A4		DRAWN BY CHERRY	DATE 28/JUN/13	THIS DRAWING CONTAINS INFORMATION THAT IS PROPRIETARY TO TXGA INDUSTRIAL ELECTRONICS(S.Z)CO.,LTD AND SHOULD NOT BE USED WITHOUT WRITTEN PERMISSION			

REV	LOCATIONS	DESCRIPTION	DATE	REVISER	APPD
1	△1	Size changes	02/AUG/22	MATT	CHERRY
2	△2	New drawing and Add dimensions	14/JUN/24	MATT	LEO
3	△3	Add marking code	13/Jan/25	NICK	LEO
4	△4	Size changes	15/Aug/25	NICK	LEO

SPECIFICATIONS

Electrical

Current Rating: 3A AC(rms)/DC  
Voltage Rating: 250V AC(rms)/DC  
Contact Resistance: 25 mΩ Max  
Insulation Resistance: 1000 MΩ Min  
Withstanding Voltage: 500V AC r.m.s  
Temperature Range-Operating: -55°C~+105°C

Material and plating

Housing: PBT UL 94V-0  
Contact: Copper Alloy/  
Selective gold in contact area, tin on tail  
Shell: SPCC/ Nickel Plated  
Nut: Copper Alloy/ Nickel Plated

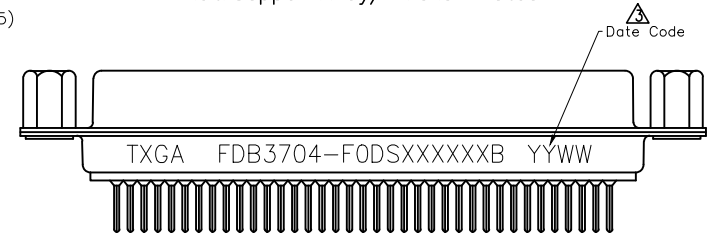
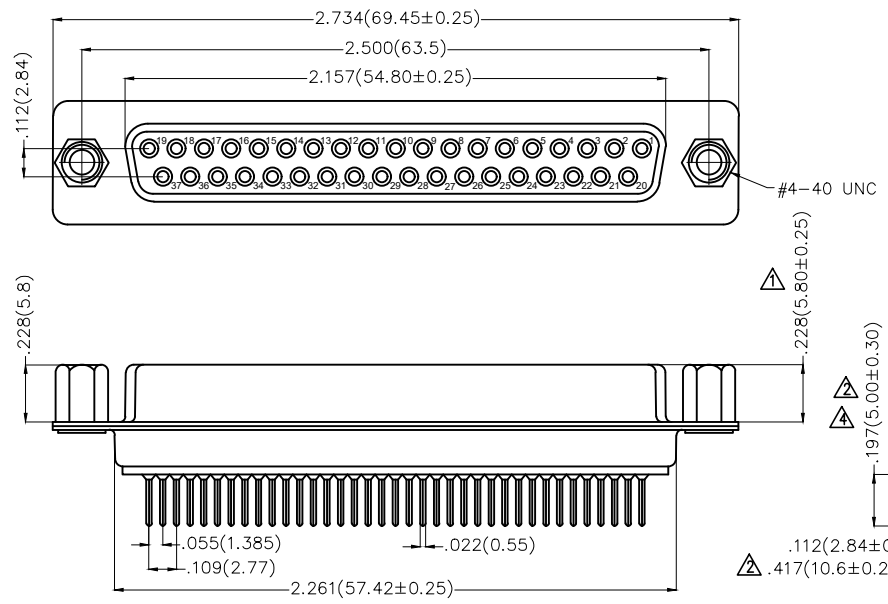

Ordering Information

FDB 37 04 — F0 D S X XX XX X B  
1 2 3 4 5 6 7 8 9 10 11

1	Category FDB- D-SUB Connector	2	Circuits 37-37 Circuits	3	Distinction No. 04	4	Type F0-Female	5	Assembly Layout D-DIP	6	Entry Angle S-180° Vertical
7	Plating 1-Gold Plated Plating 3-Selective gold in contact area, tin on tail	8	Thickness of Gold Plating 00-Gold Flash 03-3μ" Custom Plate Available	9	Color-Resin K6-Black U1-Blue	10	Packaging K-Tray L-Tube	11	Distinction Type B-B Type		

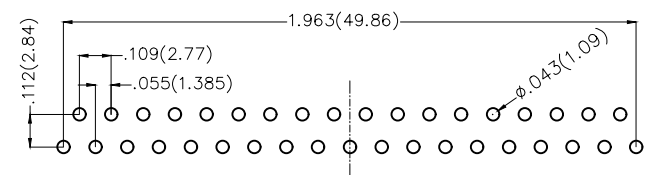

Recommended P.C.Board Layout

THIRD ANGLE PROJECTION	GENERAL TOLERANCES (UNLESS SPECIFIED)		APPROVE BY FRANK	DATE 28/JUN/13	PART NO. FDB3704-F0DSXXXXXXB	ITEM NO. FDB3704	 Building Technology Cornerstone
	DESIGN UNITS Inch (metric)	X.±.012(0.30) X.X±.008(0.20) X.XX±.006(0.15) X.XXX±.004(0.10)	X.±5' .X±2' .XX±1' .XXX±0.5'	CHECKED BY JACOB	DATE 28/JUN/13	TITLE D-SUB connector 37 Circuits 180° Vertical Female	
SCALE 5:1	SIZE A4	DRAWN BY CHERRY		DATE 28/JUN/13	THIS DRAWING CONTAINS INFORMATION THAT IS PROPRIETARY TO TXGA INDUSTRIAL ELECTRONICS(S.Z)CO.,LTD AND SHOULD NOT BE USED WITHOUT WRITTEN PERMISSION		

REV	LOCATIONS	DESCRIPTION	DATE	REVISER	APPD
1	△1	Size changes	02/AUG/22	MATT	CHERRY
2	△2	New drawing and Add dimensions	14/JUN/24	MATT	LEO
3	△3	Add marking code	13/Jan/25	NICK	LEO
4	△4	Size changes	15/Aug/25	NICK	LEO

SPECIFICATIONS

Electrical

Current Rating: 3A AC(rms)/DC  
Voltage Rating: 250V AC(rms)/DC  
Contact Resistance: 25 mΩ Max  
Insulation Resistance: 1000 MΩ Min  
Withstanding Voltage: 500V AC r.m.s  
Temperature Range-Operating: -55°C~+105°C

Material and plating

Housing: PBT UL 94V-0  
Contact: Copper Alloy/  
Selective gold in contact area, tin on tail  
Shell: SPCC/ Nickel Plated  
Nut: Copper Alloy/ Nickel Plated

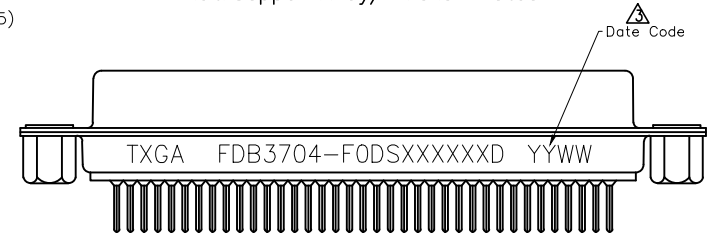
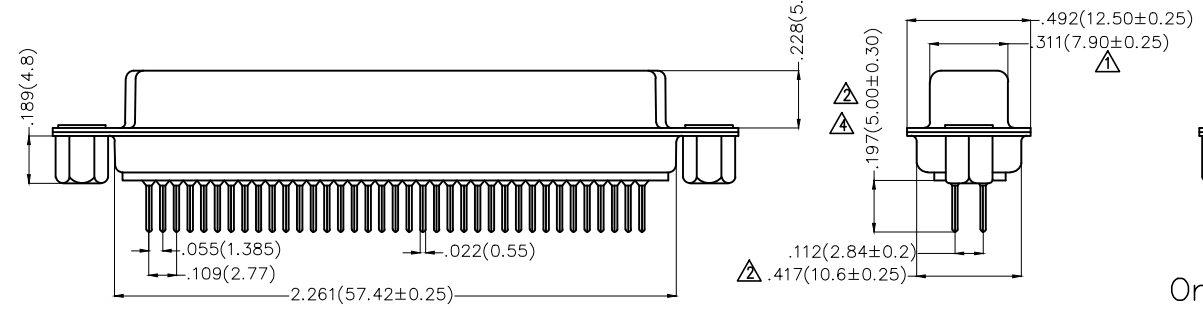
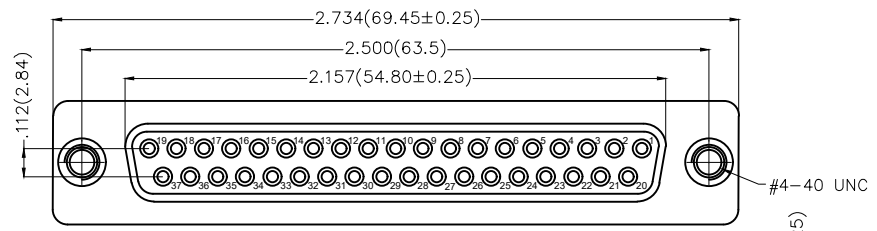

Ordering Information

FDB 37 04 — F0 D S X XX XX X D  
1 2 3 4 5 6 7 8 9 10 11

1	Category FDB- D-SUB Connector	2	Circuits 37-37 Circuits	3	Distinction No. 04	4	Type F0-Female	5	Assembly Layout D-DIP	6	Entry Angle S-180° Vertical
7	Plating 1-Gold Plated Plating 3-Selective gold in contact area, tin on tail	8	Thickness of Gold Plating 00-Gold Flash 03-3μ" Custom Plate Available	9	Color-Resin K6-Black U1-Blue	10	Packaging K-Tray L-Tube	11	Distinction Type D-D Type		

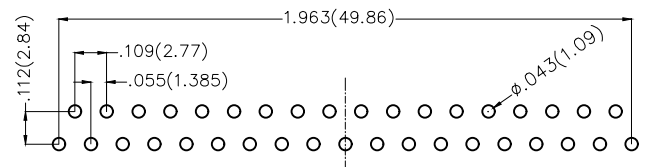

Recommended P.C.Board Layout

THIRD ANGLE PROJECTION	GENERAL TOLERANCES (UNLESS SPECIFIED)		APPROVE BY FRANK	DATE 28/JUN/13	PART NO. FDB3704-F0DSXXXXXD	ITEM NO. FDB3704		
	DESIGN UNITS Inch (metric)	X.±.012(0.30) X.X±.008(0.20) X.XX±.006(0.15) X.XXX±.004(0.10)	X.±5' .X±2' .XX±1' .XXX±0.5'	CHECKED BY JACOB	DATE 28/JUN/13	TITLE D-SUB connector 37 Circuits 180° Vertical Female		REV 4
SCALE 5:1	SIZE A4	DRAWN BY CHERRY		DATE 28/JUN/13	THIS DRAWING CONTAINS INFORMATION THAT IS PROPRIETARY TO TXGA INDUSTRIAL ELECTRONICS(S.Z)CO.,LTD AND SHOULD NOT BE USED WITHOUT WRITTEN PERMISSION			

REV	LOCATIONS	DESCRIPTION	DATE	REVISED	APPD
1	△1	Size changes	02/AUG/22	MATT	CHERRY
2	△2	New drawing and Add dimensions	14/JUN/24	MATT	LEO
3	△3	Add marking code	13/Jan/25	NICK	LEO
4	△4	Size changes	15/Aug/25	NICK	LEO

SPECIFICATIONS

Electrical

Current Rating: 3A AC(rms)/DC  
Voltage Rating: 250V AC(rms)/DC  
Contact Resistance: 25 mΩ Max  
Insulation Resistance: 1000 MΩ Min  
Withstanding Voltage: 500V AC r.m.s  
Temperature Range-Operating: -55°C~+105°C

Material and plating

Housing: PBT UL 94V-0  
Contact: Copper Alloy/  
Selective gold in contact area, tin on tail  
Shell: SPCC/ Nickel Plated  
Nut: Copper Alloy/ Nickel Plated

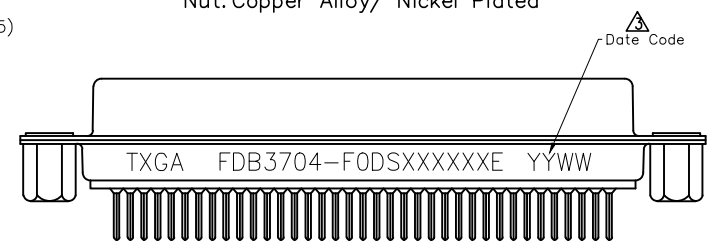
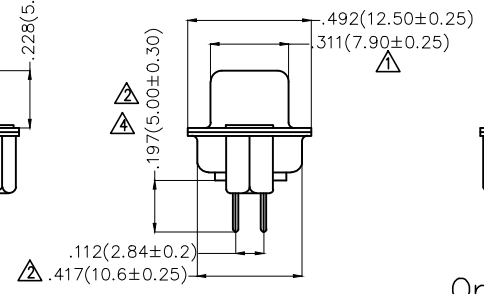
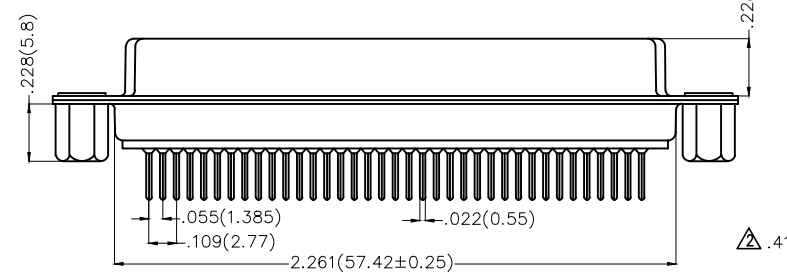
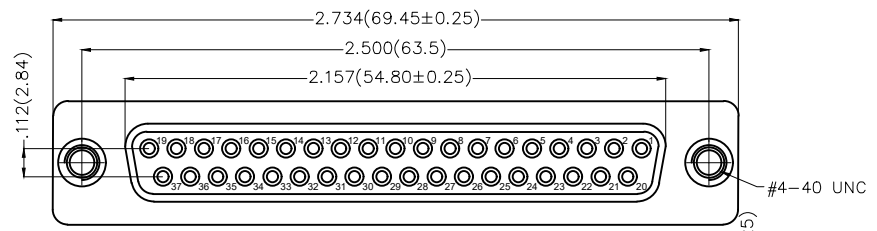

Ordering Information

FDB 37 04 — F0 D S X XX XX X E  
1 2 3 4 5 6 7 8 9 10 11

1	Category FDB- D-SUB Connector	2	Circuits 37-37 Circuits	3	Distinction No. 04	4	Type F0-Female	5	Assembly Layout D-DIP	6	Entry Angle S-180° Vertical
7	Plating 1-Gold Plated Plating 3-Selective gold in contact area, tin on tail	8	Thickness of Gold Plating 00-Gold Flash 03-3μ" Custom Plate Available	9	Color-Resin K6-Black U1-Blue	10	Packaging K-Tray L-Tube	11	Distinction Type E-E Type		

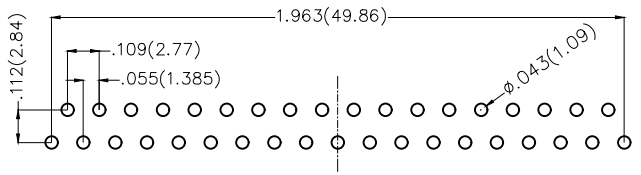

Recommended P.C.Board Layout

THIRD ANGLE PROJECTION	GENERAL TOLERANCES (UNLESS SPECIFIED)		APPROVE BY FRANK	DATE 28/JUN/13	PART NO. FDB3704-F0DSXXXXXXE	ITEM NO. FDB3704	 Building Technology Cornerstone	
	DESIGN UNITS Inch (metric)	X.±.012(0.30) X.X±.008(0.20) X.XX±.006(0.15) X.XXX±.004(0.10)	X'.±5' .X'±2' .XX'±1' .XXX'±0.5'	CHECKED BY JACOB	DATE 28/JUN/13	TITLE D-SUB connector 37 Circuits 180° Vertical Female		REV 4
SCALE 5:1	SIZE A4		DRAWN BY CHERRY	DATE 28/JUN/13	THIS DRAWING CONTAINS INFORMATION THAT IS PROPRIETARY TO TXGA INDUSTRIAL ELECTRONICS(S.Z)CO.,LTD AND SHOULD NOT BE USED WITHOUT WRITTEN PERMISSION			

REV	LOCATIONS	DESCRIPTION	DATE	REVISED	APPD
1	△1	Size changes	02/AUG/22	MATT	CHERRY
2	△2	New drawing and Add dimensions	14/JUN/24	MATT	LEO
3	△3	Add marking code	13/Jan/25	NICK	LEO
4	△4	Size changes	15/Aug/25	NICK	LEO

**SPECIFICATIONS**

Electrical  
 Current Rating: 3A AC(rms)/DC  
 Voltage Rating: 250V AC(rms)/DC  
 Contact Resistance: 25 mΩ Max  
 Insulation Resistance: 1000 MΩ Min  
 Withstanding Voltage: 500V AC r.m.s  
 Temperature Range—Operating: -55°C~+105°C

Material and plating  
 Housing: PBT UL 94V-0  
 Contact: Copper Alloy/  
 Selective gold in contact area, tin on tail  
 Shell: SPCC/ Nickel Plated  
 Screws: Copper Alloy/Nickel Plated  
 Board Lock: Copper Alloy/ Tin Plated

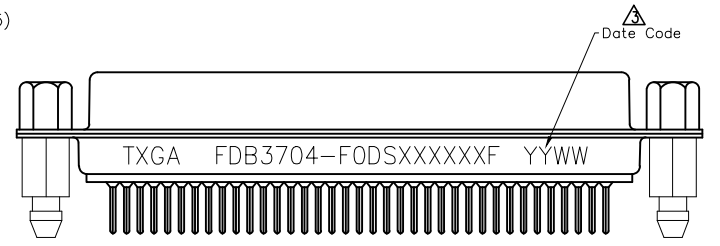
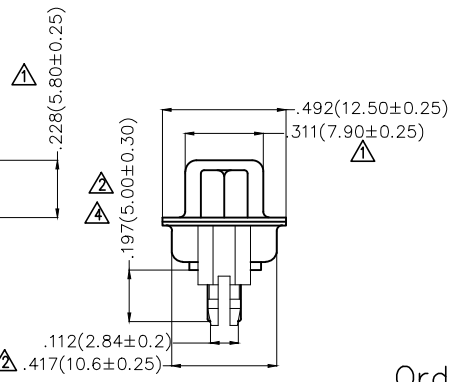
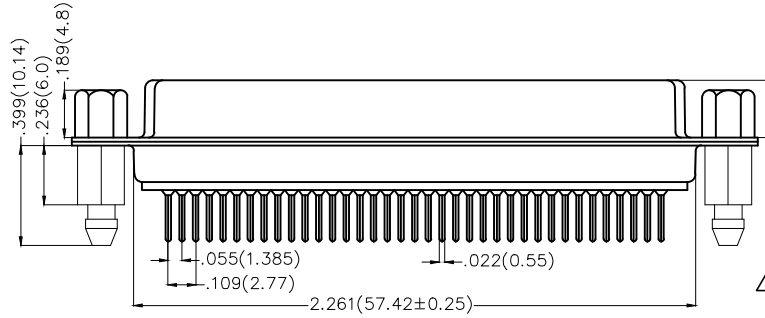
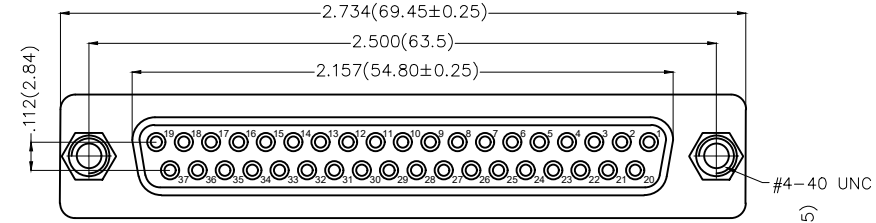

**Ordering Information**

FDB 37 04 — F0 D S X XX XX X F  
 1 2 3 4 5 6 7 8 9 10 11

1	Category FDB- D-SUB Connector	2	Circuits 37-37 Circuits	3	Distinction No. 04	4	Type F0-Female	5	Assembly Layout D-DIP	6	Entry Angle S-180° Vertical
7	Plating 1-Gold Plated Plating 3-Selective gold in contact area, tin on tail	8	Thickness of Gold Plating 00-Gold Flash 03-3μ" Custom Plate Available	9	Color-Resin K6-Black U1-Blue	10	Packaging K-Tray L-Tube	11	Distinction Type F-F Type		

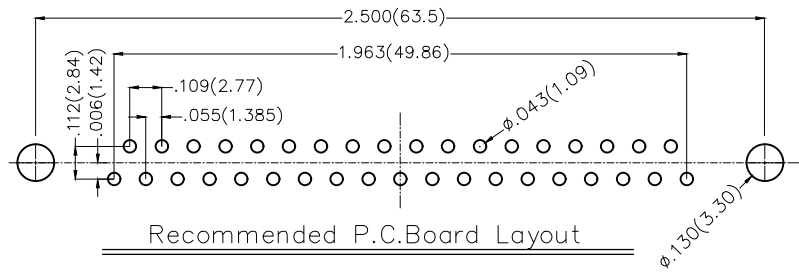

THIRD ANGLE PROJECTION		GENERAL TOLERANCES (UNLESS SPECIFIED)		APPROVE BY	DATE	PART NO.	ITEM NO.	TXGA	
		X.±.012(0.30)	X'.±5'	FRANK	28/JUN/13	FDB3704-F0DSXXXXXXF	FDB3704	Building Technology Cornerstone	
DESIGN UNITS Inch (metric)		X.X±.008(0.20)	.X'±2'	CHECKED BY	DATE	TITLE D-SUB connector 37 Circuits 180° Vertical Female		REV 4	SHEET NO. 1/1
SCALE	SIZE	X.XX±.006(0.15)	.XX'±1'	DRAWN BY	DATE	THIS DRAWING CONTAINS INFORMATION THAT IS PROPRIETARY TO TXGA INDUSTRIAL ELECTRONICS(S.Z)CO.,LTD AND SHOULD NOT BE USED WITHOUT WRITTEN PERMISSION			
5:1	A4	X.XXX±.004(0.10)	.XXX'±0.5'	CHERRY	28/JUN/13				

REV	LOCATIONS	DESCRIPTION	DATE	REVISER	APPD
1	△1	Size changes	02/AUG/22	MATT	CHERRY
2	△2	New drawing and Add dimensions	14/JUN/24	MATT	LEO
3	△3	Add marking code	13/Jan/25	NICK	LEO
4	△4	Size changes	15/Aug/25	NICK	LEO

SPECIFICATIONS

Electrical

Current Rating: 3A AC(rms)/DC  
Voltage Rating: 250V AC(rms)/DC  
Contact Resistance: 25 mΩ Max  
Insulation Resistance: 1000 MΩ Min  
Withstanding Voltage: 500V AC r.m.s  
Temperature Range-Operating: -55°C~+105°C

Material and plating

Housing: PBT UL 94V-0  
Contact: Copper Alloy/  
Selective gold in contact area, tin on tail  
Shell: SPCC/ Nickel Plated  
Board Lock: Copper Alloy /Tin Plated

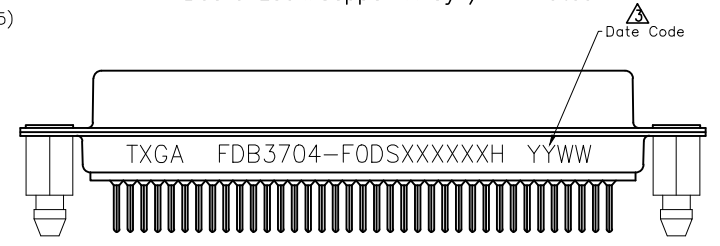
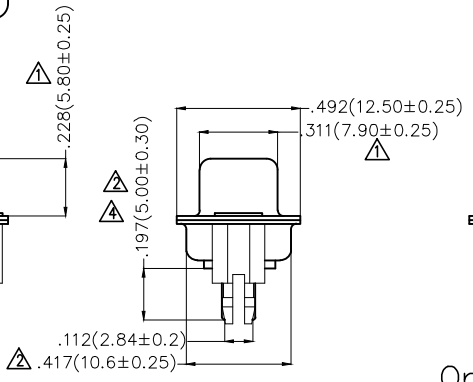
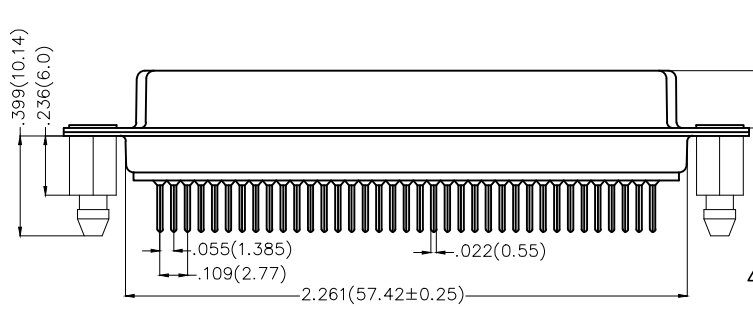
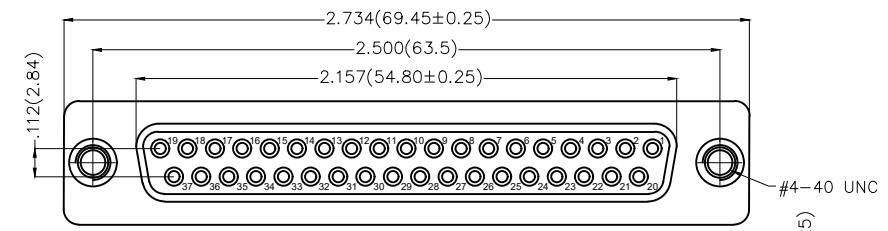

Ordering Information

FDB 37 04 - F0 D S X XX XX X H  
1 2 3 4 5 6 7 8 9 10 11

1	Category FDB- D-SUB Connector	2	Circuits 37-37 Circuits	3	Distinction No. 04	4	Type F0-Female	5	Assembly Layout D-DIP	6	Entry Angle S-180° Vertical
7	Plating 1-Gold Plated Plating 3-Selective gold in contact area, tin on tail	8	Thickness of Gold Plating 00-Gold Flash 03-3μ" Custom Plate Available	9	Color-Resin K6-Black U1-Blue	10	Packaging K-Tray L-Tube	11	Distinction Type H-H Type		

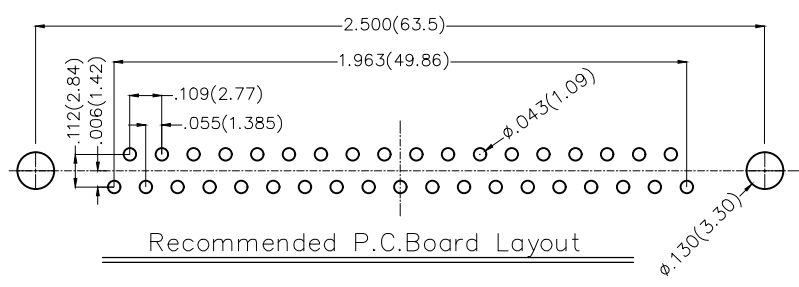

THIRD ANGLE PROJECTION		GENERAL TOLERANCES (UNLESS SPECIFIED)		APPROVE BY	DATE	PART NO.	ITEM NO.	TXGA	
		X.±.012(0.30)	X.±5'	FRANK	28/JUN/13	FDB3704-F0DSXXXXXXH	FDB3704	Building Technology Cornerstone	
DESIGN UNITS Inch (metric)		X.X±.008(0.20)	.X±2'	CHECKED BY	DATE	TITLE			
		X.XX±.006(0.15)	.XX±1'	JACOB	28/JUN/13	D-SUB connector 37 Circuits 180° Vertical Female		REV 4	SHEET NO. 1/1
SCALE	SIZE	X.XXX±.004(0.10)	.XXX±0.5'	DRAWN BY	DATE	THIS DRAWING CONTAINS INFORMATION THAT IS PROPRIETARY TO TXGA INDUSTRIAL ELECTRONICS(S.Z)CO.,LTD AND SHOULD NOT BE USED WITHOUT WRITTEN PERMISSION			
5:1	A4			CHERRY	28/JUN/13				

REV	LOCATIONS	DESCRIPTION	DATE	REVISER	APPD

**SPECIFICATIONS**  
**Electrical**  
 Current Rating: 3A AC(rms)/DC  
 Voltage Rating: 250V AC(rms)/DC  
 Contact Resistance: 25 mΩ Max  
 Insulation Resistance: 1000 MΩ Min  
 Withstanding Voltage: 500V AC r.m.s  
 Temperature Range—Operating: -55°C~+105°C

**Material and plating**  
 Housing: PBT UL 94V-0  
 Contact: Copper Alloy/  
 Selective gold in contact area, tin on tail  
 Shell: SPCC/ Nickel Plated  
 Screw: Copper Alloy/Nickel Plated

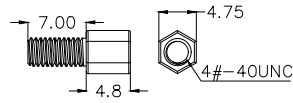
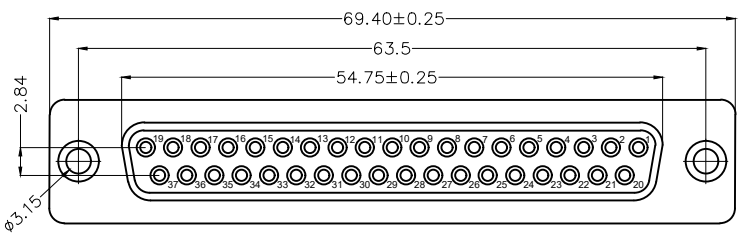

Screw (2pcs)

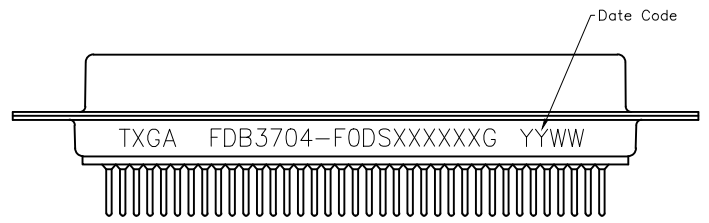
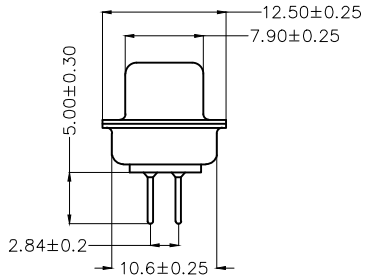
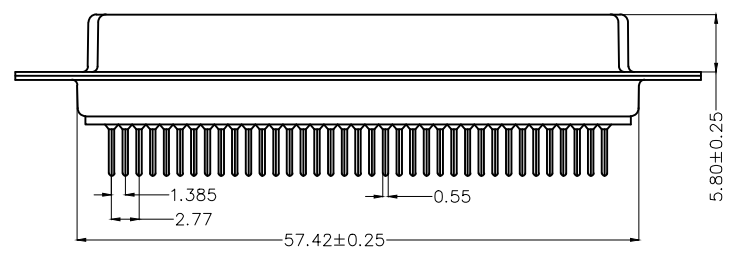

**Ordering Information**

FDB 37 04 — F0 D S X XX XX X G  
 1 2 3 4 5 6 7 8 9 10 11

1 Category FDB- D-SUB Connector	2 Circuits 37-37 Circuits	3 Distinction No. 04	4 Type F0-Female	5 Assembly Layout D-DIP	6 Entry Angle S-180° Vertical
7 Plating 1-Gold Plated Plating 3-Selective gold in contact area, tin on tail	8 Thickness of Gold Plating 00-Gold Flash 03-3μ" Custom Plate Available	9 Color-Resin K6-Black	10 Packaging K-Tray	11 Distinction Type G-G Type	

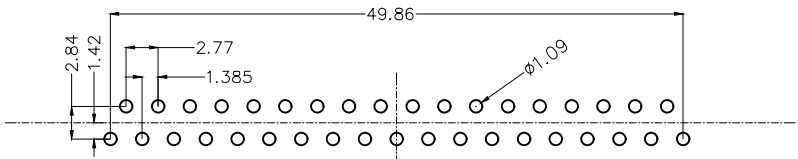

Recommended P.C.Board Layout

THIRD ANGLE PROJECTION	GENERAL TOLERANCES (UNLESS SPECIFIED)		APPROVE BY LEO	DATE 15/AUG/23	PART NO. FDB3704-F0DSXXXXXXG	ITEM NO. FDB3704	 Building Technology Cornerstone
	DESIGN UNITS METRIC	X. ±0.30	X.* ±5°	CHECKED BY GISELLE	DATE 15/AUG/23	TITLE D-SUB connector 37 Circuits 180° Vertical Female	
SCALE 5:1	SIZE A4	X.XX ±0.15	X.XX' ±1°	DRAWN BY NICK	DATE 15/AUG/23	REV 0 SHEET NO. 1/1	
THIS DRAWING CONTAINS INFORMATION THAT IS PROPRIETARY TO TXGA INDUSTRIAL ELECTRONICS(S.Z)CO.,LTD AND SHOULD NOT BE USED WITHOUT WRITTEN PERMISSION							