

| REV | LOCATIONS | DESCRIPTION | DATE | REVISER | APPD |
|-----|-----------|------------------|-----------|---------|--------|
| 1 | △ | Size changes | 27/MAY/22 | MATT | CHERRY |
| 2 | △ | Add marking code | 13/Jan/25 | NICK | LEO |

SPECIFICATIONS

- Electrical
- 1.Current Rating: 3A AC(rms)/DC
 - 2.Voltage Rating: 250V AC(rms)/DC
 - 3.Contact Resistance: 30 mΩ Max
 - 4.Insulation Resistance: 1000 MΩ MIN /DC 500V
 - 5.Withstanding Voltage: 500V AC r.m.s
 - 6.Temperature Range—Operating: -45°C~+85°C
- Material and Finish
- 1.Housing: PBT+30%GF UL94V-0
 - 2.Contact: Copper Alloy/ Gold Plated/
Selective gold on contact area, tin on tail
 - 3.Shell: Steel/Nickel Plated

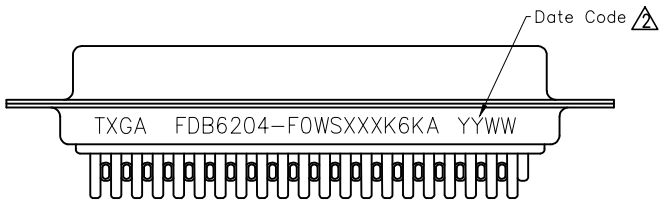
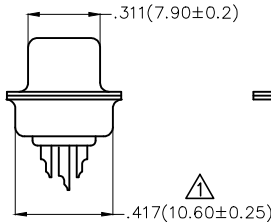
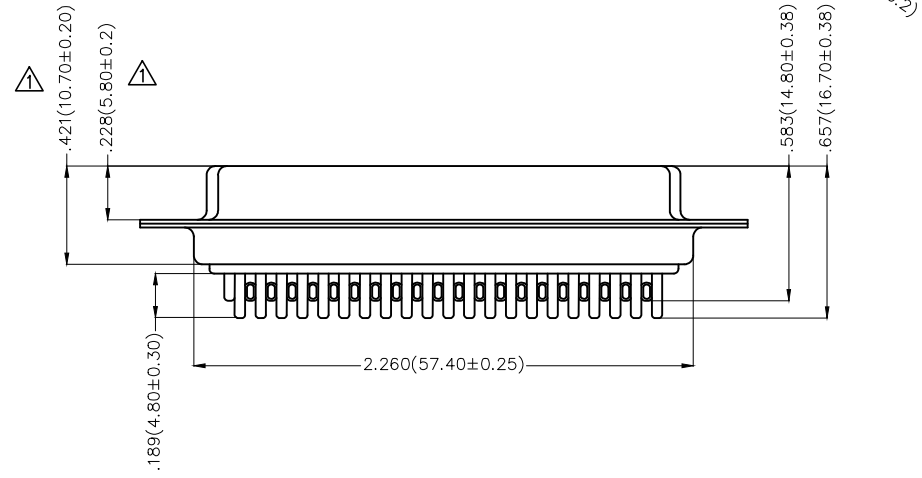
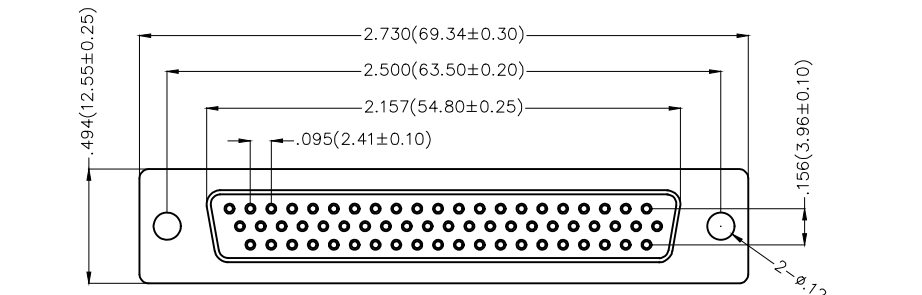

Ordering Information

FDB 62 04 - F0 W S X XX K6 K A
 1 2 3 4 5 6 7 8 9 10 11

| | | | | | | | | | | | |
|---|---|---|---|---|-------------------------|----|---------------------|----|-----------------------------------|---|---------------------------|
| 1 | Category FDB- D-SUB | 2 | Circuits 62 | 3 | Distinction No. 04 | 4 | Type F0-Female | 5 | Assembly Layout W-Welding Type | 6 | Entry Angle S-Vertical |
| 7 | Plating 1-Gold plated 3-Selective gold on contact area, tin on tail | 8 | Thickness of Gold Plating 00-Gold Flash 01-1u" 03-3u" Custom Plate Available | 9 | Color-Resin K6-Black | 10 | Packaging K-Tray | 11 | Products Categories A-A Type | | |

| | | | | | | | | |
|-------------------------------|---------------------------------------|--|--|----------------------|--|----------------------------------|---------------------------|-------|
| <p>THIRD ANGLE PROJECTION</p> | GENERAL TOLERANCES (UNLESS SPECIFIED) | | APPROVE BY FRANK | DATE 18/JUN/13 | PART NO. FDB6204-FOWSXXXK6KA | ITEM NO. FDB6204 | <p>Leader Of Industry</p> | |
| | DESIGN UNITS Inch (metric) | X.±.012(0.30) X.X±.008(0.20) X.XX±.006(0.15) X.XXX±.004(0.10) | X.±5° .X'±2° .XX'±1° .XXX'±0.5° | CHECKED BY CHERRY | DATE 18/JUN/13 | TITLE D-SUB 62PIN FEMALE CONN | | REV 2 |
| SCALE 5:1 | SIZE A4 | | DRAWN BY KATE | DATE 18/JUN/13 | THIS DRAWING CONTAINS INFORMATION THAT IS PROPRIETARY TO TXGA INDUSTRIAL ELECTRONICS(S.Z)CO.,LTD AND SHOULD NOT BE USED WITHOUT WRITTEN PERMISSION | | | |