

REV	LOCATIONS	DESCRIPTION	DATE	REVISER	APPD
1	△	ADD DIM	13/AUG/15	KEVIN	CHERRY
2	△	Add marking code	13/JAN/25	NICK	LEO
3	△	Update dimensions	10/JUN/25	MATT	LEO

SPECIFICATIONS

Electrical
 Current Rating: 3A AC(rms)/DC
 Voltage Rating: 250V AC(rms)/DC
 Contact Resistance: 30 mΩ Max
 Insulation Resistance: 1000 MΩ Min
 Withstanding Voltage: 500V AC r.m.s
 Temperature Range—Operating: -55°C~+105°C

Material and plating
 Housing: PBT UL 94V-0
 Contact: Copper Alloy/ Gold plated/
 Selective gold in contact area, tin on tail
 Shell: SPCC/ Nickel Plated
 Nuts: Copper Alloy/ Nickel Plated

Ordering Information

FDB 78 05 - F0 D S X XX K6 K B
 1 2 3 4 5 6 7 8 9 10 11

1 Category FDB- D-SUB Connector	2 Circuits 78-78 Circuits	3 Distinction No. 05	4 Type F0-Female	5 Assembly Layout D-DIP	6 Entry Angle S-180° Vertical
7 Plating 1-Gold Plated 3-Selective gold in contact area, tin on tail	8 Thickness of Plating 00-Gold Flash 03-3μ" Custom Plate Available	9 Color-Resin K6-Black	10 Packaging K-Tray	11 Distinction Type B-B Type	

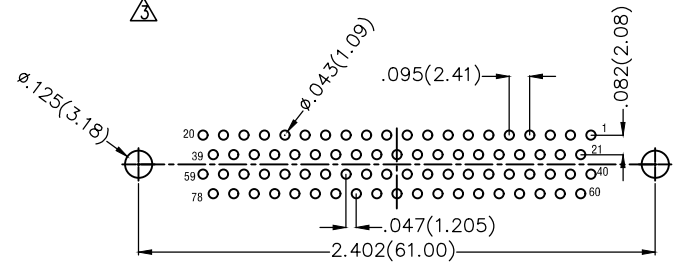
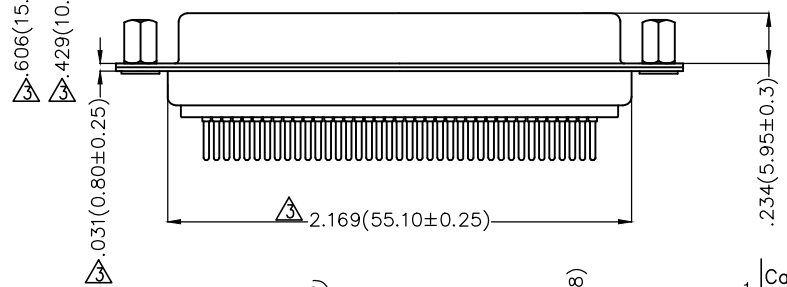
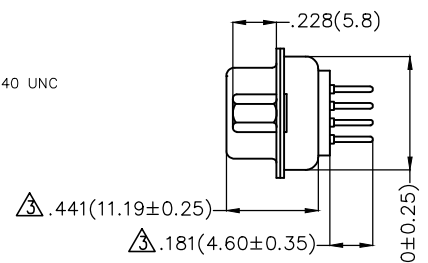
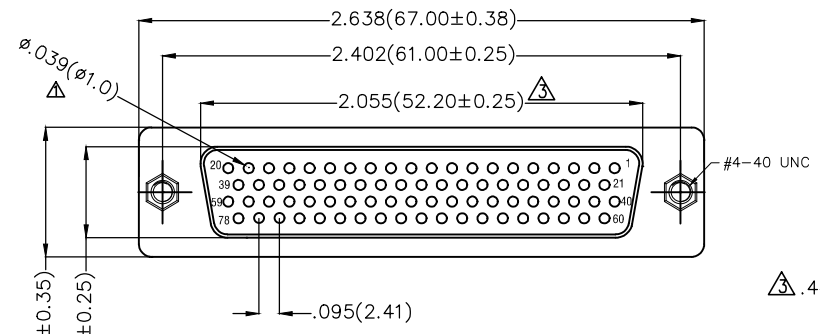
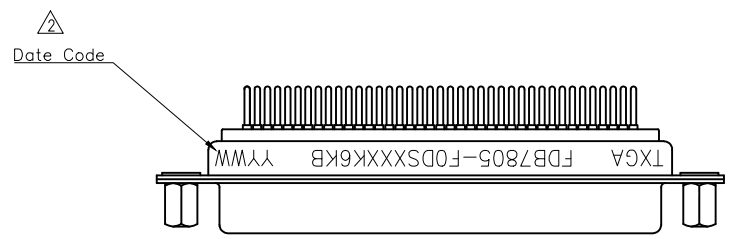

Recommended P.C.Board Layout

THIRD ANGLE PROJECTION	GENERAL TOLERANCES (UNLESS SPECIFIED)		APPROVE BY FRANK	DATE 28/AUG/13	PART NO. FDB7805-F0DSXXXK6KB	ITEM NO. FDB7805	
	DESIGN UNITS Inch (metric)	X.±.012(0.30) X.X±.008(0.20) X.XX±.006(0.15) X.XXX±.004(0.10)	X'±5" .X'±2" .XX'±1" .XXX'±0.5"	CHECKED BY CHERRY	DATE 28/AUG/13	TITLE D-SUB connector 78 Circuits 180° Vertical Female	
SCALE 5:1	SIZE A4	DRAWN BY KEVIN		DATE 28/AUG/13	THIS DRAWING CONTAINS INFORMATION THAT IS PROPRIETARY TO TXGA INDUSTRIAL ELECTRONICS(S.Z)CO.,LTD AND SHOULD NOT BE USED WITHOUT WRITTEN PERMISSION		REV 3 SHEET NO. 1/1

REV	LOCATIONS	DESCRIPTION	DATE	REVISER	APPD
1	△	ADD DIM	13/AUG/15	KEVIN	CHERRY
2	△	Add marking code	13/JAN/25	NICK	LEO
3	△	Update dimensions	10/JUN/25	MATT	LEO

SPECIFICATIONS

Electrical
 Current Rating: 3A AC(rms)/DC
 Voltage Rating: 250V AC(rms)/DC
 Contact Resistance: 30 mΩ Max
 Insulation Resistance: 1000 MΩ Min
 Withstanding Voltage: 500V AC r.m.s
 Temperature Range—Operating: -55°C~+105°C

Material and plating
 Housing: PBT UL 94V-0
 Contact: Copper Alloy/ Gold plated/
 Selective gold in contact area, tin on tail
 Shell: SPCC/ Nickel Plated
 Nuts: Copper Alloy/ Nickel Plated

Ordering Information

FDB 78 05 — F0 D S X XX K6 K C
 1 2 3 4 5 6 7 8 9 10 11

1 Category FDB- D-SUB Connector	2 Circuits 78-78 Circuits	3 Distinction No. 05	4 Type F0-Female	5 Assembly Layout D-DIP	6 Entry Angle S-180° Vertical
7 Plating 1-Gold Plated 3-Selective gold in contact area, tin on tail	8 Thickness of Plating 00-Gold Flash 03-3μ" Custom Plate Available	9 Color-Resin K6-Black	10 Packaging K-Tray	11 Distinction Type C-C Type	

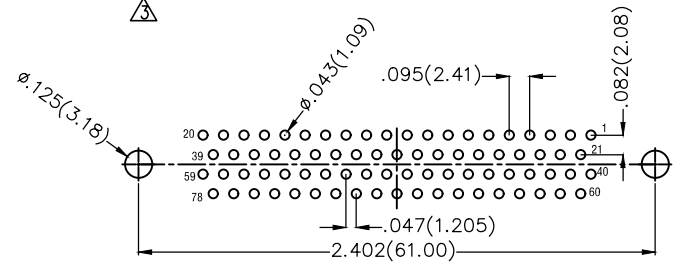
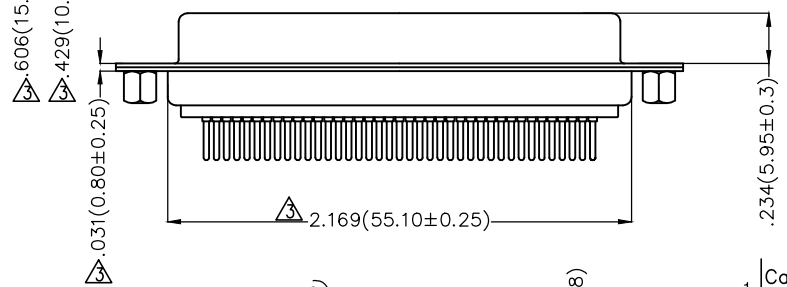
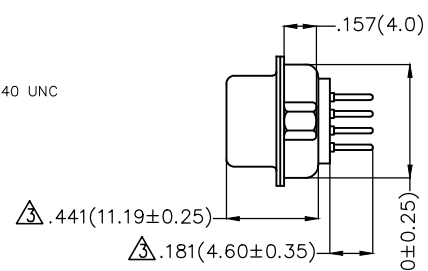
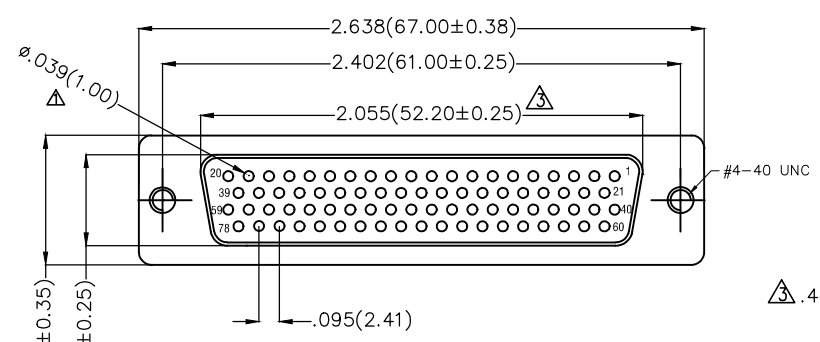
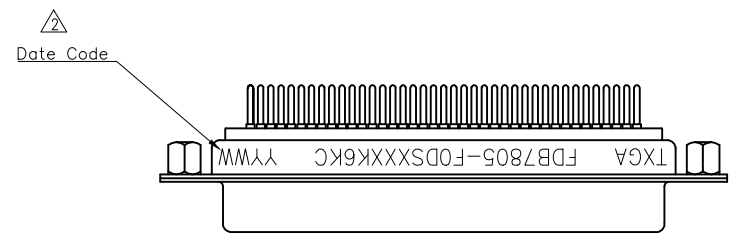

Recommended P.C.Board Layout

THIRD ANGLE PROJECTION	GENERAL TOLERANCES (UNLESS SPECIFIED)		APPROVE BY FRANK	DATE 28/AUG/13	PART NO. FDB7805-F0DSXXXK6KC	ITEM NO. FDB7805	
	DESIGN UNITS Inch (metric)	X.±.012(0.30) X.X±.008(0.20) X.XX±.006(0.15) X.XXX±.004(0.10)	X'.±5' .X'±2' .XX'±1' .XXX'±0.5'	CHECKED BY CHERRY	DATE 28/AUG/13	TITLE D-SUB connector 78 Circuits 180° Vertical Female	
SCALE 5:1	SIZE A4	DRAWN BY KEVIN		DATE 28/AUG/13	THIS DRAWING CONTAINS INFORMATION THAT IS PROPRIETARY TO TXGA INDUSTRIAL ELECTRONICS(S.Z)CO.,LTD AND SHOULD NOT BE USED WITHOUT WRITTEN PERMISSION		REV 3 SHEET NO. 1/1

REV	LOCATIONS	DESCRIPTION	DATE	REVISER	APPD
1	△	ADD DIM	13/AUG/15	KEVIN	CHERRY
2	△	Add marking code	13/JAN/25	NICK	LEO
3	△	Update dimensions	10/JUN/25	MATT	LEO

SPECIFICATIONS

Electrical
 Current Rating: 3A AC(rms)/DC
 Voltage Rating: 250V AC(rms)/DC
 Contact Resistance: 30 mΩ Max
 Insulation Resistance: 1000 MΩ Min
 Withstanding Voltage: 500V AC r.m.s
 Temperature Range—Operating: -55°C~+105°C

Material and plating
 Housing: PBT UL 94V-0
 Contact: Copper Alloy/ Gold plated/
 Selective gold in contact area, tin on tail
 Shell: SPCC/ Nickel Plated
 Nuts: Copper Alloy/ Nickel Plated

Ordering Information

FDB 78 05 — F0 D S X XX K6 K D
 1 2 3 4 5 6 7 8 9 10 11

1 Category FDB- D-SUB Connector	2 Circuits 78-78 Circuits	3 Distinction No. 05	4 Type F0-Female	5 Assembly Layout D-DIP	6 Entry Angle S-180° Vertical
7 Plating 1-Gold Plated 3-Selective gold in contact area, tin on tail	8 Thickness of Plating 00-Gold Flash 03-3μ" Custom Plate Available	9 Color-Resin K6-Black	10 Packaging K-Tray	11 Distinction Type D-D Type	

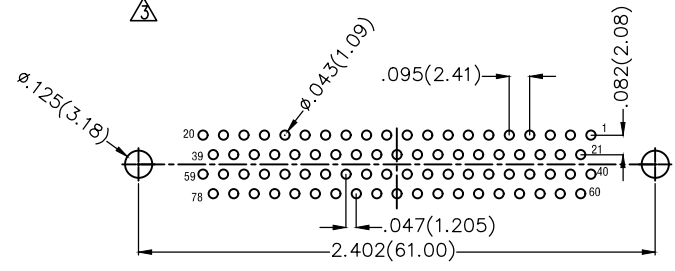
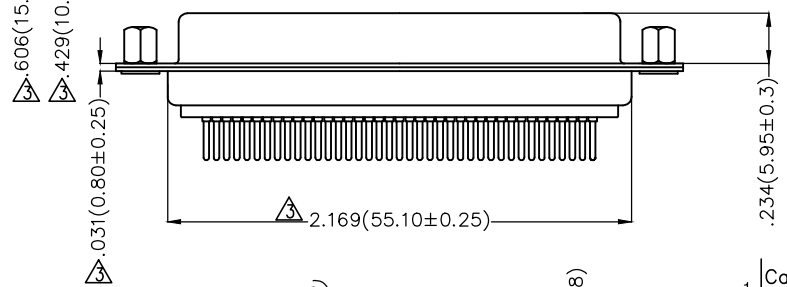
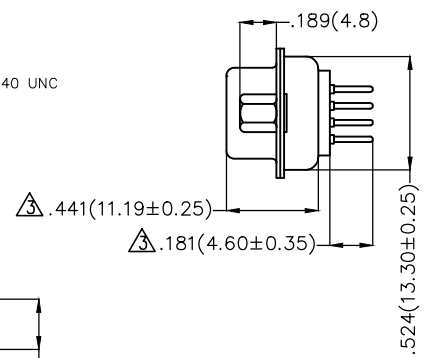
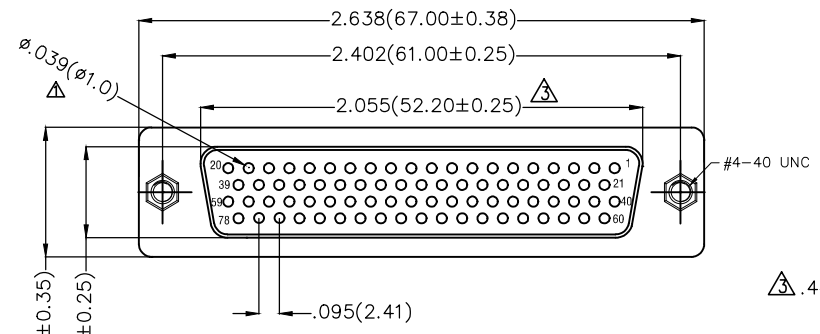
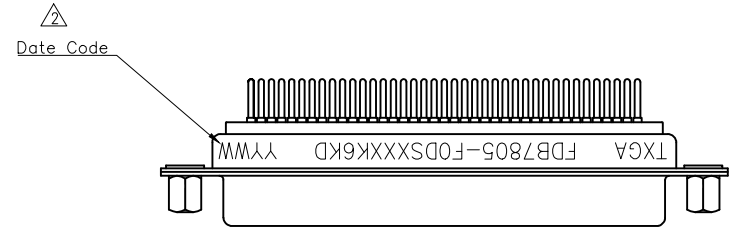

Recommended P.C.Board Layout

THIRD ANGLE PROJECTION	GENERAL TOLERANCES (UNLESS SPECIFIED)		APPROVE BY FRANK	DATE 28/AUG/13	PART NO. FDB7805-F0DSXXXK6KD	ITEM NO. FDB7805	
	DESIGN UNITS Inch (metric)	X.±.012(0.30) X.X±.008(0.20) X.XX±.006(0.15) X.XXX±.004(0.10)	X'±5" .X'±2" .XX'±1" .XXX'±0.5"	CHECKED BY CHERRY	DATE 28/AUG/13	TITLE D-SUB connector 78 Circuits 180° Vertical Female	
SCALE 5:1	SIZE A4		DRAWN BY KEVIN	DATE 28/AUG/13	THIS DRAWING CONTAINS INFORMATION THAT IS PROPRIETARY TO TXGA INDUSTRIAL ELECTRONICS(S.Z)CO.,LTD AND SHOULD NOT BE USED WITHOUT WRITTEN PERMISSION		REV 3 SHEET NO. 1/1

REV	LOCATIONS	DESCRIPTION	DATE	REVISER	APPD
1	△	ADD DIM	13/AUG/15	KEVIN	CHERRY
2	△	Add marking code	13/JAN/25	NICK	LEO
3	△	Update dimensions	10/JUN/25	MATT	LEO

SPECIFICATIONS

Electrical
 Current Rating: 3A AC(rms)/DC
 Voltage Rating: 250V AC(rms)/DC
 Contact Resistance: 30 mΩ Max
 Insulation Resistance: 1000 MΩ Min
 Withstanding Voltage: 500V AC r.m.s
 Temperature Range—Operating: -55°C~+105°C

Material and plating
 Housing: PBT UL 94V-0
 Contact: Copper Alloy/ Gold plated/
 Selective gold in contact area, tin on tail
 Shell: SPCC/ Nickel Plated
 Nuts: Copper Alloy/ Nickel Plated

Ordering Information

FDB 78 05 - F0 D S X XX K6 K E
 1 2 3 4 5 6 7 8 9 10 11

1 Category FDB- D-SUB Connector	2 Circuits 78-78 Circuits	3 Distinction No. 05	4 Type F0-Female	5 Assembly Layout D-DIP	6 Entry Angle S-180° Vertical
7 Plating 1-Gold Plated 3-Selective gold in contact area, tin on tail	8 Thickness of Plating 00-Gold Flash 03-3μ" Custom Plate Available	9 Color-Resin K6-Black	10 Packaging K-Tray	11 Distinction Type E-E Type	

THIRD ANGLE PROJECTION	GENERAL TOLERANCES (UNLESS SPECIFIED)		APPROVE BY FRANK	DATE 28/AUG/13	PART NO. FDB7805-F0DSXXXK6KE	ITEM NO. FDB7805	 Building Technology Cornerstone
	DESIGN UNITS Inch (metric)	X.±.012(0.30) X.X±.008(0.20) X.XX±.006(0.15) X.XXX±.004(0.10)	X'.±5' .X'±2' .XX'±1' .XXX'±0.5'	CHECKED BY CHERRY	DATE 28/AUG/13	TITLE D-SUB connector 78 Circuits 180° Vertical Female	
SCALE 5:1	SIZE A4		DRAWN BY KEVIN	DATE 28/AUG/13	THIS DRAWING CONTAINS INFORMATION THAT IS PROPRIETARY TO TXGA INDUSTRIAL ELECTRONICS(S.Z)CO.,LTD AND SHOULD NOT BE USED WITHOUT WRITTEN PERMISSION		

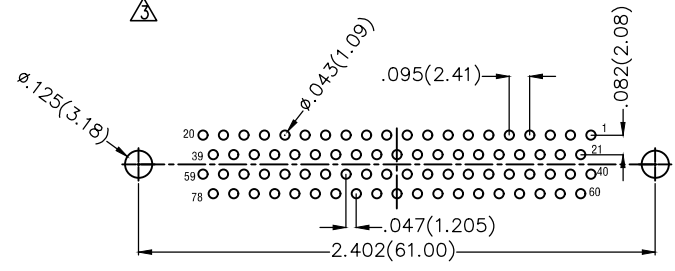
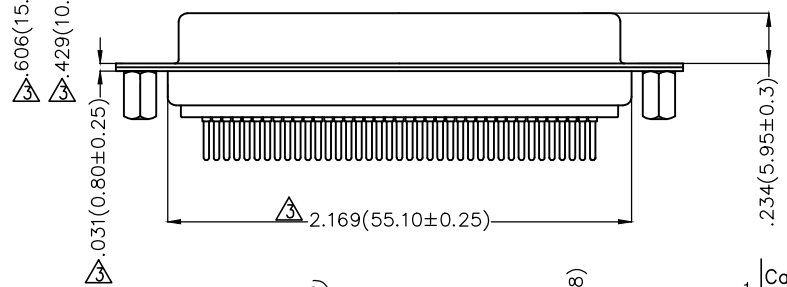
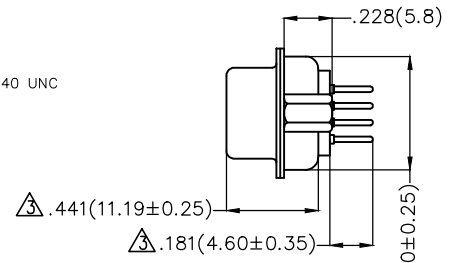
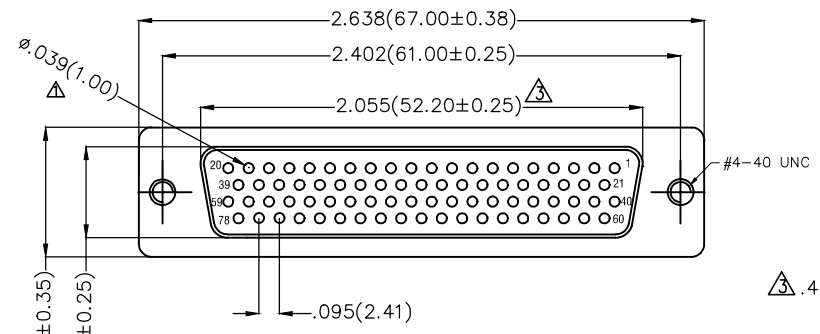
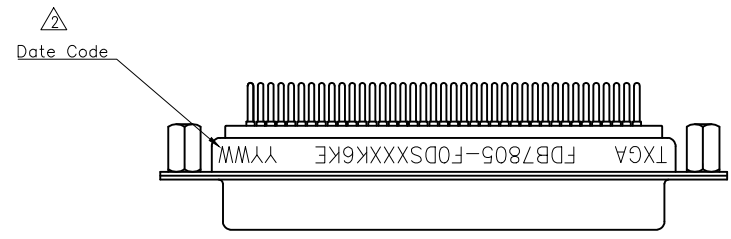

Recommended P.C.Board Layout

A
B
C
D
E
F

A
B
C
D
E
F

1 2 3 4 5 6 7 8

1 2 3 4 5 6 7 8

REV	LOCATIONS	DESCRIPTION	DATE	REVISER	APPD
1	△	ADD DIM	13/AUG/15	KEVIN	CHERRY
2	△	Add marking code	13/JAN/25	NICK	LEO
3	△	Update dimensions	10/JUN/25	MATT	LEO

SPECIFICATIONS

Electrical
 Current Rating: 3A AC(rms)/DC
 Voltage Rating: 250V AC(rms)/DC
 Contact Resistance: 30 mΩ Max
 Insulation Resistance: 1000 MΩ Min
 Withstanding Voltage: 500V AC r.m.s
 Temperature Range—Operating: -55°C~+105°C

Material and plating
 Housing: PBT UL 94V-0
 Contact: Copper Alloy/ Gold plated/
 Selective gold in contact area, tin on tail
 Shell: SPCC/ Nickel Plated
 Board Lock: Copper Alloy/ Tin Plated
 Screws: Copper Alloy/ Nickel Plated

Ordering Information

FDB 78 05 - F0 D S X XX K6 K F
 1 2 3 4 5 6 7 8 9 10 11

1 Category FDB- D-SUB Connector	2 Circuits 78-78 Circuits	3 Distinction No. 05	4 Type F0-Female	5 Assembly Layout D-DIP	6 Entry Angle S-180° Vertical
7 Plating 1-Gold Plated 3-Selective gold in contact area, tin on tail	8 Thickness of Plating 00-Gold Flash 03-3μ" Custom Plate Available	9 Color-Resin K6-Black	10 Packaging K-Tray	11 Distinction Type F-F Type	

THIRD ANGLE PROJECTION	GENERAL TOLERANCES (UNLESS SPECIFIED)		APPROVE BY FRANK	DATE 28/AUG/13	PART NO. FDB7805-F0DSXXXK6KF	ITEM NO. FDB7805	 Building Technology Cornerstone
	DESIGN UNITS Inch (metric)	X.±.012(0.30) X.X±.008(0.20) X.XX±.006(0.15) X.XXX±.004(0.10)	X'.±5' .X'±2' .XX'±1' .XXX'±0.5'	CHECKED BY CHERRY	DATE 28/AUG/13	TITLE D-SUB connector 78 Circuits 180° Vertical Female	
SCALE 5:1	SIZE A4	DRAWN BY KEVIN		DATE 28/AUG/13	THIS DRAWING CONTAINS INFORMATION THAT IS PROPRIETARY TO TXGA INDUSTRIAL ELECTRONICS(S.Z)CO.,LTD AND SHOULD NOT BE USED WITHOUT WRITTEN PERMISSION		

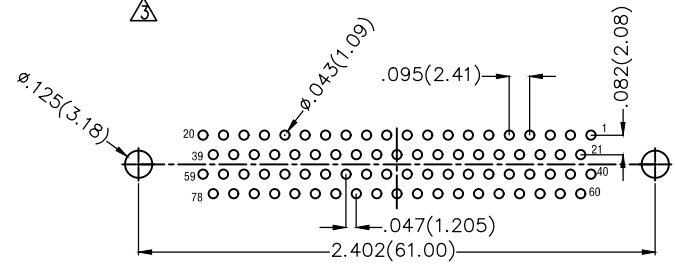
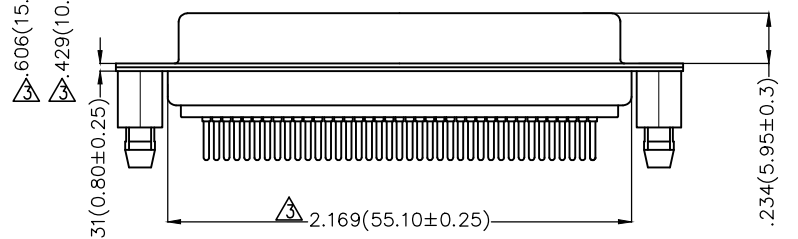
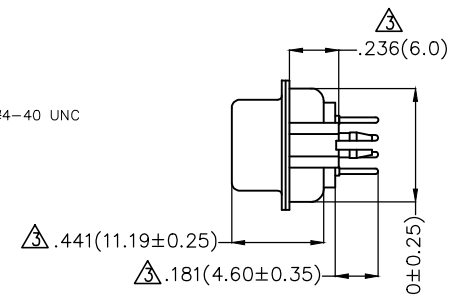
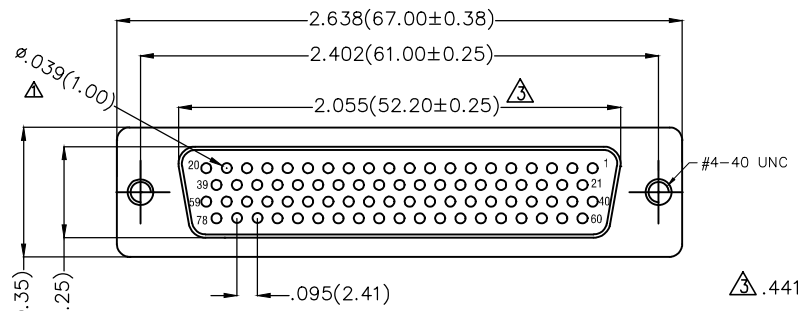
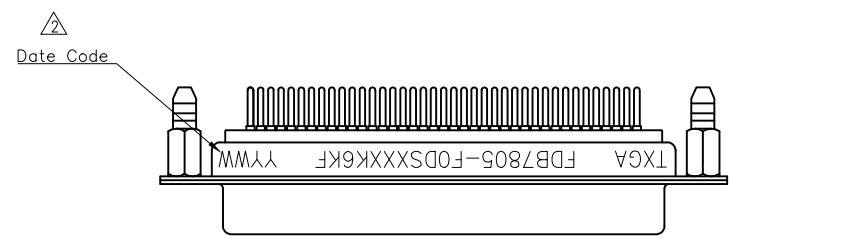

Recommended P.C.Board Layout