

REV	LOCATIONS	DESCRIPTION	DATE	REVISER	APPD

SPECIFICATIONS

Electrical
 Current Rating: 0.5A AC(rms)/DC
 Voltage Rating: 40V AC(rms)/DC
 Contact Resistance: 30 mΩ Max
 Insulation Resistance: 100 MΩ Min
 Withstanding Voltage: 500V AC r.m.s

Mechanical
 Mating force: 4.5KG.F Max
 Retention force: 1.0KG.F Min
 Durability: 10000 cycles Min.

Environmental
 Operating Temperature: -25°C~+85°C

Material and plating
 Housing: LCP (UL 94V-0), Black
 Contacts: Copper Alloy/Gold 0.025μm plated on contact, Tin plated on tail
 Shell: Copper Alloy/Nickel plated

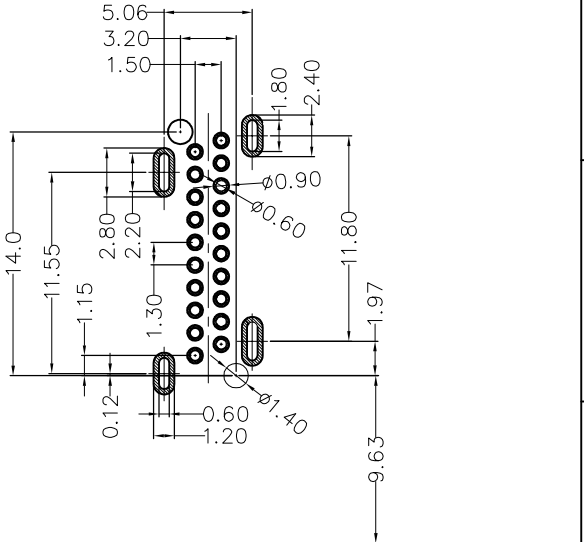
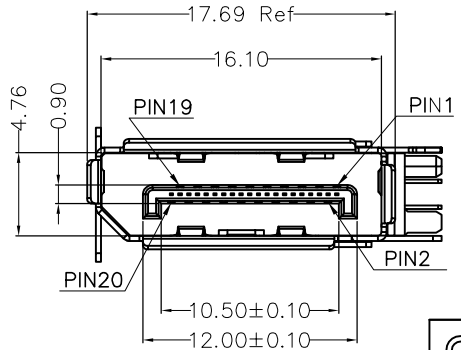
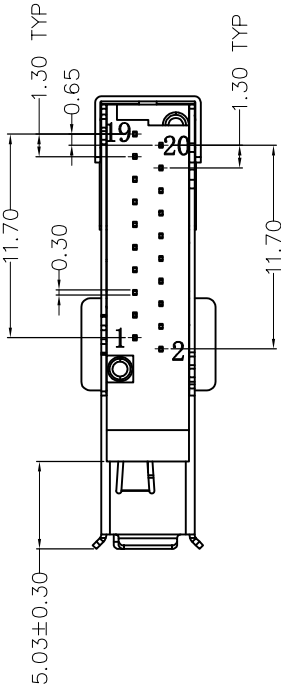
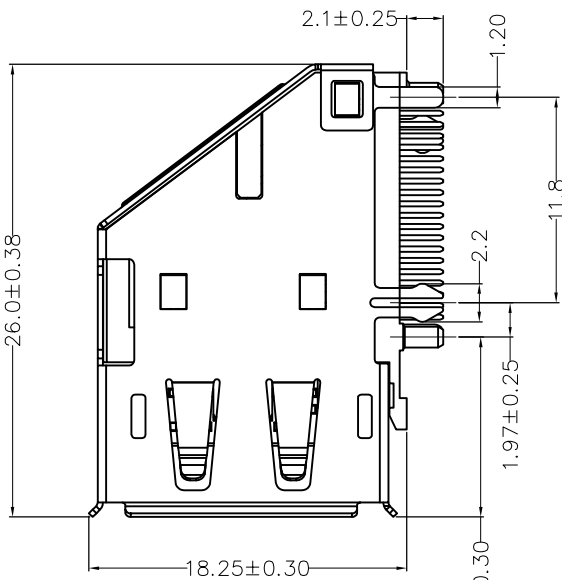
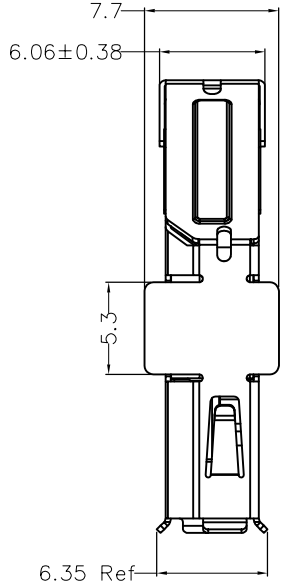
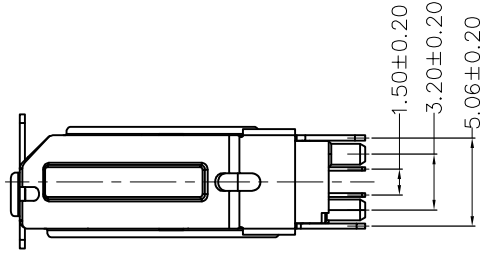

Recommended P.C.Board Layout
 General tolerances: ±0.05

 THIRD ANGLE PROJECTION	GENERAL TOLERANCES (UNLESS SPECIFIED)		APPROVE BY	DATE	PART NO.	ITEM NO.	 Building Technology Cornerstone	
	X.±0.30	.X'±5'	LEO	15/AUG/22	FDL07-FDB301BKM	FDL07		
	DESIGN UNITS Metric(mm)	X.X±0.20	.X'±2'	CHECKED BY	DATE	TITLE		REV 0 SHEET NO. 1/2
	SCALE	X.XX±0.15	.XX'±1"	GISELLE	15/AUG/22	DISPLAY PORT 90°Angle Female(DIP)		
SIZE	X.XXX±0.10	.XXX'±0.5"	DRAWN BY	DATE	THIS DRAWING CONTAINS INFORMATION THAT IS PROPRIETARY TO TXGA INDUSTRIAL ELECTRONICS(S.Z)CO.,LTD AND SHOULD NOT BE USED WITHOUT WRITTEN PERMISSION			
5:1	MATT			15/AUG/22				
A4								

1 2 3 4 5 6 7 8

REV	LOCATIONS	DESCRIPTION	DATE	REVISER	APPD

- Note:
- 10 sprocket hole cumulative tolerance ± 0.2
 - Carrier camber is within 1.0mm in 100mm
 - Material: White Conductive polystyrene Alloy 100% recyclable
 - All dimensions meet EIA-481-3 requirements
 - Component load per 13" reel: 170pcs

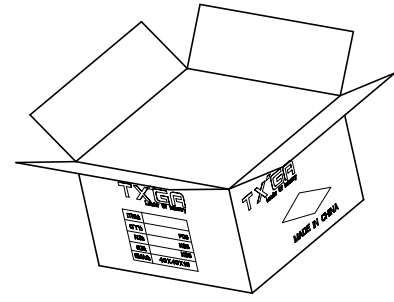
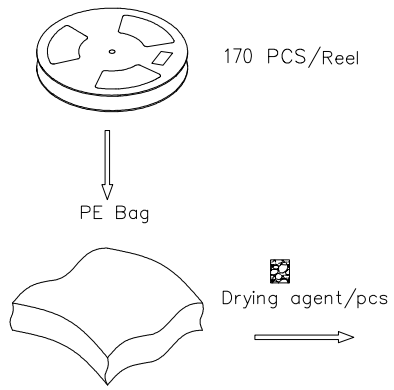
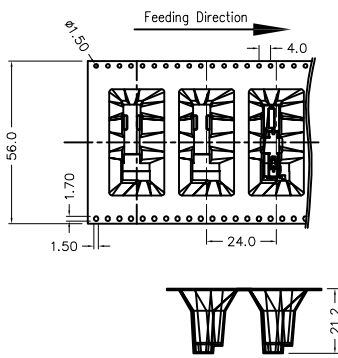
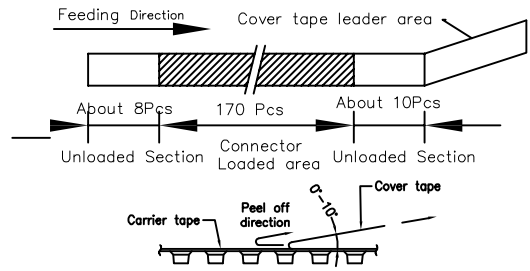
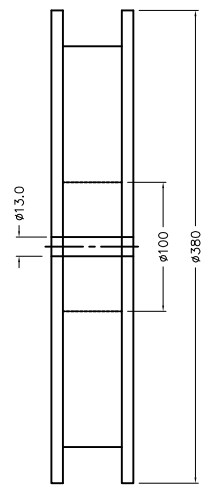
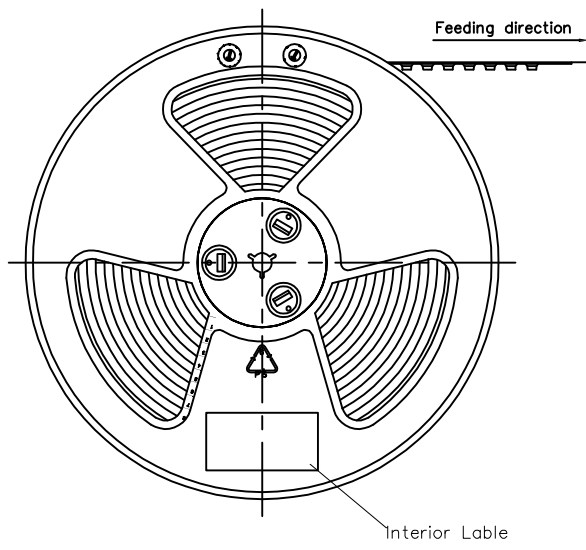

 THIRD ANGLE PROJECTION	GENERAL TOLERANCES (UNLESS SPECIFIED)		APPROVE BY	DATE	PART NO.	ITEM NO.	 Building Technology Cornerstone
	X.±0.30	X.±5'	LEO	12/JUL/22	FDL07-FDB301BKM	FDL07	
DESIGN UNITS Metric(mm)	X.X±0.20	.X'±2'	CHECKED BY	DATE	TITLE		REV 0 SHEET NO. 2/2
SCALE 5:1 SIZE A4	X.XX±0.15	.XX'±1'	GISELLE	12/JUL/22	DISPLAY PORT 90°Angle Female(DIP)		
	X.XXX±0.10	.XXX'±0.5'	DRAWN BY	DATE	THIS DRAWING CONTAINS INFORMATION THAT IS PROPRIETARY TO TXGA INDUSTRIAL ELECTRONICS(S.Z)CO.,LTD AND SHOULD NOT BE USED WITHOUT WRITTEN PERMISSION		
			MATT	12/JUL/22			

1 2 3 4 5 6 7 8