

REV	LOCATIONS	DESCRIPTION	DATE	REVISER	APPD

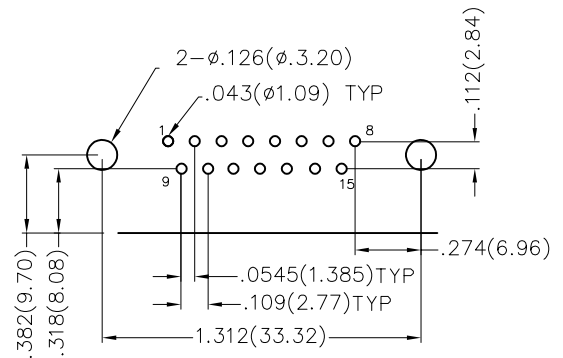
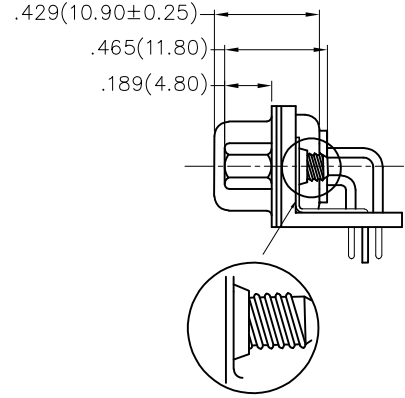
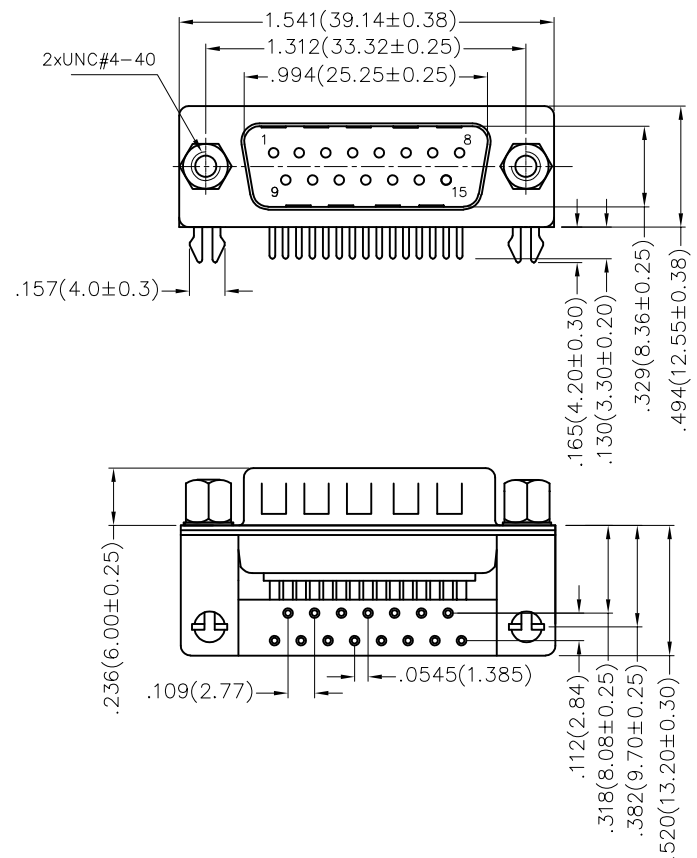

Recommended P.C.Board Layout

### Ordering Information

FDM 15 01 - M0 D B 1 XX XX X  
 1 2 3 4 5 6 7 8 9 10

1   Category FDM-Machined pin D-SUB connector	2   Circuits 15	3   Distinction No. 01	4   Type M0-Male	5   Assembly Layout D-DIP	6   Entry Angle B-90° Angle
7   Plating 1-Gold Plated	8   Thickness of Plating 01-1µ" 03-3µ" Custom plate available	9   Color-Resin W1-White K6-Black	10   Packaging K-Tray L-Tube		

**Materials And Finish**  
 Shell: Spcc Material, Front Nickel Plated 80µ" Min  
 Back Shell: SPCC, Tin Plated 100µ" Min  
 Insulator: Glass Filled Thermoplastic, UL 94V-0  
 Contact Material: Brass /Gold Plated  
**Electrical Characteristic**  
 Current Rating: 7.5A  
 Voltage Rating: 300V  
 Contact Resistance: 5mΩ Max  
 Dielectric Withstanding Voltage :1000V AC r.m.s  
 Insulation Resistance: 5000 MΩ Min.  
 Temperature Range-Operating: -55°C ~ +105°C

THIRD ANGLE PROJECTION	GENERAL TOLERANCES (UNLESS SPECIFIED)		APPROVE BY FRANK	DATE 28/JUN/13	PART NO. FDM1501-M0DB1XXXXX	ITEM NO. FDM1501-M0	 Building Technology Cornerstone
	DESIGN UNITS Inch (metric)	X.±.012(0.30) X.X±.008(0.20) X.XX±.006(0.15) X.XXX±.004(0.10)	X'±5' 'X'±2' 'XX'±1' 'XXX'±0.5'	CHECKED BY JACOB	DATE 28/JUN/13	TITLE Machined pin D-SUB connector 90° Angle Male	
SCALE 5:1	SIZE A4	DRAWN BY CHERRY		DATE 28/JUN/13	THIS DRAWING CONTAINS INFORMATION THAT IS PROPRIETARY TO TXGA INDUSTRIAL ELECTRONICS(S.Z)CO.,LTD AND SHOULD NOT BE USED WITHOUT WRITTEN PERMISSION		

REV	LOCATIONS	DESCRIPTION	DATE	REVISER	APPD

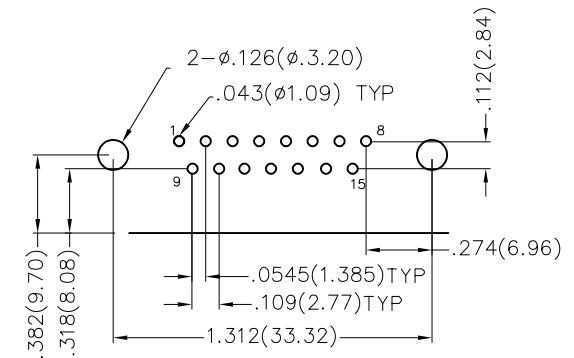
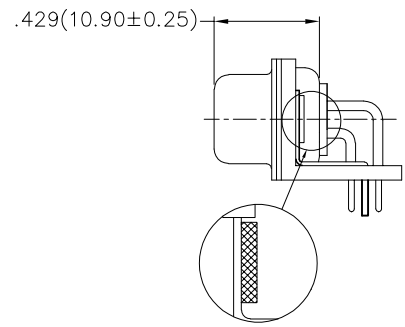
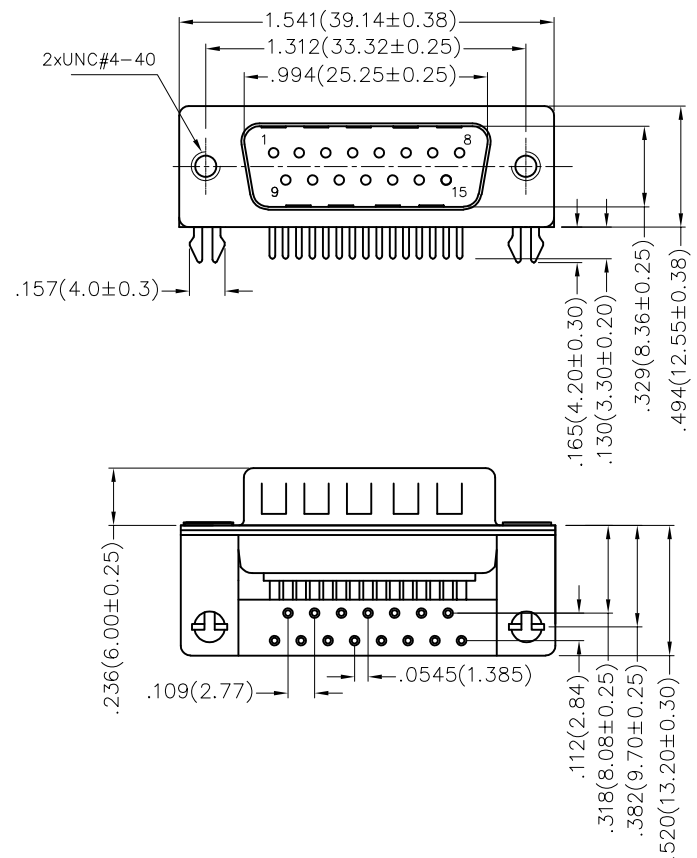

Recommended P.C. Board Layout

Ordering Information

FDM 15 01 - M0 D B 1 XX XX X B  
 1 2 3 4 5 6 7 8 9 10 11

1   Category FDM-Machined pin D-SUB connector	2   Circuits 15	3   Distinction No. 01	4   Type M0-Male	5   Assembly Layout D-DIP	6   Entry Angle B-90° Angle
7   Plating 1-Gold Plated	8   Thickness of Plating 01-1μ" 03-3μ" Custom plate available	9   Color-Resin W1-White K6-Black	10   Packaging K-Tray L-Tube	11   Distinction Type B-B Type	

Materials And Finish  
 Shell: Spcc Material, Front Nickel Plated 80μ" Min  
 Back Shell: SPCC, Tin Plated 100μ" Min  
 Insulator: Glass Filled Thermoplastic, UL 94V-0  
 Contact Material: Brass /Gold Plated  
 Electrical Characteristic  
 Current Rating: 7.5A  
 Voltage Rating: 300V  
 Contact Resistance: 5mΩ Max  
 Dielectric Withstanding Voltage :1000V AC r.m.s  
 Insulation Resistance: 5000 MΩ Min.  
 Temperature Range-Operating: -55°C ~ +105°C

THIRD ANGLE PROJECTION	GENERAL TOLERANCES (UNLESS SPECIFIED)		APPROVE BY FRANK	DATE 28/JUN/13	PART NO. FDM1501-MODB1XXXXXB	ITEM NO. FDM1501-M0	 Building Technology Cornerstone
	DESIGN UNITS Inch (metric)	X.±.012(0.30) X.X±.008(0.20) X.XX±.006(0.15) X.XXX±.004(0.10)	X'±5' .X'±2' .XX'±1' .XXX'±0.5'	CHECKED BY JACOB	DATE 28/JUN/13	TITLE Machined pin D-SUB connector 90° Angle Male	
SCALE 5:1	SIZE A4		DRAWN BY CHERRY	DATE 28/JUN/13	THIS DRAWING CONTAINS INFORMATION THAT IS PROPRIETARY TO TXGA INDUSTRIAL ELECTRONICS(S.Z)CO.,LTD AND SHOULD NOT BE USED WITHOUT WRITTEN PERMISSION		

REV	LOCATIONS	DESCRIPTION	DATE	REVISER	APPD
1	△	Size change	21/FEB/22	MATT	CHERRY

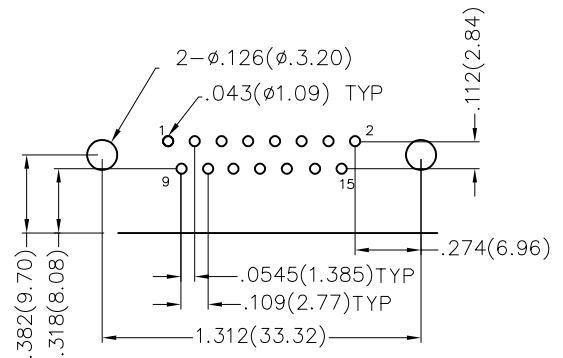
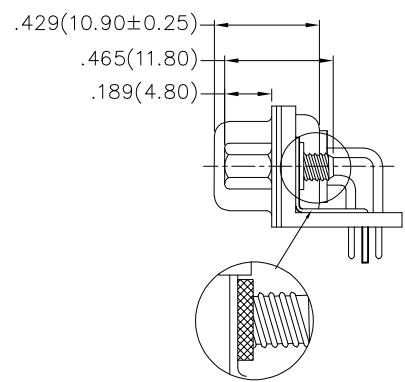
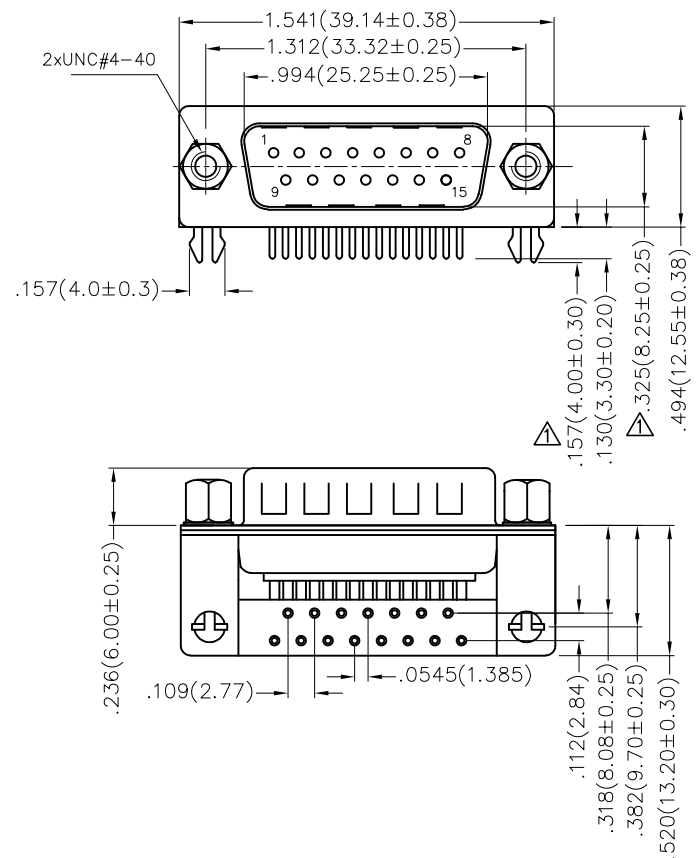

Recommended P.C.Board Layout

### Ordering Information

FDM 15 01 - M0 D B 1 XX XX X C  
 1 2 3 4 5 6 7 8 9 10 11

1   Category FDM-Machined pin D-SUB connector	2   Circuits 15	3   Distinction No. 01	4   Type M0-Male	5   Assembly Layout D-DIP	6   Entry Angle B-90° Angle
7   Plating 1-Gold Plated	8   Thickness of Plating 01-1μ" 03-3μ" Custom plate available	9   Color-Resin W1-White K6-Black	10   Packaging K-Tray L-Tube	11   Distinction Type C-C Type	

**Materials And Finish**  
 Shell: Spcc Material, Front Nickel Plated 80μ" Min  
 Back Shell: SPCC, Tin Plated 100μ" Min  
 Insulator: Glass Filled Thermoplastic, UL 94V-0  
 Contact Material: Brass /Gold Plated  
**Electrical Characteristic**  
 Current Rating: 7.5A  
 Voltage Rating: 300V  
 Contact Resistance: 5mΩ Max  
 Dielectric Withstanding Voltage :1000V AC r.m.s  
 Insulation Resistance: 5000 MΩ Min.  
 Temperature Range-Operating: -55°C ~ +105°C

THIRD ANGLE PROJECTION	GENERAL TOLERANCES (UNLESS SPECIFIED)		APPROVE BY FRANK	DATE 28/JUN/13	PART NO. FDM1501-MODB1XXXXXC	ITEM NO. FDM1501-M0	 Building Technology Cornerstone
	DESIGN UNITS Inch (metric)	X.±.012(0.30) X.X±.008(0.20) X.XX±.006(0.15) X.XXX±.004(0.10)	X'±5' .X'±2' .XX'±1' .XXX'±0.5'	CHECKED BY JACOB	DATE 28/JUN/13	TITLE Machined pin D-SUB connector 90° Angle Male	
SCALE 5:1	SIZE A4	DRAWN BY CHERRY		DATE 28/JUN/13	THIS DRAWING CONTAINS INFORMATION THAT IS PROPRIETARY TO TXGA INDUSTRIAL ELECTRONICS(S.Z)CO.,LTD AND SHOULD NOT BE USED WITHOUT WRITTEN PERMISSION		

REV	LOCATIONS	DESCRIPTION	DATE	REVISER	APPD

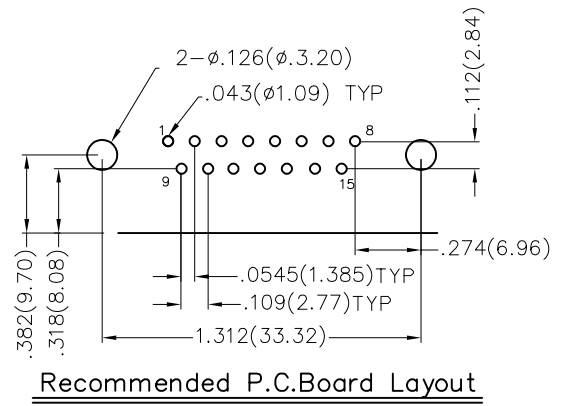
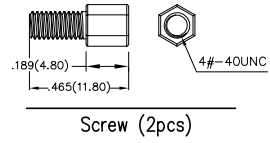
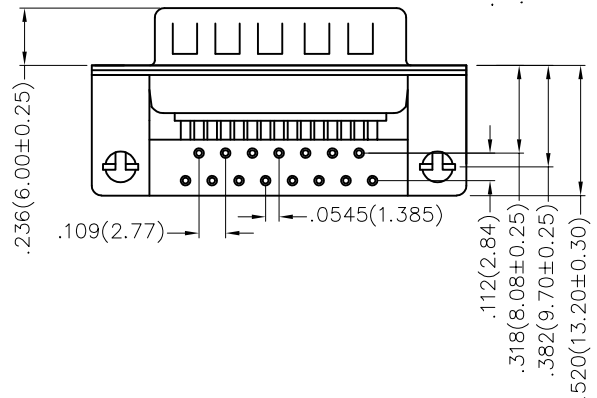
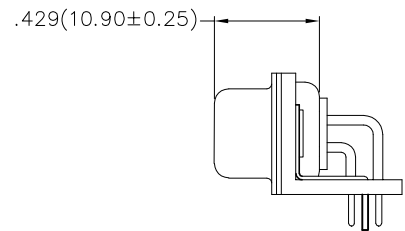
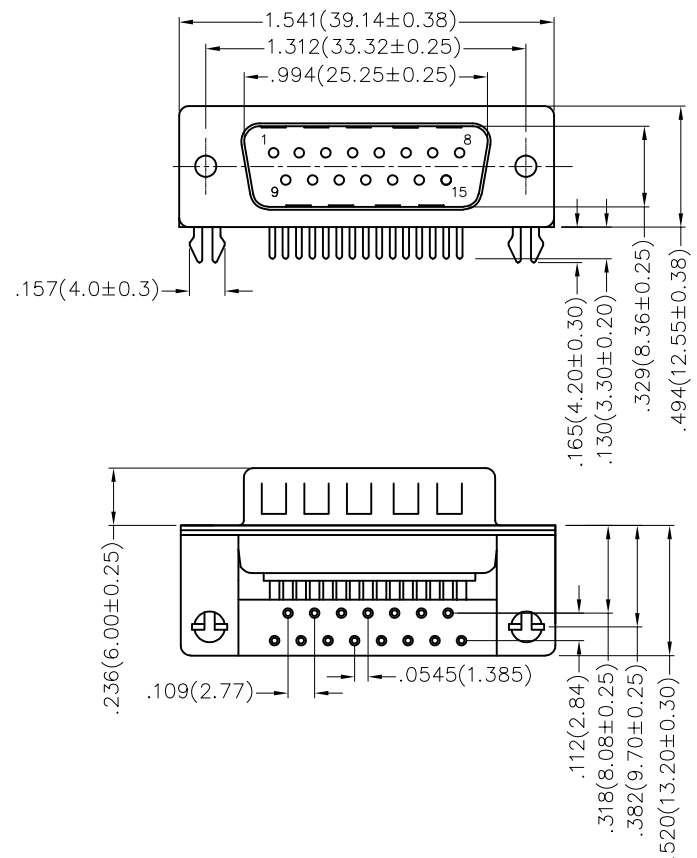

### Ordering Information

FDM 15 01 - M0 D B 1 XX XX X D  
 1 2 3 4 5 6 7 8 9 10 11

1   Category FDM-Machined pin D-SUB connector	2   Circuits 15	3   Distinction No. 01	4   Type M0-Male	5   Assembly Layout D-DIP	6   Entry Angle B-90° Angle
7   Plating 1-Gold Plated	8   Thickness of Plating 01-1μ" 03-3μ" Custom plate available	9   Color-Resin W1-White K6-Black	10   Packaging K-Tray L-Tube	11   Distinction Type D-D Type	

**Materials And Finish**  
 Shell: Spcc Material, Front Nickel Plated 80μ" Min  
 Back Shell: SPCC, Tin Plated 100μ" Min  
 Insulator: Glass Filled Thermoplastic, UL 94V-0  
 Contact Material: Brass /Gold Plated  
**Electrical Characteristic**  
 Current Rating: 7.5A  
 Voltage Rating: 300V  
 Contact Resistance: 5mΩ Max  
 Dielectric Withstanding Voltage :1000V AC r.m.s  
 Insulation Resistance: 5000 MΩ Min.  
 Temperature Range-Operating: -55°C ~ +105°C

THIRD ANGLE PROJECTION	GENERAL TOLERANCES (UNLESS SPECIFIED)		APPROVE BY FRANK	DATE 28/JUN/13	PART NO. FDM1501-MODB1XXXXXD	ITEM NO. FDM1501-M0	 Building Technology Cornerstone
	DESIGN UNITS Inch (metric)	X.±.012(0.30) X.X±.008(0.20) X.XX±.006(0.15) X.XXX±.004(0.10)	X:±5' .X'±2' .XX'±1' .XXX'±0.5'	CHECKED BY JACOB	DATE 28/JUN/13	TITLE Machined pin D-SUB connector 90° Angle Male	
SCALE 5:1	SIZE A4	DRAWN BY CHERRY		DATE 28/JUN/13	THIS DRAWING CONTAINS INFORMATION THAT IS PROPRIETARY TO TXGA INDUSTRIAL ELECTRONICS(S.Z)CO.,LTD AND SHOULD NOT BE USED WITHOUT WRITTEN PERMISSION		

REV	LOCATIONS	DESCRIPTION	DATE	REVISER	APPD

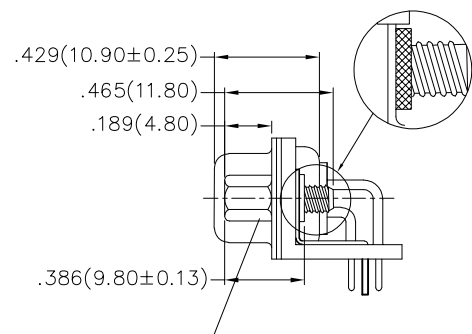
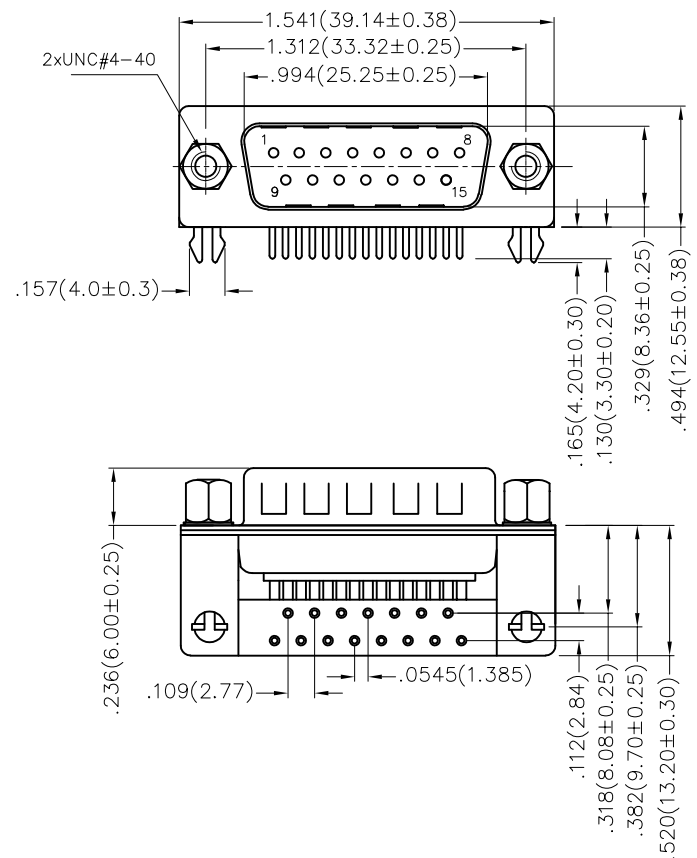

\* Notes:  
 Screws (Part No.: R-6AB-01A)  
 Salt spray: 48H  
 Torque force: 6kgf

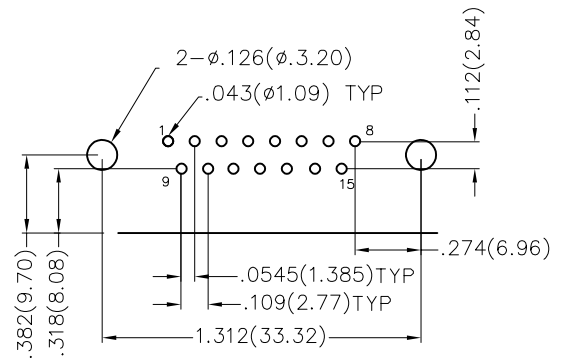

Recommended P.C.Board Layout

Materials And Finish  
 Shell: Spcc Material, Front Nickel Plated 80μ" Min  
 Back Shell: SPCC, Tin Plated 100μ" Min  
 Insulator: Glass Filled Thermoplastic, UL 94V-0  
 Contact Material: Brass /Gold Plated  
 Electrical Characteristic  
 Current Rating: 7.5A  
 Voltage Rating: 300V  
 Contact Resistance: 5mΩ Max  
 Dielectric Withstanding Voltage :1000V AC r.m.s  
 Insulation Resistance: 5000 MΩ Min.  
 Temperature Range-Operating: -55°C ~ +105°C

Ordering Information

FDM 15 01 - M0 D B 1 XX XX X E  
 1 2 3 4 5 6 7 8 9 10 11

1   Category FDM-Machined pin D-SUB connector	2   Circuits 15	3   Distinction No. 01	4   Type M0-Male	5   Assembly Layout D-DIP	6   Entry Angle B-90° Angle
7   Plating 1-Gold Plated	8   Thickness of Plating 01-1μ" 03-3μ" Custom plate available	9   Color-Resin W1-White K6-Black	10   Packaging K-Tray L-Tube	11   Distinction Type E-E Type	

THIRD ANGLE PROJECTION	GENERAL TOLERANCES (UNLESS SPECIFIED)		APPROVE BY FRANK	DATE 28/JUN/13	PART NO. FDM1501-MODB1XXXXXE	ITEM NO. FDM1501-M0	 Building Technology Cornerstone
	DESIGN UNITS Inch (metric)	X.±.012(0.30) X.X±.008(0.20) X.XX±.006(0.15) X.XXX±.004(0.10)	X:±5' .X'±2' .XX'±1' .XXX'±0.5'	CHECKED BY JACOB	DATE 28/JUN/13	TITLE Machined pin D-SUB connector 90° Angle Male	
SCALE 5:1	SIZE A4	DRAWN BY CHERRY		DATE 28/JUN/13	THIS DRAWING CONTAINS INFORMATION THAT IS PROPRIETARY TO TXGA INDUSTRIAL ELECTRONICS(S.Z)CO.,LTD AND SHOULD NOT BE USED WITHOUT WRITTEN PERMISSION		

REV	LOCATIONS	DESCRIPTION	DATE	REVISER	APPD
1	▲	Update dimensions and tolerances	11/DEC/24	MATT	LEO

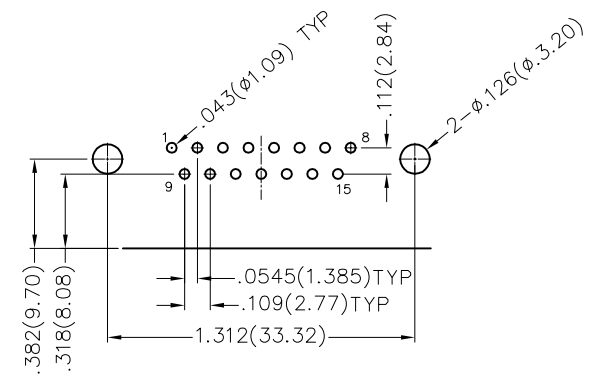
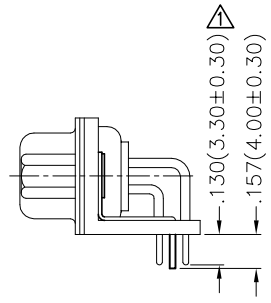
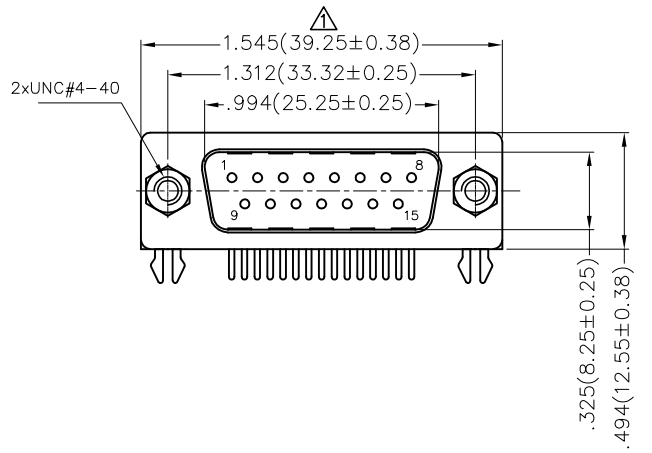

Recommended P.C Board Layout

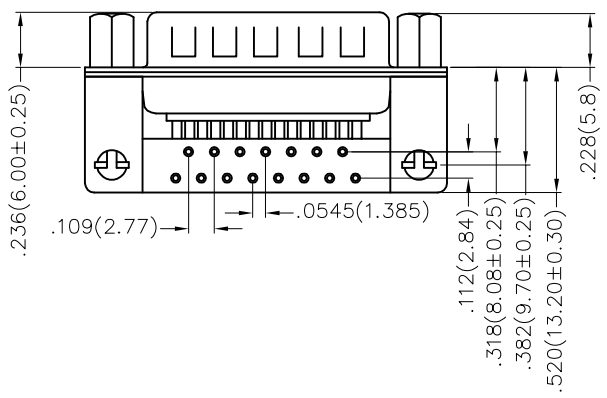

Ordering Information

FDM 15 01 - M0 D B 1 XX XX X F  
 1 2 3 4 5 6 7 8 9 10 11

1   Category FDM-Machined pin D-SUB connector	2   Circuits 15	3   Distinction No. 01	4   Type M0-Male	5   Assembly Layout D-DIP	6   Entry Angle B-90° Angle
7   Plating 1-Gold Plated	8   Thickness of Plating 01-1μ" 03-3μ" Custom plate available	9   Color-Resin W1-White K6-Black	10   Packaging K-Tray	11   Distinction Type F-F Type	

Materials And Finish  
 Shell: Spcc Material, Front Nickel Plated 80μ" Min  
 Back Shell: SPCC, Tin Plated 100μ" Min  
 Insulator: Glass Filled Thermoplastic, UL 94V-0  
 Contact Material: Brass /Gold Plated  
 Electrical Characteristic  
 Current Rating: 7.5A  
 Voltage Rating: 300V  
 Contact Resistance: 5mΩ Max  
 Dielectric Withstanding Voltage :1000V AC r.m.s  
 Insulation Resistance: 5000 MΩ Min.  
 Temperature Range-Operating: -55°C ~ +105°C

THIRD ANGLE PROJECTION	GENERAL TOLERANCES (UNLESS SPECIFIED)		APPROVE BY FRANK	DATE 01/DEC/23	PART NO. FDM1501-MODB1XXXXXF	ITEM NO. FDM1501-M0	 Building Technology Cornerstone
	DESIGN UNITS Inch (metric)	X.±.012(0.30) X.X±.008(0.20) X.XX±.006(0.15) X.XXX±.004(0.10)	X.±5' .X±2' .XX±1' .XXX±0.5'	CHECKED BY JACOB	DATE 01/DEC/23	TITLE Machined pin D-SUB connector 90° Angle Male	
SCALE 5:1	SIZE A4		DRAWN BY MATT	DATE 01/DEC/23	THIS DRAWING CONTAINS INFORMATION THAT IS PROPRIETARY TO TXGA INDUSTRIAL ELECTRONICS(S.Z)CO.,LTD AND SHOULD NOT BE USED WITHOUT WRITTEN PERMISSION		