

REV	LOCATIONS	DESCRIPTION	DATE	REVISER	APPD
1	△	Structure Change	2024.2.28	Cherry	KATE
2	△	Structure Change	2024.7.25	Cherry	KATE

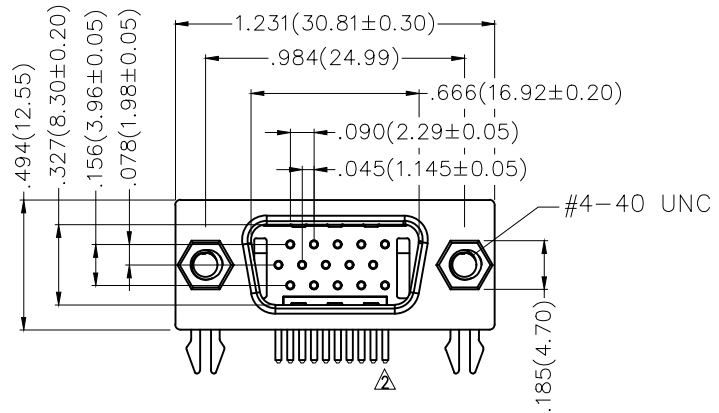

SPECIFICATION

Electrical
 Current Rating: 5A AC(rms)/DC
 Voltage Rating: 250V AC(rms)/DC
 Contact Resistance: 25 mΩ Max
 Insulation Resistance: 1000 MΩ MIN /DC 500V
 Withstanding Voltage: 500V AC r.m.s
 Temperature Range—Operating: -55°C~+105°C

Material and Plating
 Insulator: PBT+30% G.F (UL94V-0), Black △
 Contact: Phosphor bronze/ Gold plated △
 Shell: SPCC/ Tin plating over nickel

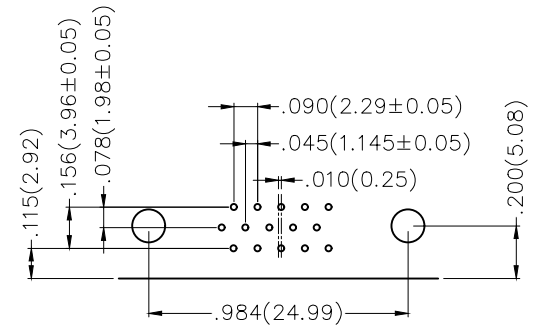
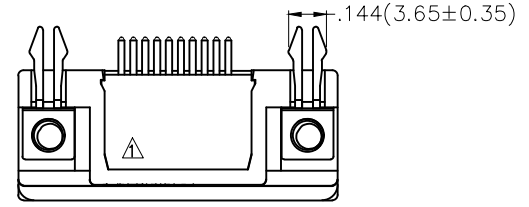
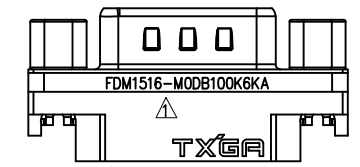
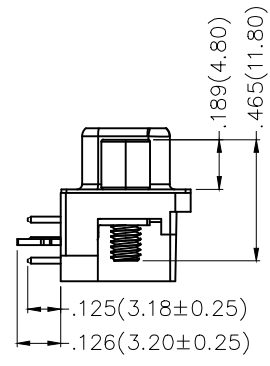
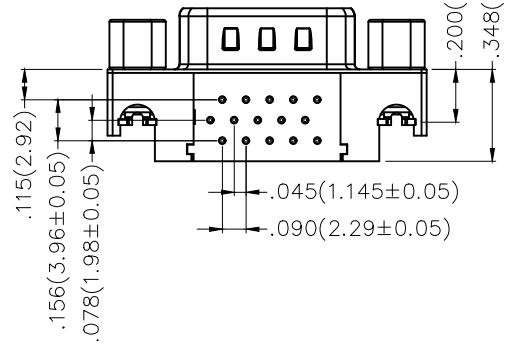
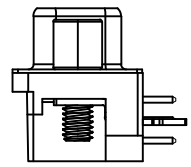

Recommended P.C.Board Layout
 General tolerances: ±.002(0.05)

<p>THIRD ANGLE PROJECTION</p>	GENERAL TOLERANCES (UNLESS SPECIFIED)		APPROVE BY	DATE	PART NO.	ITEM NO.	<p>Building Technology Cornerstone</p>
	X. ±0.30	X.' ±5'	LEO	14/FEB/23	FDM1516-M0DB100K6KA	FDM1516	
	DESIGN UNITS METRIC		CHECKED BY	DATE	TITLE		
	X.X ±0.20	X.X' ±2'	GISELLE	14/FEB/23	Machined pin D-SUB connector 90° Angle Male		
SCALE	SIZE	X.XX ±0.15	X.XX' ±1'	DRAWN BY	DATE	REV 2	
5:1	A4	X.XXX ±0.10	X.XXX' ±0.5'	CHERRY	14/FEB/23	SHEET NO. 1/1	
THIS DRAWING CONTAINS INFORMATION THAT IS PROPRIETARY TO TXGA INDUSTRIAL ELECTRONICS(S.Z)CO.,LTD AND SHOULD NOT BE USED WITHOUT WRITTEN PERMISSION							