

| REV | LOCATIONS | DESCRIPTION | DATE | REVISER | APPD |
|-----|-----------|------------------|-----------|---------|--------|
| 1 | △ | Size changes | 09/AUG/22 | MATT | CHERRY |
| 2 | △ | Add marking code | 13/Jan/25 | NICK | LEO |

Date Code

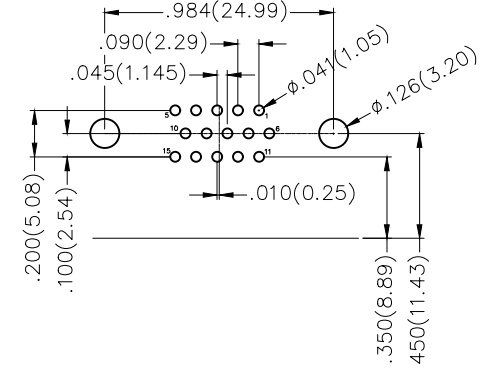

Recommended P.C. Board Layout

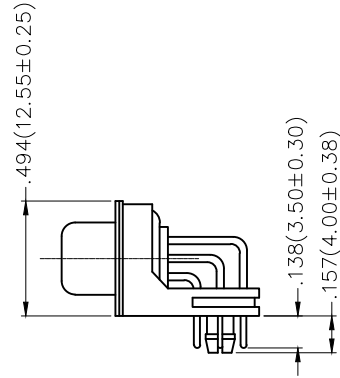
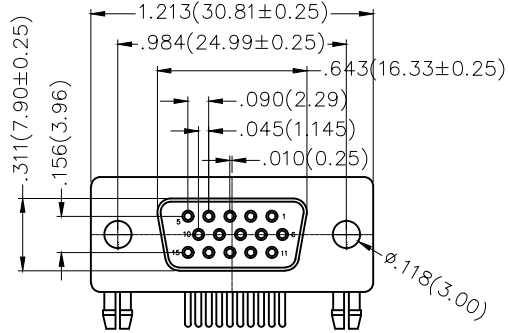
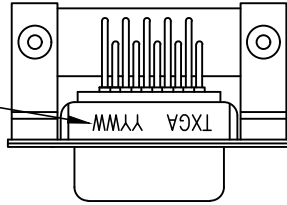
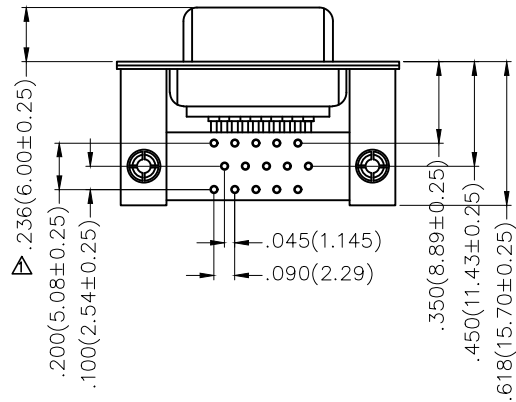

Ordering Information

FDM 15 25 — FO D B 1 XX XX X A
 1 2 3 4 5 6 7 8 9 10 11

| | | | | | | | | | | | |
|---|----------------------------------|---|---------------|---|--|---|----------------------|----|------------------|----|------------------|
| 1 | Category | 2 | Circuits | 3 | Distinction No. | 4 | Type | 5 | Assembly Layout | | |
| | FDM-Machined pin D-SUB connector | | 15 | | 25 | | FO-Female | | D-DIP | | |
| 6 | Entry Angle | 7 | Plating | 8 | Thickness of Plating | 9 | Color-Resin | 10 | Packaging | 11 | Distinction Type |
| | B-90° Angle | | 1-Gold Plated | | 01-1μ" 03-3μ" Custom plate available | | W1-White K6-Black | | K-Tray L-Tube | | A-A Type |

SPECIFICATION

Electrical

Current Rating: 5A
 Voltage Rating: 300V
 Contact resistance: 30mΩ Max
 Insulation resistance: 5000MΩ Min. at 500V DC
 Dielectric Withstanding Voltage :1000V AC r.m.s Min
 Temperature Range-Operating: -55°C ~ +105°C

Material and Plating

Insulator: PBT +30% G.F (UL94V-0)
 Contact: Brass/ Gold plated
 Shell: SPCC/ Front Nickel plated, Back Tin plated

| | | | | | | | |
|-------------------------------|--|-------------------------------------|---------------------|----------------------|---------------------------------|--|------------------------|
| THIRD ANGLE PROJECTION | GENERAL TOLERANCES (UNLESS SPECIFIED) | | APPROVE BY FRANK | DATE 09/SEP/19 | PART NO. FDM1525-F0DB1XXXXXA | ITEM NO. FDM1525 | Leader Of Industry |
| | DESIGN UNITS Inch (metric) | X.±.012(0.30) X.X±.008(0.20) | X.±5° .X±2° | CHECKED BY CHERRY | DATE 09/SEP/19 | TITLE Machined pin D-SUB connector 90° Angle Female | |
| SCALE 5:1 | SIZE A4 | X.XX±.006(0.15) X.XXX±.004(0.10) | .XX±1° .XXX±0.5° | DRAWN BY KATE | DATE 09/SEP/19 | THIS DRAWING CONTAINS INFORMATION THAT IS PROPRIETARY TO TXGA INDUSTRIAL ELECTRONICS(S.Z)CO.,LTD AND SHOULD NOT BE USED WITHOUT WRITTEN PERMISSION | |

REV 2 SHEET NO. 1/1

| REV | LOCATIONS | DESCRIPTION | DATE | REVISER | APPD |
|-----|-----------|------------------|-----------|---------|--------|
| 1 | △ | Size changes | 09/AUG/22 | MATT | CHERRY |
| 2 | △ | Add marking code | 13/Jan/25 | NICK | LEO |

Date Code

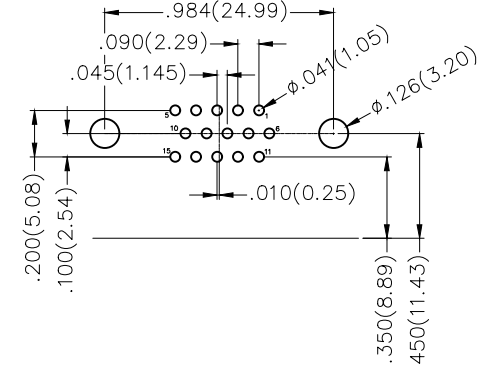
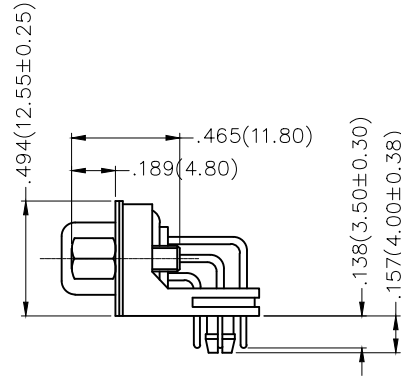
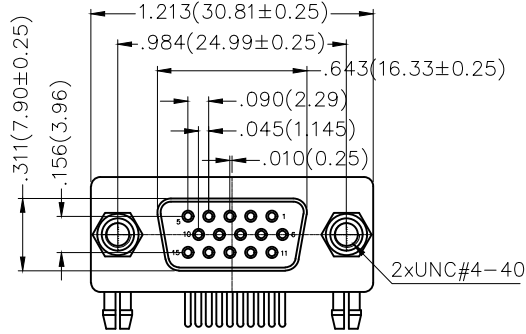
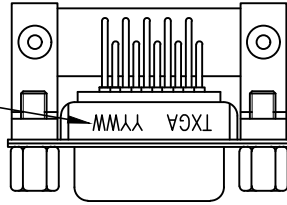

Recommended P.C.Board Layout

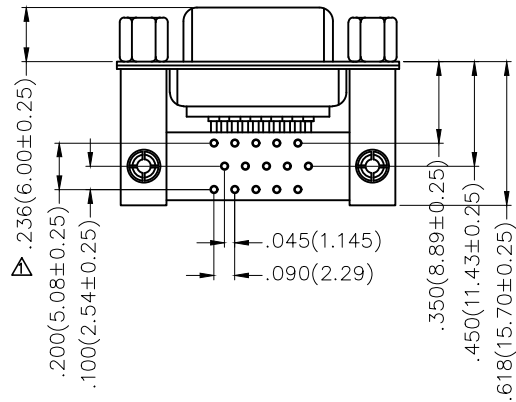

Ordering Information

FDM 15 25 — FO D B 1 XX XX X B
 1 2 3 4 5 6 7 8 9 10 11

| | | | | | | | | | | | |
|---|----------------------------------|---|---------------|---|--|---|----------------------|----|------------------|----|------------------|
| 1 | Category | 2 | Circuits | 3 | Distinction No. | 4 | Type | 5 | Assembly Layout | | |
| | FDM-Machined pin D-SUB connector | | 15 | | 25 | | FO-Female | | D-DIP | | |
| 6 | Entry Angle | 7 | Plating | 8 | Thickness of Plating | 9 | Color-Resin | 10 | Packaging | 11 | Distinction Type |
| | B-90° Angle | | 1-Gold Plated | | 01-1μ" 03-3μ" Custom plate available | | W1-White K6-Black | | K-Tray L-Tube | | B-B Type |

SPECIFICATION

Electrical

Current Rating: 5A
 Voltage Rating: 300V
 Contact resistance: 30mΩ Max
 Insulation resistance: 5000MΩ Min. at 500V DC
 Dielectric Withstanding Voltage :1000V AC r.m.s Min
 Temperature Range-Operating: -55°C ~ +105°C

Material and Plating

Insulator: PBT +30% G.F (UL94V-0)
 Contact: Brass/ Gold plated
 Shell: SPCC/ Front Nickel plated, Back Tin plated

| | | | | | | | | |
|-------------------------------|--|--|---|----------------------|--|---|------------------------|---------------|
| THIRD ANGLE PROJECTION | GENERAL TOLERANCES (UNLESS SPECIFIED) | | APPROVE BY FRANK | DATE 09/SEP/19 | PART NO. FDM1525-F0DB1XXXXXB | ITEM NO. FDM1525 | Leader Of Industry | |
| | DESIGN UNITS Inch (metric) | X.±.012(0.30) X.X±.008(0.20) X.XX±.006(0.15) X.XXX±.004(0.10) | X'.±5" .X'±2" .XX'±1" .XXX'±0.5" | CHECKED BY CHERRY | DATE 09/SEP/19 | TITLE Machined pin D-SUB connector 90° Angle Female | | |
| SCALE 5:1 | SIZE A4 | | DRAWN BY KATE | DATE 09/SEP/19 | THIS DRAWING CONTAINS INFORMATION THAT IS PROPRIETARY TO TXGA INDUSTRIAL ELECTRONICS(S.Z)CO.,LTD AND SHOULD NOT BE USED WITHOUT WRITTEN PERMISSION | | REV 2 | SHEET NO. 1/1 |

| REV | LOCATIONS | DESCRIPTION | DATE | REVISER | APPD |
|-----|-----------|------------------|-----------|---------|--------|
| 1 | △ | Size changes | 09/AUG/22 | MATT | CHERRY |
| 2 | △ | Add marking code | 13/Jan/25 | NICK | LEO |

Date Code

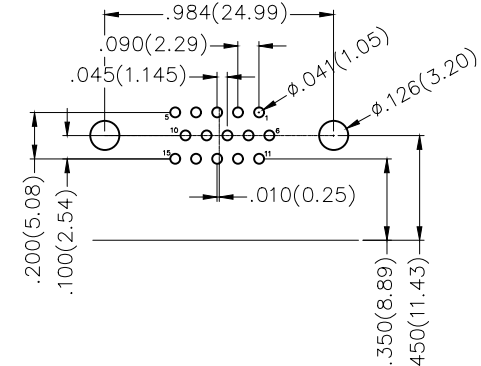
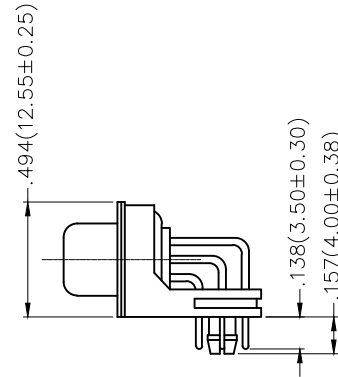
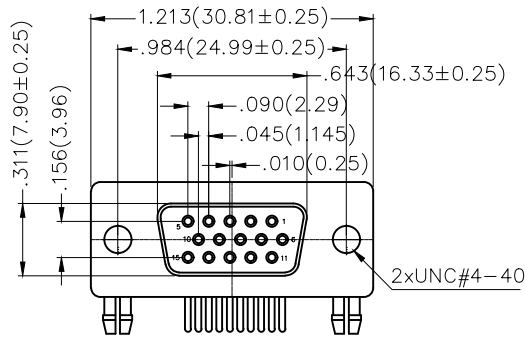
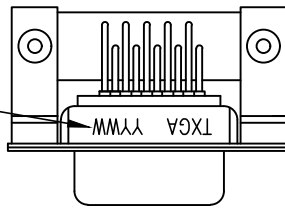

Recommended P.C.Board Layout

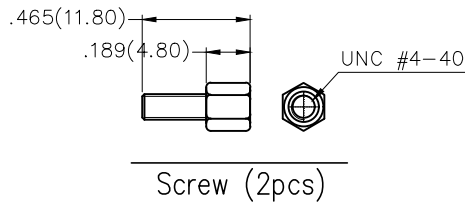

Screw (2pcs)

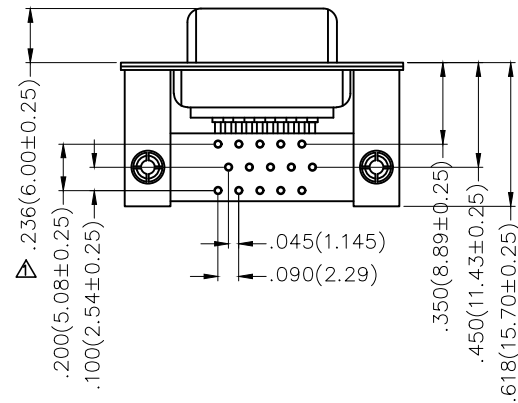

Ordering Information

FDM 15 25 — FO D B 1 XX XX X C
 1 2 3 4 5 6 7 8 9 10 11

| | | | | | | | | | | | |
|---|----------------------------------|---|---------------|---|--|---|----------------------|----|------------------|----|------------------|
| 1 | Category | 2 | Circuits | 3 | Distinction No. | 4 | Type | 5 | Assembly Layout | | |
| | FDM-Machined pin D-SUB connector | | 15 | | 25 | | FO-Female | | D-DIP | | |
| 6 | Entry Angle | 7 | Plating | 8 | Thickness of Plating | 9 | Color-Resin | 10 | Packaging | 11 | Distinction Type |
| | B-90° Angle | | 1-Gold Plated | | 01-1μ" 03-3μ" Custom plate available | | W1-White K6-Black | | K-Tray L-Tube | | C-C Type |

SPECIFICATION

Electrical

Current Rating: 5A
 Voltage Rating: 300V
 Contact resistance: 30mΩ Max
 Insulation resistance: 5000MΩ Min. at 500V DC
 Dielectric Withstanding Voltage :1000V AC r.m.s Min
 Temperature Range-Operating: -55°C ~ +105°C

Material and Plating

Insulator: PBT +30% G.F (UL94V-0)
 Contact: Brass/ Gold plated
 Shell: SPCC/ Front Nickel plated, Back Tin plated

| | | | | | | | | |
|-------------------------------|--|------------------|----------------------|-------------------|--|---------------------|------------------------|---------------|
| THIRD ANGLE PROJECTION | GENERAL TOLERANCES (UNLESS SPECIFIED) | | APPROVE BY FRANK | DATE 09/SEP/19 | PART NO. FDM1525-F0DB1XXXXXC | ITEM NO. FDM1525 | Leader Of Industry | |
| | X.±.012(0.30) | X.±5' | CHECKED BY CHERRY | DATE 09/SEP/19 | TITLE Machined pin D-SUB connector 90° Angle Female | | | |
| DESIGN UNITS Inch (metric) | X.X±.008(0.20) | .X'±2' | DRAWN BY KATE | DATE 09/SEP/19 | THIS DRAWING CONTAINS INFORMATION THAT IS PROPRIETARY TO TXGA INDUSTRIAL ELECTRONICS(S.Z)CO.,LTD AND SHOULD NOT BE USED WITHOUT WRITTEN PERMISSION | | REV 2 | SHEET NO. 1/1 |
| SCALE 5:1 | SIZE A4 | X.XX±.006(0.15) | | | | | | |
| | | X.XXX±.004(0.10) | | | | | | |