

REV	LOCATIONS	DESCRIPTION	DATE	REVISER	APPD

SPECIFICATIONS

Electrical
 Current Rating: 5.0A AC(rms)/DC
 Voltage Rating: 500V AC(rms)/DC
 Contact Resistance: 30 mΩ Max
 Insulation Resistance: 3000 MΩ Min
 Withstanding Voltage: 500V AC(rms)/DC
 Temperature Range—Operating: -55°C~+105°C

Material And Finished
 Insulator: PBT (UL 94V-0)
 Shell: SPCC/ Front Nickel plated, Back Tin plated
 Barrier: PA9T/ yellow
 Contacts: Brass/ Gold Plated
 Rivet: Copper alloy/ Nickel Plated
 Bracket: Copper alloy/ Nickel Plated
 Screw: Carbon steel/ Nickel Plated

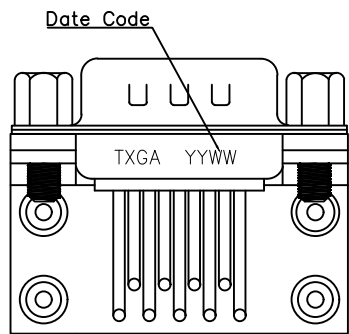
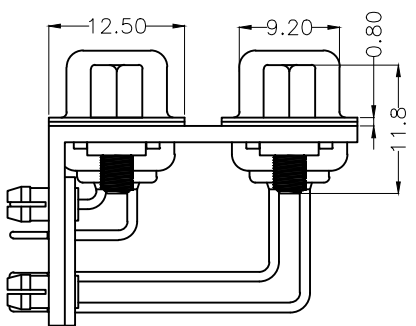
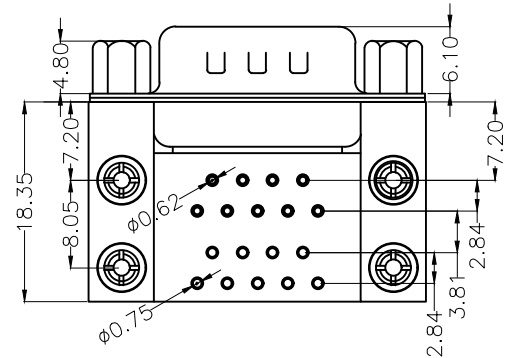
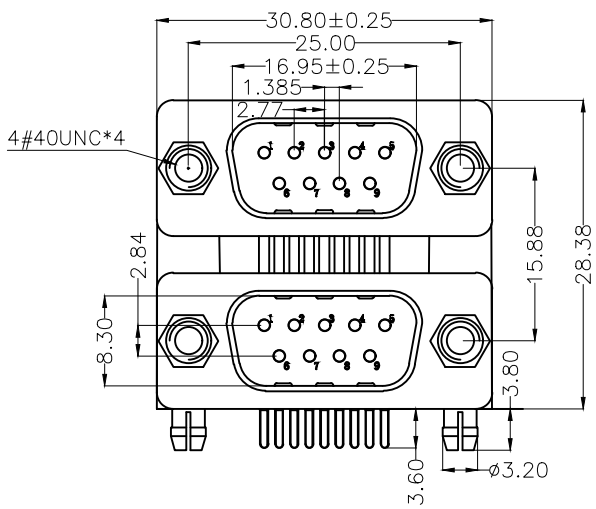

Ordering Information

FDM 18 01 — MM D B 1 XX XX K
 1 2 3 4 5 6 7 8 9 10

1 Category FDM—Machined pin D—SUB connector	2 Circuits 18	3 Distinction No. 01	4 Type MM—Male+Male	5 Assembly Layout D—DIP
6 Entry Angle B—90° Angle	7 Plating 1—Gold Plated	8 Thickness of Plating 02—2μ" 05—5μ" Custom plate available	9 Color—Resin BK—Black WH—White	10 Packaging K—Tray

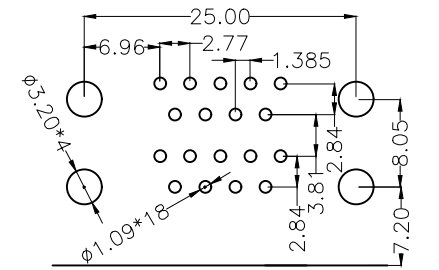

Recommended P.C. Board Layout

THIRD ANGLE PROJECTION	GENERAL TOLERANCES (UNLESS SPECIFIED)		APPROVE BY LEO	DATE 02/AUG/23	PART NO. FDM1801—MMDB1XXXXX	ITEM NO. FDM1801	 Building Technology Cornerstone
	X. ±0.30	X.* ±5°	CHECKED BY GISELLE	DATE 02/AUG/23	TITLE Machined pin D—SUB connector 9+9Circuits 90° Angle		
DESIGN UNITS METRIC	X.X ±0.20	X.X' ±2°	DRAWN BY NICK	DATE 02/AUG/23	THIS DRAWING CONTAINS INFORMATION THAT IS PROPRIETARY TO TXGA INDUSTRIAL ELECTRONICS(S.Z)CO.,LTD AND SHOULD NOT BE USED WITHOUT WRITTEN PERMISSION		
SCALE 5:1	SIZE A4	X.XX ±0.15	X.XX' ±1°				
		X.XXX ±0.10	X.XXX' ±0.5°				