

REV	LOCATIONS	DESCRIPTION	DATE	REVISER	APPD
1	▲	Add marking code	13/Jan/25	NICK	LEO

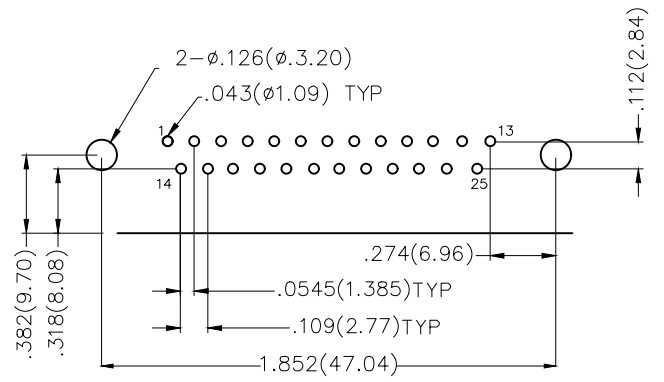
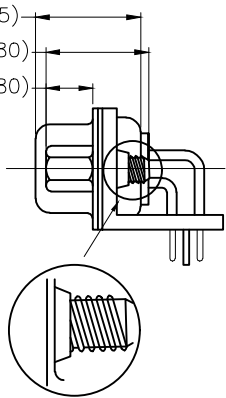
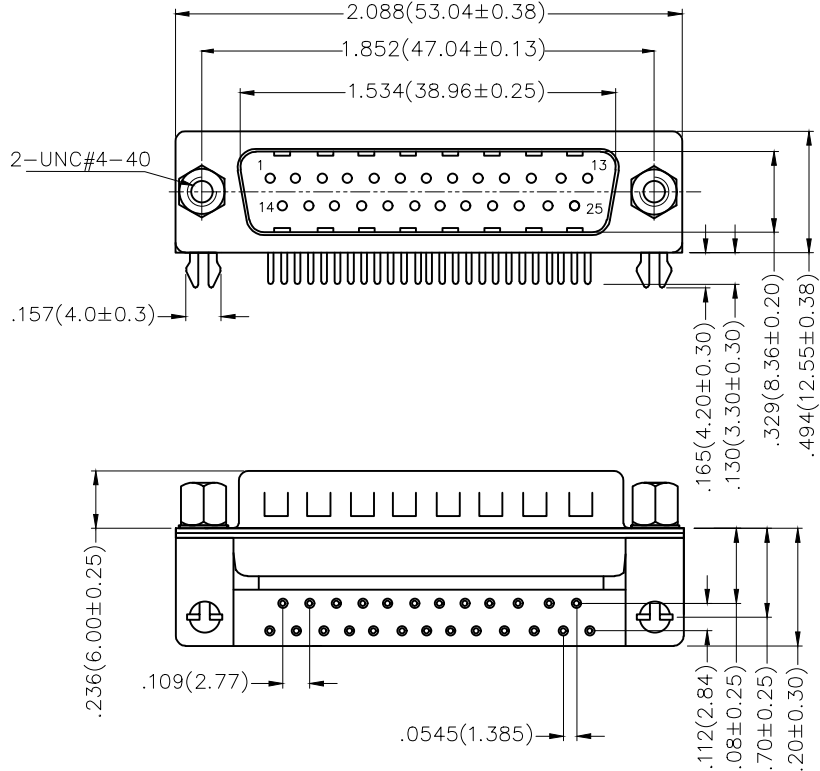
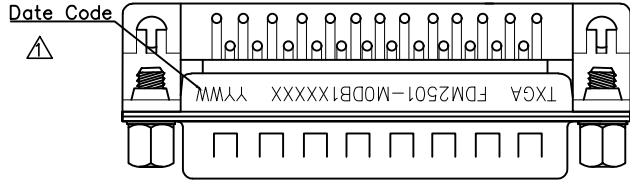

Recommended P.C. Board Layout

Ordering Information

FDM 25 01 - M0 D B 1 XX XX X
 1 2 3 4 5 6 7 8 9 10

1 Category FDM-Machined pin D-SUB connector	2 Circuits 25	3 Distinction No. 01	4 Type M0-Male	5 Assembly Layout D-DIP
6 Entry Angle B-90° Angle	7 Plating 1-Gold Plated	8 Thickness of Plating 01-1µ" 03-3µ" Custom plate available	9 Color-Resin K6-Black W1-White	10 Packaging K-Tray L-Lube

Materials And Finish
 Shell: Spcc Material, Front Nickel Plated 80µ" Min
 Back Shell: SPCC, Tin Plated 100µ" Min
 Insulator: Glass Filled Thermoplastic, UL 94V-0
 Contact Material: Brass /Gold Plated
 Electrical Characteristic
 Current Rating: 7.5A
 Voltage Rating: 300V
 Contact Resistance: 5mΩ Max
 Dielectric Withstanding Voltage :1000V AC r.m.s
 Insulation Resistance: 5000 MΩ Min.
 Temperature Range-Operating: -55°C ~ +105°C

 THIRD ANGLE PROJECTION DESIGN UNITS METRIC SCALE 5:1 SIZE A4	GENERAL TOLERANCES (UNLESS SPECIFIED)		APPROVE BY FRANK	DATE 28/JUN/13	PART NO. FDM2501-MODB1XXXXX	ITEM NO. FDM2501-M0	 Building Technology Cornerstone
	X. ±.012(0.30)	X.* ±5°	CHECKED BY JACOB	DATE 28/JUN/13	TITLE Machined pin D-SUB connector 90° Angle Male		
	X.XX ±.0008(0.15)	X.XX* ±1°	DRAWN BY CHERRY	DATE 28/JUN/13	THIS DRAWING CONTAINS INFORMATION THAT IS PROPRIETARY TO TXGA INDUSTRIAL ELECTRONICS(S.Z)CO.,LTD AND SHOULD NOT BE USED WITHOUT WRITTEN PERMISSION		
	X.XXX ±.004(0.10)	X.XXX* ±0.5°					

REV	LOCATIONS	DESCRIPTION	DATE	REVISER	APPD
1	△	Add marking code	13/Jan/25	NICK	LEO

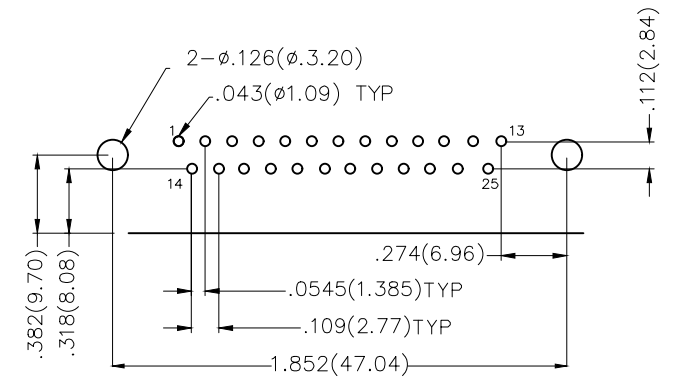
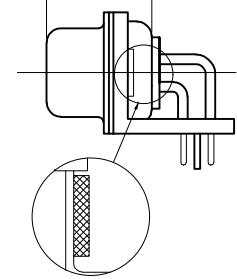
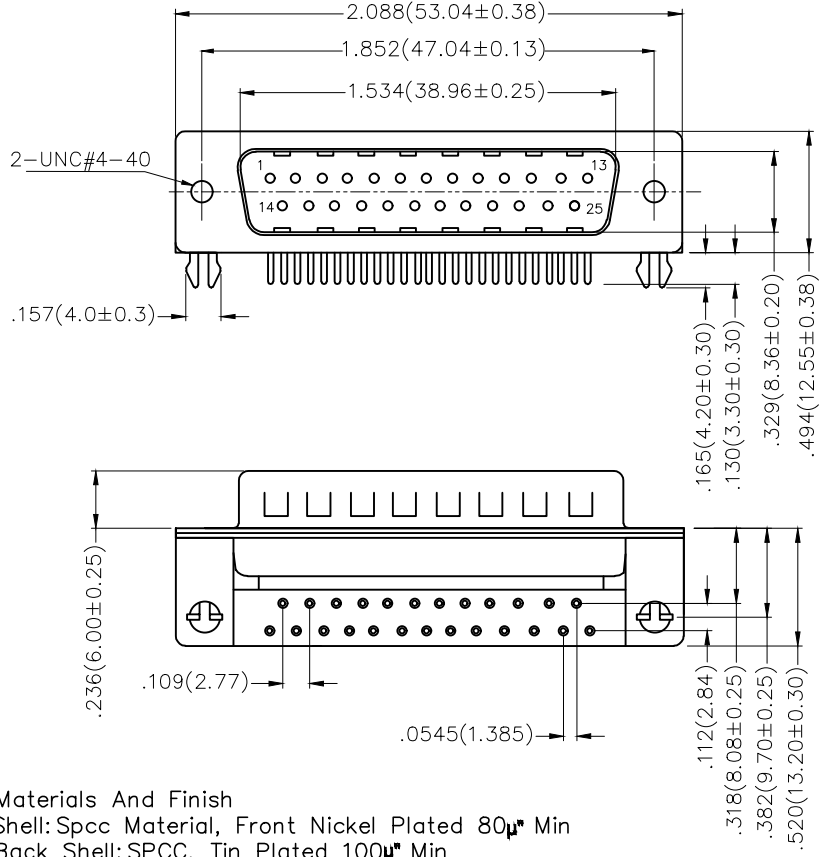
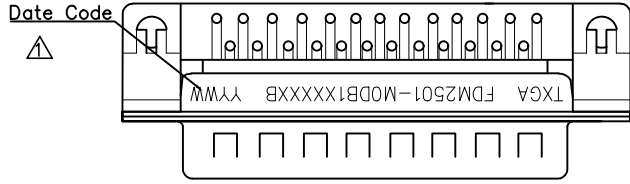

Recommended P.C.Board Layout

Ordering Information

FDM 25 01 - M0 D B 1 XX XX X B
 1 2 3 4 5 6 7 8 9 10 11

1 Category FDM-Machined pin D-SUB connector	2 Circuits 25	3 Distinction No. 01	4 Type MO-Male	5 Assembly Layout D-DIP	
6 Entry Angle B-90° Angle	7 Plating 1-Gold Plated	8 Thickness of Plating 01-1μ" 03-3μ" Custom plate available	9 Color-Resin K6-Black W1-White	10 Packaging K-Tray L-Lube	11 Distinction Type B-Type B

Materials And Finish
 Shell: Spcc Material, Front Nickel Plated 80μ^m Min
 Back Shell: SPCC, Tin Plated 100μ^m Min
 Insulator: Glass Filled Thermoplastic, UL 94V-0
 Contact Material: Brass /Gold Plated
 Electrical Characteristic
 Current Rating: 7.5A
 Voltage Rating: 300V
 Contact Resistance: 5mΩ Max
 Dielectric Withstanding Voltage :1000V AC r.m.s
 Insulation Resistance: 5000 MΩ Min.
 Temperature Range-Operating: -55°C ~ +105°C

THIRD ANGLE PROJECTION		GENERAL TOLERANCES (UNLESS SPECIFIED)		APPROVE BY	DATE	PART NO.	ITEM NO.	TXGA Building Technology Cornerstone
SCALE 5:1	SIZE A4	X. ±.012(0.30)	X.* ±5°	FRANK	28/JUN/13	FDM2501-MODB1XXXXXB	FDM2501-MO	
		X.X ±.008(0.20)	X.X* ±2°	CHECKED BY	DATE	TITLE Machined pin D-SUB connector 90° Angle Male		
		X.XX ±.0006(0.15)	X.XX* ±1°	JACOB	28/JUN/13	THIS DRAWING CONTAINS INFORMATION THAT IS PROPRIETARY TO TXGA INDUSTRIAL ELECTRONICS(S.Z)CO.,LTD AND SHOULD NOT BE USED WITHOUT WRITTEN PERMISSION		
		X.XXX ±.004(0.10)	X.XXX* ±0.5°	DRAWN BY	DATE			
				CHERRY	28/JUN/13			

REV	LOCATIONS	DESCRIPTION	DATE	REVISER	APPD
1		Size change	30/MAY/22	MATT	CHERRY
2		Add marking code	13/Jan/25	NICK	LEO

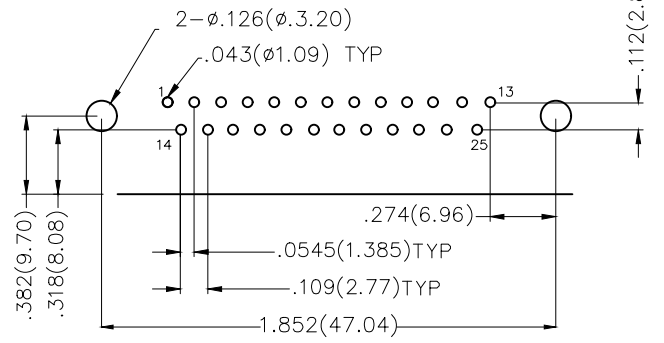
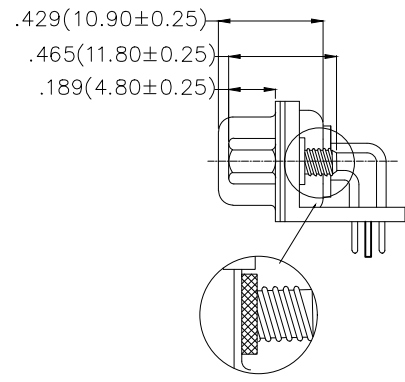
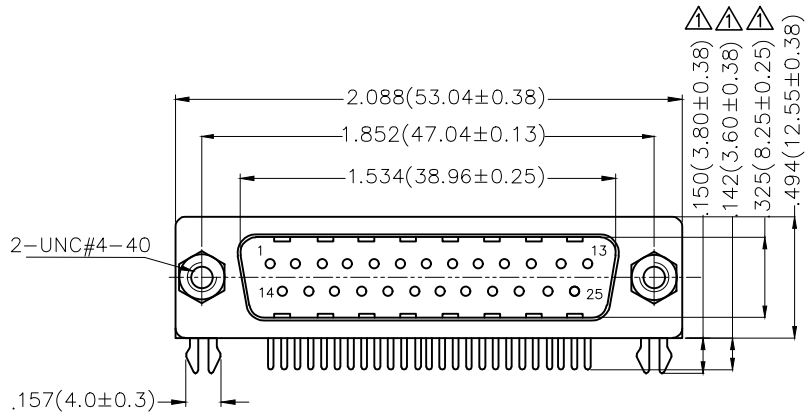
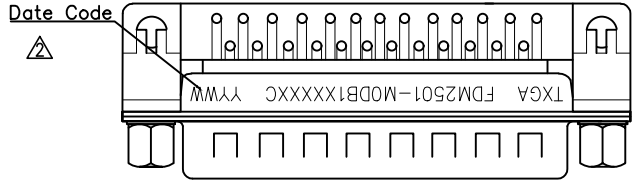

Recommended P.C. Board Layout

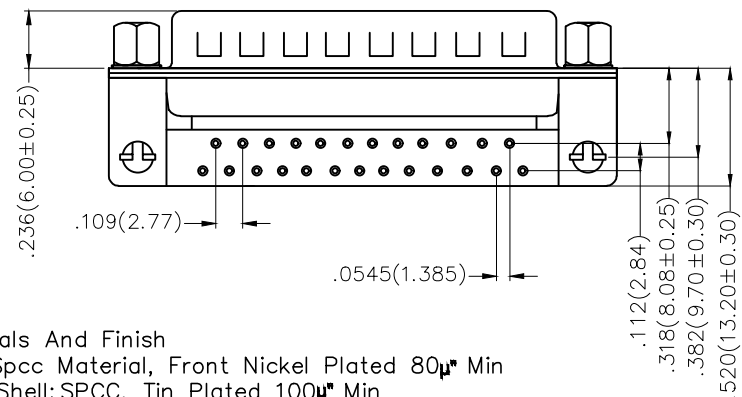

Ordering Information

FDM 25 01 - M0 D B 1 XX XX X C
 1 2 3 4 5 6 7 8 9 10 11

1 Category FDM-Machined pin D-SUB connector	2 Circuits 25	3 Distinction No. 01	4 Type MO-Male	5 Assembly Layout D-DIP
6 Entry Angle B-90° Angle	7 Plating 1-Gold Plated	8 Thickness of Plating 01-1μ" 03-3μ" Custom plate available	9 Color-Resin K6-Black W1-White	10 Packaging K-Tray L-Lube
11 Distinction Type C-Type C				

Materials And Finish
 Shell: Spcc Material, Front Nickel Plated 80μ^m Min
 Back Shell: SPCC, Tin Plated 100μ^m Min
 Insulator: Glass Filled Thermoplastic, UL 94V-0
 Contact Material: Brass /Gold Plated
 Electrical Characteristic
 Current Rating: 7.5A
 Voltage Rating: 300V
 Contact Resistance: 5mΩ Max
 Dielectric Withstanding Voltage :1000V AC r.m.s
 Insulation Resistance: 5000 MΩ Min.
 Temperature Range-Operating: -55°C ~ +105°C

THIRD ANGLE PROJECTION		GENERAL TOLERANCES (UNLESS SPECIFIED)		APPROVE BY	DATE	PART NO.	ITEM NO.	TXGA Building Technology Cornerstone
DESIGN UNITS METRIC	X. ±.012(0.30)	X.* ±5°	CHECKED BY	FRANK	28/JUN/13	FDM2501-MODB1XXXXXC	FDM2501-MO	
	X.X ±.008(0.20)	X.X* ±2°	JACOB		28/JUN/13	TITLE Machined pin D-SUB connector 90° Angle Male		
SCALE 5:1	X.XX ±.006(0.15)	X.XX* ±1°	DRAWN BY	CHERRY	DATE	THIS DRAWING CONTAINS INFORMATION THAT IS PROPRIETARY TO TXGA INDUSTRIAL ELECTRONICS(S.Z)CO.,LTD AND SHOULD NOT BE USED WITHOUT WRITTEN PERMISSION		
	X.XXX ±.004(0.10)	X.XXX* ±0.5°			28/JUN/13			

REV	LOCATIONS	DESCRIPTION	DATE	REVISER	APPD
1	▲	Add marking code	13/Jan/25	NICK	LEO

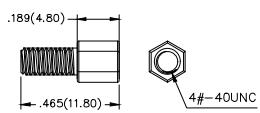
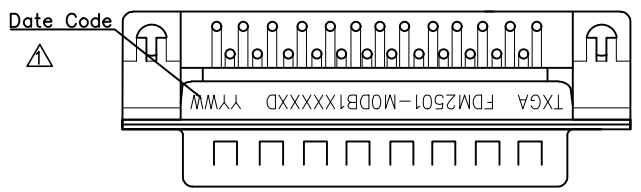

Screw (2pcs)

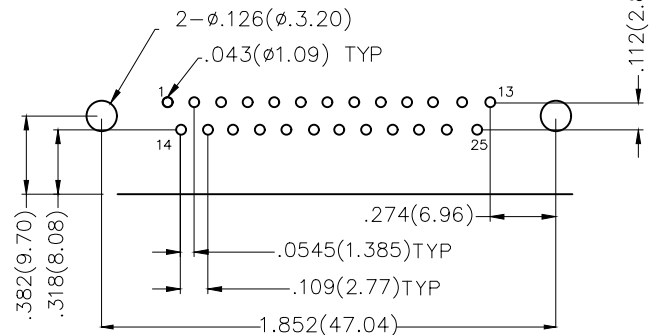
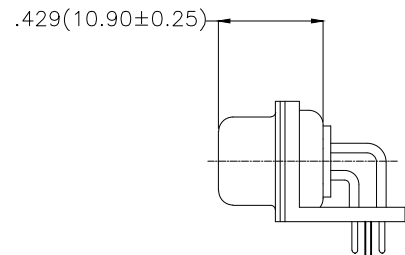
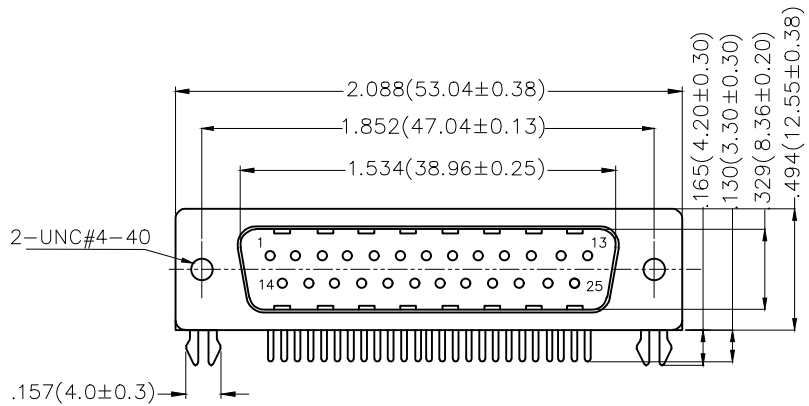

Recommended P.C. Board Layout

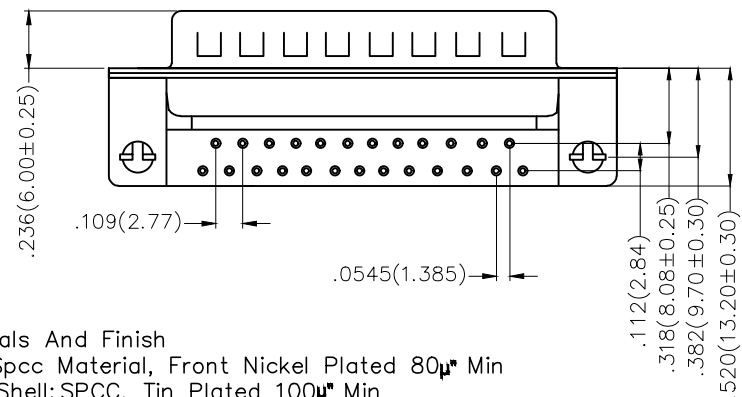

Ordering Information

FDM 25 01 - M0 D B 1 XX XX X D
 1 2 3 4 5 6 7 8 9 10 11

1	Category	2	Circuits	3	Distinction No.	4	Type	5	Assembly Layout		
	FDM-Machined pin D-SUB connector		25		01		MO-Male		D-DIP		
6	Entry Angle	7	Plating	8	Thickness of Plating	9	Color-Resin	10	Packaging	11	Distinction Type
	B-90° Angle		1-Gold Plated		01-1μ" 03-3μ" Custom plate available		K6-Black W1-White		K-Tray L-Lube		D-Type D

Materials And Finish
 Shell: Spcc Material, Front Nickel Plated 80μ^m Min
 Back Shell: SPCC, Tin Plated 100μ^m Min
 Insulator: Glass Filled Thermoplastic, UL 94V-0
 Contact Material: Brass /Gold Plated
 Electrical Characteristic
 Current Rating: 7.5A
 Voltage Rating: 300V
 Contact Resistance: 5mΩ Max
 Dielectric Withstanding Voltage :1000V AC r.m.s
 Insulation Resistance: 5000 MΩ Min.
 Temperature Range-Operating: -55°C ~ +105°C

THIRD ANGLE PROJECTION		GENERAL TOLERANCES (UNLESS SPECIFIED)		APPROVE BY	DATE	PART NO.	ITEM NO.	TXGA Building Technology Cornerstone
		X. ±0.12(0.30)	X.* ±5°	FRANK	28/JUN/13	FDM2501-M0DB1XXXXXD	FDM2501-M0	
DESIGN UNITS		X.X ±0.008(0.20)	X.X* ±2°	CHECKED BY	DATE	TITLE		REV 1 SHEET NO. 1/1
METRIC		X.XX ±0.0006(0.15)	X.XX* ±1°	JACOB	28/JUN/13	Machined pin D-SUB connector 90° Angle Male		
SCALE	SIZE	X.XXX ±0.004(0.10)	X.XXX* ±0.5°	DRAWN BY	DATE	THIS DRAWING CONTAINS INFORMATION THAT IS PROPRIETARY TO TXGA INDUSTRIAL ELECTRONICS(S.Z)CO.,LTD AND SHOULD NOT BE USED WITHOUT WRITTEN PERMISSION		
5:1	A4			CHERRY	28/JUN/13			

REV	LOCATIONS	DESCRIPTION	DATE	REVISER	APPD
1	△	Add marking code	13/Jan/25	NICK	LEO

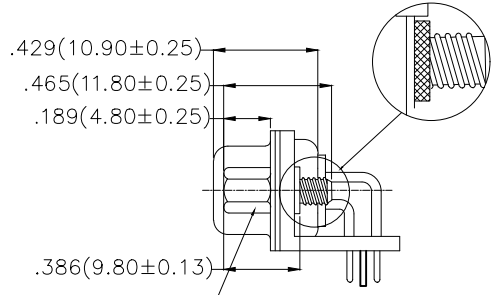
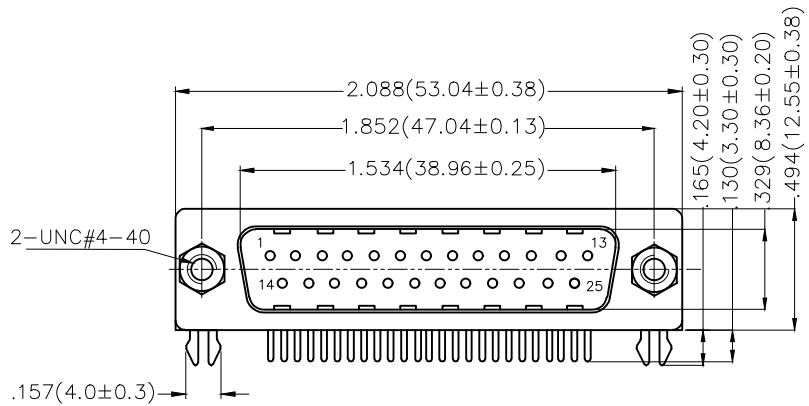
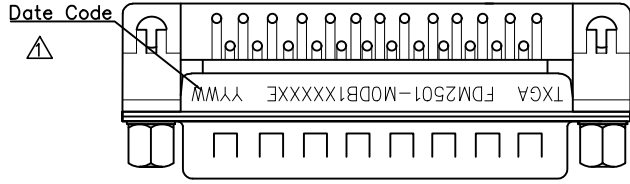

* Notes:
Screws (Part No.: R-6AB-01A)
Salt spray: 48H
Torque force: 6kgf

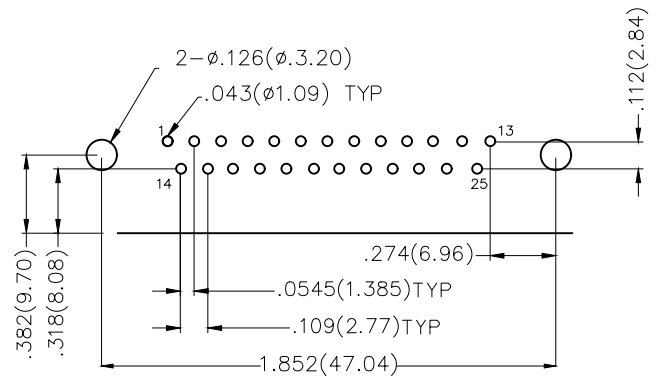

Recommended P.C. Board Layout

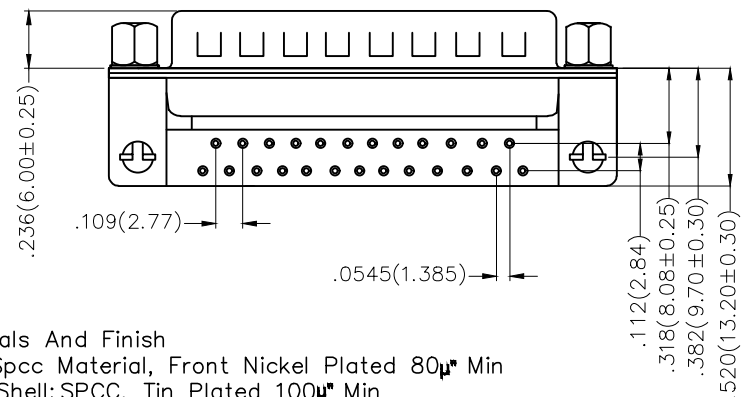

Ordering Information

FDM 25 01 - M0 D B 1 XX XX X E
1 2 3 4 5 6 7 8 9 10 11

1 Category FDM-Machined pin D-SUB connector	2 Circuits 25	3 Distinction No. 01	4 Type MO-Male	5 Assembly Layout D-DIP
6 Entry Angle B-90° Angle	7 Plating 1-Gold Plated	8 Thickness of Plating 01-1μ" 03-3μ" Custom plate available	9 Color-Resin K6-Black W1-White	10 Packaging K-Tray L-Lube
11 Distinction Type E-Type E				

Materials And Finish
Shell: Spcc Material, Front Nickel Plated 80μ^m Min
Back Shell: SPCC, Tin Plated 100μ^m Min
Insulator: Glass Filled Thermoplastic, UL 94V-0
Contact Material: Brass /Gold Plated
Electrical Characteristic
Current Rating: 7.5A
Voltage Rating: 300V
Contact Resistance: 5mΩ Max
Dielectric Withstanding Voltage :1000V AC r.m.s
Insulation Resistance: 5000 MΩ Min.
Temperature Range-Operating: -55°C ~ +105°C

THIRD ANGLE PROJECTION		GENERAL TOLERANCES (UNLESS SPECIFIED)		APPROVE BY	DATE	PART NO.	ITEM NO.	TXGA Building Technology Cornerstone	
DESIGN UNITS METRIC	X. ±0.12(0.30)	X.* ±5°	CHECKED BY	FRANK	28/JUN/13	FDM2501-MODB1XXXXXE	FDM2501-MO		
	X.X ±.008(0.20)	X.X* ±2°	JACOB		28/JUN/13	TITLE Machined pin D-SUB connector 90° Angle Male			
SCALE 5:1	SIZE A4	X.XX ±.0006(0.15)	X.XX* ±1°	DRAWN BY	DATE	THIS DRAWING CONTAINS INFORMATION THAT IS PROPRIETARY TO TXGA INDUSTRIAL ELECTRONICS(S.Z)CO.,LTD AND SHOULD NOT BE USED WITHOUT WRITTEN PERMISSION		REV 1	SHEET NO. 1/1
		X.XXX ±.004(0.10)	X.XXX* ±0.5°	CHERRY	28/JUN/13				

REV	LOCATIONS	DESCRIPTION	DATE	REVISER	APPD
1	△	Add marking code	13/Jan/25	NICK	LEO

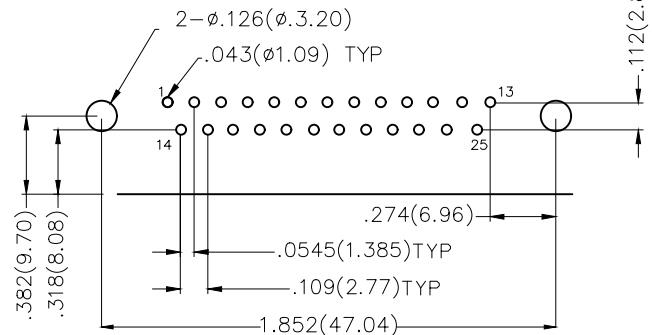
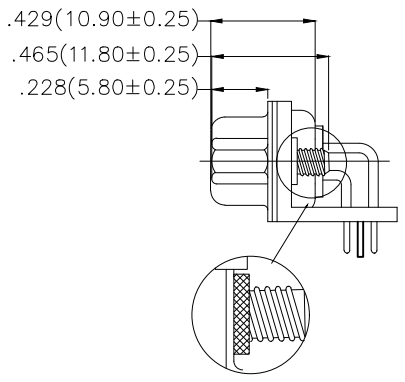
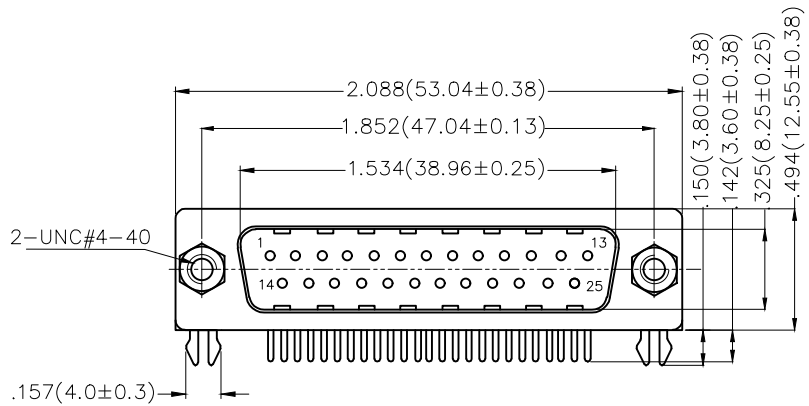
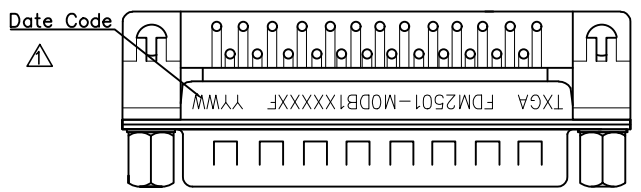

Recommended P.C. Board Layout

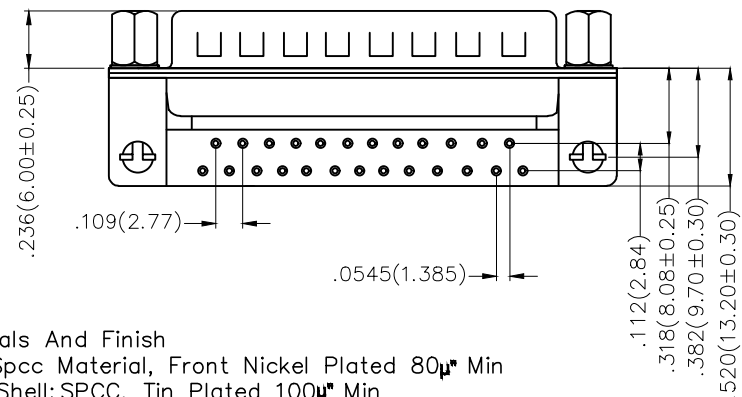

Ordering Information

FDM 25 01 - M O D B 1 XX XX X F
 1 2 3 4 5 6 7 8 9 10 11

1 Category FDM-Machined pin D-SUB connector	2 Circuits 25	3 Distinction No. 01	4 Type MO-Male	5 Assembly Layout D-DIP
6 Entry Angle B-90° Angle	7 Plating 1-Gold Plated	8 Thickness of Plating 01-1μ" 03-3μ" Custom plate available	9 Color-Resin K6-Black W1-White	10 Packaging K-Tray L-Lube
11 Distinction Type F-Type F				

Materials And Finish
 Shell: Spcc Material, Front Nickel Plated 80μ^m Min
 Back Shell: SPCC, Tin Plated 100μ^m Min
 Insulator: Glass Filled Thermoplastic, UL 94V-0
 Contact Material: Brass /Gold Plated
 Electrical Characteristic
 Current Rating: 7.5A
 Voltage Rating: 300V
 Contact Resistance: 5mΩ Max
 Dielectric Withstanding Voltage :1000V AC r.m.s
 Insulation Resistance: 5000 MΩ Min.
 Temperature Range-Operating: -55°C ~ +105°C

THIRD ANGLE PROJECTION		GENERAL TOLERANCES (UNLESS SPECIFIED)		APPROVE BY	DATE	PART NO.	ITEM NO.	TXGA Building Technology Cornerstone
DESIGN UNITS METRIC	X. ±0.12(0.30)	X.* ±5°	CHECKED BY	FRANK	28/JUN/13	FDM2501-MODB1XXXXXF	FDM2501-MO	
	X.X ±0.008(0.20)	X.X* ±2°	JACOB		28/JUN/13	TITLE Machined pin D-SUB connector 90° Angle Male		
	X.XX ±0.0006(0.15)	X.XX* ±1°	DRAWN BY	NICK	28/JUN/13	THIS DRAWING CONTAINS INFORMATION THAT IS PROPRIETARY TO TXGA INDUSTRIAL ELECTRONICS(S.Z)CO.,LTD AND SHOULD NOT BE USED WITHOUT WRITTEN PERMISSION		
SCALE 5:1	SIZE A4	X.XXX ±0.004(0.10)	X.XXX* ±0.5°					