

1 2 3 4 5 6 7 8

REV	LOCATIONS	DESCRIPTION	DATE	REVISER	APPD
1	△	Size & Tolerance changes	08/JUN/22	MATT	CHERRY

SPECIFICATIONS

Electrical Characteristic
 Current Rating: 10 to 40A (Power contacts)
 Voltage Rating: 300V
 Contact Resistance: 5mΩ Max.
 Insulation Resistance: 5000 MΩ Min.
 Dielectric Withstanding Voltage: 1000V AC r.m.s Min
 Temperature Range-Operating: -55°C ~ +105°C

Material and plating
 Shell: Steel, Nickel Plated 80μ" Min
 Back Shell: Steel, Tin Plated 100μ" Min
 Insulator: Glass Filled Thermoplastic (UL 94V-0)
 Power Contacts: Brass/ Gold Plated

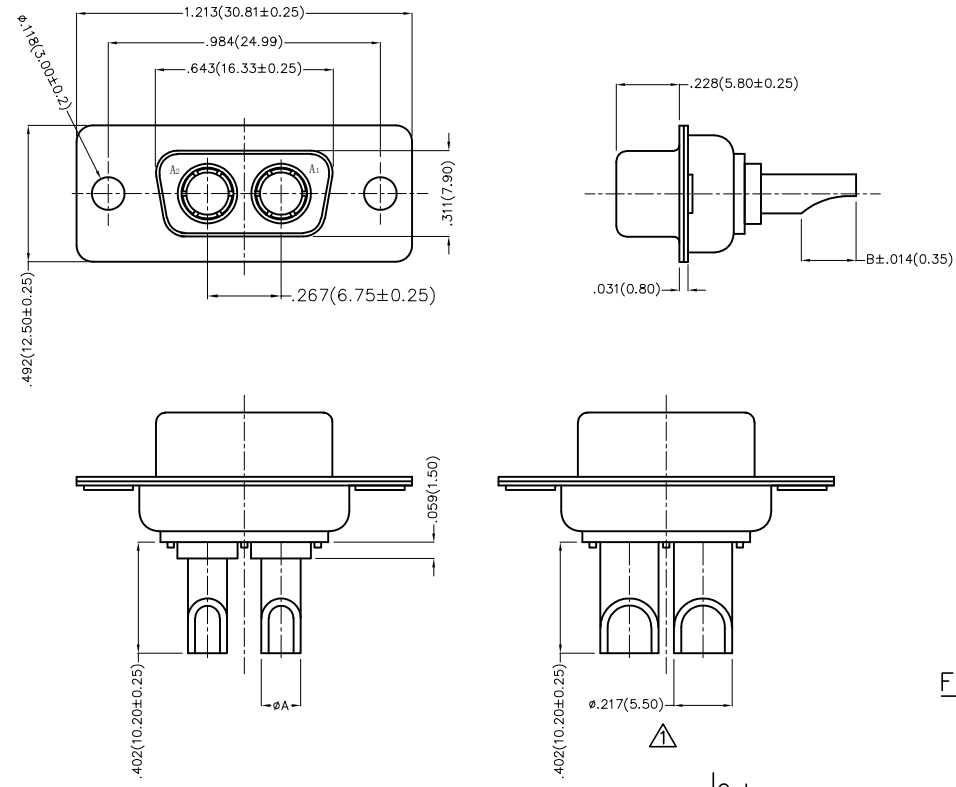

Type	Part NO.	A	B △	Wire	Current Rating(A)
A	FDPO201-FOWS1XXK6KA	φ.098(2.50)	.177(4.50)	14#~16#	10
B	FDPO201-FOWS1XXK6KB	φ.142(3.60)	.197(5.00)	10#~12#	20
C	FDPO201-FOWS1XXK6KC	φ.173(4.40)	.217(5.50)	8#~10#	30
D	FDPO201-FOWS1XXK6KD	φ.217(5.50)	.217(5.50)	6#~8#	40

Ordering Information

FDP 02 01 — F0 W S 1 XX K6 K X
 1 2 3 4 5 6 7 8 9 10 11

1 Category FDP-Hight current D-SUB connector	2 Circuits 02-2W2	3 Distinction No. 01	4 Type FO-Female	5 Assembly Layout W-Welding Type
6 Entry Angle S-180° Vertical	7 Plating 1-Gold Plated	8 Thickness of Plating 03-3μ" 15-15μ" Custom Plate Available	9 Color-Resin K6-Black	10 Packaging K-Tray
			11 Distinction Type A-Type A B-Type B C-Type C D-Type D	

<p>THIRD ANGLE PROJECTION</p>	GENERAL TOLERANCES (UNLESS SPECIFIED)		APPROVE BY FRANK	DATE 19/JUL/13	PART NO. FDPO201-FOWS1XXK6KX	ITEM NO. FDPO201-F	<p>Leader Of Industry</p>	
	X.±.012(0.30)	X.±5'	CHECKED BY CHERRY	DATE 19/JUL/13	TITLE Hight current D-SUB connector 2W2 180° Vertical Female			REV 0
	X.X±.008(0.20)	.X±2'	DRAWN BY JACOB	DATE 19/JUL/13	THIS DRAWING CONTAINS INFORMATION THAT IS PROPRIETARY TO TXGA INDUSTRIAL ELECTRONICS(S.Z)CO.,LTD AND SHOULD NOT BE USED WITHOUT WRITTEN PERMISSION			SHEET NO. 1/1
	X.XX±.006(0.15)	.XX±1'						
SCALE 5:1	SIZE A4	X.XXX±.004(0.10)	.XX±0.5'					

1 2 3 4 5 6 7 8