

REV	LOCATIONS	DESCRIPTION	DATE	REVISER	APPD

**SPECIFICATIONS**

**Electrical Characteristic**  
**Current Rating:**  
 Signal contacts: 5A  
 Power contacts: 10 to 40A  
**Voltage Rating:** 300V  
**Contact Resistance:** 5mΩ Max.  
**Insulation Resistance:** 5000 MΩ Min.  
**Dielectric Withstanding Voltage:** 1000V AC r.m.s Min  
**Temperature Range-Operating:** -55°C ~ +105°C

**Material and plating**  
 Shell: Steel, Nickel Plated 80μ" Min  
 Back Shell: Steel, Tin Plated 100μ" Min  
 Insulator: PBT (UL 94V-0)  
 Signal contacts: Brass/ Gold Plated  
 Power Contacts: Brass/ Gold Plated  
 Board Lock: Copper Alloy/ Tin Plated  
 Screws: Steel/Nickel Plated  
 Salt spray : 24H Min.

Type	Part NO.	øA	PCB. øB	Current Rating(A)
A	FDP0714-MODB1XXBKKA	1.70	2.00	10
B	FDP0714-MODB1XXBKKB	2.75	3.00	20
C	FDP0714-MODB1XXBKKC	3.30	3.60	30
D	FDP0714-MODB1XXBKKD	3.80	4.10	40

**Ordering Information**

FDP 07 14 — MO D B 1 XX BK K X  
 1 2 3 4 5 6 7 8 9 10 11

1	D-sub Connector Category FDP-Power Type	2	Circuits 07-7W2	3	Distinction No. 14	4	Type MO-Male	5	Assembly Layout D-DIP	6	Entry Angle B-90° Angle
7	Plating 1-Gold Plated	8	Thickness of Plating 03-0.075μm 15-0.375μm 30-0.75μm	9	Color-Resin BK-Black	10	Packaging K-Tray	11	Type A-Type A C-Type C B-Type B D-Type D		

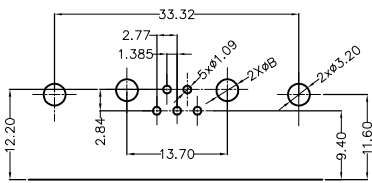
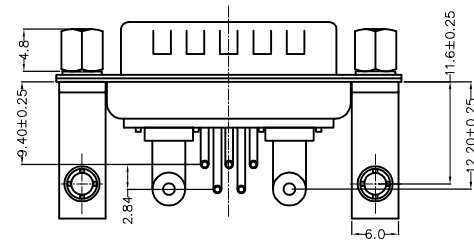
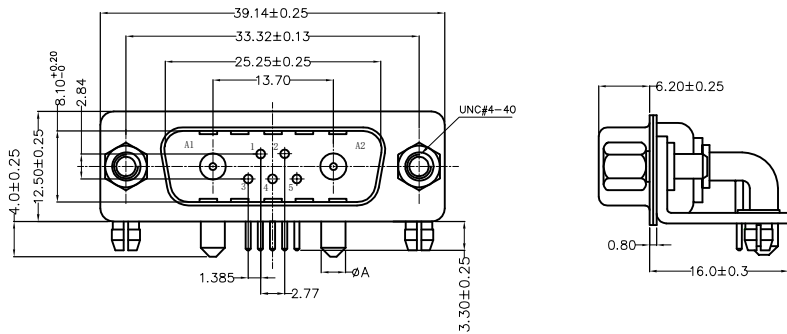
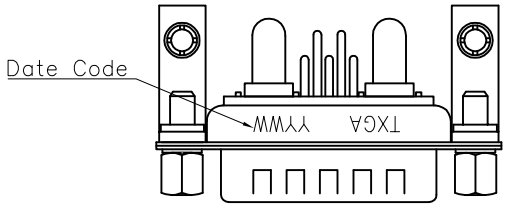

Recommended P.C.Board Layout  
 General tolerances: ±0.05mm

<p>THIRD ANGLE PROJECTION</p>	GENERAL TOLERANCES (UNLESS SPECIFIED)		APPROVE BY LEO	DATE 20/JUL/24	PART NO. FDP0714-MODB1XXBKXX	ITEM NO. FDP0714	<p>Building Technology Cornerstone</p>	
	X. ±0.30	X.* ±5°	CHECKED BY GISELLE	DATE 20/JUL/24	TITLE Hight current D-SUB connector 7W2 90°Angle Male(DIP)			REV 0
	X.X ±0.20	X.X* ±2°	DRAWN BY MATT	DATE 20/JUL/24	THIS DRAWING CONTAINS INFORMATION THAT IS PROPRIETARY TO TXGA INDUSTRIAL ELECTRONICS(S.Z)CO.,LTD AND SHOULD NOT BE USED WITHOUT WRITTEN PERMISSION			
	X.XX ±0.15	X.XX* ±1°						
X.XXX ±0.10	X.XXX* ±0.5°							